

STATE OF CALIFORNIA
 BUSINESS AND TRANSPORTATION AGENCY
 DEPARTMENT OF TRANSPORTATION

50-803617
 80-803617

FILED
 AT REQUEST OF
 DEPT. OF PUBLIC WORKS
 AUG 20 1980
 27 MIN. PAST 10 AM
 IN BOOK 16
 AT PAGE 71
 OF STATE HIGHWAY MAPS
 LOS ANGELES COUNTY, CALIF.
 COUNTY RECORDER
 L. Salas
 500

| DIST | COUNTY | ROUTE | POST MILES | SHEET NO. | TOTAL SHEETS |
|------|--------|-------|------------|-----------|--------------|
| 07 | LA | 91 | 9.9 | 11 | 11 |

Walter L. Lubruck
 RIGHT OF WAY ENGINEERING
 REGISTERED CIVIL ENGINEER NO. 8944
 8-6-80
 DATE

Recorded in the Office
 of the County Recorder
 LOS ANGELES COUNTY
 S.H.M.B. No. Pg.

RIGHT OF WAY MAPS OF
 STATE HIGHWAY
 In the City of Compton,
 along Route 91 Fwy,
 at College Overhead

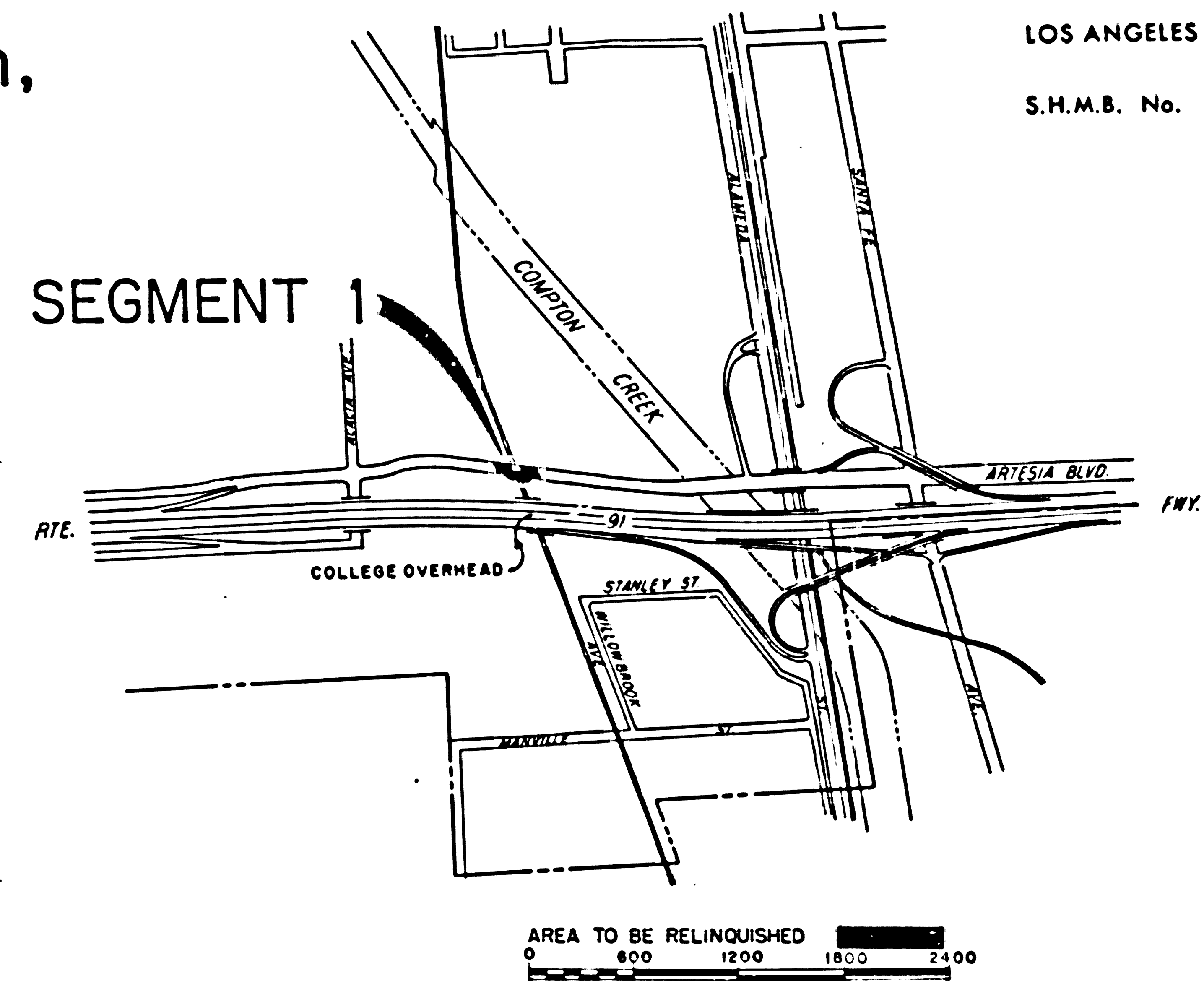
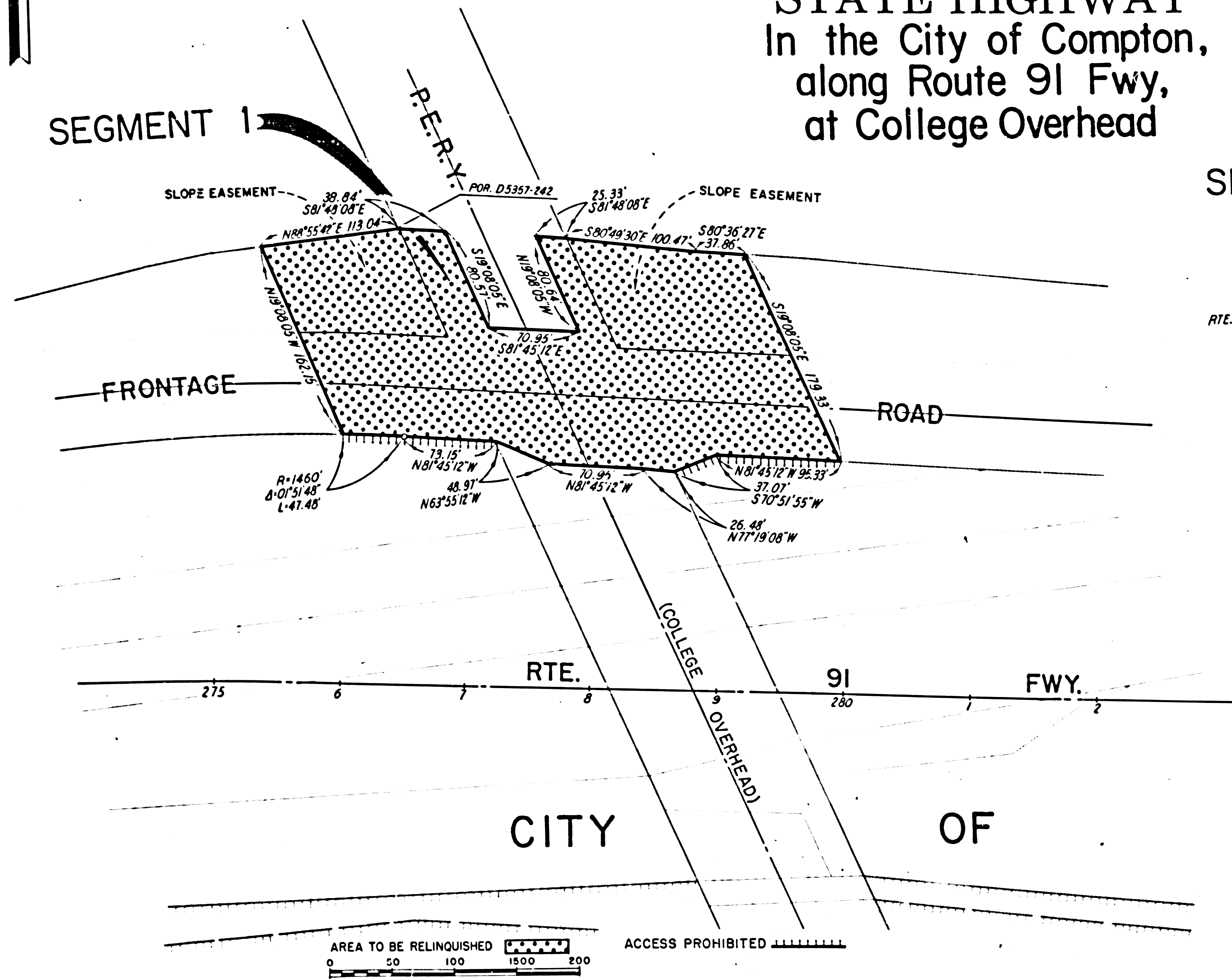

STATE OF CALIFORNIA
 BUSINESS AND TRANSPORTATION AGENCY
 DEPARTMENT OF TRANSPORTATION

PROPOSED RELINQUISHMENT

| | |
|----------------|-------------------------------------|
| DR'N BY V.J.R. | R/W MAP NO. F 1090-5 |
| C'LC BY S.F. | CONTRACT NO. 07-040944 07-009514 |
| C'K'D BY K.D. | REL- 993 |
| REVISED | |