

SK 17/29

STATE OF CALIFORNIA
BUSINESS AND TRANSPORTATION AGENCY
DEPARTMENT OF TRANSPORTATION

RIGHT OF WAY MAPS OF
STATE HIGHWAY

In the City of Glendale along Route 002
at Fern Lane.

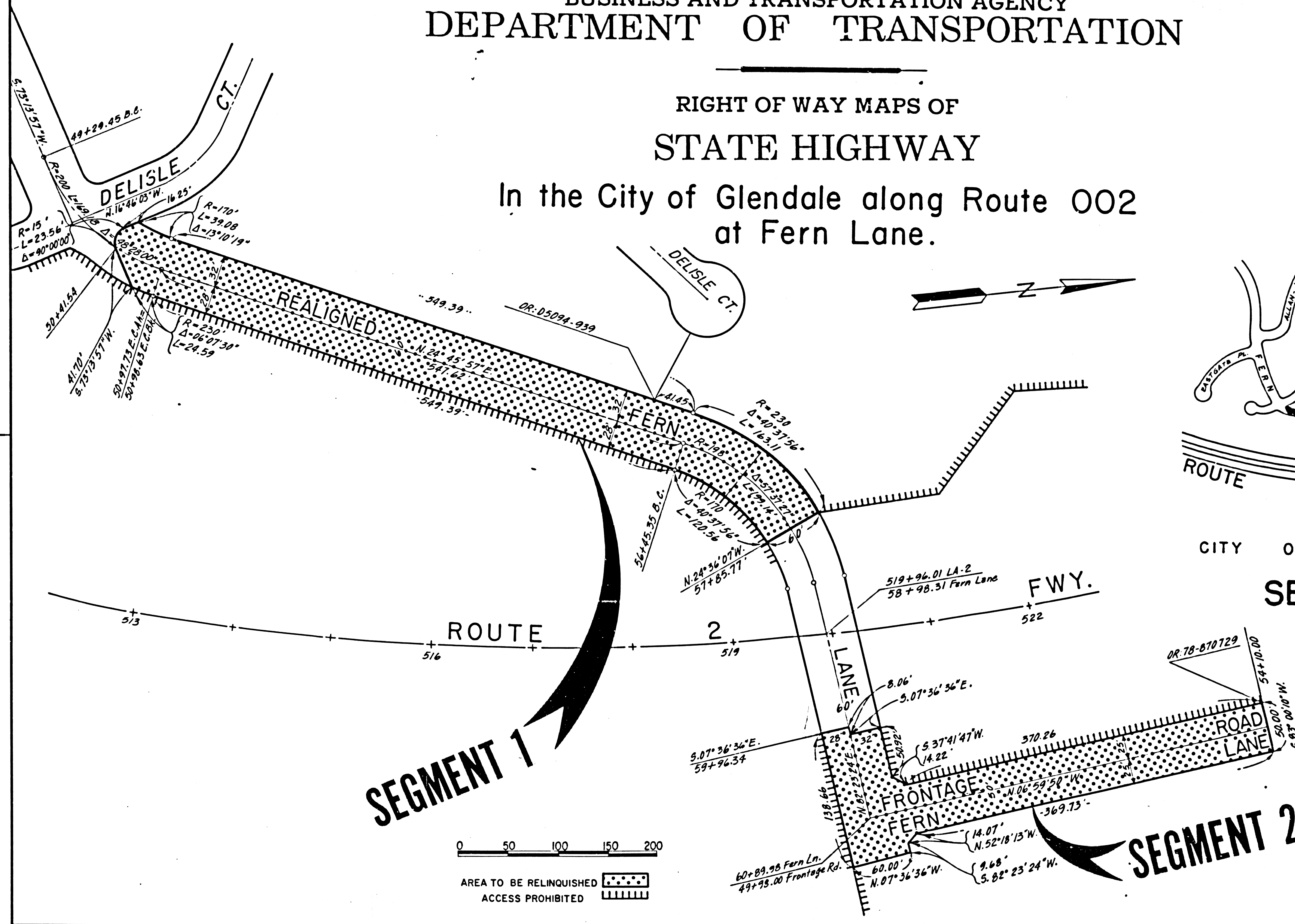

SEGMENT 1

SEGMENT 2

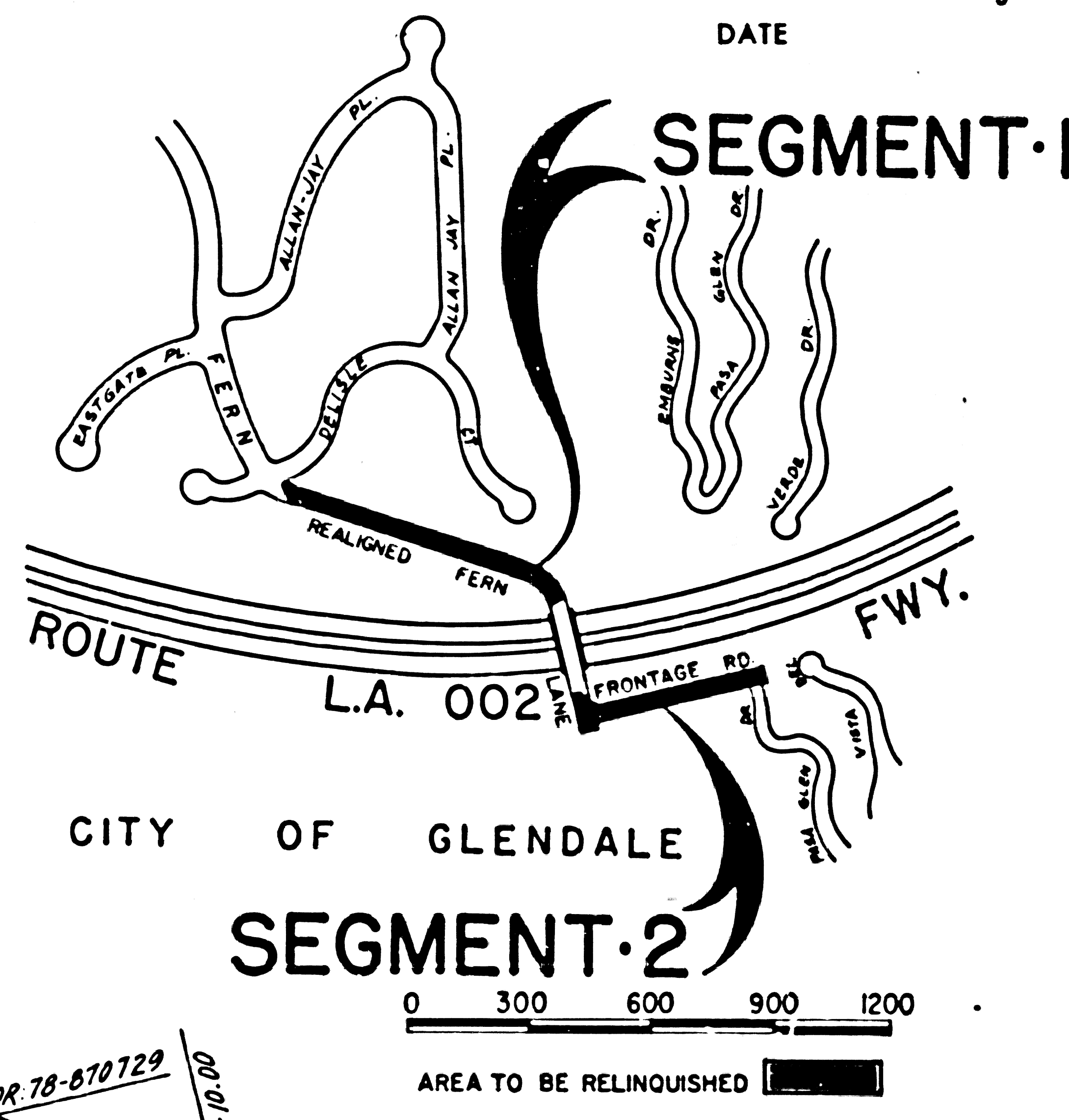

STATE	FEDERAL PROJECT NO.		
CALIF	7-210-1(67) 18		
DIST.	COUNTY	ROUTE	POST MILES
07	L.A.	002	R 21.6
SHEET NO.		TOTAL SHEETS	
1		1	

FILED AT REQUEST OF
DEPT OF PUBLIC WORKS
SEP 15 1982
91 PAST 3 p.m.
IN BOOK 17
AT PAGE 29
OF STATE HIGHWAY MAPS
LOS ANGELES COUNTY, CA
Registered Recorder
O. Lacayo
Deputy

Walter L. Kuback
RIGHT OF WAY ENGINEERING
REGISTERED CIVIL ENGINEER NO. 8944
6-24-92
DATE

Recorded in the Office
of the County Recorder
LOS ANGELES COUNTY
S.H.M.B. No. Pg.
DATE

STATE OF CALIFORNIA
BUSINESS AND TRANSPORTATION AGENCY
DEPARTMENT OF TRANSPORTATION

PROPOSED RELINQUISHMENT

DR'N BY F.E.Hdez.	R/W MAP NO. F-1272-L-2-3
C'LC BY S.H.	CONTRACT NO. 07-063724
C'K'D BY S.H.	REL-1031
REVISED	