

SHMB 18-8

STATE OF CALIFORNIA
 BUSINESS AND TRANSPORTATION AGENCY
 DEPARTMENT OF TRANSPORTATION

STATE		FEDERAL PROJECT NO.			
CALIF.		U-086-1(4)			
DIST.	COUNTY	ROUTE	POST MILES	SHEET NO.	TOTAL SHEETS
07	L.A.	134	8.8	1	1

M. N. Watanabe
 REGISTERED CIVIL ENGINEER
 RIGHT OF WAY ENGINEERING
 July 14, 1987
 APPROVAL DATE

M. WATANABE
 No. 19898
 Exp. 8-30-89
 C.E.C.
 STATE OF CALIFORNIA

RIGHT OF WAY MAPS OF
 STATE HIGHWAY

In the City of Los Angeles along Broadway
 between City Limits and Colorado Blvd.

(In compliance with Sections 128 & 129 of the STREETS & HIGHWAYS Code)
 Recorded in the Office of the County Recorder
 LOS ANGELES COUNTY
 S.H.M.B. No. 18 Pg. 8
 DATE 9-9-87

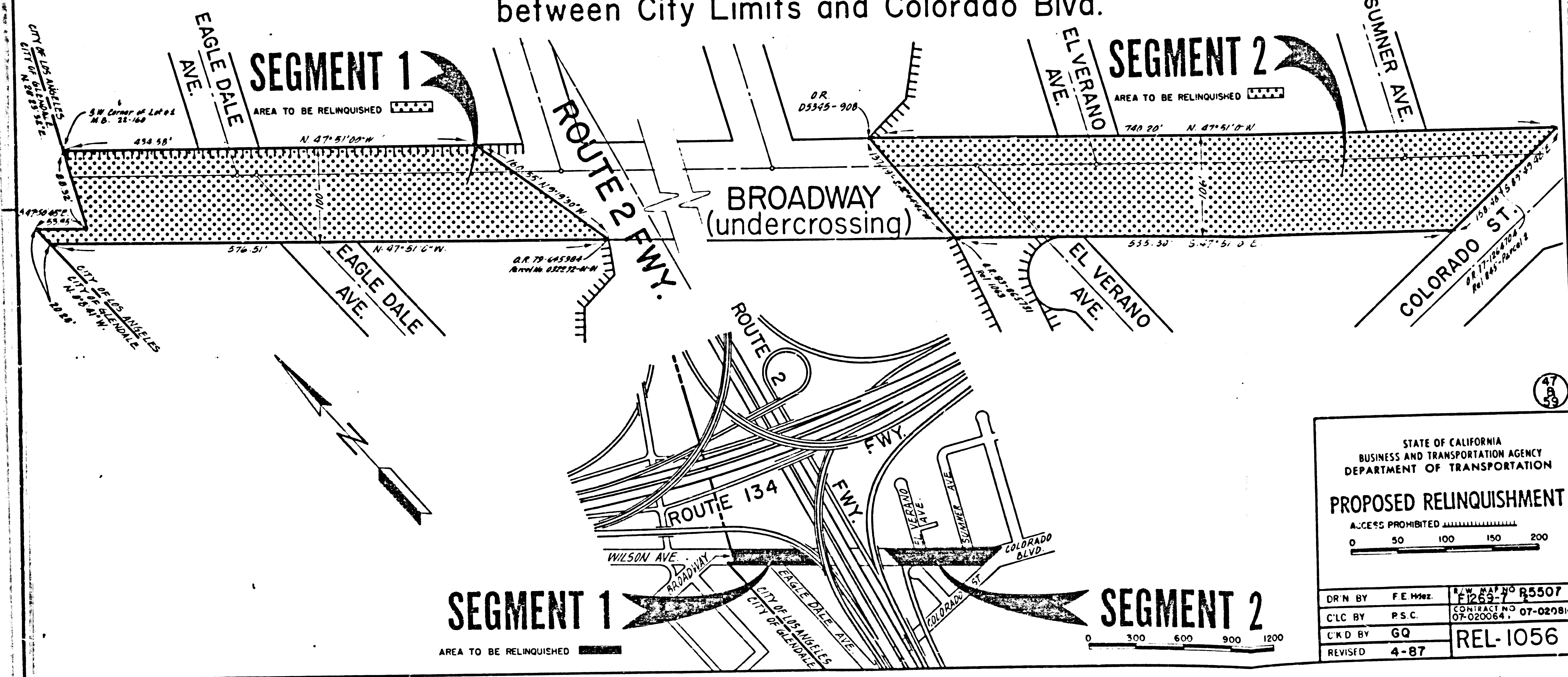

STATE OF CALIFORNIA
 BUSINESS AND TRANSPORTATION AGENCY
 DEPARTMENT OF TRANSPORTATION

PROPOSED RELINQUISHMENT

ACCESS PROHIBITED

0 50 100 150 200

DR'N BY	F.E. H&Bz.	R.W. MAP NO.	R5507
C/LC BY	P.S.C.	CONTRACT NO.	F1269-7 07-020814
C/K'D BY	GQ	REL.	REL-1056
REVISED	4-87		

59-217

WS 41-B-4