

SHMB 18-11

STATE OF CALIFORNIA  
 BUSINESS AND TRANSPORTATION AGENCY  
 DEPARTMENT OF TRANSPORTATION

RIGHT OF WAY MAPS OF  
 STATE HIGHWAY

In the City of Glendale along Wilson Ave. and Broadway between Vallejo Dr. and City Limits

STATE	FEDERAL PROJECT NO.			
CALIF.	U-086-1(A)			
CITY	ROUTE	POST MILES	SHEET NO.	TOTAL SHEETS
07	L.A.	134	8.8	11

*M. N. Nishimura*  
 REGISTERED CIVIL ENGINEER  
 RIGHT OF WAY ENGINEERING  
 July 14, 1987  
 APPROVAL DATE

**M. WATANABE**  
 REGISTERED PROFESSIONAL ENGINEER  
 No. 18898  
 Exp. 8-30-85  
 CIVIL  
 STATE OF CALIFORNIA

(In compliance with Sections 128 & 129 of the STREETS & HIGHWAYS Code)

Recorded in the Office of the County Recorder

LOS ANGELES COUNTY

S.H.M.B. No. 18 Pg. 11  
 DATE: OCTOBER 5, 1987

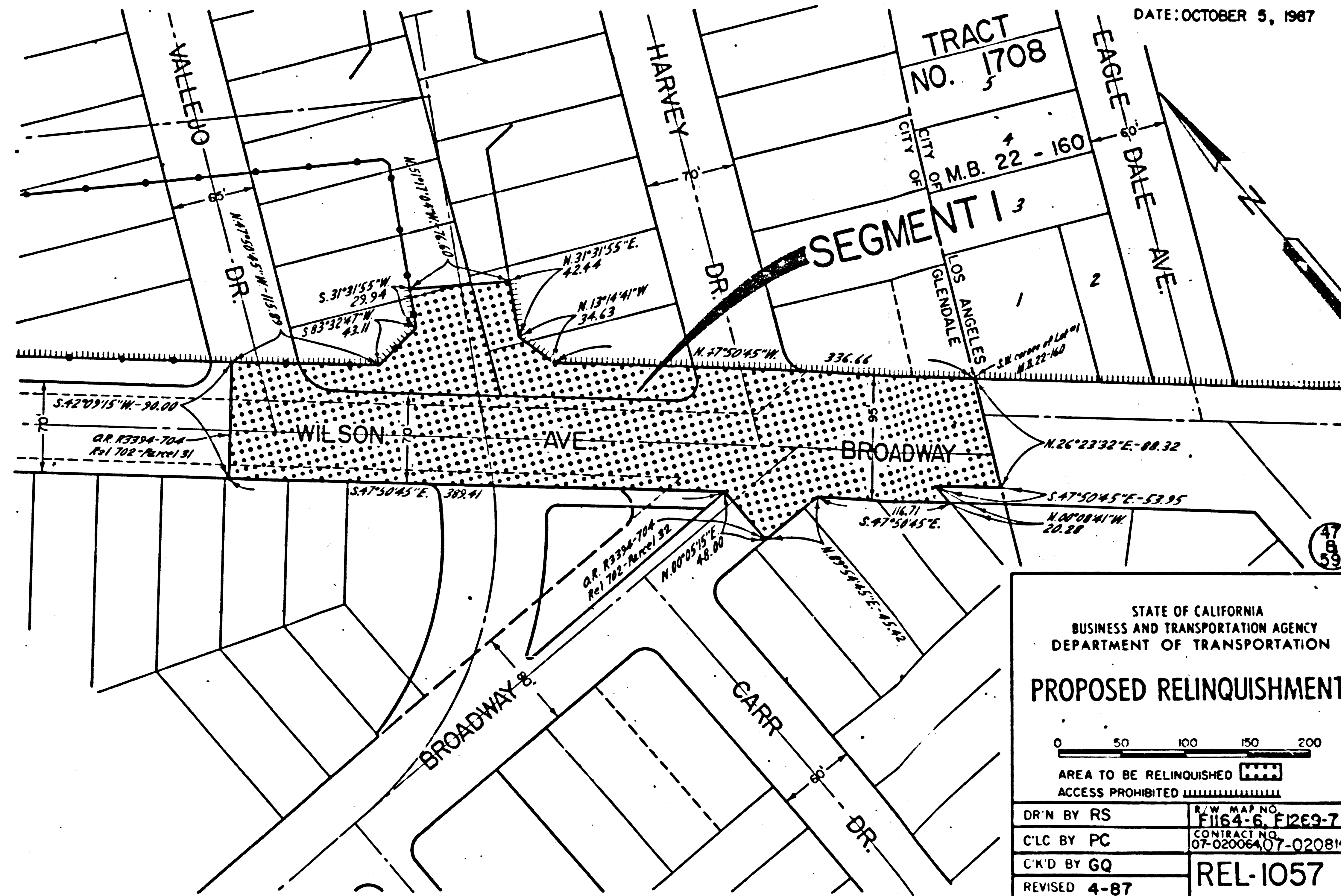
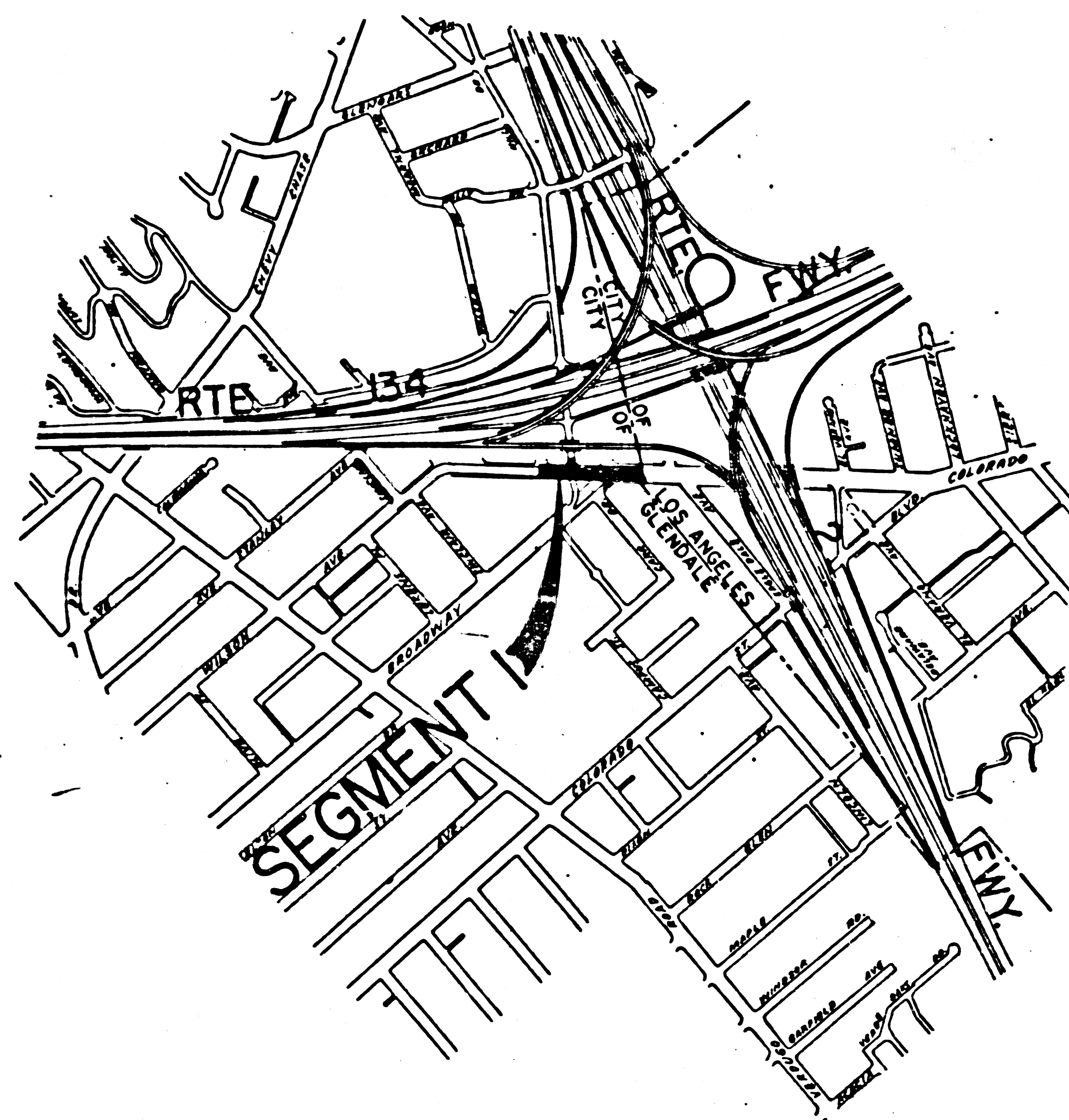

0 600 1200  
 AREA TO BE RELINQUISHED

STATE OF CALIFORNIA  
 BUSINESS AND TRANSPORTATION AGENCY  
 DEPARTMENT OF TRANSPORTATION

PROPOSED RELINQUISHMENT

0 50 100 150 200

AREA TO BE RELINQUISHED  
 ACCESS PROHIBITED

DR'N BY RS	FIG. MAP NO. F1269-7
C'LC BY PC	CONTRACT NO. 07-020064-07-020814
C'K'D BY GQ	REL-1057
REVISED 4-87	

59-217

W.S. 41-B-4