

SHMB 18-22

#90-950061

STATE OF CALIFORNIA  
BUSINESS AND TRANSPORTATION AGENCY  
DEPARTMENT OF TRANSPORTATION

STATE	FEDERAL PROJECT NO.	
DIST. COUNTY	ROUTE	POST MILES
07 LA	1	59.0
SHEET NO.		TOTAL SHEETS
1		2
M. Watanabe REGISTERED CIVIL ENGINEER RIGHT OF WAY ENGINEERING 9/19/88 APPROVAL DATE		

RIGHT OF WAY MAPS OF  
STATE HIGHWAY

In the Unincorporated Portion of the County of Los Angeles  
Route 1, Outer Highway from 0.4 Mi. East of  
Nicholas Canyon Road to 0.6 Mi. East of  
Nicholas Canyon Road

(In compliance with  
Sections 128 & 129 of the  
STREETS & HIGHWAYS Code)

Recorded in the Office  
of the County Recorder  
LOS ANGELES COUNTY

S.H.M.B. No. 18 Pg. 22823  
DATE 9-7-88

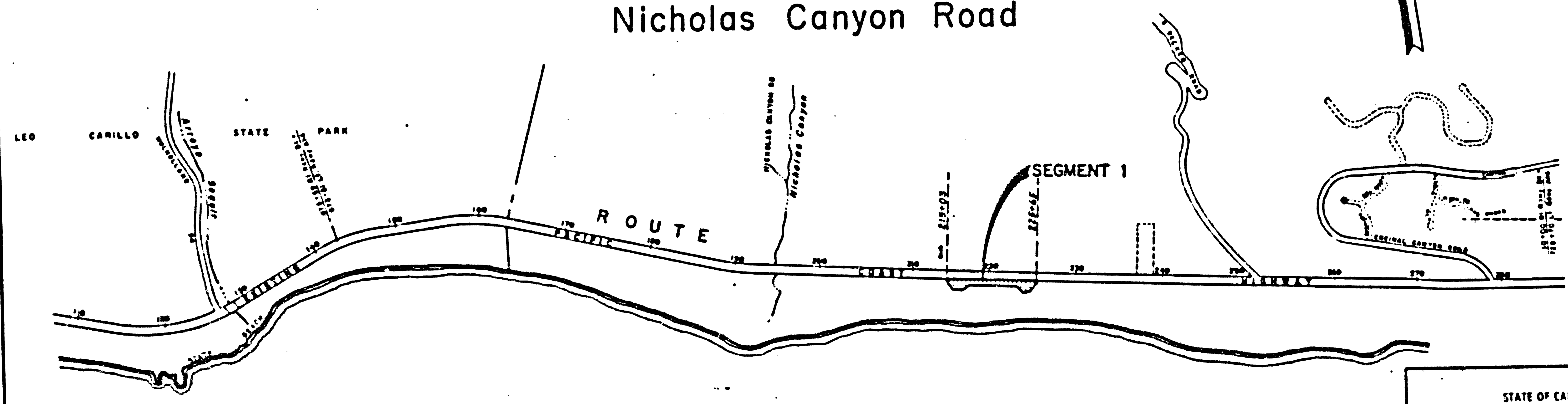
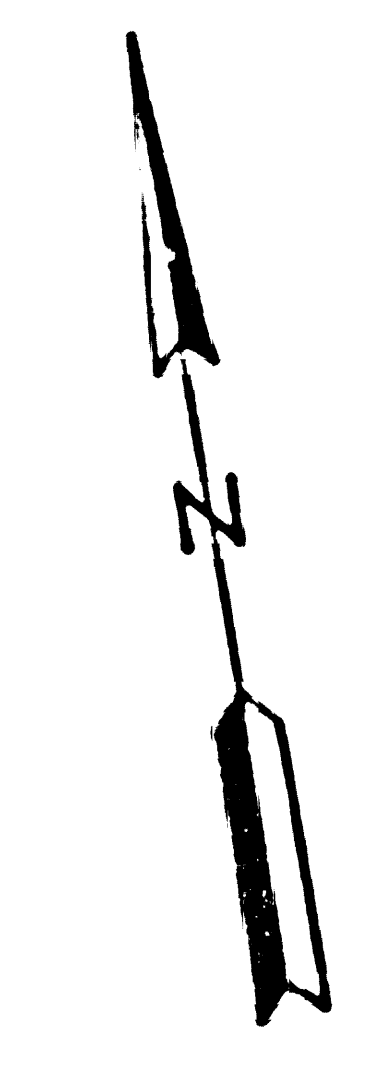

P A C I F I C O C E A N

STATE OF CALIFORNIA  
BUSINESS AND TRANSPORTATION AGENCY  
DEPARTMENT OF TRANSPORTATION

**PROPOSED RELINQUISHMENT**

0 600 1200 1800 2400

AREA TO BE RELINQUISHED

DRN BY LG	R/W MAP NO. 25638-C
CLC BY MV	CONTRACT NO.
CND BY ED	REL-1155
REVISED	

114-997

77

SHMB 18-23

#90-950061

STATE		FEDERAL PROJECT NO.	
CALIF.			
DIST.	COUNTY	ROUTE	POST MILES
07	LA	1	59.0
		SHEET NO.	TOTAL SHEETS
		2	2

*M. Watanabe*  
 REGISTERED CIVIL ENGINEER  
 RIGHT OF WAY ENGINEERING  
 9/15/88  
 APPROVAL DATE

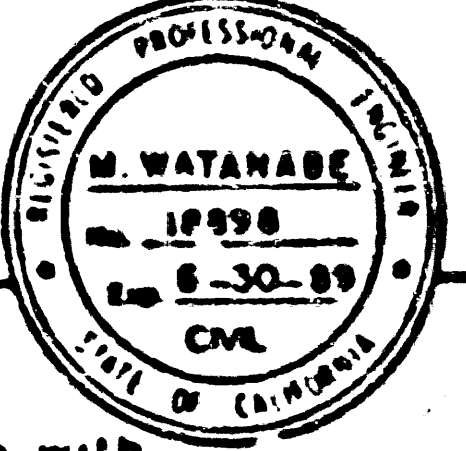

(In compliance with Sections 128 & 129 of the STREETS & HIGHWAYS Code)

Recorded in the Office of the County Recorder  
 LOS ANGELES COUNTY

S.H.M.B. No. 18 Pg. 22823  
 DATE 9-7-88

RANCHO TOPANGA MALIBU SEQUIT  
 PAT. 1-407

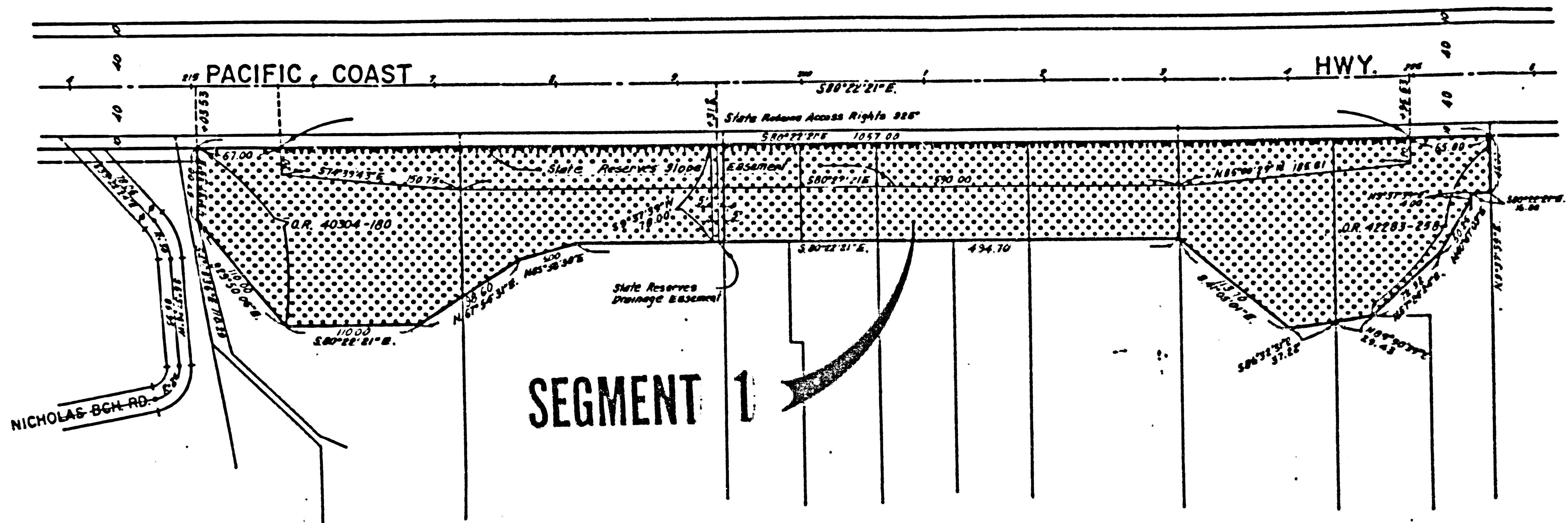
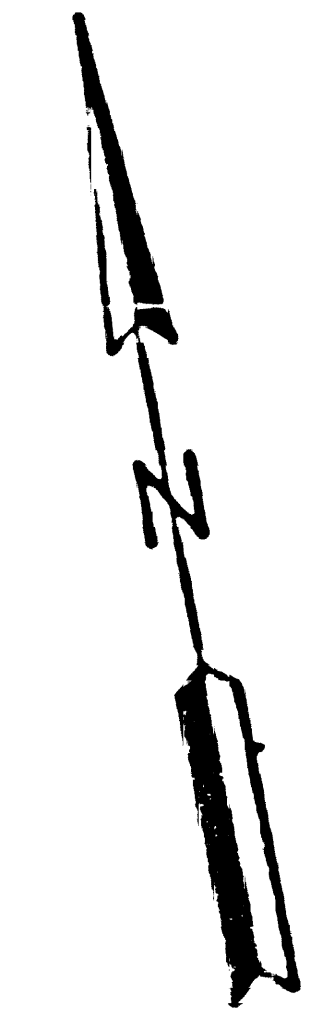

77

STATE OF CALIFORNIA  
 BUSINESS AND TRANSPORTATION AGENCY  
 DEPARTMENT OF TRANSPORTATION

**PROPOSED RELINQUISHMENT**

0 50 100 150 200

AREA TO BE RELINQUISHED [Hatched Box]  
 ACCESS PROHIBITED [Dashed Box]

DR'N BY LG	R/W MAP NO. 25638-C
C/LC BY HV	CONTRACT NO.
C/K'D BY EO	REL-1155
REVISED	

114-997