

SHMB 18-76

Doc # 93-114382

STATE OF CALIFORNIA  
BUSINESS AND TRANSPORTATION AGENCY  
DEPARTMENT OF TRANSPORTATION

STATE		FEDERAL PROJECT NO.	
CALIF.		1-105-1131010	
DIST	COUNTY	ROUTE	POST MILES
07	LA	405	21.9/22.2
		NO.	SHEET
		1	2

APPROVAL DATE: 3/2/92

Licensed Land Surveyor  
RIGHT OF WAY ENGINEERING  
High Jerome Archambault  
LS 9070  
Exp. 9-30-93

RIGHT OF WAY MAPS OF  
STATE HIGHWAY

In the County of Los Angeles, along Rte. 405,  
between 106th St. and 101st St.

(In compliance with Sections 128 & 129 of the STREETS & HIGHWAYS Code)  
Recorded in the Office of the County Recorder  
LOS ANGELES COUNTY  
SHMB No. 18 Pg 75/76  
DATE 6-9-92

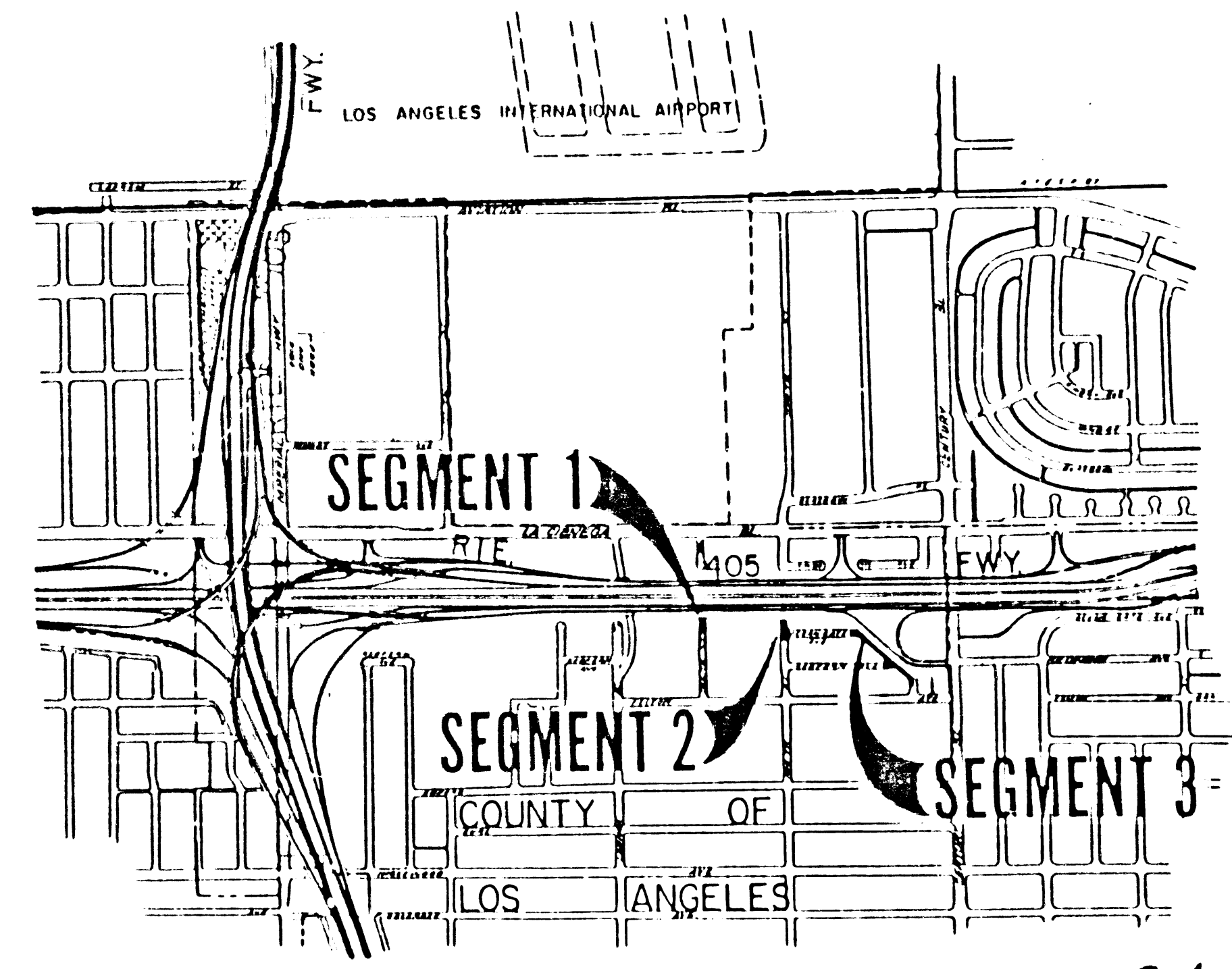

INTERSTATE 82

STATE OF CALIFORNIA  
BUSINESS AND TRANSPORTATION AGENCY  
DEPARTMENT OF TRANSPORTATION

PROPOSED RELINQUISHMENT

0 600 1200 1800 2400

AREA TO BE RELINQUISHED

DRN BY MLS	1/24/92
CLC BY SC	1924-6-FJ923-3
CKD BY E. KURIHARA	007529
REVISED	REL-1112

W.S. 24-A-5

SHMB 18-76

COUNTY OF LOS ANGELES

DOC # 93-174382

STATE	FEDERAL PROJECT NO.
CALIF. 1-105-31010	
POST MILES	SHEETS
21.9/222	2 2
<i>David J. Ackerman</i> LICENSED LAND SURVEYOR RIGHT OF WAY ENGINEERING 7/7/90 APPROVAL DATE	

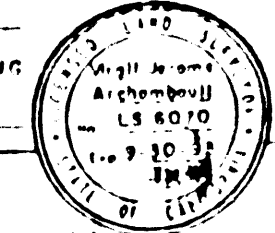

(In compliance with Sections 128 & 129 of the STREETS & HIGHWAYS Code)

Recorded in the Office of the County Recorder  
LOS ANGELES COUNTY

SHMB No. 18 Pg 75/76  
DATE 6-9-92

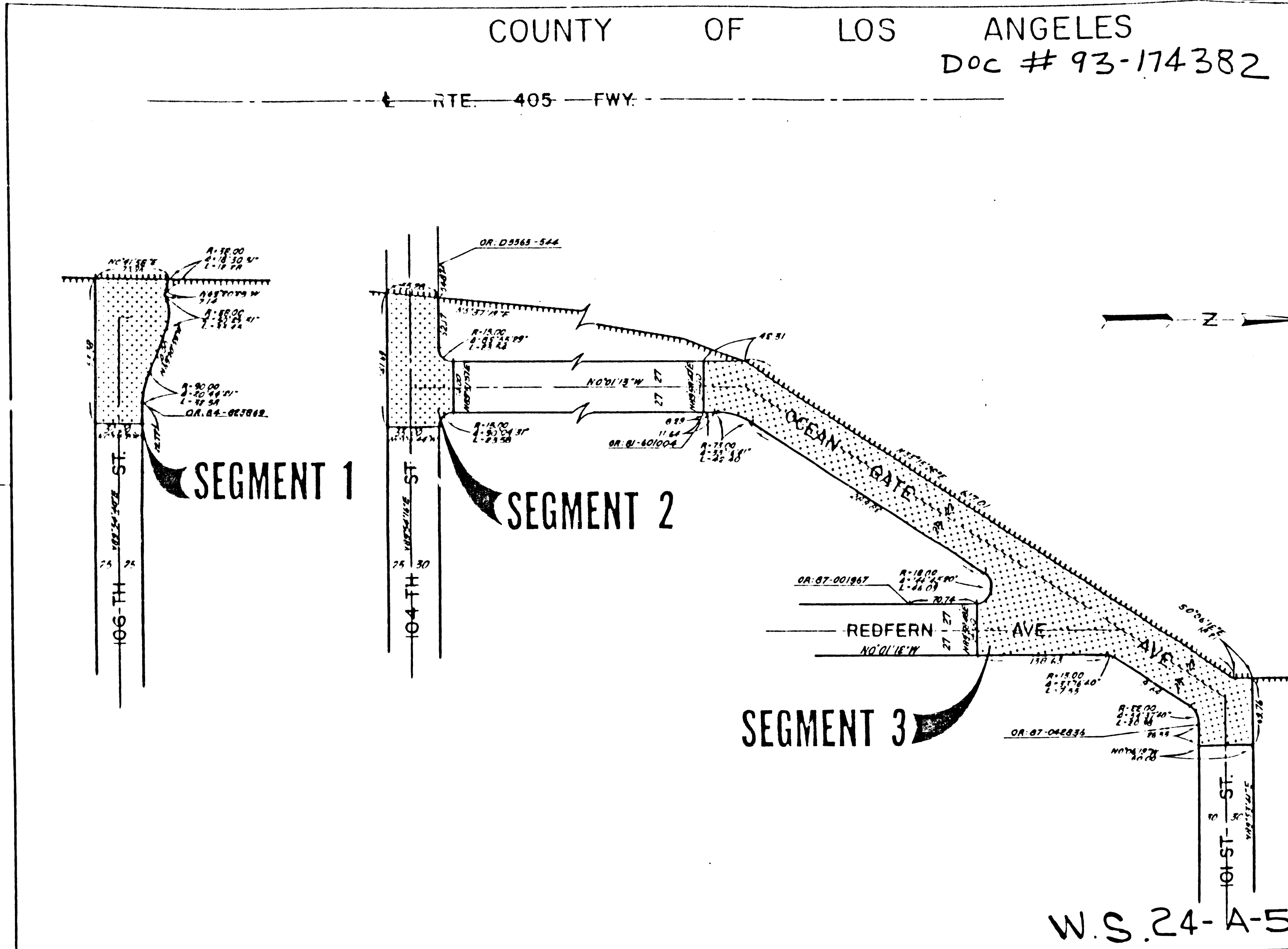

INTERSTATE (82)

STATE OF CALIFORNIA  
BUSINESS AND TRANSPORTATION AGENCY  
DEPARTMENT OF TRANSPORTATION

PROPOSED RELINQUISHMENT

0 50 100 150 200

AREA TO BE RELINQUISHED [Hatched Area]

ACCESS PROHIBITED [Hatched Area]

DRN BY MLS	1924-6-E1925-3
CHK BY SC	007823
CR'D BY E. KURIHARA	REL-1112
REVISED 6-7-90	

W.S. 24-A-5