

SHMB 18-83

#94-756538

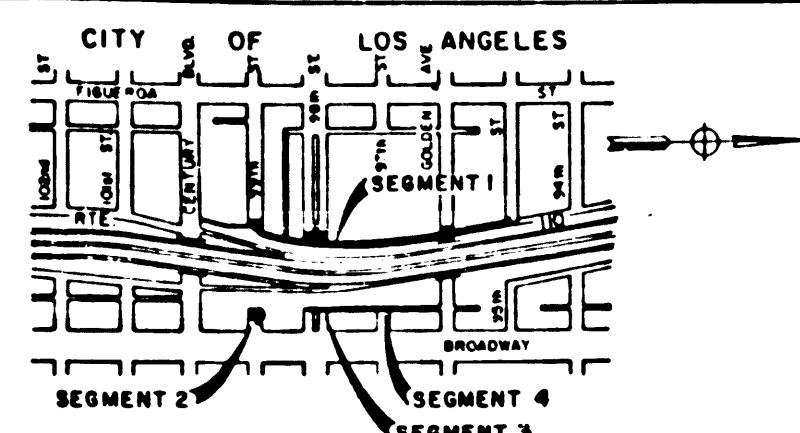

STATE OF CALIFORNIA
 BUSINESS AND TRANSPORTATION AGENCY
 DEPARTMENT OF TRANSPORTATION

07	LA	105	R6 B-R7 B	1	1
190-193 190-193					
10/2/91 10/2/91 10/2/91 10/2/91					

David J. Kucharski
 LICENSED LAND SURVEYOR
 RIGHT OF WAY ENGINEERING
 10/2/91

RIGHT OF WAY MAPS OF
 STATE HIGHWAY

In the City of Los Angeles, Along Route 110 Freeway
 Between Century Boulevard and Ninety-Fifth Street

(In compliance with Sections 128 & 129 of the STREETS & HIGHWAYS Code)
 Recorded in the Office of the County Recorder
 LOS ANGELES COUNTY
 SHMB No 18 Pg 83
 DATE AUG 10, 1992

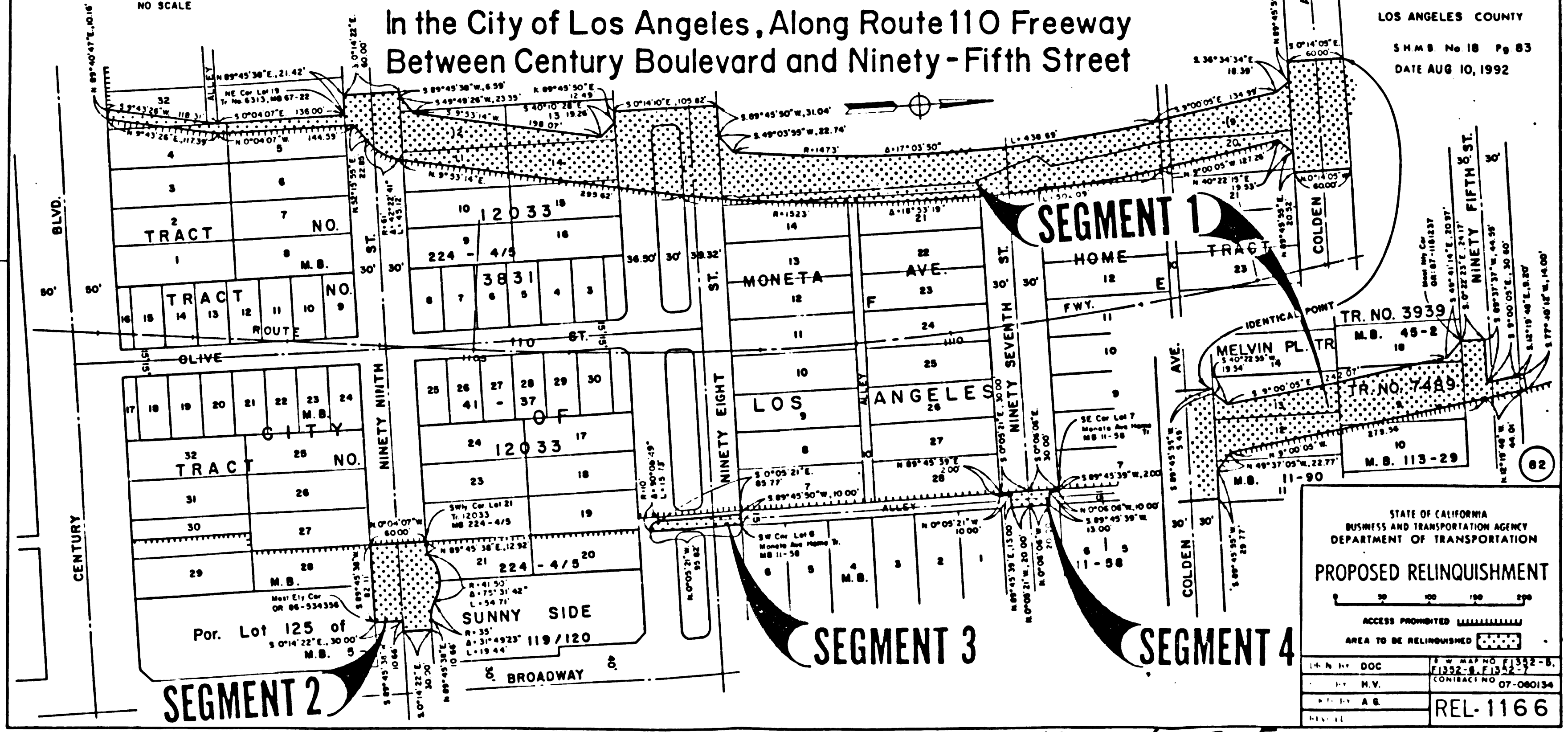

STATE OF CALIFORNIA
 BUSINESS AND TRANSPORTATION AGENCY
 DEPARTMENT OF TRANSPORTATION

PROPOSED RELINQUISHMENT

ACCESS PROHIBITED [diagonal lines]

AREA TO BE RELINQUISHED [dotted area]

DATE	10/2/91	MAP NO.	1352-B
BY	D.J.K.	CONTRACT NO.	07-080134
REVISED			REL-1166

WS 24-E-5