

STATE OF CALIFORNIA
 BUSINESS AND TRANSPORTATION AGENCY
 DEPARTMENT OF TRANSPORTATION

RIGHT OF WAY MAPS OF
 STATE HIGHWAY
 In the City of Los Angeles, on Venice Blvd (Route 187, North
 and South) From Pacific Ave. To Lincoln Blvd.

DIST.	COUNTY	ROUTE	POST MILES TO TOTAL PROJECT	SHEET NO.	TOTAL SHEETS
07	LA	187	2.4 / 3.5	1	1

Virgil J. Archambault
 DISTRICT ENGINEER
 PROFESSIONAL LAND SURVEYOR
 APPROVAL DATE: 4-16-93

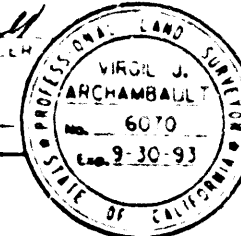

(In compliance with
 Sections 128 & 129 of the
 STREET & HIGHWAYS CODE)
 Recorded in the Office
 of the County Recorder
 COUNTY
 S. H. M. B. No. Pg.

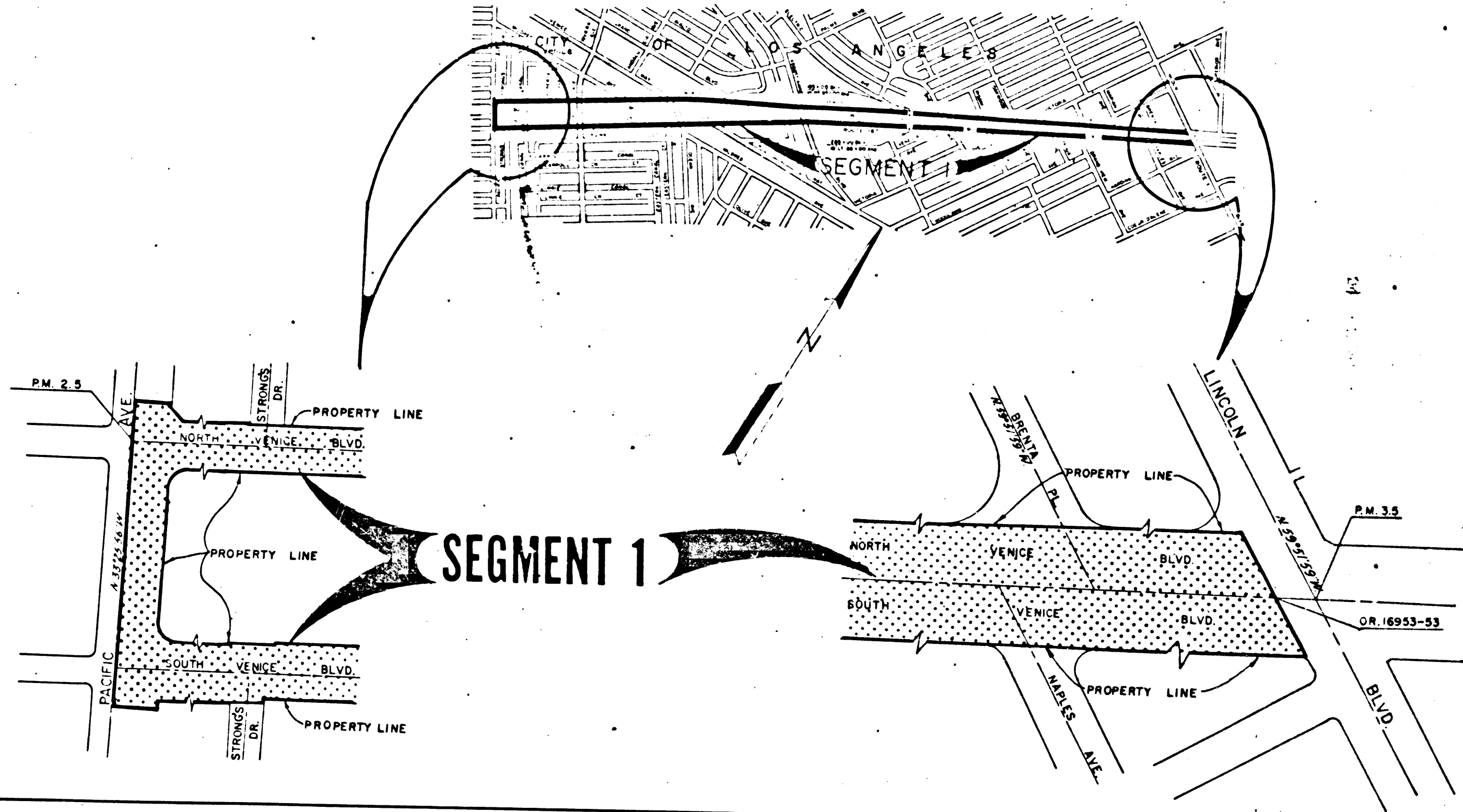

FILED
 AT REQUEST OF
 DISTRICT ENGINEER
 MAT 04 893
 01 PM 1
 IN ROOM 19
 AT 10:00 AM
 FOR THE COUNTY OF
 LOS ANGELES
 BY
 Virgil J. Archambault
 DISTRICT ENGINEER

93 12710
 93 84330

STATE OF CALIFORNIA
 BUSINESS AND TRANSPORTATION AGENCY
 DEPARTMENT OF TRANSPORTATION

PROPOSED RELINQUISHMENT

0 400 1200 1600 2400
 AREA TO BE RELINQUISHED

DRN BY R.D.	R.W. MAP NO. 23974
CLC BY A.G.	CONTRACT NO. 07-062224
CRD BY A.G.	REL-1157
REVISED	

BOOK 19 PAGE 10