

SHMB 19-11

STATE	FEDERAL PROJECT NO.
07	LA
ROUTE	TOTAL PROJECT MILES
72	10.5/12.1
	SHEET NO.
	1
	2

*Yorge J. Archambault*  
 DISTRICT ENGINEER IN CHARGE  
 PROFESSIONAL LAND SURVEYOR  
 9-8-93  
 APPROVAL DATE

YORGE J. ARCHAMBAULT  
 6070  
 9-30-97  
 STATE OF CALIFORNIA

STATE OF CALIFORNIA #93-2286015  
 BUSINESS AND TRANSPORTATION AGENCY  
 DEPARTMENT OF TRANSPORTATION

RIGHT OF WAY MAPS OF  
 STATE HIGHWAY  
 In the County of Los Angeles, Along Whittier Blvd.  
 From Atlantic Blvd To The Westerly Limits of The  
 City of Montebello.

In compliance with  
 Sections 128 & 129 of the  
 STREET & HIGHWAYS CODE)  
 Recorded in the Office  
 of the County Recorder  
 Los Angeles COUNTY  
 S. M. B. No. 19Pg. 11-12  
 DATE: 9-10-93

SUPERSEDES MAP RECORDED  
 AUGUST 9, 1993  
 S.H.M.B. No. 19 Pg. 8, 9

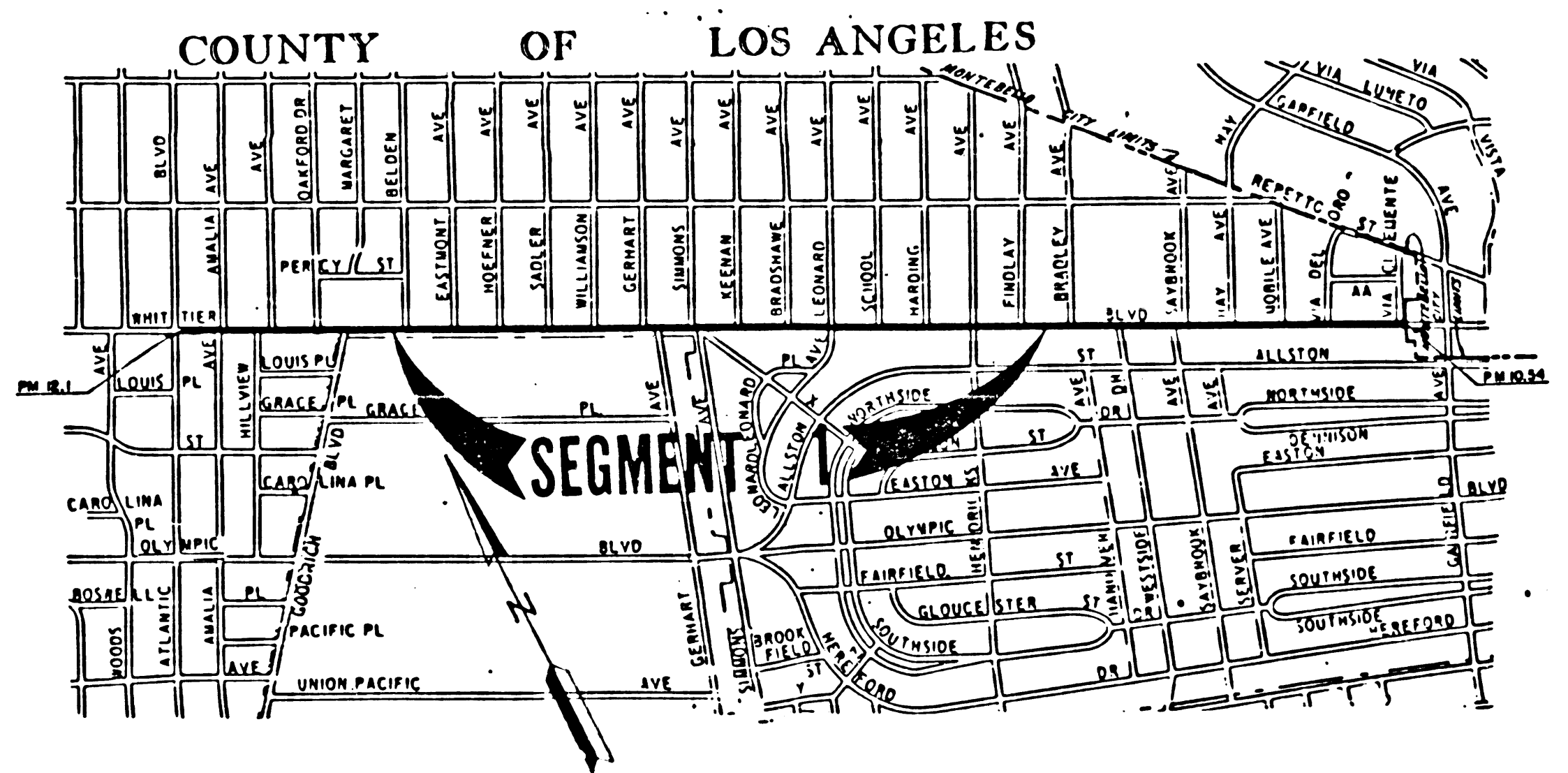

STATE OF CALIFORNIA  
 BUSINESS AND TRANSPORTATION AGENCY  
 DEPARTMENT OF TRANSPORTATION

**PROPOSED RELINQUISHMENT**

0 50 100 150 200

AREA TO BE RELINQUISHED

OWN BY R.O.	170 MAP NO. 7189
C'LC BY A.G.	CONTRACT NO. 3309 (KASH CONTRACT)
C'R'D BY	REL-1170
REVISED	

W.S. 36-A, B-3

SHMB 19-12

# 93-2286015

COUNTY OF LOS ANGELES

DIST.	COUNTY	ROUTE	POST MILES TOTAL PROJECT	SHEET NO.	TOTAL SHEETS
07	LA	72	10.5 / 12.1	2	2

*Virgil J. Archambault*  
 DISTRICT RIGHT OF WAY ENGINEER  
 PROFESSIONAL LAND SURVEYOR  
 APPROVAL DATE: 9-8-93

VIRGIL J. ARCHAMBAULT  
 6070  
 9-30-97  
 PROFESSIONAL LAND SURVEYOR

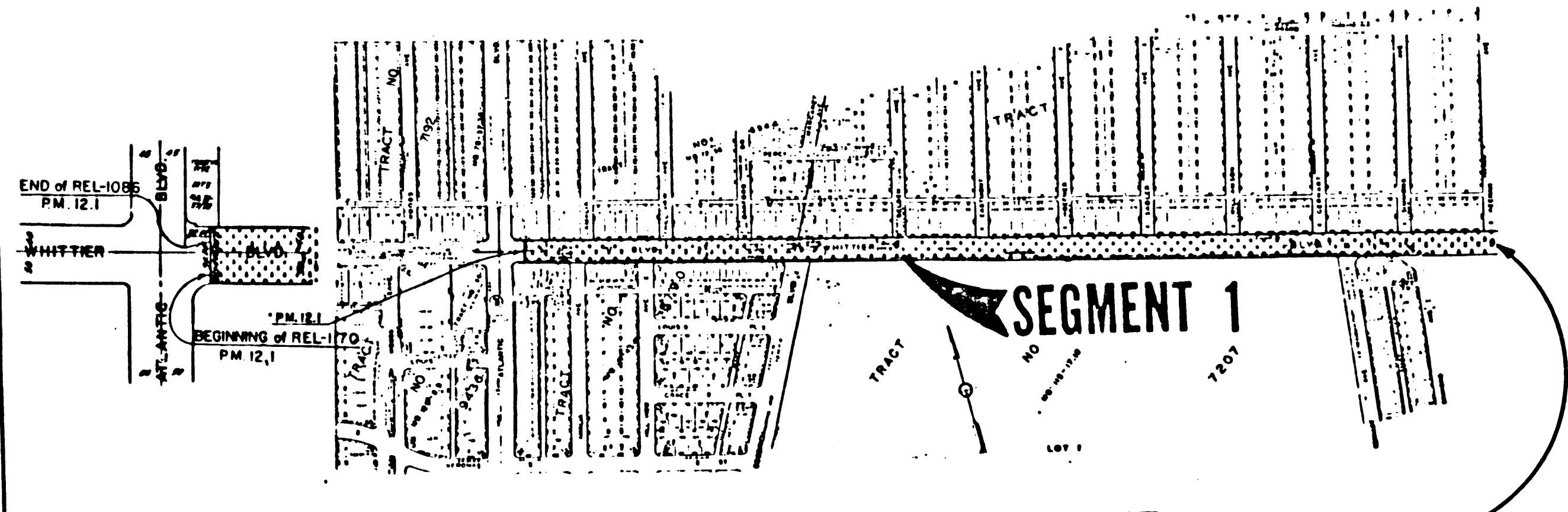

IDENTICAL POINT

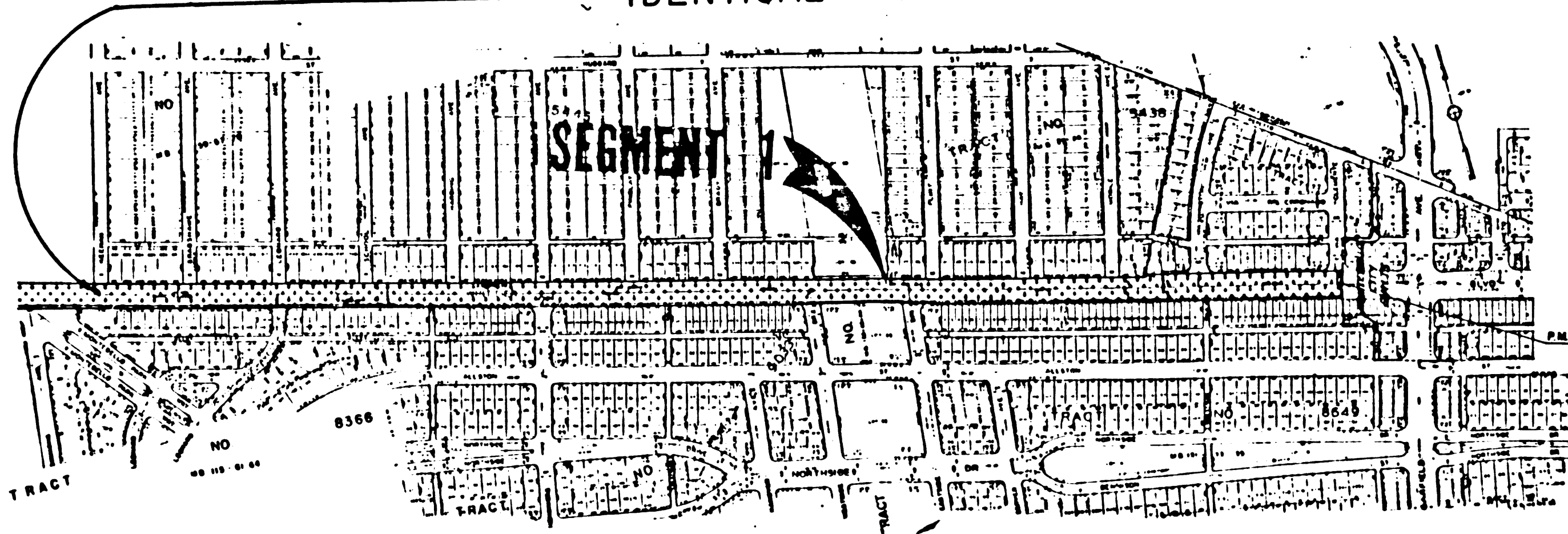

(In compliance with Sections 128 & 129 of the STREET & HIGHWAYS CODE)  
 Recorded in the Office of the County Recorder  
 Los Angeles COUNTY  
 S. M. B. No. 19 Pg. 11-12  
 DATE: 9-10-93  
 SUPERSEDES MAP RECORDED AUGUST 9, 1993  
 S.M.B. No. 19 Pg. 8, 9

STATE OF CALIFORNIA  
 BUSINESS AND TRANSPORTATION AGENCY  
 DEPARTMENT OF TRANSPORTATION

**PROPOSED RELINQUISHMENT**

0 50 100 150 200

AREA TO BE RELINQUISHED [diagonal hatching]  
 ACCESS PROMOTED [dashed line]

DRN BY RD	S/W MAP NO. P. 7129
C/LC BY A.G.	CONTRACT NO. 3309 (CASH CONTRACT)
CR'D BY	REL-1170
REVISED	

W.S. 36-A, B-3