

SHMB 19-22

941642042

STATE OF CALIFORNIA
BUSINESS AND TRANSPORTATION AGENCY
DEPARTMENT OF TRANSPORTATION

STATE OF CALIFORNIA				
FEDERAL PROJECT NO.				
COUNTY				
DIST.	COUNTY	ROUTE	POST MILES TOTAL PROJECT	SHEET NO. OF TOTAL SHEETS
07	LA	105	9.4/11.0	1 1
APPROVAL DATE: 9-21-93				
PROFESSIONAL LAND SURVEYOR: VIRGIL J. ARCHAMBAULT, No. 6070, Exp. 9-30-97				

RIGHT OF WAY MAPS OF
STATE HIGHWAY

In the County of Los Angeles, along Firestone Blvd. (Route 105), between Los Angeles city limits (Central Ave.) and the westerly city limits of the City of South Gate (E. of Alameda St.)

(In compliance with Sections 128 & 129 of the STREET & HIGHWAYS CODE)
Recorded in the Office of the County Recorder
LOS ANGELES COUNTY
S. H. M. B. No. 19 Pg. 22
Date: 5-4-94

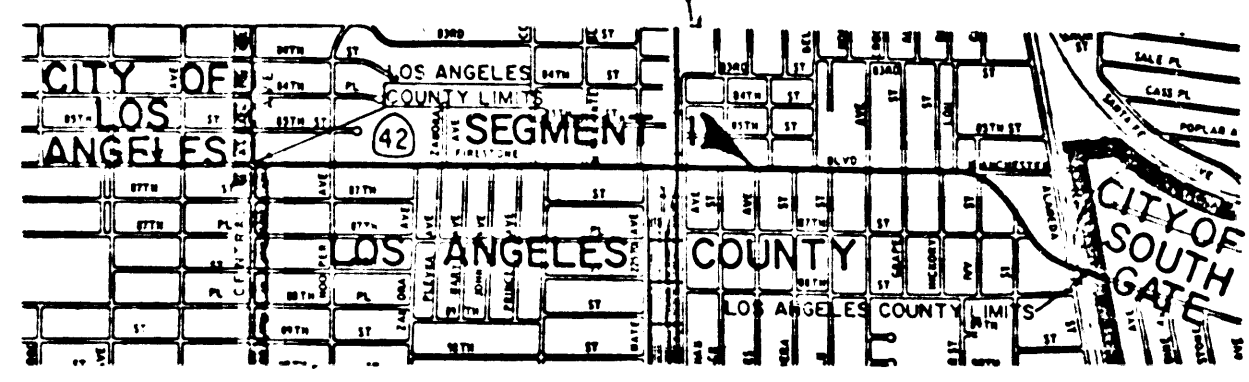
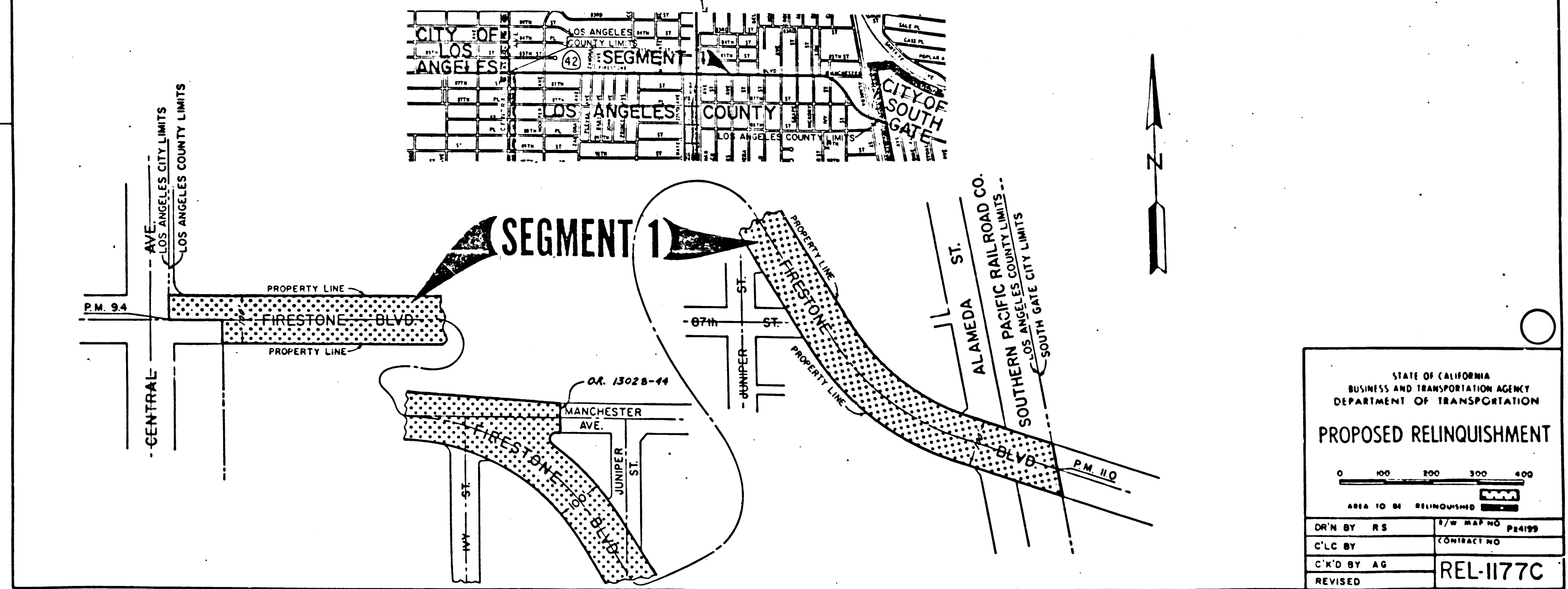

STATE OF CALIFORNIA
BUSINESS AND TRANSPORTATION AGENCY
DEPARTMENT OF TRANSPORTATION

PROPOSED RELINQUISHMENT

0 100 200 300 400

AREA TO BE RELINQUISHED

DR'N BY	RS	E/W MAP NO.	P24199
C'LC BY		CONTRACT NO.	
C'K'D BY	AG	REL-1177C	
REVISED			

W.S. 7-A, B-5