

SHMB 19-33

STATE OF CALIFORNIA #94-1829084
BUSINESS AND TRANSPORTATION AGENCY
DEPARTMENT OF TRANSPORTATION

STATE	COUNTY	ROUTE	POST MILE	SECTION
CA	LA	105	11.4/11.7	1 2
APPROVAL DATE: 7-2-84				

PROFESSIONAL LAND SURVEYOR
VIRGIL J. SCHMIDT
1619
1-30-87

RIGHT OF WAY MAPS OF
STATE HIGHWAY

In the City of Lynwood, between Peach Street and Birch Street

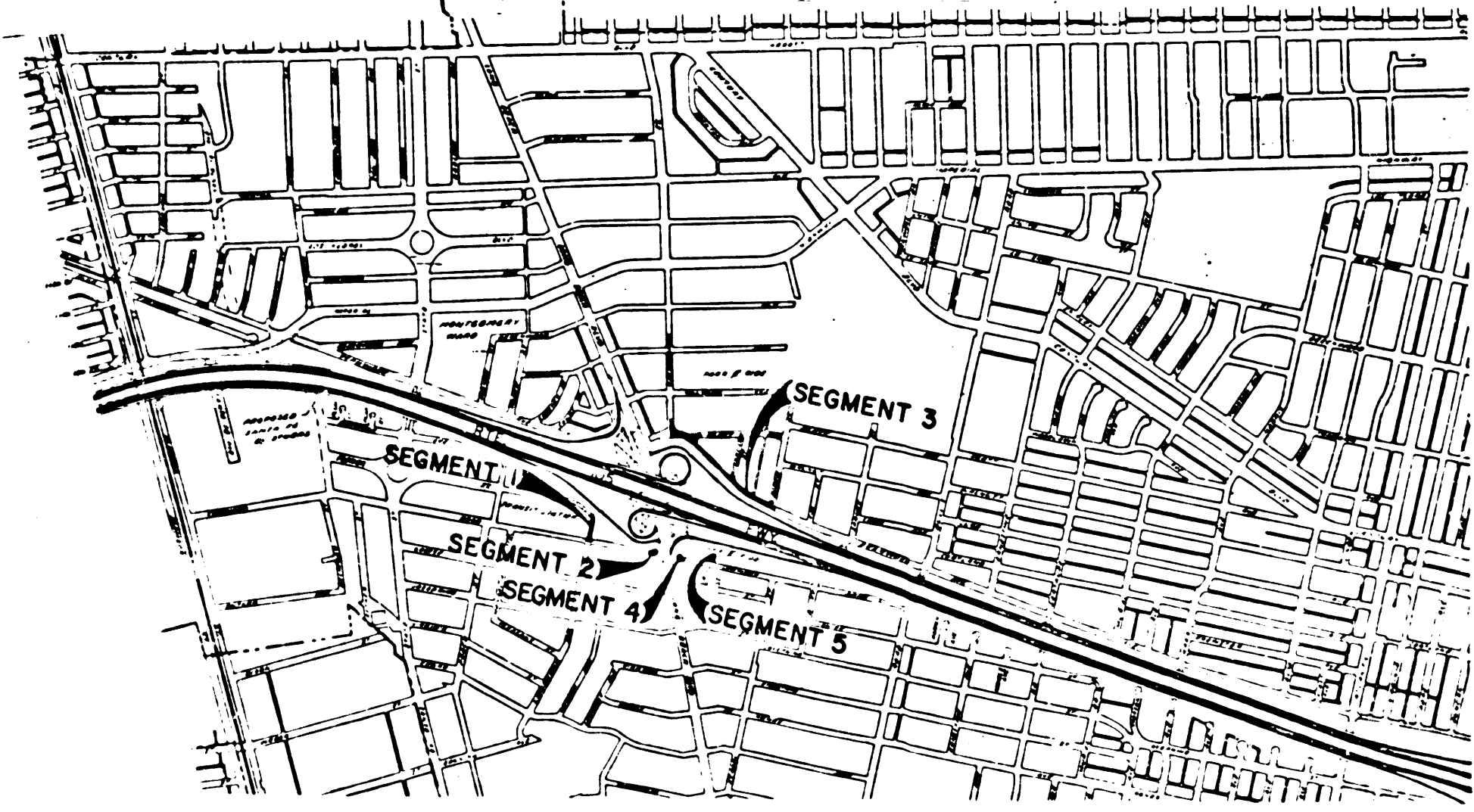

In compliance with Sections 128 & 129 of the STREET & HIGHWAYS CODE
Recorded in the Office of the County Recorder
LOS ANGELES COUNTY
S.H.M.B. NO. 19 PAGE 33-34
DATE AUG. 11, 1984

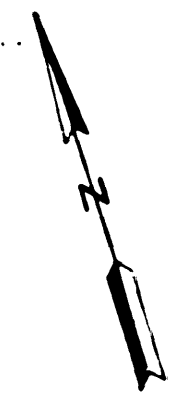

INTERSTATE

STATE OF CALIFORNIA
BUSINESS AND TRANSPORTATION AGENCY
DEPARTMENT OF TRANSPORTATION

PROPOSED RELINQUISHMENT

0 500 1000 1500 2000

AREA TO BE RELINQUISHED

DRN BY RS	1 W. 11.4/11.7
CLC BY WR	1 W. 11.4/11.7
REV BY AG	1 W. 11.4/11.7
REVISED	REL-1142A

WS 32-A-2

CITY OF LYNWOOD #94-1829084

SHMB 19-34

DIST	COUNTY	ROUTE	TOTAL ACRES	SHEETS
07	LA	105	11.4/11.7	2 2

David J. ...
 DISTRICT OFFICE OF RAY L. ...
 PROFESSIONAL LAND SURVEYOR
 3-3-94
 APPROVAL DATE

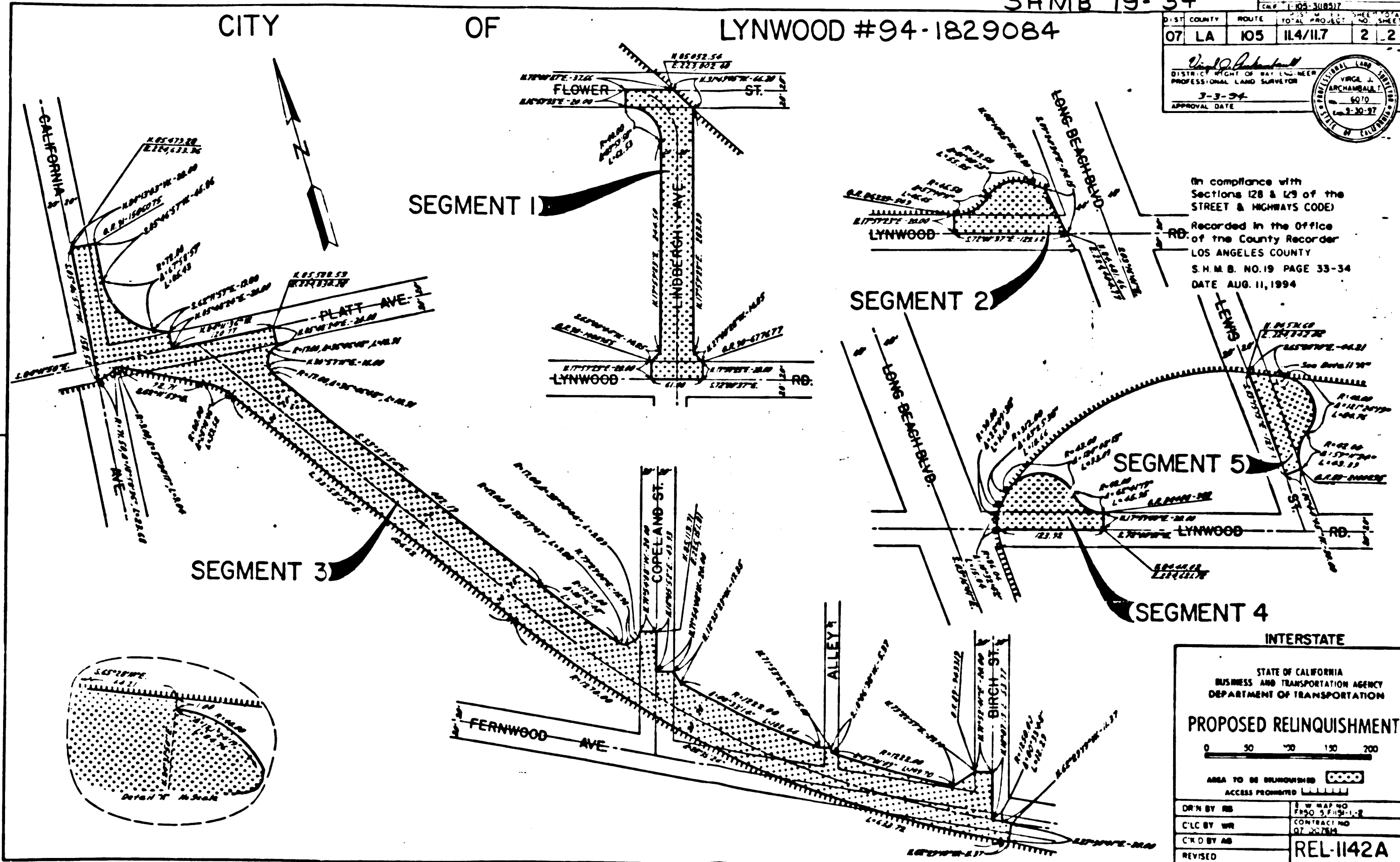

In compliance with Sections 128 & 129 of the STREET & HIGHWAYS CODE
 Recorded in the Office of the County Recorder LOS ANGELES COUNTY S.H.M.B. NO. 19 PAGE 33-34 DATE AUG. 11, 1994

STATE OF CALIFORNIA
 BUSINESS AND TRANSPORTATION AGENCY
 DEPARTMENT OF TRANSPORTATION

PROPOSED RELINQUISHMENT

0 50 100 150 200

AREA TO BE RELINQUISHED

ACCESS PROVIDED

DRN BY	MR	D W HAY	NO
CLC BY	MR	TRUDY J. ...	DATE
CR'D BY	MR
REVISED		REL-1142A	

WS 32-A-2