

STATE OF CALIFORNIA
 BUSINESS AND TRANSPORTATION AGENCY
 DEPARTMENT OF TRANSPORTATION

RIGHT OF WAY MAPS OF
 STATE HIGHWAY

In the City of Lynwood, along Rte. 105,
 from State Street to 4th Avenue

STATE	CALIF.		PROJECT NO.	T-105-3(185)7	
DIST. COUNTY	ROUTE	TOTAL PROJECT	SHEET NO.	SHEETS	
07 LA	105	11.0/12.9	1	2	

Virgil J. Archambault
 PROFESSIONAL LAND SURVEYOR
 No. S. 9070
 Exp. 9-30-97

APPROVAL DATE: 2-13-95

96-359209
 96-359209
 FILED
 AT REQUEST OF
 DEPT. OF PUBLIC WORKS
 MAR 6 1996
 01 PM 11 4 AM
 IN BOOK 19
 AT PAGE 54-55
 REGISTERED COUNTY CLERK
 COUNTY OF LOS ANGELES

(In compliance with
 Sections 128 & 129 of the
 STREET & HIGHWAYS CODE)
 Recorded in the Office
 of the County Recorder
 COUNTY
 S. H. M. B. No. Pg.

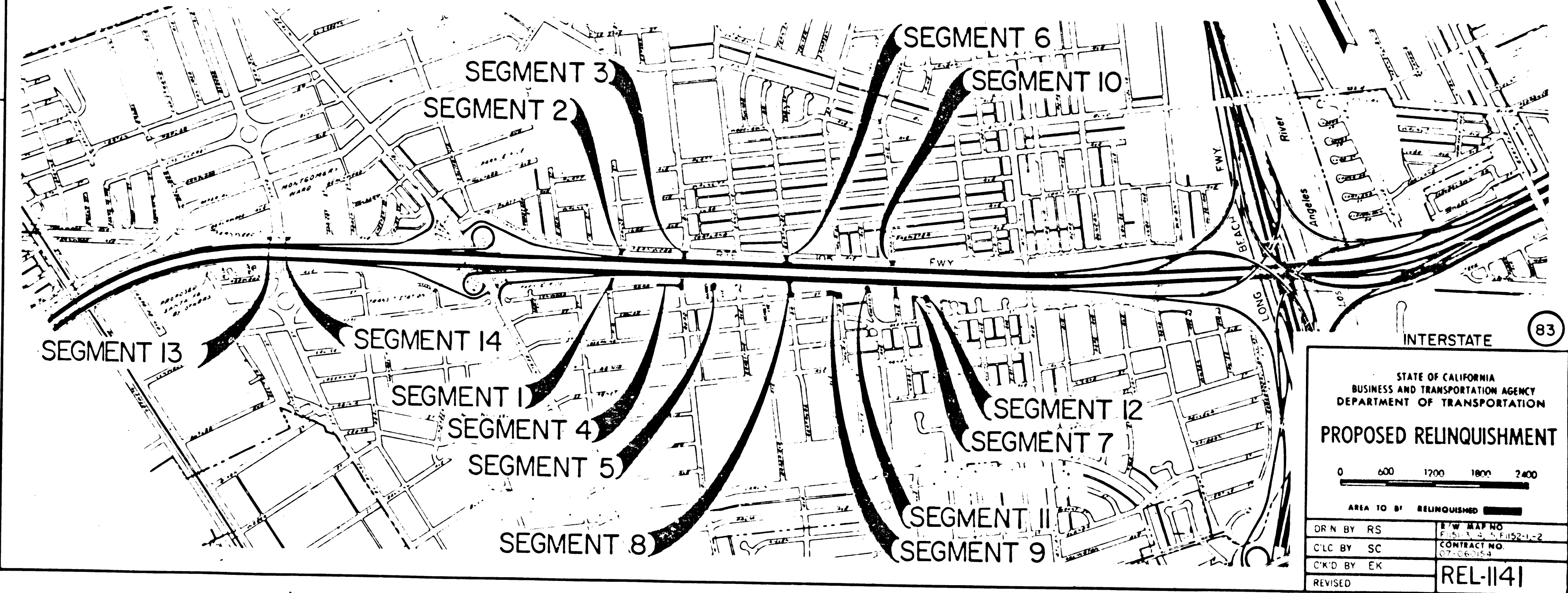

STATE OF CALIFORNIA
 BUSINESS AND TRANSPORTATION AGENCY
 DEPARTMENT OF TRANSPORTATION

PROPOSED RELINQUISHMENT

0 600 1200 1800 2400

AREA TO BE RELINQUISHED

DR N BY RS	R/W MAP NO.
CLC BY SC	CONTRACT NO.
CK'D BY EK	07-660154
REVISED	REL-1141

R/W MASK R-1

BOOK 19 PAGE 54

CITY OF LYNWOOD

07	LA	105	110	12.9	2	2
----	----	-----	-----	------	---	---

Virgil J. Archambault
 DISTRICT REGISTERED PROFESSIONAL LAND SURVEYOR
 9-13-95
 APPROVAL DATE

VIRGIL J. ARCHAMBAULT
 No. 96070
 Exp. 2.12.97
 STATE OF CALIFORNIA

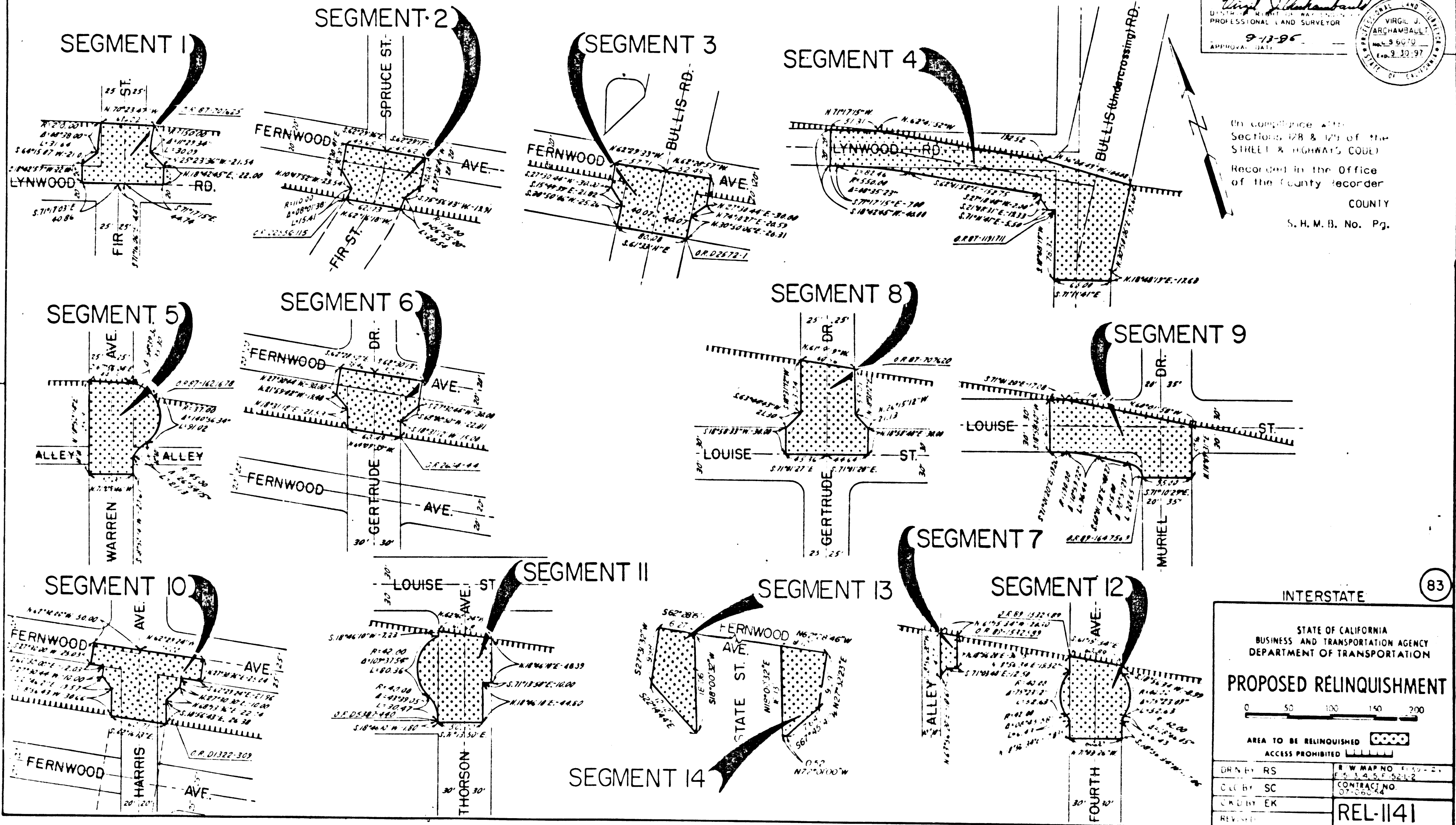

In compliance with Sections 128 & 129 of the STREET & HIGHWAYS CODE
 Recorded in the Office of the County Recorder
 COUNTY
 S. H. M. B. No. Pg.

INTERSTATE 83

STATE OF CALIFORNIA
 BUSINESS AND TRANSPORTATION AGENCY
 DEPARTMENT OF TRANSPORTATION

PROPOSED RELINQUISHMENT

0 50 100 150 200

AREA TO BE RELINQUISHED ACCESS PROHIBITED

DRN BY RS	E. W. MAP NO. 4-10-21
CLC BY SC	CONTRACT NO. 07-06042
CRD BY EK	REL-1141

BOOK 19 PAGE 55