

STATE OF CALIFORNIA  
 BUSINESS AND TRANSPORTATION AGENCY  
 DEPARTMENT OF TRANSPORTATION

RIGHT OF WAY MAPS OF  
 STATE HIGHWAY  
 IN THE CITY OF HAWTHORNE ALONG ROUTE 105 FREEWAY  
 BETWEEN HAWTHORNE BLVD AND YUKON AVE

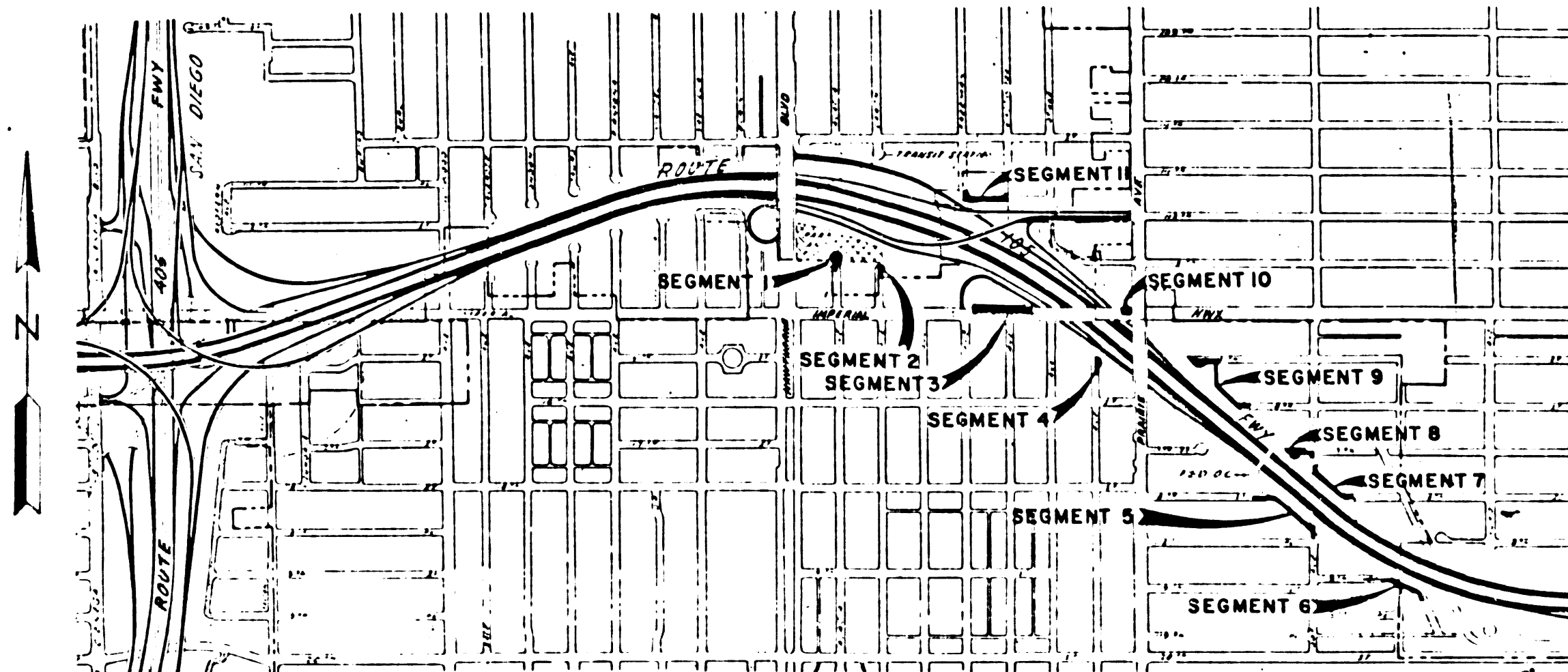

STATE TOTAL PROJ. NO.		EMP. I-105-3(31)2	
DIST.	COUNTY	ROUTE	POST MILES TOTAL PROJECT
07	LA	105	30/41
SHEET NO.		TOTAL SHEETS	
1		2	

*David J. Archambault*  
 DISTRICT ENGINEER  
 PROFESSIONAL LAND SURVEYOR  
 2-13-95  
 APPROVAL DATE

PROFESSIONAL LAND SURVEYOR  
 VINCE J. ARCHAMBAULT  
 No. 6070  
 Exp. 2-30-97  
 STATE OF CALIFORNIA

(In compliance with  
 Sections 128 & 129 of the  
 STREET & HIGHWAYS CODE)  
 Recorded in the Office  
 of the County Recorder  
 COUNTY  
 S. H. M. B. No. Pg.  
 DATE:

36-60666  
 36-650666

FILED  
 AT REQUEST OF  
 DEPT. OF PUBLIC WORKS  
 APR 25 1996  
 1  
 10 AM

IN BOOK 19  
 AT PAGE 59  
 OF STATE HIGHWAY MAPS  
 LOS ANGELES COUNTY, CA  
 Highway Recorder/County Clerk  
*[Signature]*  
 Date 4/25/96

STATE OF CALIFORNIA  
 BUSINESS AND TRANSPORTATION AGENCY  
 DEPARTMENT OF TRANSPORTATION

**PROPOSED RELINQUISHMENT**

0 50 100 150 200

AREA TO BE RELINQUISHED

DR'N BY RD.	R/W MAP NO. F-1144-1B F-1158-2, 3, 4, 8, 6, 7, U59-1, 3, 4
C'LC BY WR	CONTRACT NO. 060114
C'K'D BY	REL-1119A
REVISED	

BOOK 19 PAGE 59

CITY OF HAWTHORNE

STATE	FEDERAL PROJECT NO.
CALIF.	E-105-2 (3/1) 2
DIST. COUNTY	POST MILES
07 LA 105	30/4.1
TOTAL PROJECT	SHEET TOTAL
2	2

*Virgil J. Archambault*  
 VIRGIL J. ARCHAMBAULT  
 PROFESSIONAL LAND SURVEYOR  
 No. 6070  
 Exp. 9-30-97  
 APPROVAL DATE: 8-13-95

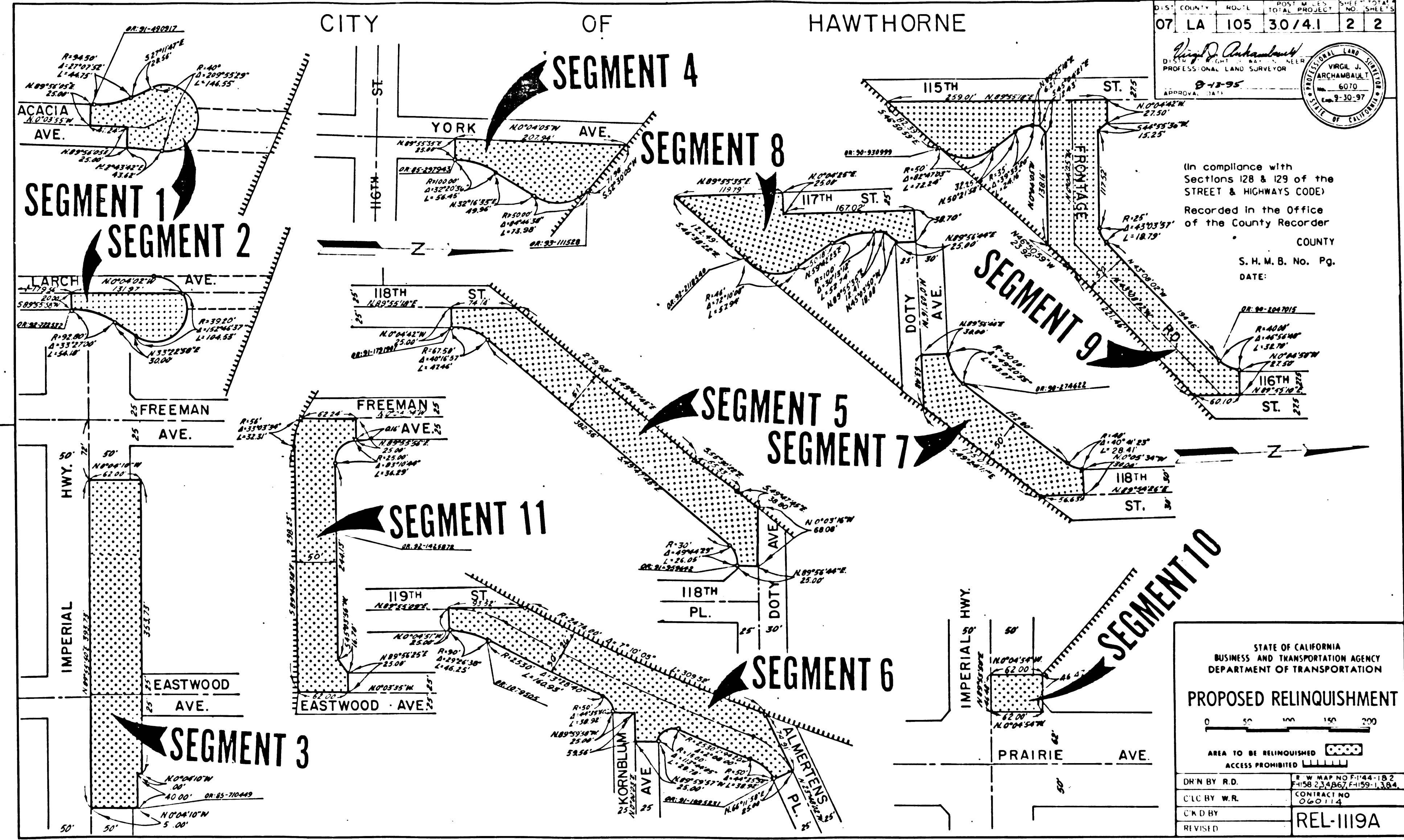

(In compliance with Sections 128 & 129 of the STREET & HIGHWAYS CODE)  
 Recorded in the Office of the County Recorder  
 COUNTY  
 S. H. M. B. No. Pg.  
 DATE:

STATE OF CALIFORNIA  
 BUSINESS AND TRANSPORTATION AGENCY  
 DEPARTMENT OF TRANSPORTATION

**PROPOSED RELINQUISHMENT**

0 50 100 150 200

AREA TO BE RELINQUISHED ACCESS PROHIBITED

D'R'N BY R.D.	R/W MAP NO F-144-182
C'LC BY W.R.	F-158 234867 F-159-1384
C'K'D BY	CONTRACT NO 060-114
REVISED	REL-1119A

BOOK 19 PAGE 20