

COUNTY OF LOS ANGELES

STATE CALIF.	FEDERAL PROJECT NO.	DIST.	COUNTY	ROUTE	POST MILES TOTAL PROJECT	SHEET NO.	TOTAL SHEETS
		07	LA	39	18.0 / 26.9	1	1

DISTRICT HIGHWAY ENGINEER
 PROFESSIONAL LAND SURVEYOR
 5-20-1996
 PLAN APPROVAL DATE

JOHN M. BASAM
 No. 1 682
 Exp. 9-30-96
 PROFESSIONAL LAND SURVEYOR
 STATE OF CALIFORNIA

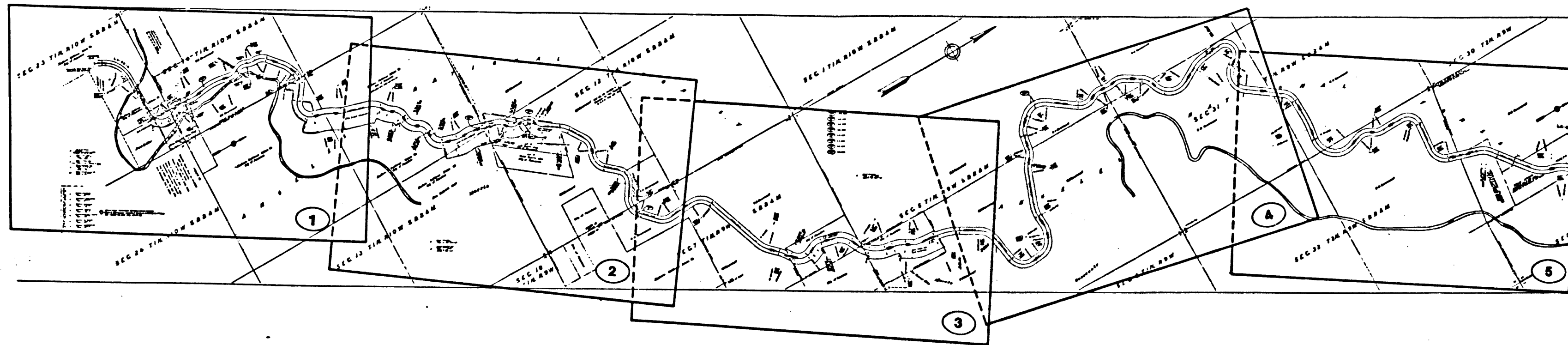

**INDEX MAP
ANGELES NATIONAL FOREST**

- 1 25955C-1
- 2 25955C-2
- 3 25955C-3
- 4 25955C-4
- 5 25955C-5
- 6 25955C-6
- 7 25955C-7

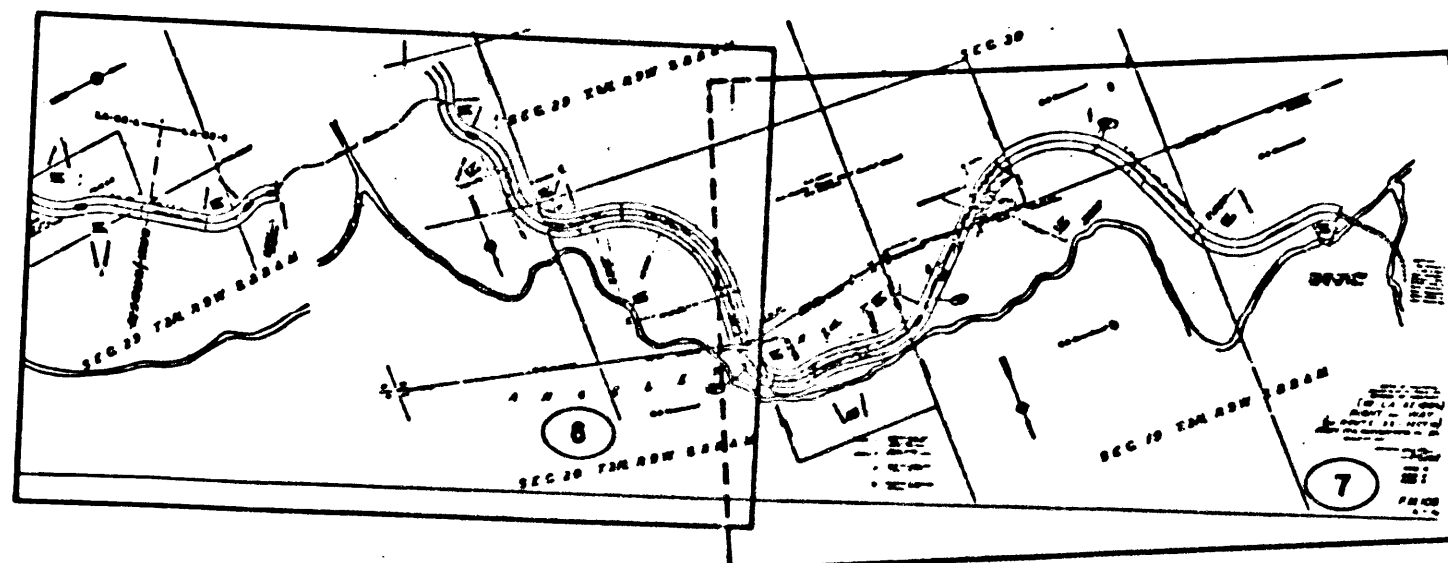

(IN COMPLIANCE WITH SECTIONS 128 & 129
 OF THE STREETS AND HIGHWAYS CODE)
 FILED FOR RECORD IN THE OFFICE OF
 COUNTY RECORDER
 LOS ANGELES COUNTY
 STATE HIGHWAY MAP BOOK NO.
 PAGE DATE:

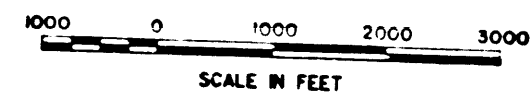

LEGEND

- R/W THROUGH NATIONAL FOREST LAND
- BOUNDARY OF NATIONAL FOREST LAND
- MONUMENT-EXISTING AS DESCRIBED

THIS MAP AND BASIS OF BEARINGS WAS PREPARED FROM
 LOS ANGELES COUNTY SURVEYORS MAP NO. F.M. 10850, ON
 FILE IN THE OFFICE OF LOS ANGELES COUNTY, DEPARTMENT
 OF PUBLIC WORKS IN THE CITY OF ALHAMBRA, IN SAID COUNTY
 ALL DISTANCES SHOWN ARE GROUND DISTANCES, GRID
 DISTANCE IS DETERMINED BY ELEVATION AND LOCATION.

STATE OF CALIFORNIA
 BUSINESS AND TRANSPORTATION AGENCY
 DEPARTMENT OF TRANSPORTATION

MAPS SHOWING NATIONAL FOREST LANDS, A PORTION OF THE
 ANGELES NATIONAL FOREST THROUGH WHICH STATE HIGHWAY ROUTE 39
 POST MILES 18.0 / 26.9, LOS ANGELES COUNTY, PASSES AND
 THROUGH WHICH A STATE HIGHWAY RIGHT OF WAY OF VARIOUS WIDTHS
 IS REQUESTED IN CONFORMITY WITH THE PROVISIONS OF THE FEDERAL
 HIGHWAY ACT OF 1958 (23 USC-317). THROUGH A PORTION OF
 SECTIONS 12 AND 14 OF TOWNSHIP 1 NORTH, RANGE 10 WEST,
 AND SECTIONS 6 AND 7 OF TOWNSHIP 1 NORTH, RANGE 9 WEST,
 AND SECTIONS 19, 20, 29, 30, 31 AND 32, TOWNSHIP 2 NORTH,
 RANGE 9 WEST, ALL OF SAN BERNARDINO MERIDIAN.

96-958213
 96-958213

JUN 18 1996

FILED
 AT REQUEST OF
 DEPT. OF PUBLIC WORKS
 41 JUN 21 PM
 19
 AT PAGE 66
 OF STATE HIGHWAY MAPS
 LOS ANGELES COUNTY, CA
 Registrar-Recorder/County Clerk
 M. Sison

PROJECT ENGINEER DATE DESIGN ENGINEER DATE APPROVAL RECOMMENDED BY DATE