

97-1573672
97-1573672

FILED
AT REQUEST OF
DEPT. OF PUBLIC WORKS
OCT 28 1997
OCT 28 11 P.M.
IN BOOK 19
AT PAGE 91
OF STATE HIGHWAY MAPS
FOR LOS ANGELES COUNTY, CA
REGISTERED RECORDER/COUNTY CLERK
BY S. J. [Signature]
COUNTY CLERK

STATE OF CALIFORNIA
BUSINESS AND TRANSPORTATION AGENCY
DEPARTMENT OF TRANSPORTATION

STATE	FEDERAL PROJECT NO.	DIST	COUNTY	ROUTE	POST MILES	SHEET NO.	TOTAL SHEETS
CALIF		07	LA	105	0.072, 38 5.937, 44	1	2

[Signature]
May 14, 1997

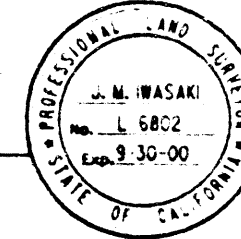

RIGHT OF WAY MAPS OF
STATE HIGHWAY
IN THE CITY OF LOS ANGELES ALONG (RTE 105) MANCHESTER AVENUE
FROM LINCOLN BOULEVARD TO THE WESTERLY CITY LIMITS OF
THE CITY OF INGLEWOOD (WESTERLY RAILROAD R/W) AND BETWEEN THE EASTERLY
CITY LIMITS OF THE CITY OF INGLEWOOD (EAST OF VAN NESS AVENUE)
TO THE WESTERLY LIMITS OF THE COUNTY OF LOS ANGELES

(IN COMPLIANCE WITH SECTION 128 & 129
OF THE STREET AND HIGHWAY CODE)
FILED FOR RECORD IN THE OFFICE OF COUNTY
RECORDER OF LOS ANGELES COUNTY
STATE HIGHWAY MAP BOOK NO. PAGE
DATE



STATE'S RIGHTS ARE NOT EXTINGUISHED
UNTIL RECORDATION OF RELATED CALIFORNIA
TRANSPORTATION COMMISSION RESOLUTION

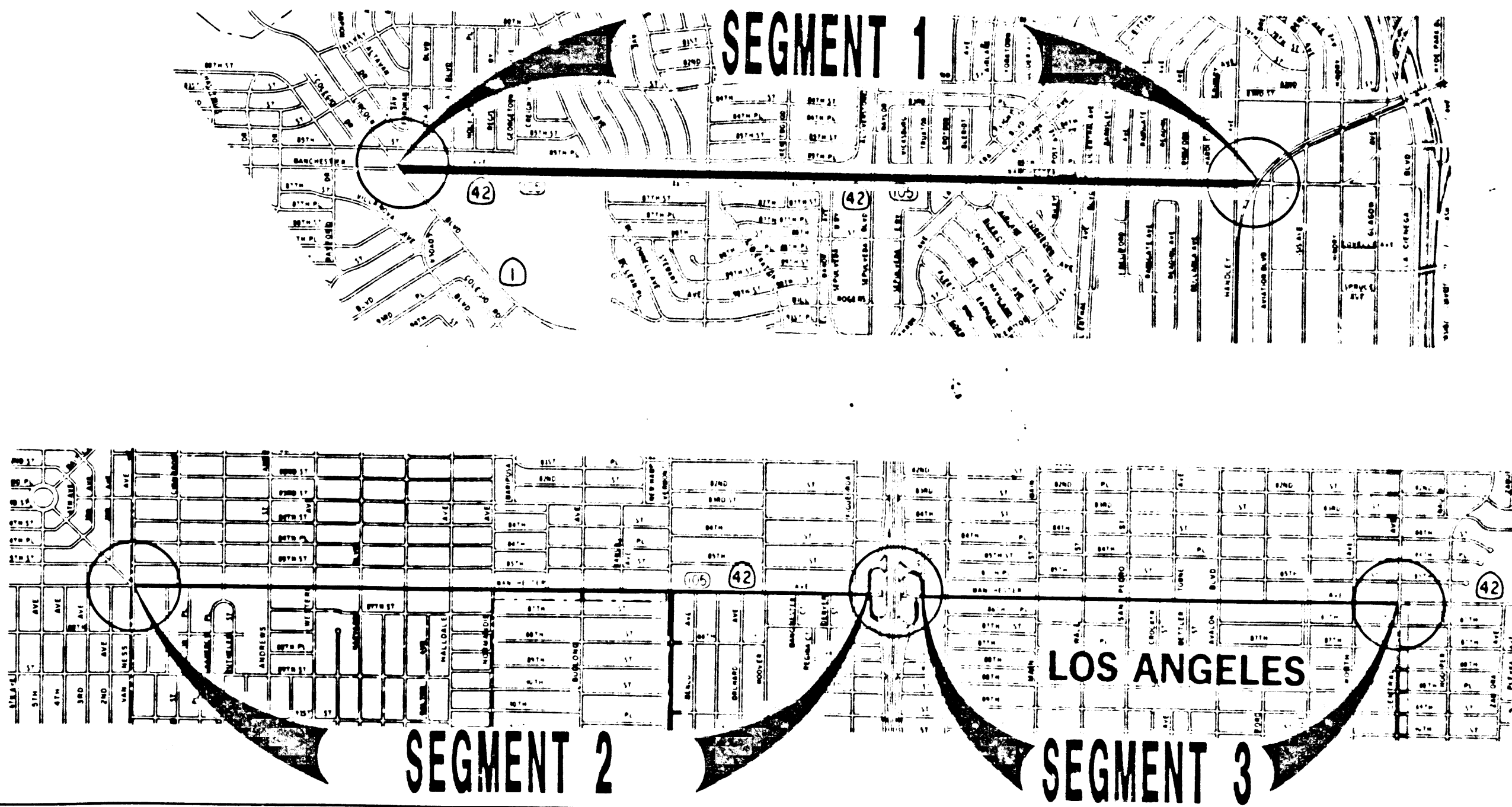

STATE OF CALIFORNIA
BUSINESS, TRANSPORTATION AND HOUSING AGENCY
DEPARTMENT OF TRANSPORTATION

PROPOSED RELINQUISHMENT

0 1000 2000 3000 4000
AREA TO BE RELINQUISHED [Shaded Area]
ACCESS PROHIBITED [Dashed Line]

DR'N BY	RD	R/W MAP NO. P. 4122
C'LC BY	AG	P. 434 P. 4197 P. 498
C'K'D BY	AG	CONTRACT NO. 065584
REVISED		REL- 1177A

CITY OF LOS ANGELES

STATE CALIF.	FEDERAL PROJECT NO.	DIST	COUNTY	ROUTE	POST MILES	SHEET NO.	TOTAL SHEETS
		07	LA	105	0.0/2.38 5.93/9.44	2	2

J. M. Masaki
 PROFESSIONAL LAND SURVEYOR
 May 14, 1997

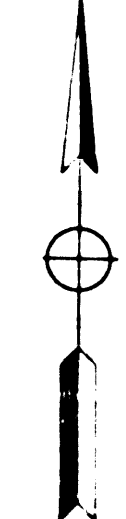
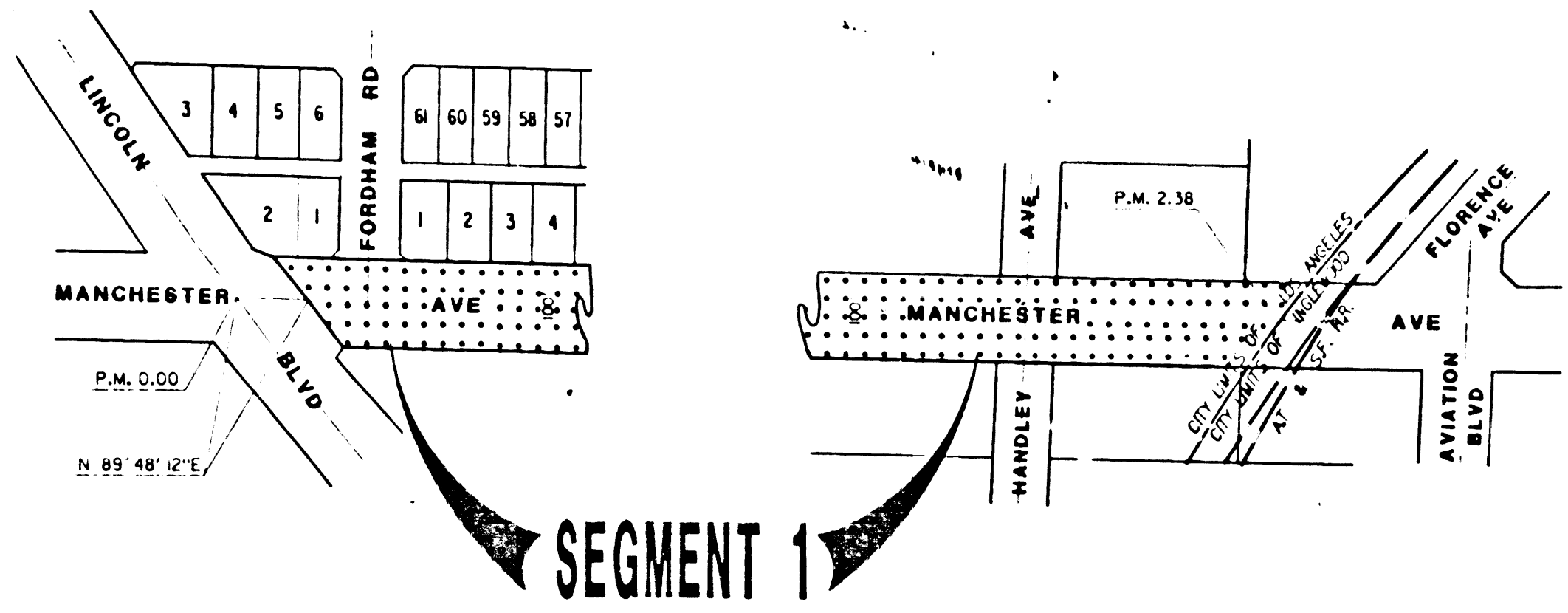
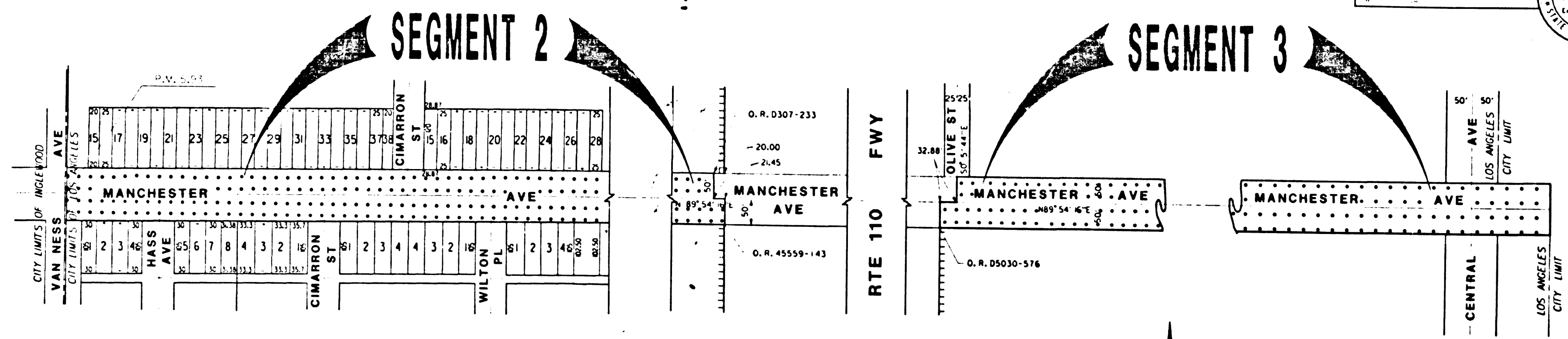
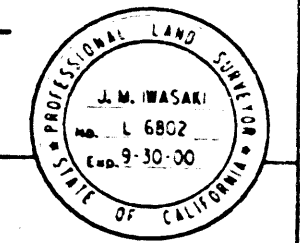

(IN COMPLIANCE WITH SECTION 128 & 129 OF THE STREET AND HIGHWAY CODE)
 FILED FOR RECORD IN THE OFFICE OF COUNTY RECORDER OF LOS ANGELES COUNTY
 STATE HIGHWAY MAP BOOK NO. PAGE DATE
 STATE'S RIGHTS ARE NOT EXTINGUISHED UNTIL RECORDATION OF RELATED CALIFORNIA TRANSPORTATION COMMISSION RESOLUTION

STATE OF CALIFORNIA
 BUSINESS, TRANSPORTATION AND HOUSING AGENCY
 DEPARTMENT OF TRANSPORTATION

PROPOSED RELINQUISHMENT

0 100 200 300 400

AREA TO BE RELINQUISHED

ACCESS PROHIBITED

DR'N BY	MG	R/W MAP NO. P 4122 P. 4.34 P. 4.97 P. 4.98
C/LC BY	WR	CONTRACT NO. 065584
C/K'D BY	AG	
REVISED		

REL- 1177A