

FILED  
AT REC'D ST OF  
DEPT OF PUBLIC WORKS  
21 JUN 2 1998  
MORNING 20  
AT 10:00 AM  
OF THE COUNTY OF TORRANCE  
REGISTERED PROFESSIONAL LAND SURVEYOR  
J. M. WASAKI

SS 1204306  
75-7209306

JUL 15 1998

STATE OF CALIFORNIA  
BUSINESS AND TRANSPORTATION AGENCY  
**DEPARTMENT OF TRANSPORTATION**

RIGHT OF WAY MAPS OF  
**STATE HIGHWAY**  
IN THE CITY OF TORRANCE ALONG ARTESIA BOULEVARD (ROUTE 91)  
BETWEEN HAWTHORNE BOULEVARD (WEST CITY LIMITS)  
AND WESTERN AVENUE (EAST CITY LIMITS)

STATE	FEDERAL PROJECT NO.	DIST	COUNTY	ROUTE	POST MILES	SHEET NO.	TOTAL SHEETS
CALIF.		07	LA	91	2.47/4.97	1	1

J. M. WASAKI  
DISTRICT RIGHT OF WAY ENGINEER  
PROFESSIONAL LAND SURVEYOR  
June 2, 1998  
APPROVAL DATE

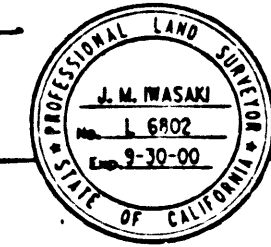

IN COMPLIANCE WITH SECTION 128 & 129  
OF THE STREET AND HIGHWAY CODE

STATE'S RIGHTS ARE NOT EXTINGUISHED UNTIL  
RECORDATION OF RELATED CALIFORNIA  
TRANSPORTATION COMMISSION RESOLUTION

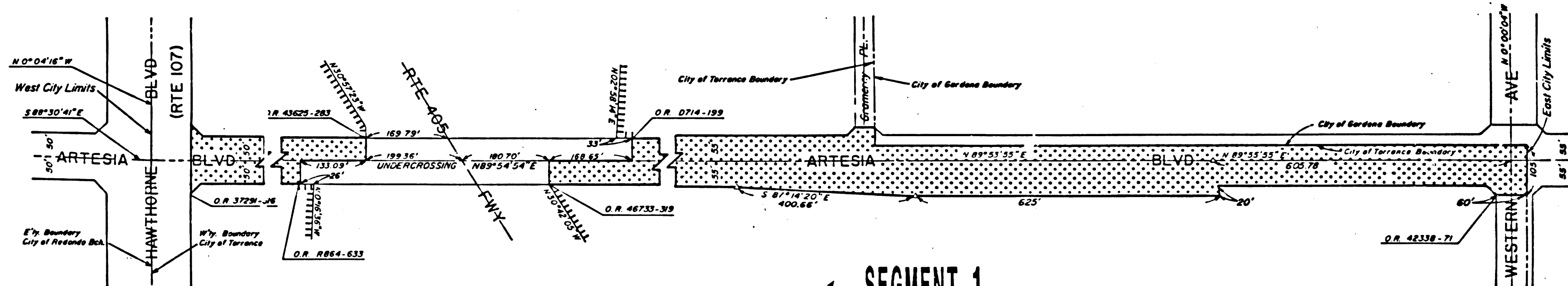

**SEGMENT 1**

**SEGMENT 2**

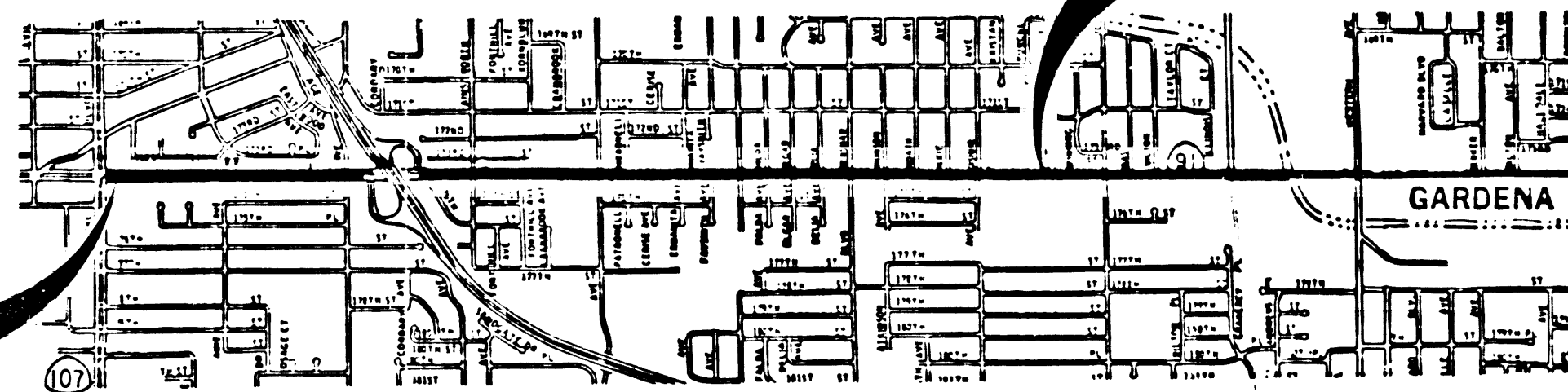

STATE OF CALIFORNIA  
BUSINESS AND TRANSPORTATION AGENCY  
DEPARTMENT OF TRANSPORTATION

**PROPOSED RELINQUISHMENT**

0 50 100 150 200

AREA TO BE RELINQUISHED [Pattern]

ACCESS PROHIBITED [Pattern]

DR'N BY	R/W MAP NO. P2 8739
C'LC BY	CONTRACT NO.
C'K'D BY	<b>REL 1198D</b>
REVISED	