

STATE OF CALIFORNIA
 BUSINESS AND TRANSPORTATION AGENCY
DEPARTMENT OF TRANSPORTATION

RIGHT OF WAY MAPS OF
STATE HIGHWAY
 IN THE CITY OF WEST HOLLYWOOD, ALONG SANTA MONICA
 BLVD, FROM DOHENY DR. TO EAST CITY LIMITS

STATE	FEDERAL PROJECT NO.	DIST	COUNTY	ROUTE	POST MILES	SHEET NO.	TOTAL SHEETS
CALIF.		07	L.A.	2	7.7/10.6	1	1

J. M. Masaki
 PROFESSIONAL LAND SURVEYOR
 December 17, 1998

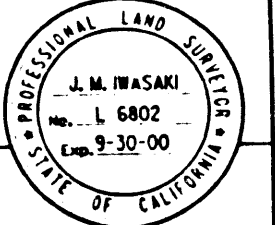

(IN COMPLIANCE WITH SECTION 128 & 129
 OF THE STREET AND HIGHWAY CODE)

STATE'S RIGHTS ARE NOT EXTINGUISHED UNTIL
 RECORDATION OF RELATED CALIFORNIA
 TRANSPORTATION COMMISSION RESOLUTION

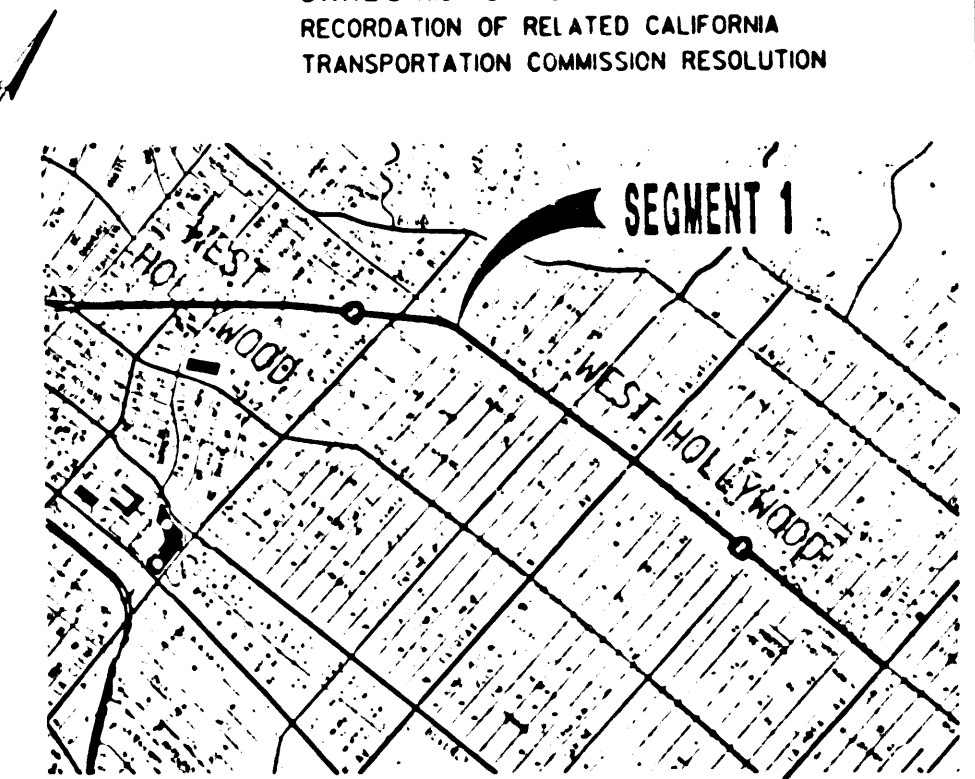
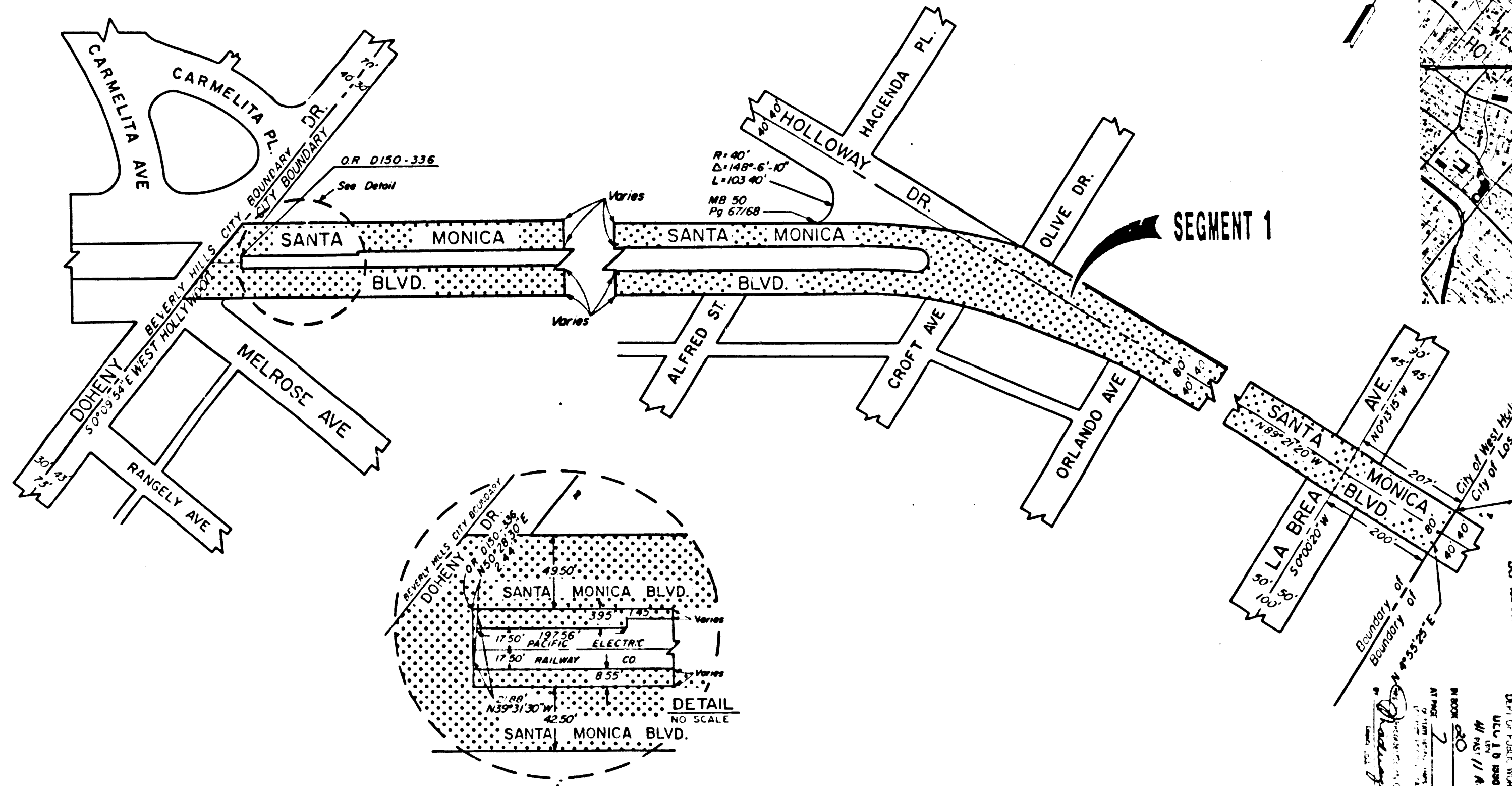

AREA TO BE RELINQUISHED
 NO SCALE

FILED FOR RECORD IN THE OFFICE OF COUNTY
 RECORDER OF LOS ANGELES COUNTY

STATE HIGHWAY MAP BOOK NO. PAGE
 DATE

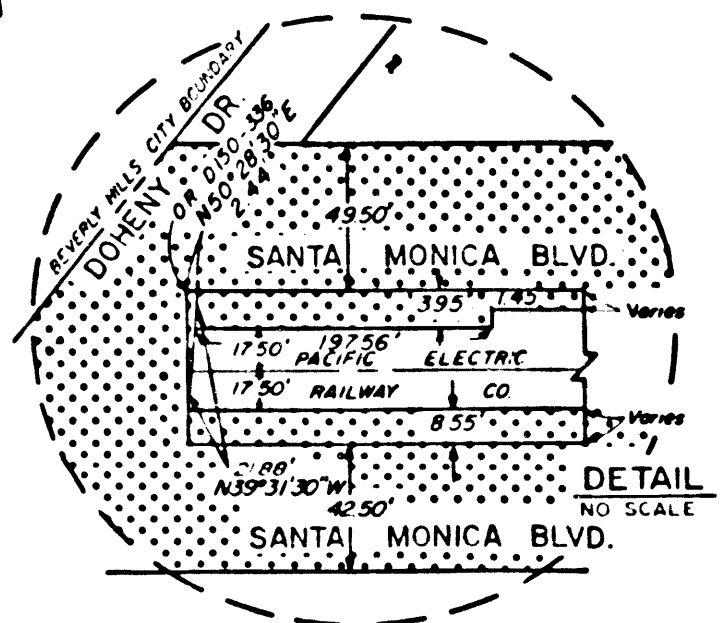

DETAIL
 NO SCALE

STATE OF CALIFORNIA
 BUSINESS, TRANSPORTATION AND HOUSING AGENCY
 DEPARTMENT OF TRANSPORTATION

PROPOSED RELINQUISHMENT

0 100 200 300 400

AREA TO BE RELINQUISHED
 ACCESS PROHIBITED

DR'N BY	PD	R/W MAP NO. P26197-C
C'LC BY	AG	CONTRACT NO.
C'K'D BY	AG	REL-1189
REVISED		

FILED
 DEPT. OF PUBLIC WORKS
 41 AUG 11 A.M.
 1998