

NOTE:
 Use sewer joint compound for all pipe joints.
 Use 2' x 2' safety and noiseless manhole frames and covers.
 Use 15" double strength pipe from station 0+00 to station 7+11. Balance to be standard.
 Resurface trench within paved areas with the same kind and quality of material removed.
 Excavate sewer under track in Garfield Ave. as shown per L.A. County detail S-a-c.
 Contractor shall obtain permit to excavate in county streets.

NOTE:
 Grades to which this improvement is to be constructed are shown on plans and profile.
 At all points between designated points the grade shall be established so as to conform to a straight line drawn between said designated points.
 Elevations are in feet above U.S.G.S. Datum or mean sea level.
 This drawing and the data hereon are hereby made a part of the specifications.
 Work shall be constructed according to specifications on file in the office of the county Engineer.

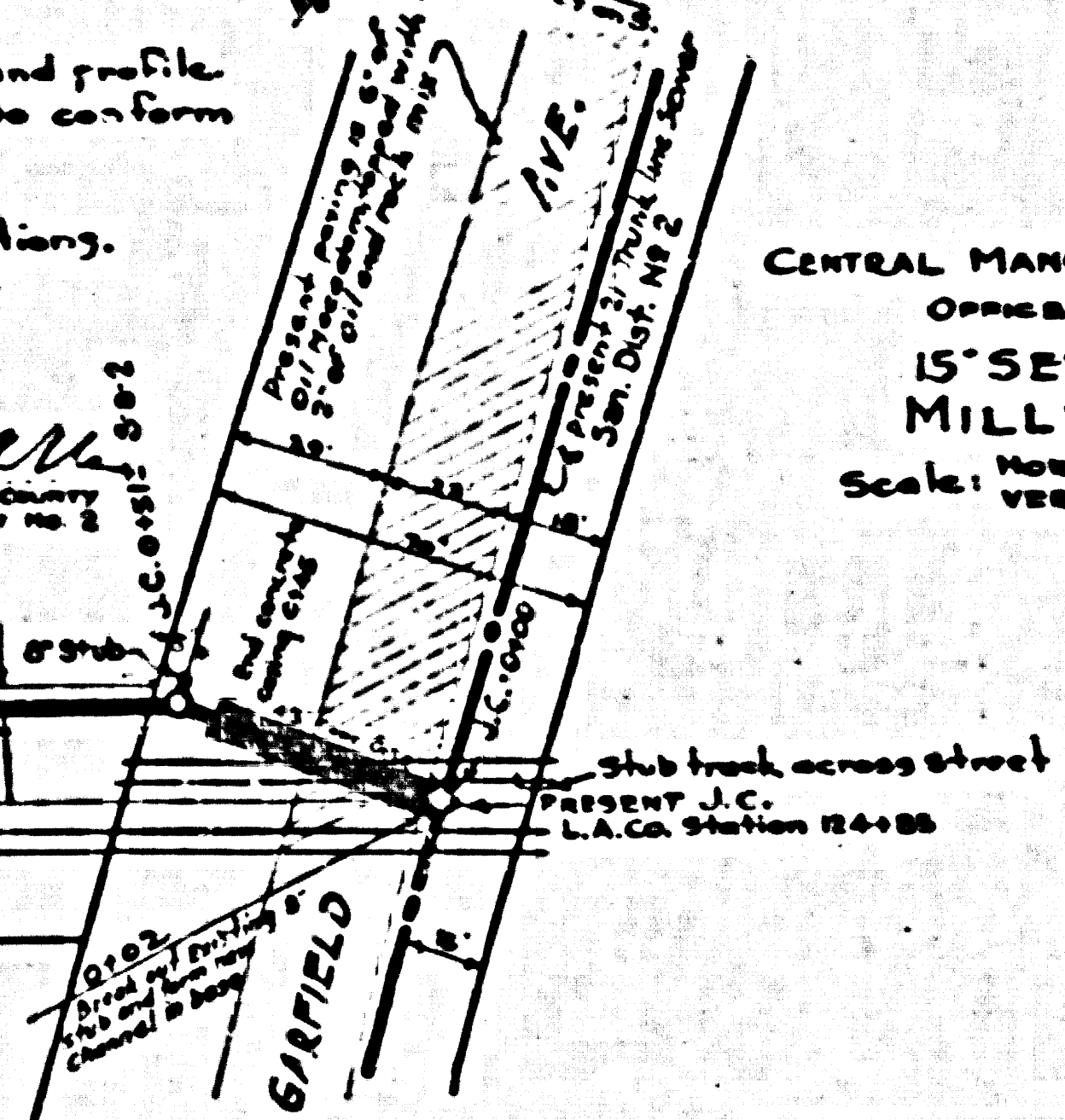
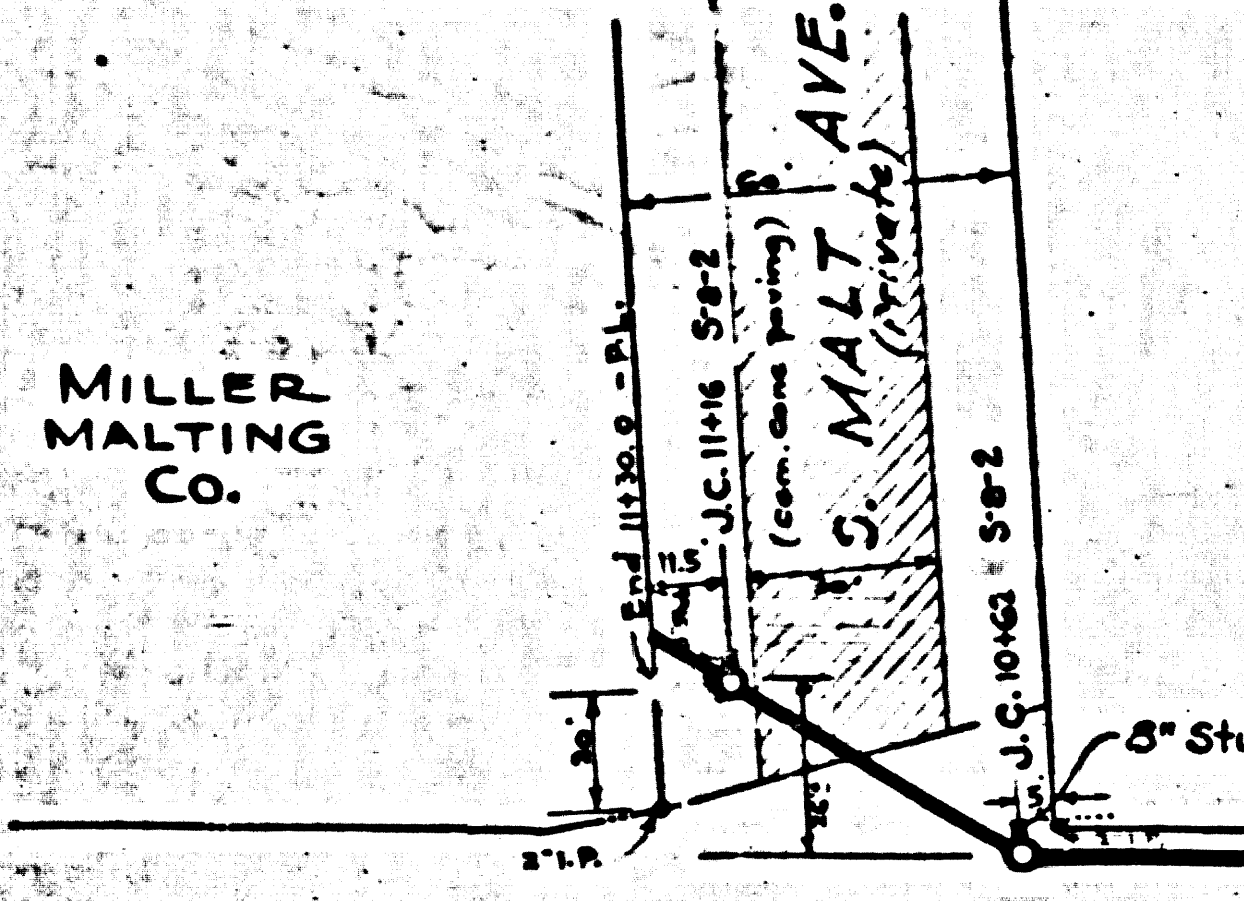

RANCHO SAN ANTONIO
 SEC 21-T2S-R12W-S.B.M.

COUNTY OF LOS ANGELES, CALIFORNIA.

APPROVED *[Signature]* APPROVED *[Signature]*
 COUNTY ENGINEER COUNTY ENGINEER OF COUNTY

CHECKED BY *[Signature]*
 COUNTY ENGINEER

CENTRAL MANUFACTURING DISTRICT, INC.
 OFFICE OF CHIEF ENGINEER
 15" SEWER TO SERVE
 MILLER MALTING CO.
 Scale: VERT 1"=4'
 JULY 25 1930

LOS ANGELES JUNCTION RY. R/W.

①

D 0 32