

EAST ROAD

MILTON ST

N.O. 1120 B

20

Lot No.	Dimensions	Notes
20	14+99.0 14+98.0	
21	16+100.3 16+100.0	
22	16+100.3 16+100.0	
23	16+100.3 16+100.0	
24	17+104.7 17+104.7	
25	17+104.7 17+104.7	
26	17+104.7 17+104.7	
27	17+104.7 17+104.7	
28	16+102.5 15+97.7	
29	16+102.5 15+97.7	
30	15+101.7 14+91.1	
31	14+99.0 14+98.0	
32	13+94.5 13+83.9	
33	13+94.5 13+83.9	
34	13+67.11 M.H. 13+94.5 13+83.9	
35	12+85.4 12+77.2	
36	11+80.5 11+80.5	
37	11+80.5 11+80.5	
38	11+80.5 11+80.5	
39	78.91 91.00 92.00	
40	91.00 92.00	
41	91.04 90.57	
42	91.04 90.57	
43	61.53 61.00	
44	61.53 61.00	
45	51.94.3 51.84.3	
46	51.94.3 51.84.3	
47	51.94.3 51.84.3	
48	51.94.3 51.84.3	
49	51.94.3 51.84.3	

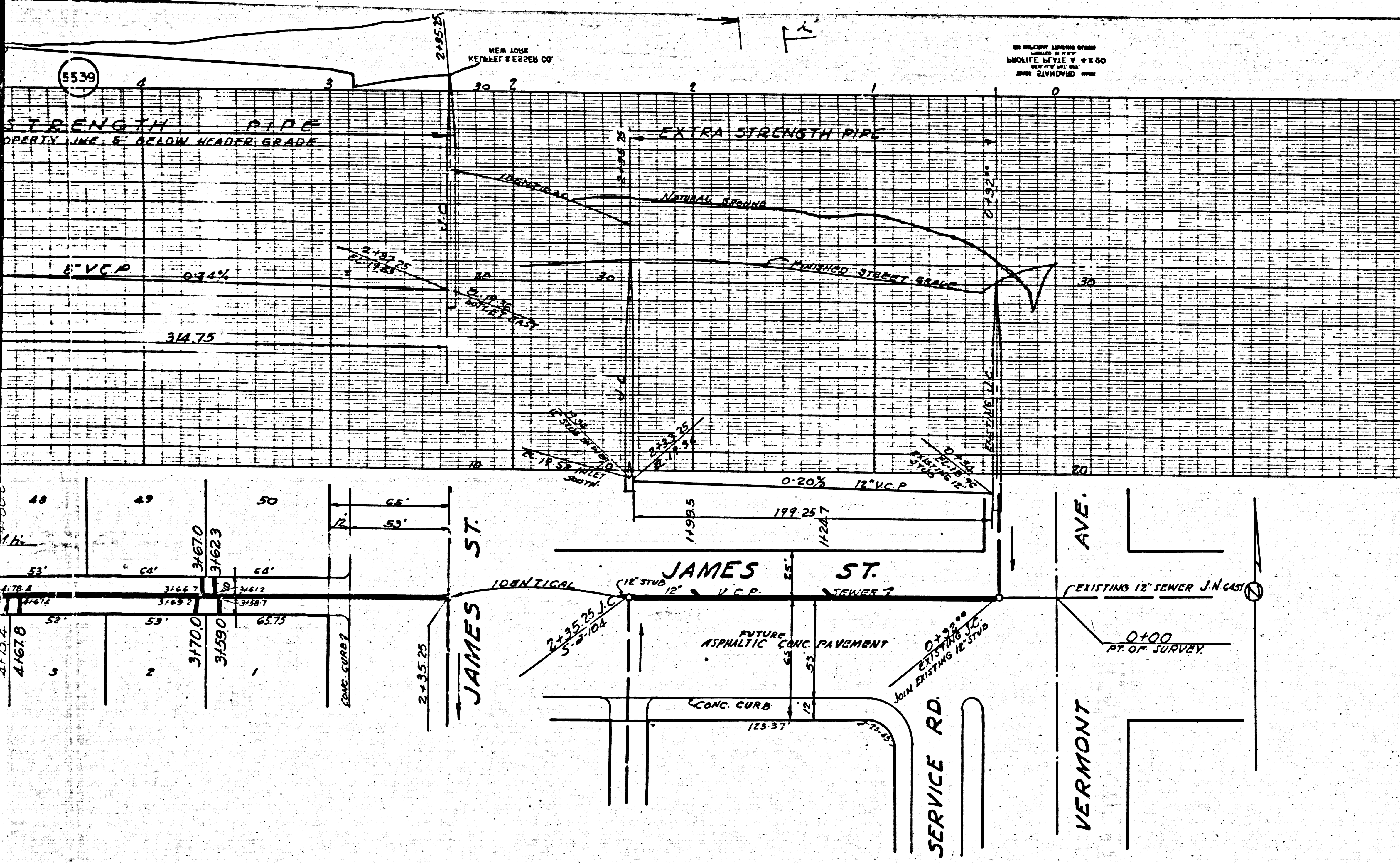

- NOTES
1. USE SPECIAL WOOD MANHOLE COVERS AND CONCRETE FRAME AS PER S-8-111
 2. USE STANDARD STRENGTH PIPE EXCEPT AS NOTED
 3. USE EXTRA STRENGTH PIPE FROM STA. 6+32 TO STA. 6+55
 4. WHERE FILLED FOUNDATION UNDER PIPE IS INADEQUATE PROVISION SHALL BE MADE TO SUPPORT PIPE
 5. Y.C. TO BE LAID HORIZONTAL AND HOUSE CONNECTIONS TO BE CONSTRUCTED WITH 1/4" RISE PER FOOT TO PROPERTY LINE EXCEPT AS NOTED
 6. USE CEMENT MORTAR FOR PIPE JOINTS

PROFILE, ALIGNMENT AND GRADE OF
SANITARY SEWERS
 TO BE CONSTRUCTED IN
JAMES ST.
 BETWEEN VERMONT AVE. AND WALNUT AVE.
FIRST ALLEY
 WEST OF VERMONT AVE.
 BETWEEN JAMES ST. & EAST ROAD

PRIVATE CONTRACT NO. 226
 W.S. 28

PREPARED IN THE OFFICE OF
 SEABOARD ENGINEERING CO.
 8825 OLYMPIC BLVD., BEVERLY HILLS CAL.
 BY: *Feb. H. Jachin*
 REG. C. E. NO. 5676

FOR LEGEND
 SEC. PLAN NO. S-2-C-64

NOTE:
 GRADES TO WHICH THIS IMPROVEMENT IS TO BE CONSTRUCTED ARE SHOWN ON PLANS AND PROFILE. GRADE POINTS FOR TOP OF CURB, CENTER LINE OF STREET OR CENTER LINE OF ALLEY ARE SHOWN BY CIRCLES ON PROFILES. AT ALL POINTS BETWEEN DESIGNATED POINTS THE GRADE SHALL BE ESTABLISHED SO AS TO CONFORM TO A STRAIGHT LINE BETWEEN DESIGNATED POINTS.
 ELEVATIONS ARE IN FEET ABOVE U.S. & S. DATUM OR MEAN SEA LEVEL.
 THIS DRAWING AND THE DATA HEREON ARE HEREBY MADE A PART OF THE SPECIFICATIONS.
 WORK SHALL BE CONSTRUCTED ACCORDING TO SPECIFICATIONS ON FILE IN THE OFFICE OF THE COUNTY ENGINEER, AND SHALL BE PROSECUTED ONLY IN THE PRESENCE OF THE COUNTY ENGINEER.
 BEFORE WORK CAN BE STARTED THE CONTRACTOR MUST OBTAIN A PERMIT TO EXCAVATE IN COUNTY STREETS FROM THE L.A. COUNTY BOARD DEPT. 104 HALL OF RECORDS AND MAKE A DEPOSIT WITH THE COUNTY ENGINEER, 100 UNION LEAGUE BUILDING, SUFFICIENT TO COVER THE COST OF CONSTRUCTION, INSPECTION AND RECORD PLANS.

COUNTY OF LOS ANGELES, CALIFORNIA

APPROVED: *[Signature]*
 CHIEF DEPUTY COUNTY ENGINEER

APPROVED: *[Signature]*
 CHIEF ENGINEER OF COUNTY
 SANITATION DISTRICT NO. 8

CHECKED BY: *N. Sherman* 1943
 OFFICE OF COUNTY ENGINEER, REG. C. E. 5353

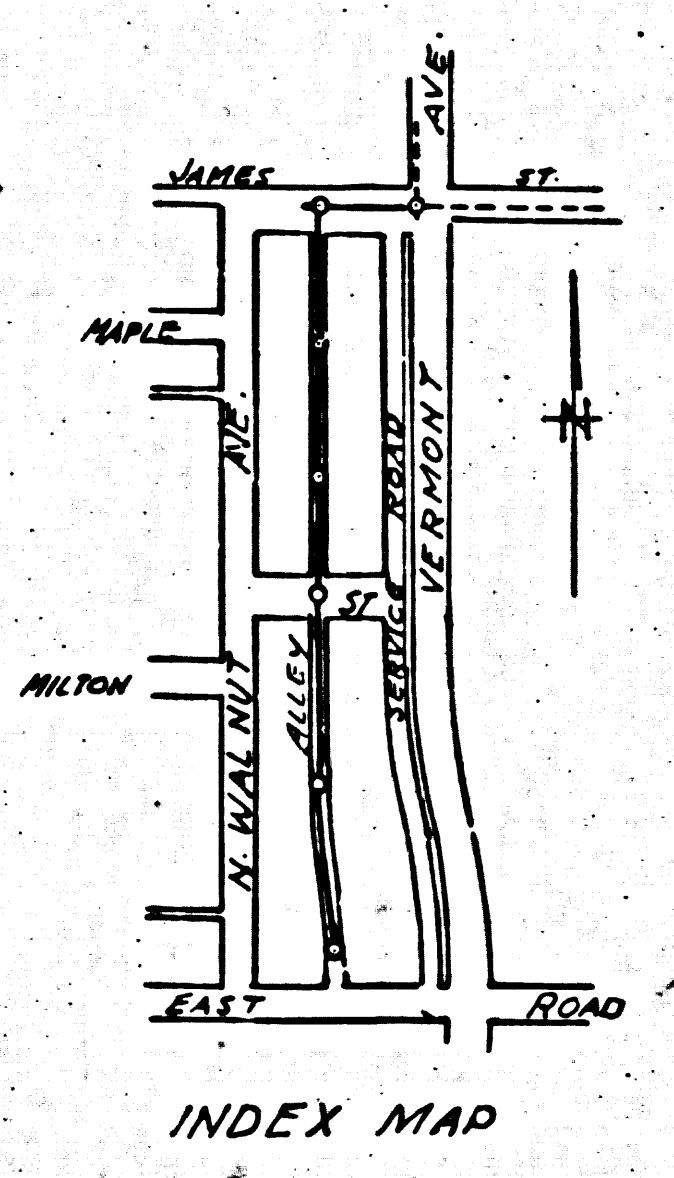

RECEIVED
 AUG 18 1943
 SANITATION DIVISION