

1. USE SPECIAL MANHOLE FRAME AND COVER (S-a-106)
2. USE EXTRA STRENGTH PIPE
3. USE CEMENT MORTAR FOR ALL PIPE JOINTS
4. RESURFACE ALL TRENCH WITHIN PAVED AREA TO MEET LOS ANGELES COUNTY ROAD DEPT. REQUIREMENTS
5. CONSTRUCT HOUSE CONNECTIONS WITH INVERT AT PROPERTY LINE .5 FEET BELOW CURB GRADE
6. ENCASE FOUR FEET OF SEWER AT POINTS OF INTERFERENCE WITH POLES AS PER S-6.

PROFILE ALIGNMENT AND GRADE OF
SANITARY SEWER
TO BE CONSTRUCTED IN
STRONG AVE.
 BETWEEN FIRST ALLEY SOUTH OF WASHINGTON BLVD. AND FIRST ALLEY NORTH OF WASHINGTON BLVD.
FIRST ALLEY SOUTH OF WASHINGTON BLVD.
 BETWEEN THE CENTER LINE OF STRONG AVE. AND A POINT 225 FEET EAST

PRIVATE CONTRACT NO. 228
 W.S. 36
 SHEET 1 OF 1 SHEET

SCALE: VERT. 1"=4'
 HORIZ. 1"=40'

PREPARED IN THE OFFICE OF
FREDERICK C. STILSON

BY *Frederick C. Stilson*
 REG. C.E. NO. 1670

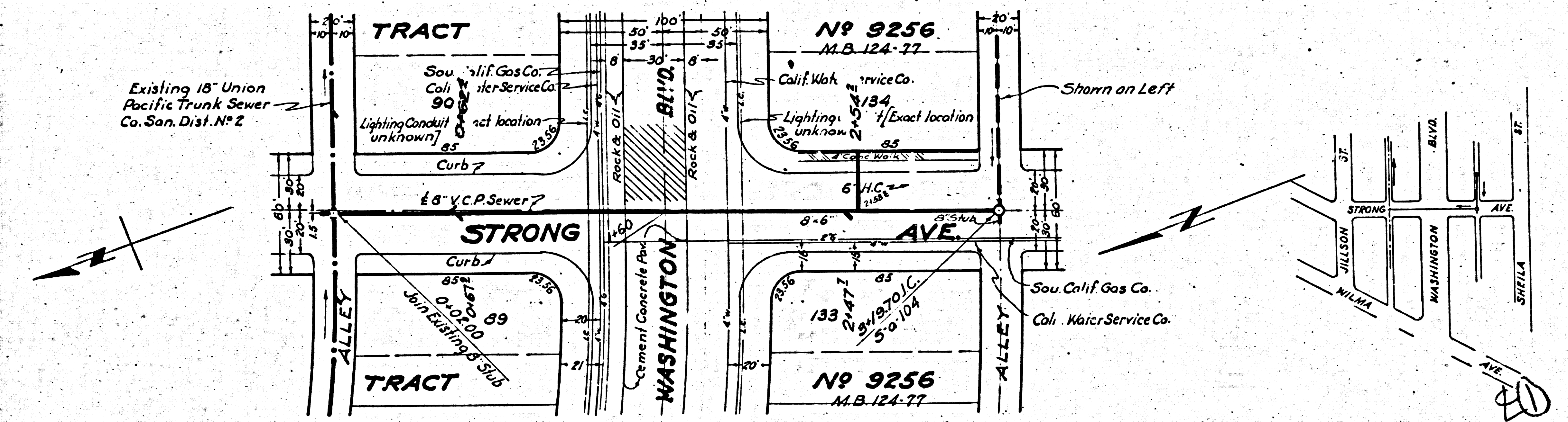

FOR LEGEND
 SEE PLAN NO. S-64

NOTE:
 GRADES TO WHICH THIS IMPROVEMENT IS TO BE CONSTRUCTED ARE SHOWN ON PLANS AND PROFILE. GRADE POINTS FOR TOP OF CURB, CENTER LINE OF STREET OR CENTER LINE OF ALLEY ARE SHOWN BY CIRCLES ON PROFILES. AT ALL POINTS BETWEEN DESIGNATED POINTS THE GRADE SHALL BE ESTABLISHED SO AS TO CONFORM TO A STRAIGHT LINE DRAWN BETWEEN SAID DESIGNATED POINTS.
 ELEVATIONS ARE IN FEET ABOVE U.S.S. DATUM OR MEAN SEA LEVEL.
 THIS DRAWING AND THE DATA HEREON ARE HEREBY MADE A PART OF THE SPECIFICATIONS.
 WORK SHALL BE CONSTRUCTED ACCORDING TO SPECIFICATIONS ON FILE IN THE OFFICE OF THE COUNTY ENGINEER AND SHALL BE PROSECUTED ONLY IN THE PRESENCE OF THE COUNTY ENGINEER.
 BEFORE WORK CAN BE STARTED, THE CONTRACTOR MUST OBTAIN A PERMIT TO EXCAVATE IN COUNTY STREETS FROM THE L.A. COUNTY ROAD DEPT., 104 HALL OF RECORDS, AND MAKE A DEPOSIT WITH THE COUNTY ENGINEER, 700 UNION LEAGUE BUILDING, SUFFICIENT TO COVER THE COST OF CONSTRUCTION INSPECTION AND RECORD PLANS.

COUNTY OF LOS ANGELES, CALIFORNIA.

APPROVED *Alfred J. ...*
 COUNTY ENGINEER

APPROVED *Frederick C. Stilson*
 CHIEF ENGINEER OF COUNTY
 SANITATION DISTRICT NO. 2

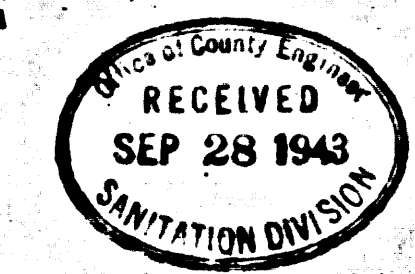

CHECKED BY *William H. ...*
 OFFICE OF COUNTY ENGINEER, REG. C.E. NO. 2193

RECEIVED

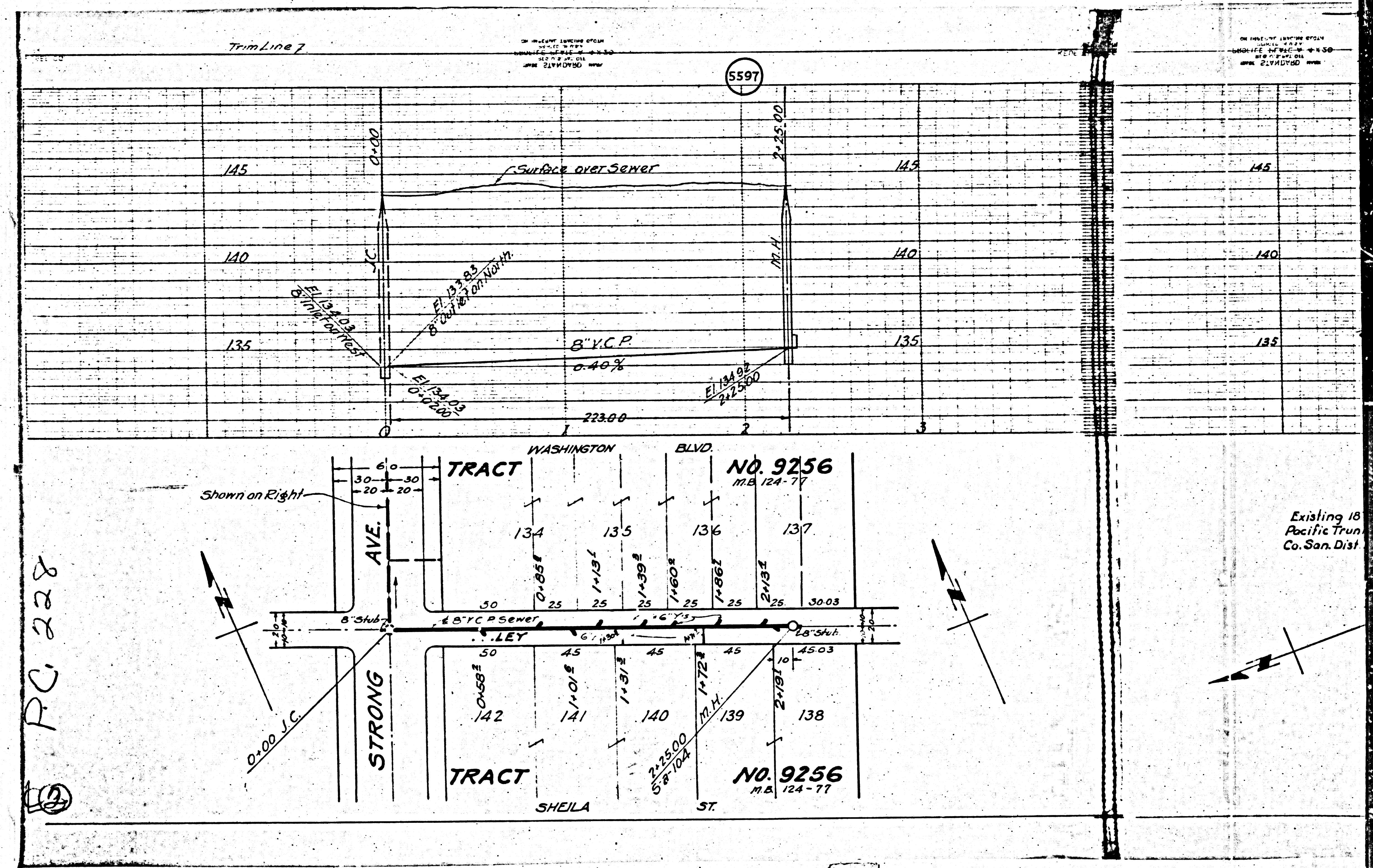

PC 228

Existing 18
Pacific Trun
Co. San. Dist