

1. USE "JUST-RITE" MANHOLE FRAMES AND COVERS
2. USE STANDARD STRENGTH PIPE
3. USE CEMENT MORTAR FOR ALL PIPE JOINTS
4. RESURFACE ALL TRENCH WITHIN PAVED AREA TO MEET LOS ANGELES COUNTY ROAD DEPT. OR STATE HIGHWAY REQUIREMENTS
5. CONSTRUCT HOUSE CONNECTIONS WITH INVERTS AT PROPERTY LINE FIVE FEET BELOW CURB GRADE
6. ENCASE FOUR FEET OF SEWER AT POINTS OF INTERFERENCE WITH POLES AS PER S-3-6

B.M. EL. 74.46 ROAD DEPT.
S.E. COR. ATLANTIC AVE. & POPPY ST.
LEAD & TAG IN CURB

PROFILE, ALIGNMENT AND GRADE OF
SANITARY SEWER
TO BE CONSTRUCTED IN
EUCLID AVE
BETWEEN ATLANTIC AVE AND STONEACRE ST.

PRIVATE CONTRACT NO. 231
WS. 32
ONE SHEET
SCALE: VERT. 1" = 4'
HORIZ. 1" = 40'
SEP 27 1943
PREPARED IN THE OFFICE OF
JONES & GILBERT

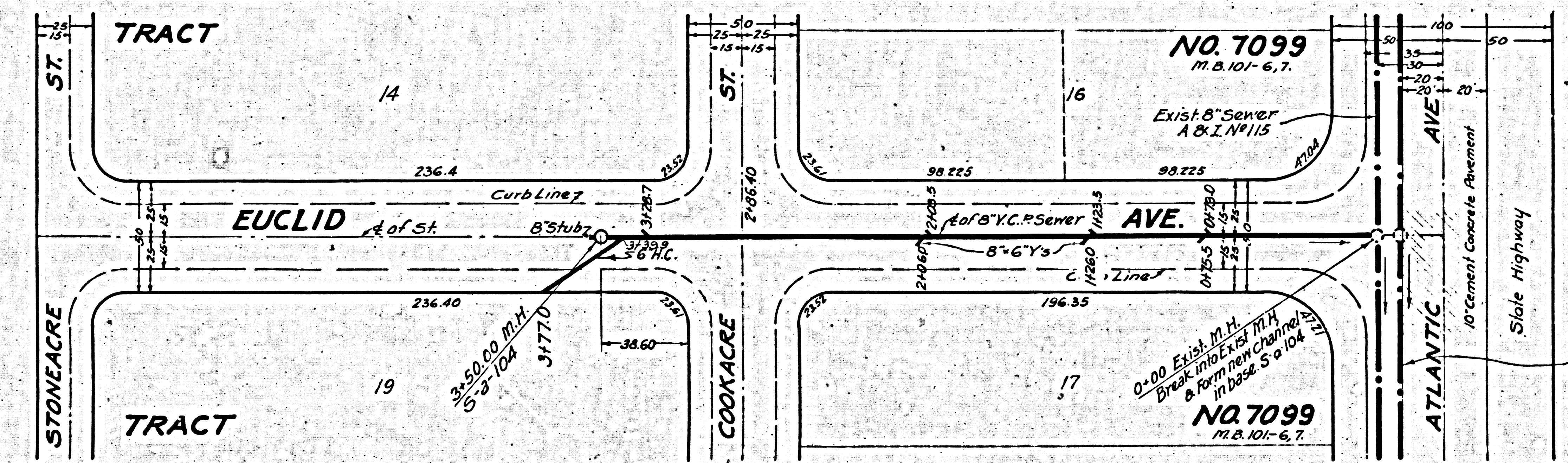

Exist. 36" Wright Road
Trunk Sewer San. Dist. No. 1.

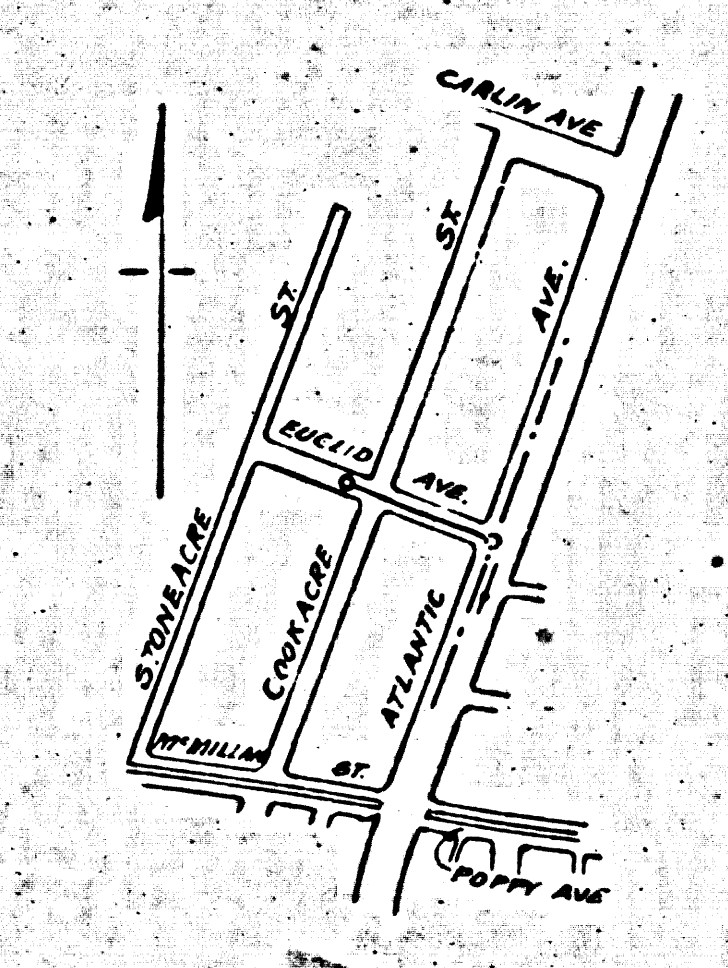

BY: *Harold G. Jones* REG. C.E. NO. 1797
FOR LEGEND SEE PLAN NO. 53-64

NOTE:
GRADES TO WHICH THIS IMPROVEMENT IS TO BE CONSTRUCTED ARE SHOWN ON THE PROFILE. GRADE POINTS FOR TOP OF CURB, CENTER LINE OF STREET OR CENTER LINE OF AVENUE ARE SHOWN BY CIRCLES ON PROFILES. AT ALL POINTS BETWEEN DESIGNATED POINTS THE GRADE SHALL BE ESTABLISHED SO AS TO CONFORM TO A STRAIGHT LINE DRAWN BETWEEN SAID DESIGNATED POINTS. ELEVATIONS ARE IN FEET ABOVE U. S. G. B. DATUM OR MEAN SEA LEVEL. THIS DRAWING AND THE DATA HEREON ARE HEREBY MADE A PART OF THE SPECIFICATIONS. WORK SHALL BE CONSTRUCTED ACCORDING TO SPECIFICATIONS ON FILE IN THE OFFICE OF THE COUNTY ENGINEER AND SHALL BE PROSECUTED ONLY IN THE PRESENCE OF THE COUNTY ENGINEER. BEFORE WORK CAN BE STARTED, THE CONTRACTOR MUST OBTAIN A PERMIT TO EXCAVATE IN COUNTY STREETS FROM THE L.A. COUNTY ROAD DEPT. 1108 HALL OF RECORDS, AND MAKE A DEPOSIT WITH THE COUNTY ENGINEER, 100 UNION LEAGUE BUILDING, SUFFICIENT TO COVER THE COST OF CONSTRUCTION INSPECTION AND RECORD PLANS. IF WORK IS TO BE DONE IN A STATE HIGHWAY A PERMIT MUST BE OBTAINED FROM THE STATE OF CALIFORNIA, DIVISION OF HIGHWAYS, 800 STATE BUILDING, AFTER MAKING THE DEPOSIT WITH THE COUNTY ENGINEER.

COUNTY OF LOS ANGELES, APPROVED, CALIFORNIA.
APPROVED *Alfred Jones* COUNTY ENGINEER
APPROVED *Harold G. Jones* ACTING CHIEF ENGINEER OF COUNTY SANITATION DISTRICT NO. 1

CHECKED BY *H. G. Jones* 9-27-43
OFFICE OF COUNTY ENGINEER, REG. C.E. NO. 3824