

Trim Prints to this line

Trim Prints to this line

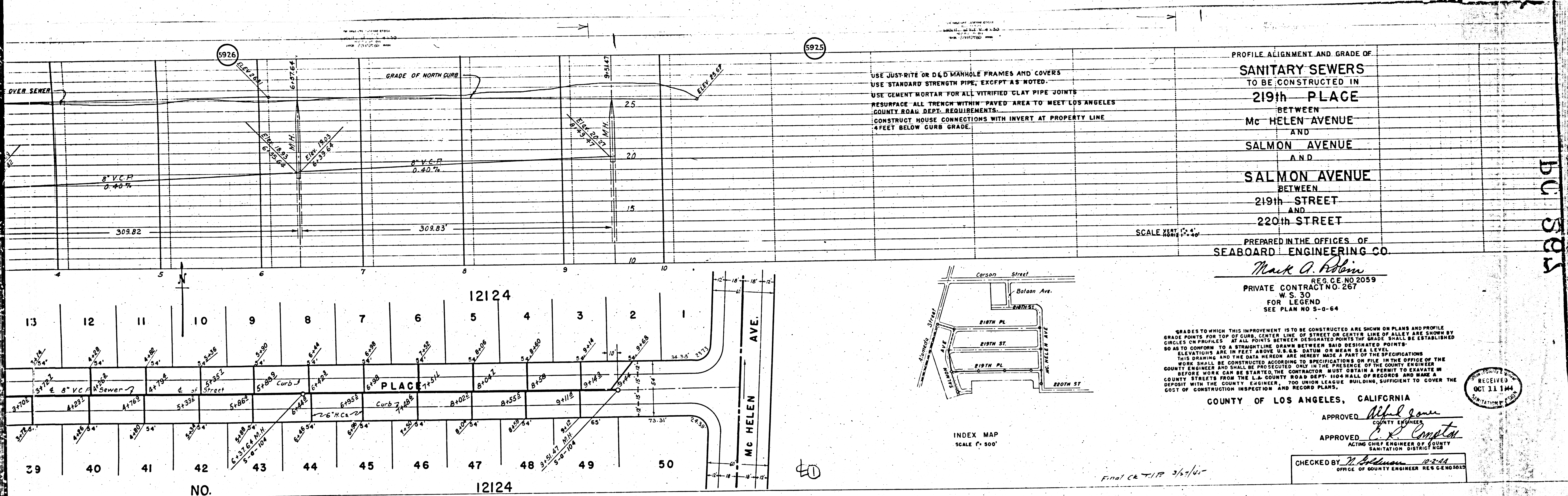



USE JUST-RITE OR D & D MANHOLE FRAMES AND COVERS  
 USE STANDARD STRENGTH PIPE, EXCEPT AS NOTED.  
 USE CEMENT MORTAR FOR ALL VITRIFIED CLAY PIPE JOINTS  
 RESURFACE ALL TRENCH WITHIN PAVED AREA TO MEET LOS ANGELES COUNTY ROAD DEPT. REQUIREMENTS.  
 CONSTRUCT HOUSE CONNECTIONS WITH INVERT AT PROPERTY LINE 4 FEET BELOW CURB GRADE.

PROFILE ALIGNMENT AND GRADE OF  
**SANITARY SEWERS**  
 TO BE CONSTRUCTED IN  
**219th PLACE**  
 BETWEEN  
**MC HELEN AVENUE**  
 AND  
**SALMON AVENUE**  
 AND  
**SALMON AVENUE**  
 BETWEEN  
**219th STREET**  
 AND  
**220th STREET**

SCALE HORIZ. 1" = 40'

PREPARED IN THE OFFICES OF  
**SEABOARD ENGINEERING CO.**

*Mark A. Roblin*  
 REG. CE. NO. 2059  
 PRIVATE CONTRACT NO. 267  
 W. S. 30  
 FOR LEGEND  
 SEE PLAN NO. S-6-64

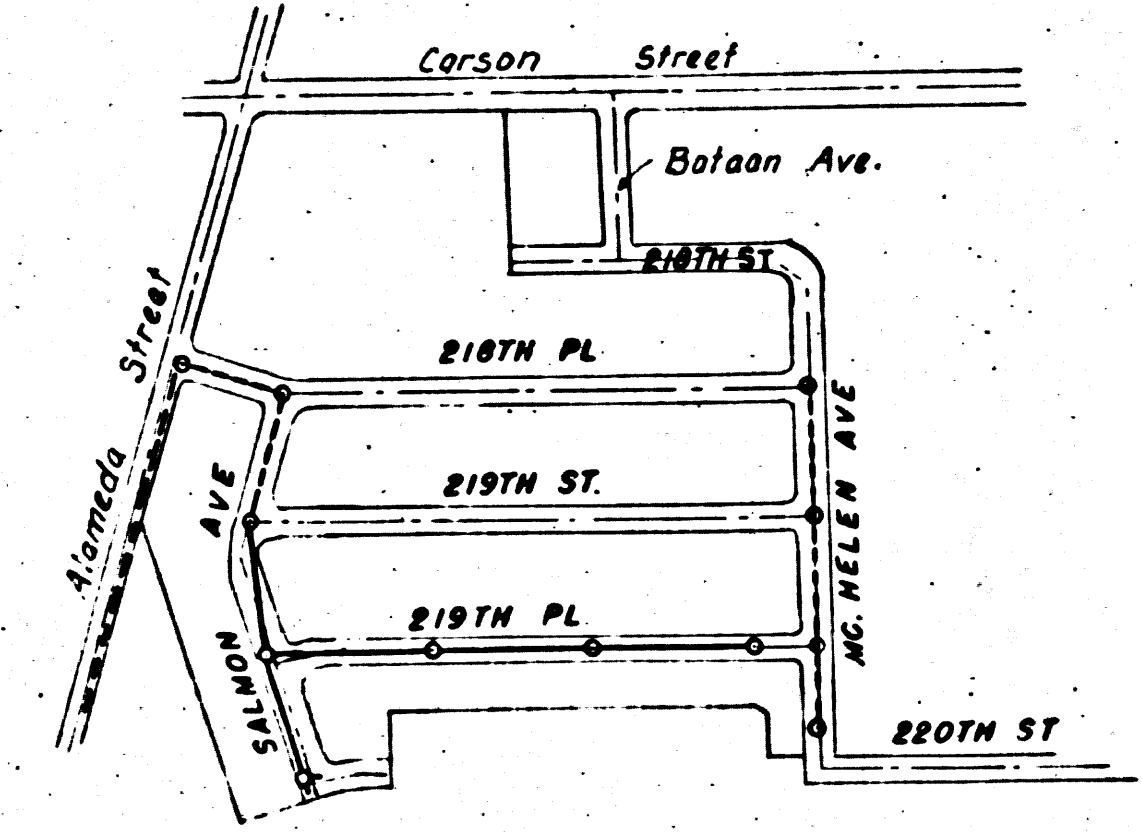

INDEX MAP  
 SCALE 1" = 500'

GRADES TO WHICH THIS IMPROVEMENT IS TO BE CONSTRUCTED ARE SHOWN ON PLANS AND PROFILE GRADE POINTS FOR TOP OF CURB, CENTER LINE OF STREET OR CENTER LINE OF ALLEY ARE SHOWN BY CIRCLES ON PROFILES. AT ALL POINTS BETWEEN DESIGNATED POINTS THE GRADE SHALL BE ESTABLISHED SO AS TO CONFORM TO A STRAIGHTLINE DRAWN BETWEEN SAID DESIGNATED POINTS.  
 ELEVATIONS ARE IN FEET ABOVE U.S.S. DATUM OR MEAN SEA LEVEL.  
 THIS DRAWING AND THE DATA HEREON ARE HEREBY MADE A PART OF THE SPECIFICATIONS FOR THE WORK SHOWN AND SHALL BE PROSECUTED ONLY IN THE PRESENCE OF THE COUNTY ENGINEER.  
 BEFORE WORK CAN BE STARTED, THE CONTRACTOR MUST OBTAIN A PERMIT TO EXCAVATE IN COUNTY STREETS FROM THE L.A. COUNTY ROAD DEPT. 1104 HALL OF RECORDS AND MAKE A DEPOSIT WITH THE COUNTY ENGINEER, 700 UNION LEAGUE BUILDING, SUFFICIENT TO COVER THE COST OF CONSTRUCTION INSPECTION AND RECORD PLANS.

COUNTY OF LOS ANGELES, CALIFORNIA

APPROVED *Alfred Lowe*  
 COUNTY ENGINEER

APPROVED *E. J. Compton*  
 ACTING CHIEF ENGINEER OF COUNTY SANITATION DISTRICT NO. 1

CHECKED BY *M. Roblin* 10-2-44  
 OFFICE OF COUNTY ENGINEER REG. CE. NO. 2059

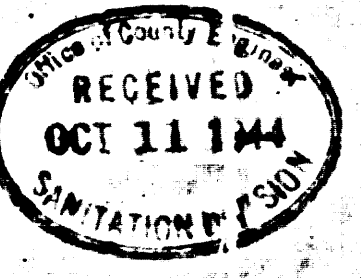

BC 505

Final CE TIR 3/27/45