

Trim Prints To This Line

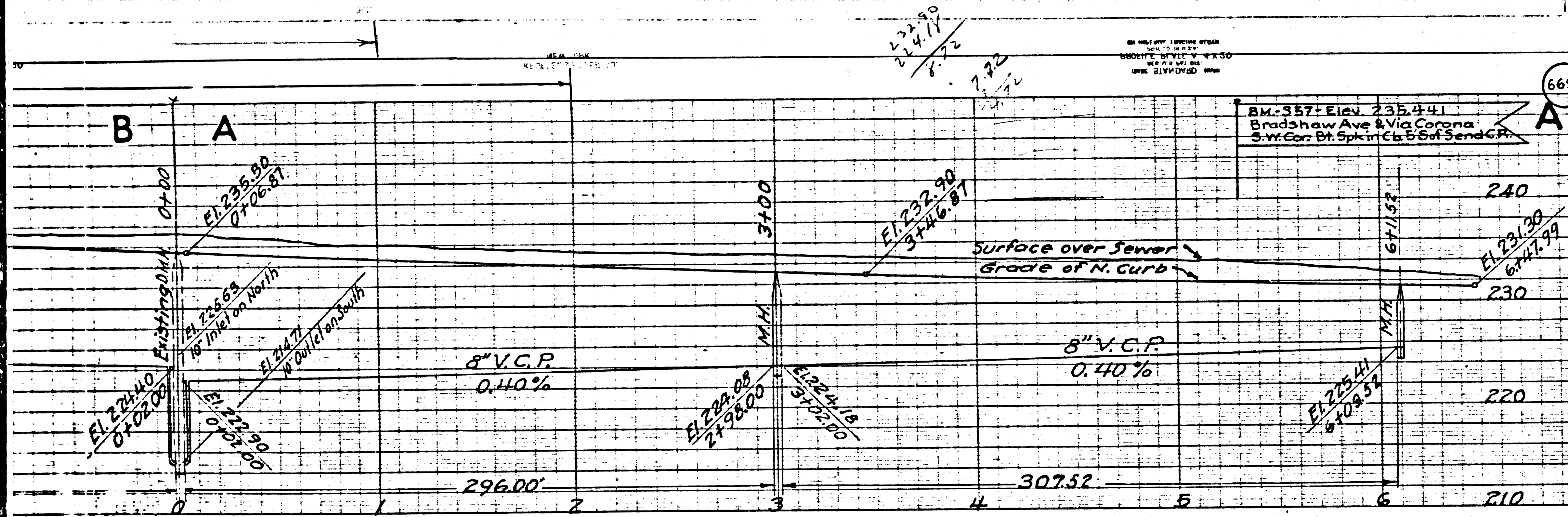

6695

USE STANDARD STRENGTH PIPE EXCEPT AS NOTED

USE LEV'ENT MORTAR FOR ALL VITRIFIED CLAY PIPE JOINTS

INCREASE FOUR FEET OF SEWER AT POINTS OF INTERFERENCE WITH POLES AS PER S-a-6

CONSTRUCT HOUSE CONNECTIONS WITH INVERT AT PROPERTY LINE 5 FEET BELOW CURB GRADE EXCEPT AS NOTED

ALL STRUCTURES SHALL BE BRICK SEWER STRUCTURES AS PER PLAN NO. S-a-104

USE STANDARD MANHOLE FRAMES AND COVERS AS PER PLAN NO. S-a-116

CONSTRUCT TOPS OF ALL STRUCTURES IN RIGHTS OF WAY 6" ABOVE FINISHED GRADE

RESURFACE ALL TRENCHES WITHIN PAVED AREA TO MEET LOS ANGELES COUNTY ROAD DEPT. OR STATE HIGHWAY REQUIREMENTS

RECONSTRUCT TOPS OF EXISTING STRUCTURES TO CONFORM TO NEW STREET GRADE.

NO REVISIONS SHALL BE MADE IN THESE PLANS WITHOUT APPROVAL OF THE COUNTY ENGINEER OR REPRESENTATIVE OF THE COUNTY ENGINEER WILL SURVEY OR LAY OUT ANY PORTION OF THE WORK

THE OWNER OR HIS AUTHORIZED REPRESENTATIVE SHALL FURNISH THE COUNTY ENGINEER WITH GRADE SHEETS AND STATIONS OF ALL HOUSE CONNECTIONS AND Y BRANCHES, AND SHALL PROVIDE STAKES FOR THEM AT THEIR PROPER LOCATIONS WITH STATIONING PLAINLY MARKED. ANY CHANGE OF LOCATION SHALL BE REQUESTED IN WRITING BY THE OWNER OR HIS REPRESENTATIVE.

PROFILE ALIGNMENT AND GRADE OF  
**SANITARY SEWERS**  
TO BE CONSTRUCTED IN

REPETTO STREET  
BETWEEN BRADSHAW ST. AND  
THE FIRST ALLEY EAST OF ATLANTIC BLVD.

**TRACT No. 12263**  
PRIVATE CONTRACT NO. 394  
W. S. 36  
ONE SHEET

SCALE: VERT. 1"=4'  
HORIZ. 1"=40'

MAY 1948

PREPARED IN THE OFFICES OF  
**HARRY R. BOLTON**

FOR LEGEND  
SEE PLAN NO. S-a-64

**NOTE**

GRADES TO WHICH THIS IMPROVEMENT IS TO BE CONSTRUCTED ARE SHOWN ON PLANS AND PROFILES. GRADE POINTS FOR TOP OF CURB, CENTER LINE OF STREET OR CENTER LINE OF ALLEY ARE SHOWN BY CIRCLES ON PROFILES. AT ALL POINTS BETWEEN DESIGNATED POINTS THE GRADE SHALL BE ESTABLISHED SO AS TO CONFORM TO A STRAIGHT LINE DRAWN BETWEEN SAID DESIGNATED POINTS.

ELEVATIONS ARE IN FEET ABOVE U. S. G. DATUM OR MEAN SEA LEVEL.

THIS DRAWING AND THE DATA HEREON ARE HEREBY MADE A PART OF THE SPECIFICATIONS.

WORK SHALL BE CONSTRUCTED ACCORDING TO SPECIFICATIONS ON FILE IN THE OFFICE OF THE COUNTY ENGINEER AND SHALL BE PROSECUTED ONLY IN THE PRESENCE OF THE COUNTY ENGINEER.

BEFORE WORK CAN BE STARTED, THE CONTRACTOR MUST OBTAIN A PERMIT TO EXCAVATE IN COUNTY STREETS FROM THE L. A. COUNTY ROAD DEPT. FROM HALL OF RECORDS, AND MAKE A DEPOSIT WITH THE COUNTY ENGINEER, 700 UNION LEAGUE BUILDING, SUFFICIENT TO COVER THE COST OF CONSTRUCTION INSPECTION AND RECORD PLANS.

IF WORK IS TO BE DONE IN A STATE HIGHWAY, A PERMIT MUST BE OBTAINED FROM THE STATE OF CALIFORNIA, DIVISION OF HIGHWAYS, 808 STATE BUILDING, AFTER MAKING THE DEPOSIT WITH THE COUNTY ENGINEER.

COUNTY OF LOS ANGELES, CALIFORNIA

APPROVED *[Signature]* CITY ENGINEER  
APPROVED *[Signature]* CHIEF DEPUTY COUNTY ENGINEER

APPROVED *[Signature]* CHIEF ENGINEER OF COUNTY SANITATION DISTRICT NO. 2

CHECKED BY *[Signature]* 7/26 1946  
OFFICE OF COUNTY ENGINEER, PEG. C. E. NO. 6320

**DOUBLE SCALE**

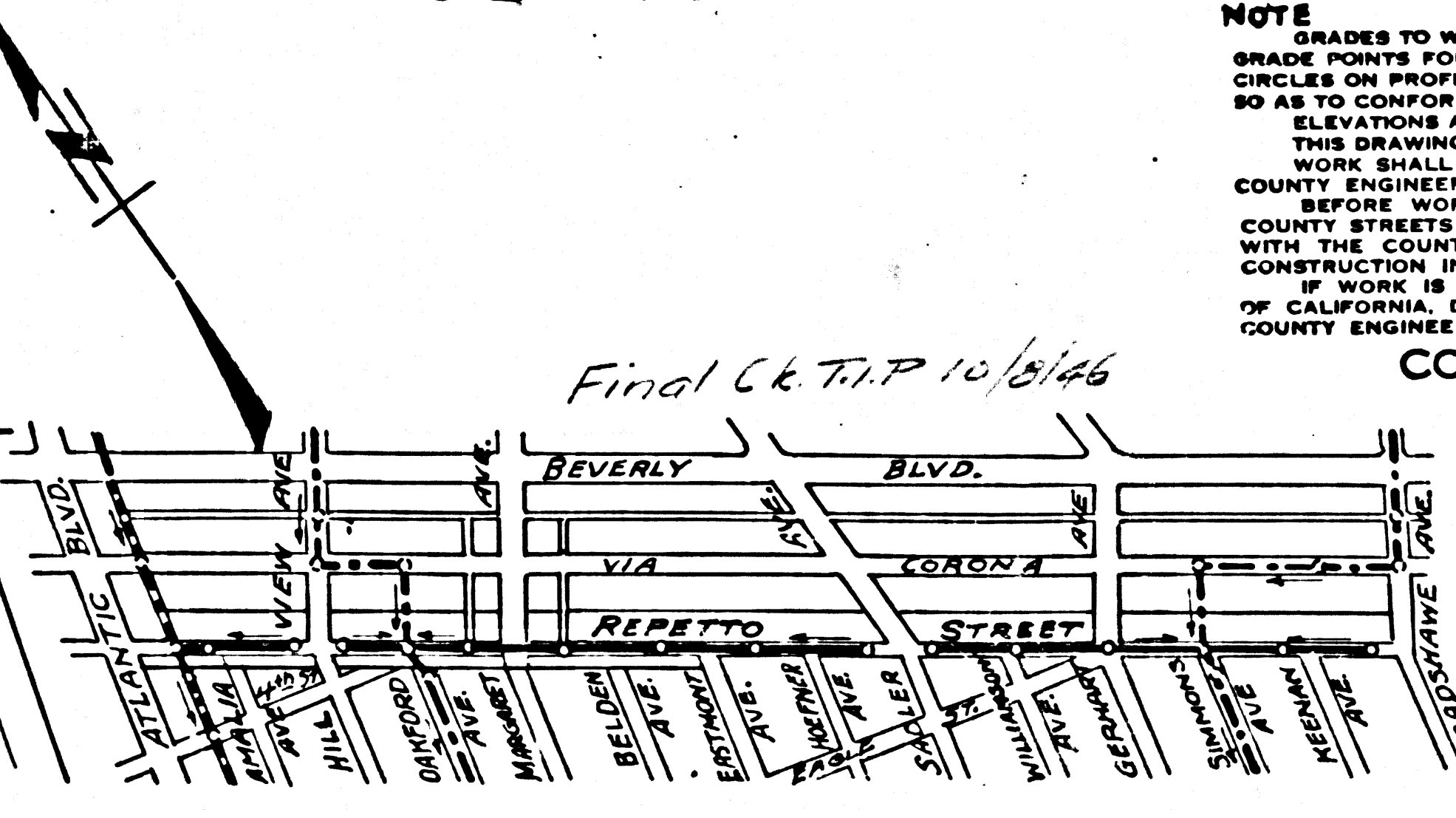

Trim Prints To This Line

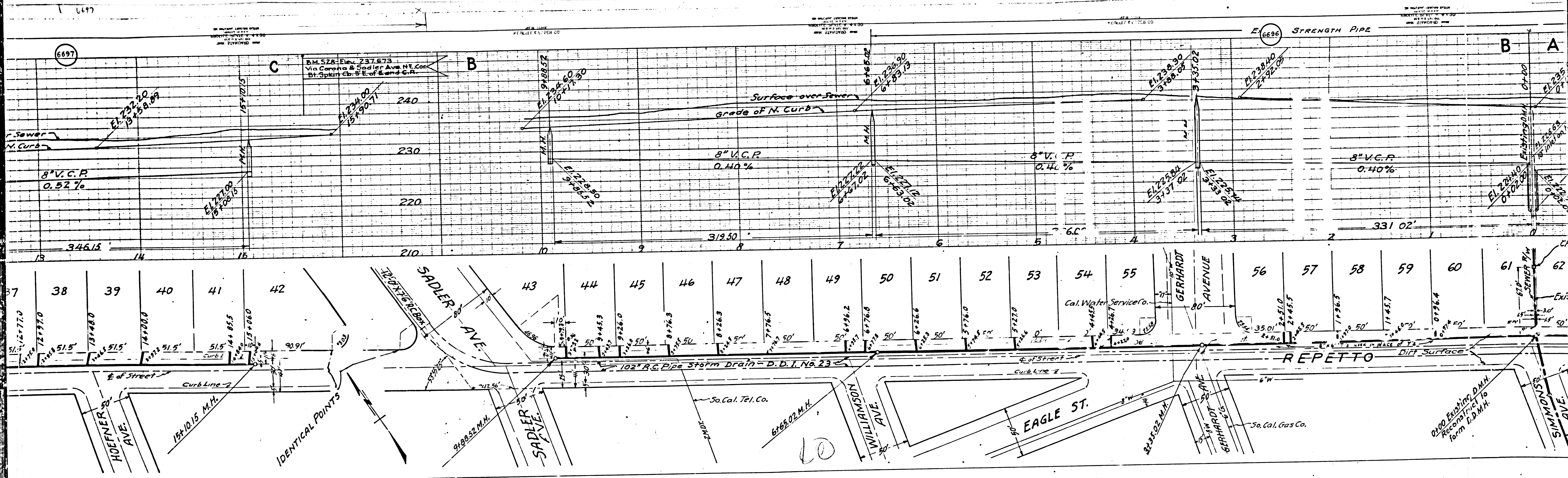

B.M. 528 Elev. 237.673  
 Via Corona & Sadler Ave NE Cor.  
 Bl. Spkin Co. S E of S and S-A.

2.00 Existing D.M.H.  
 Reconstruct to  
 form D.D.M.H.

6168.02 M.H.

15410.15 M.H.

6697

6696

6698

6697

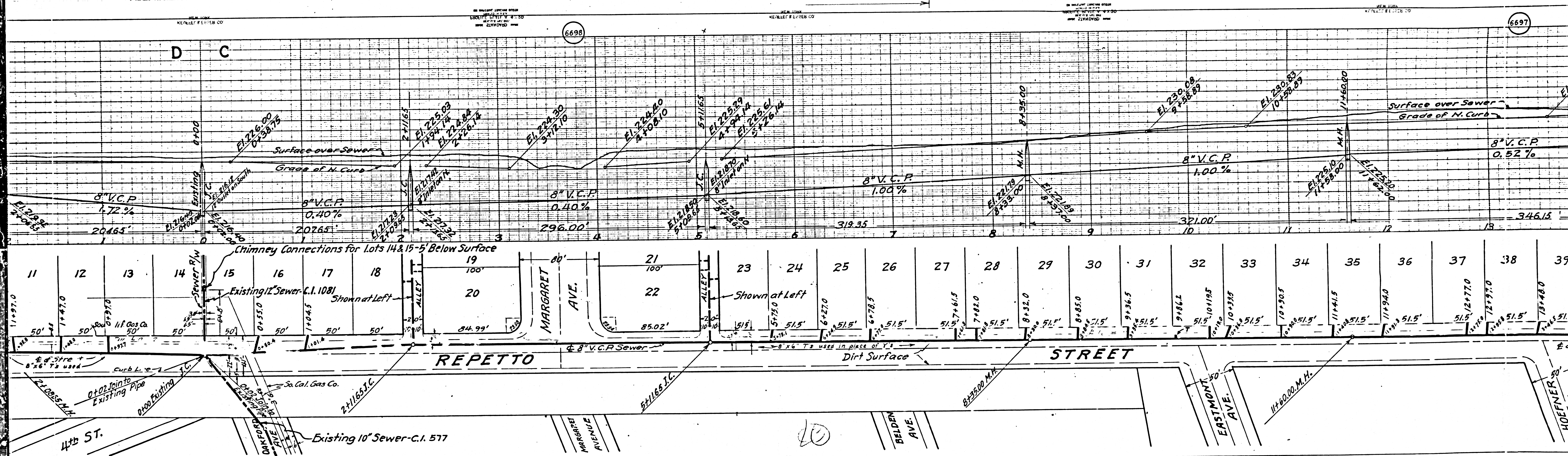

D C

Chimney Connections for Lots 14 & 15-5 Below Surface

Existing 10" Sewer - C.I. 577

REPETTO STREET

STREET

4th ST.

DARKFORD AVE.

MARGARET AVENUE

MARGARET AVENUE

BELDEN AVE.

EASTMONT AVE.

HOEFNER ST.

M3

M6

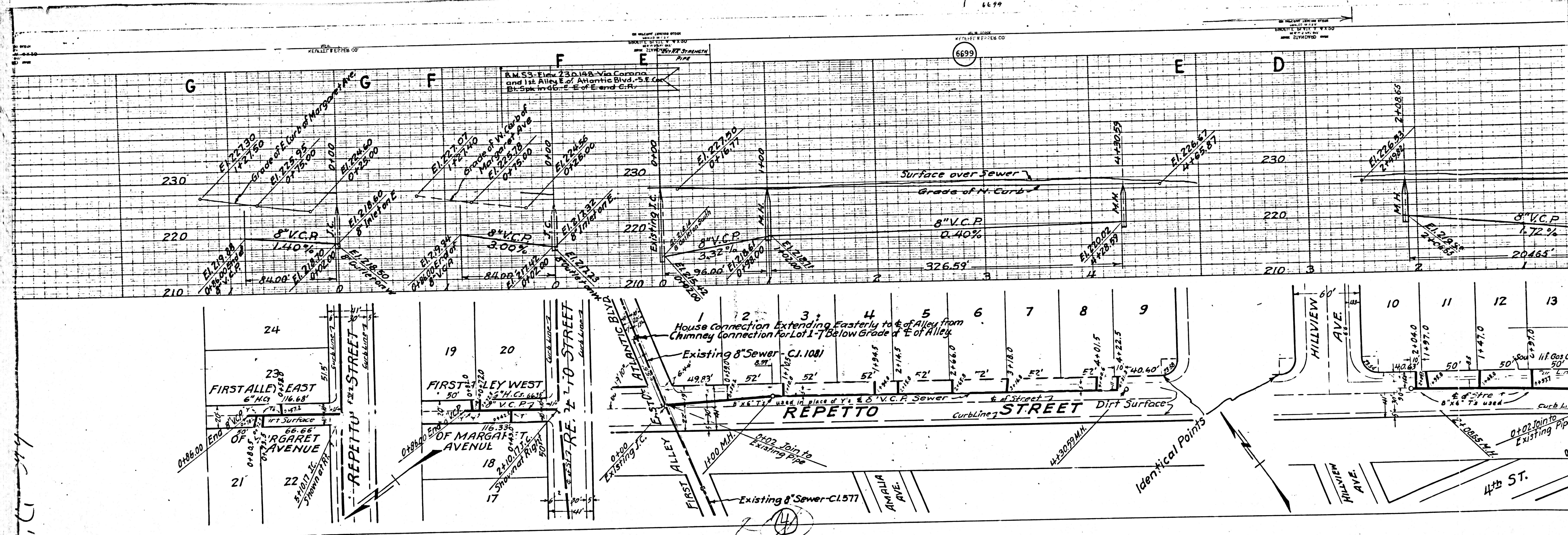

B.M. 53 Elev. 230.148 - Via Corona and 1st Alley E of Atlantic Blvd. - S.E. Cor. Elev. Spk in 46'-E of E and G.R.

6899

House Connection Extending Easterly to E of Alley from Chimney Connection for Lot 1-7 Below Grade of E of Alley.

Existing 8" Sewer - C.I. 1081

REPETTO STREET

STREET

Existing 8" Sewer - C.I. 577

Identical Points

11/11/11