

BY MAILING LISTING STATE  
UNIONITE OFFICE 4750  
RECEIVED  
MAY 21 1946

BY MAILING LISTING STATE  
UNIONITE OFFICE 4750  
RECEIVED  
MAY 21 1946

BY MAILING LISTING STATE  
UNIONITE OFFICE 4750  
RECEIVED  
MAY 21 1946

BY MAILING LISTING STATE  
UNIONITE OFFICE 4750  
RECEIVED  
MAY 21 1946

BY MAILING LISTING STATE  
UNIONITE OFFICE 4750  
RECEIVED  
MAY 21 1946

- (1) USE COUNTY STANDARD MANHOLE FRAMES AND COVERS AS PER 3-3-FITZ.
- (2) USE EXTRA STRENGTH PIPE.
- (3) USE CEMENT MORTAR FOR ALL VITRIFIED CLAY PIPE JOINTS.
- (4) RESURFACE ALL TRENCH WITHIN PAVED AREA TO MEET LOS ANGELES COUNTY ROAD DEPT. OR CALIFORNIA STATE HIGHWAY REQUIREMENTS.
- (5) ALL STRUCTURES SHALL BE BRICK SEWER STRUCTURES, 3-2-104.

PROFILE, ALIGNMENT AND GRADE OF  
**SANITARY SEWERS**  
TO BE CONSTRUCTED IN  
**SLAUSON AVE.**  
FROM MANHOLE IN BARKFIELD AVENUE TO MANHOLE 2063' EAST  
IN EAST LAGUNA TRACT S.C.C. B-8-961 (EXHIBIT  
(C.A. 388)

PRIVATE CONTRACT NO. 404  
W.S. NO. 38  
ONE SHEET

NOTE:  
NO REPRESENTATIVE OF THE COUNTY ENGINEER WILL SURVEY OR LAY OUT ANY PORTION OF THE WORK.  
THE OWNER OR HIS AUTHORIZED REPRESENTATIVE SHALL FURNISH THE COMPLETE EMBLEM, WITH GRADE, SIZES  
AND STATIONS OF ALL HOUSE CONNECTIONS AND Y BRANCHES AND SHALL PROVIDE STAKES FOR THEM AT THEIR  
PROPER LOCATIONS WITH STATIONING, BLANKLY MARKED AND CHANGE OF LOCATION SHALL BE REQUESTED IN WRITING  
BY THE OWNER OR HIS REPRESENTATIVE.  
NO REVISIONS SHALL BE MADE IN THESE PLANS WITHOUT APPROVAL OF THE COUNTY ENGINEER.

PREPARED IN THE OFFICES OF  
**HAROLD A. BARNETT**  
REG. C.E. NO. 1216

BY: *Harold A. Barnett*  
REG. C.E. NO. 1216

FOR LEGEND  
SEE PLAN NO. 3-4-84

NOTE:  
GRADES TO WHICH THIS IMPROVEMENT IS TO BE CONSTRUCTED ARE SHOWN ON PLANS AND PROFILE.  
GRADE POINTS ARE AS INDICATED BY ARROWS AT ALL POINTS BETWEEN DESIGNATED  
POINTS THE GRADE SHALL BE ESTABLISHED SO AS TO CONFORM TO A STRAIGHT LINE  
DRAWN BETWEEN SAID DESIGNATED POINTS.  
ELEVATIONS ARE IN FEET ABOVE U.S.A.'S DATUM OR MEAN SEA LEVEL.  
THIS DRAWING AND THE DATA HEREON ARE HEREBY MADE A PART OF THE SPECIFICATIVE  
WORK SHALL BE CONSTRUCTED ACCORDING TO SPECIFICATIONS ON FILE IN THE OFFICE OF THE  
COUNTY ENGINEER AND SHALL BE PROSECUTED ONLY IN THE PRESENCE OF THE COUNTY ENGINEER.  
NO WORK CAN BE STARTED, THE CONTRACTOR MUST OBTAIN A PERMIT TO BRAY FROM THE  
COUNTY STREET FROM THE L.A. COUNTY ROAD DEPT. 104 HALL OF RECORDS, AND HAVE A  
DEPOSIT WITH THE COUNTY ENGINEER, 700 UNION LEAGUE BUILDING, SUFFICIENT TO COVER THE  
COST OF CONSTRUCTION INSPECTION AND RECORDED PLANS.

COUNTY OF LOS ANGELES, CALIFORNIA  
APPROVED: *Alfred J. Gause*  
COUNTY ENGINEER

APPROVED: *Walter J. Gause*  
CHIEF ENGINEER OF COUNTY  
SANITATION DISTRICT NO. 2

CHECKED BY: *Kathleen Vichet*  
INDUSTRIAL WASTE ENGINEER

CHECKED BY: *Walter J. Gause* 7/3-1946  
OFFICE OF COUNTY ENGINEER REG. C.E. NO. 1216

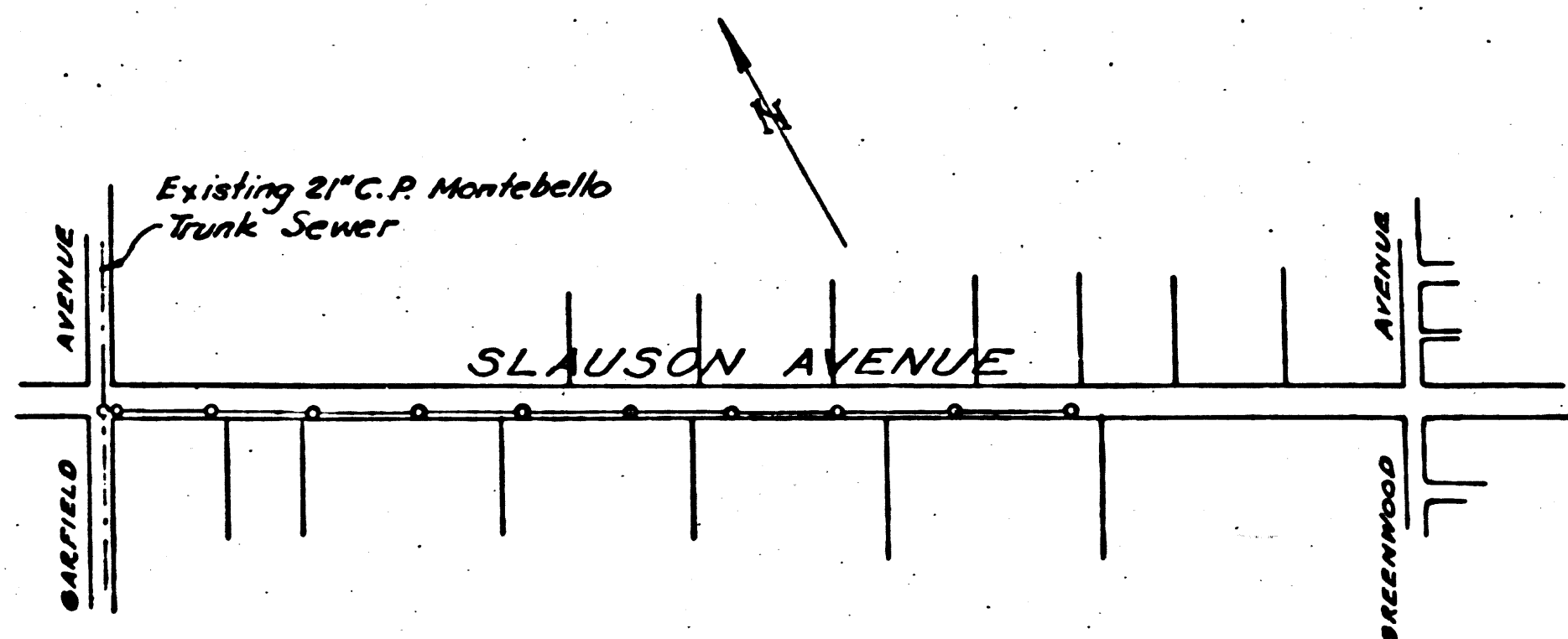

INDEX MAP  
SCALE: 1"=60'

Final CK TRP 11/26/46

H.A.B. Drawg. No. 3507

RECEIVED  
SEP 3  
1946

NEW YORK  
KEPLER & EYER CO.

NEW YORK  
KEPLER & EYER CO.

NEW YORK  
KEPLER & EYER CO.

NEW YORK  
KEPLER & EYER CO.

NEW YORK  
KEPLER & EYER CO.

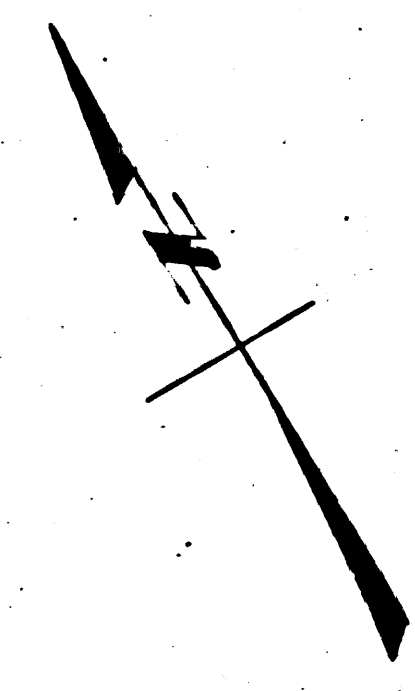
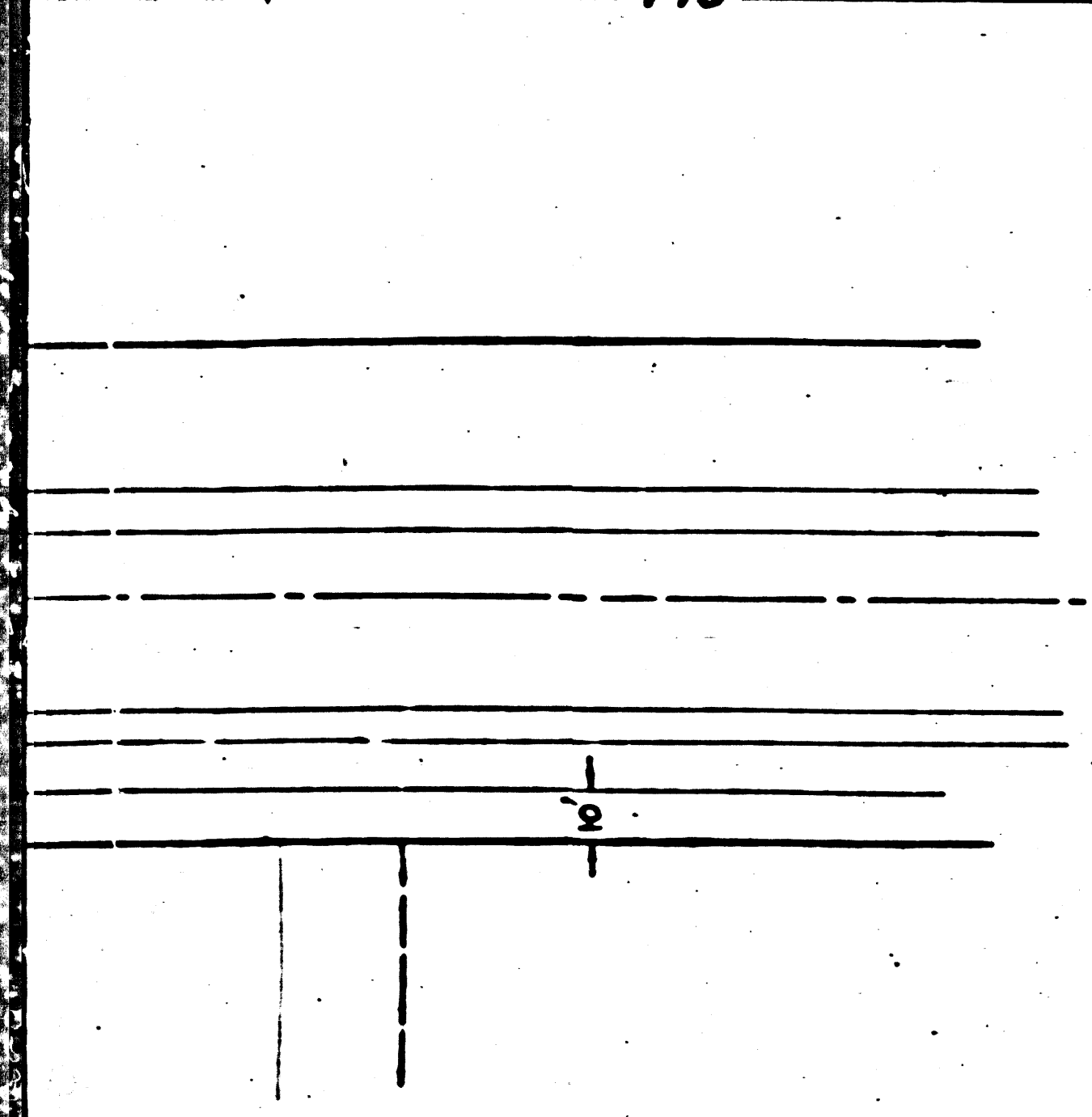
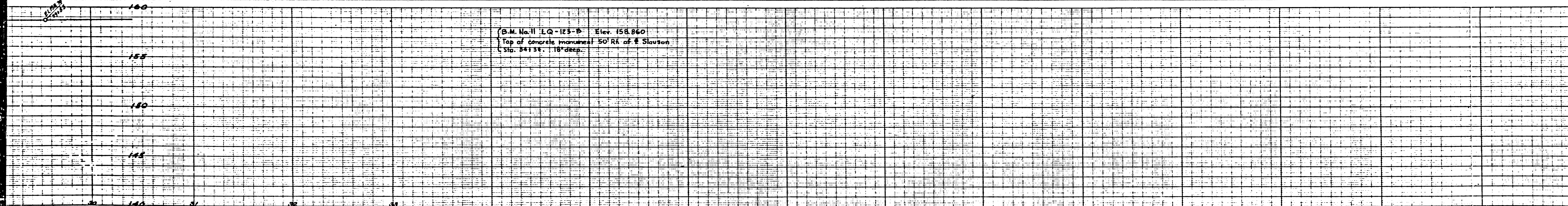

②

NO. 100001  
DATE: 12-15-30  
BY: J. H. WILSON  
CHECKED: J. H. WILSON

NO. 100002  
DATE: 12-15-30  
BY: J. H. WILSON  
CHECKED: J. H. WILSON

NO. 100003  
DATE: 12-15-30  
BY: J. H. WILSON  
CHECKED: J. H. WILSON

NO. 100004  
DATE: 12-15-30  
BY: J. H. WILSON  
CHECKED: J. H. WILSON

NO. 100005  
DATE: 12-15-30  
BY: J. H. WILSON  
CHECKED: J. H. WILSON

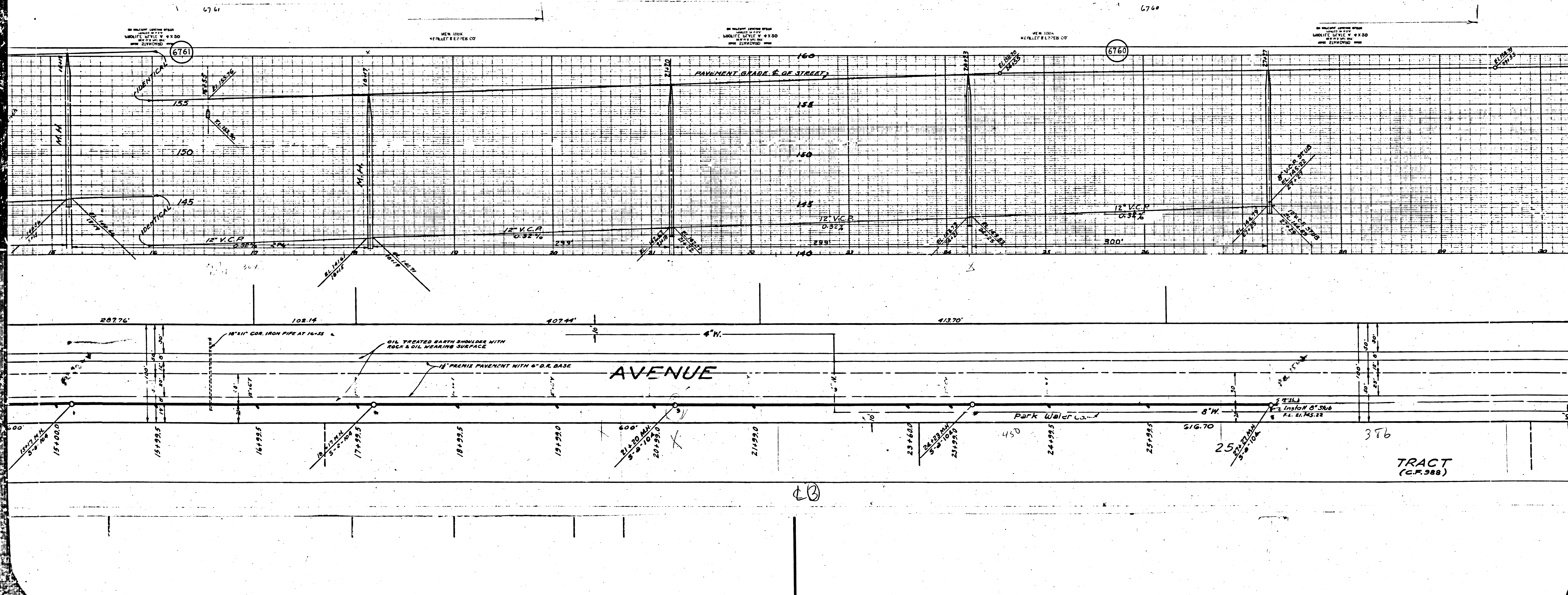

TRACT  
(C.F. 388)

43

676

676

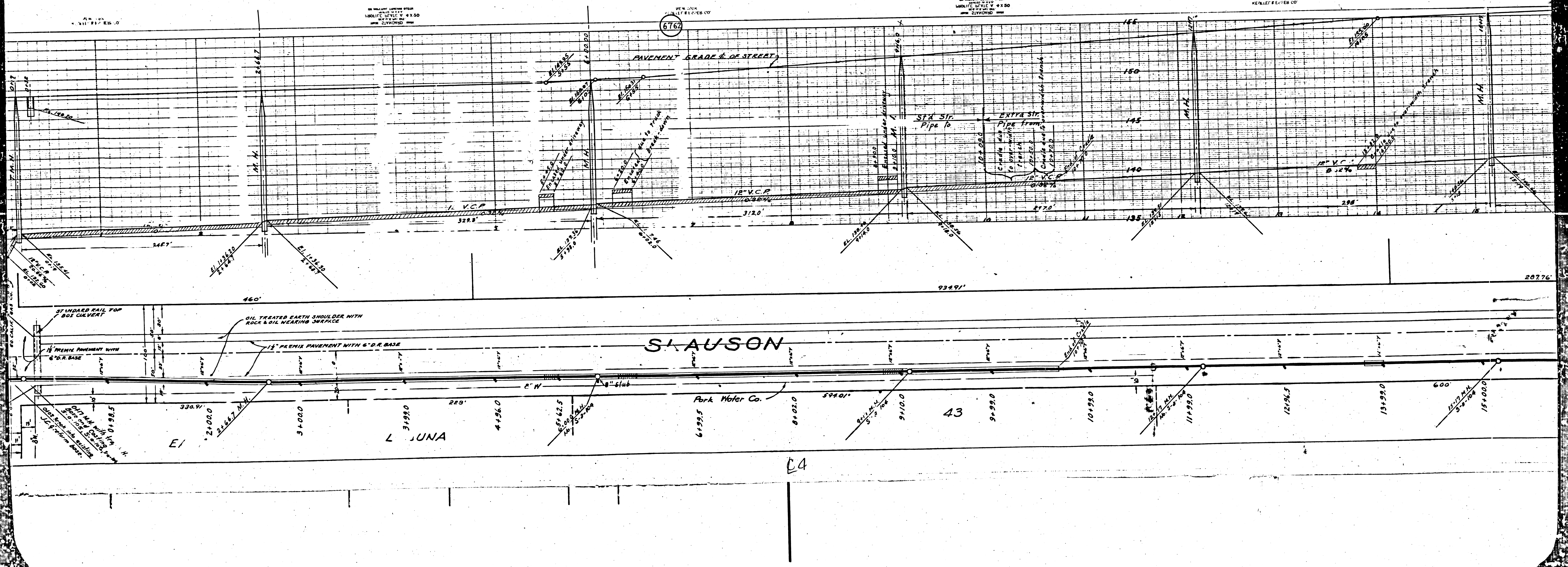

STANSON

43

64

LUNA

Park Water Co.

