

- (1) Use Standard Manhole Frame & Cover S.A. 117
 - (2) Use Standard strength pipe
 - (3) Use Cement mortar for all vitrified clay pipe joints
 - (4) Surface all trench within paved area to meet Los Angeles County Road Department requirements
 - (5) Escape Four feet of cover at points of interference with poles in per 5 A-5
 - (6) All structures shall be Brick Tower Structures, P.A. 10
- No representative of the County Engineer will survey or lay out any portion of the work. The contractor or his authorized representative shall furnish the County Engineer with grade sheets and stations of all house connections and branches and shall provide stakes for them in their proper locations with markings plainly marked. Any change of location shall be requested in writing by the contractor or his representative. No revisions shall be made in these plans without approval of the County Engineer.

PROFILE ALIGNMENT AND GRADE OF SANITARY SEWER TO BE CONSTRUCTED IN ERIEL AVE. AND COMPTON BLVD. BETWEEN A POINT 22' N. OF COMPTON BLVD. AND A POINT 22' S. OF COMPTON BLVD.

PRIVATE CONTRACT NO. 411
 INS. NO. 28
 SHEET 1 OF 1 SHEET
 SCALE: 1" VERT. = 40' HORIZ.
 PREPARED IN THE OFFICE OF
 ENGINEERING SERVICE CORPORATION
 BY: E. J. ...
 FOR LEGEND
 See Plan No. 3062

SCHEDULE of Y's

| | | |
|---------|------|------------|
| LINE 1' | 0130 | 0'26" Y R. |
| | 0135 | " |
| | 0140 | " |
| | 0145 | 6'26" Y R. |
| | 0150 | 6'26" C.O. |
| | 0155 | 6'26" Y R. |
| | 0160 | " |
| | 0165 | " |
| | 0170 | 6'26" C.O. |
| LINE 2' | 0175 | 6'26" Y R. |
| | 0180 | " |
| | 0185 | " |
| | 0190 | 6'26" C.O. |
| | 0195 | " |
| | 0200 | " |
| | 0205 | 6'26" Y R. |
| | 0210 | " |
| | 0215 | 6'26" C.O. |
| | 0220 | " |
| | 0225 | 6'26" Y R. |
| | 0230 | " |
| | 0235 | 6'26" C.O. |
| | 0240 | " |
| | 0245 | 6'26" Y R. |
| | 0250 | " |

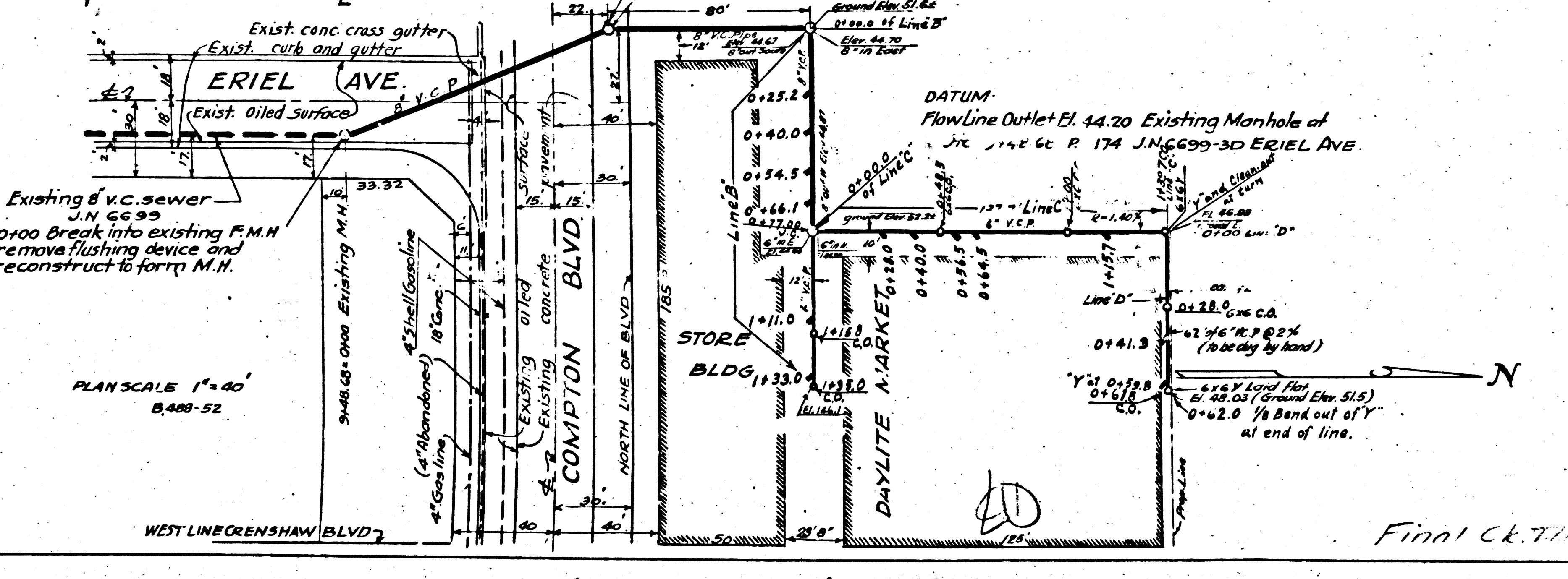

GRADES TO WHICH THIS IMPROVEMENT IS TO BE CONSTRUCTED ARE SHOWN ON PLANS AND PROFILE. GRADE POINTS FOR TOP OF CURB CENTER OF STREET OR CENTER LINE OF ALLEY ARE SHOWN BY CIRCLES ON PROFILE, AT ALL POINTS BETWEEN DESIGNATED POINTS THE GRADE SHALL BE ESTABLISHED SO AS TO CONFORM TO A STRAIGHT LINE DRAWN BETWEEN SAID DESIGNATED POINTS. ELEVATIONS ARE IN FEET ABOVE U.S.G.S. DATUM OR MEAN SEA LEVEL. THIS DRAWING AND THE DATA HEREON ARE HEREBY MADE A PART OF THE SPECIFICATIONS. WORK SHALL BE CONSTRUCTED ACCORDING TO SPECIFICATIONS ON FILE IN THE OFFICE OF THE COUNTY ENGINEER AND SHALL BE PROSECUTED ONLY IN THE PRESENCE OF THE COUNTY ENGINEER. BEFORE WORK CAN BE STARTED THE CONTRACTOR MUST OBTAIN A PERMIT TO EXCAVATE IN COUNTY STREETS FROM THE L.A. COUNTY ROAD DEPT. 1104 HALL OF RECORDS, AND MAKE A DEPOSIT WITH THE COUNTY ENGINEER, 700 FASHION LEAGUE BUILDING SUFFICIENT TO COVER THE COST OF CONSTRUCTION INSPECTION AND RECORD PLANS. IF WORK IS TO BE DONE IN A STATE HIGHWAY A PERMIT MUST BE OBTAINED FROM THE STATE OF CALIFORNIA DIVISION OF HIGHWAYS, 808 STATE BUILDING AFTER MAKING THE DEPOSIT WITH THE COUNTY ENGINEER.

COUNTY OF LOS ANGELES, CALIFORNIA.
 APPROVED: *Edward J. ...* CHIEF DEPUTY COUNTY ENGINEER
 APPROVED: *... ..* CHIEF ENGINEER OF COUNTY SANITATION DISTRICT NO. 5
 CHECKED BY: *... ..* 7/24 1946
 OFFICE OF COUNTY ENGINEER, REG. C.E. NO. 6330

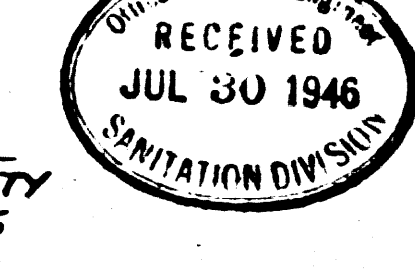

BC 411

Final C.E. 719 10/20/46

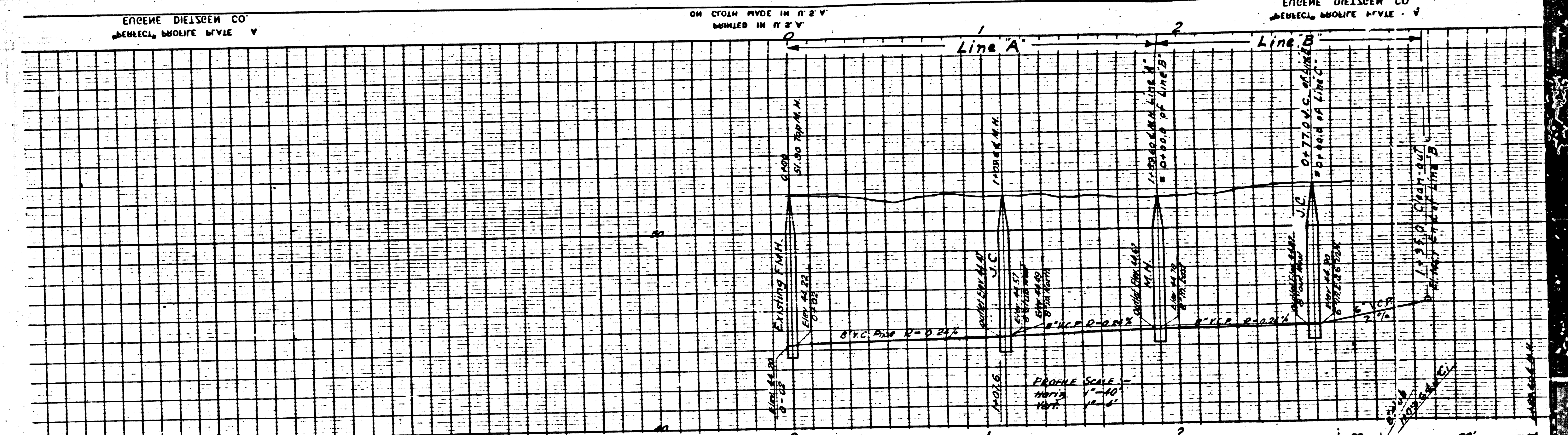

SCHEDULE of Y's

| LINE | Station | Type |
|----------|----------|--------------|
| LINE 'A' | 0+38 | 8"x6" V'S RH |
| | 0+55 | |
| | 0+60 | |
| | 0+80 | 6"x6" Y RH |
| | 1+17 | 6"x6" C.O. |
| | 1+26 | 6"x6" Y RH |
| LINE 'B' | 1+41 | " " " " |
| | 1+49 | 6"x6" C.O. |
| | 1+29 | 6"x6" Y RH |
| | 0+42 | " " " |
| | 0+50 | " " CO. |
| | 0+55 | " " Y RH |
| LINE 'C' | 0+65 | " " " |
| | 1+00 | " " CO. |
| | 1+14 | " " Y RH |
| | 1+30.7 | " " " |
| | 0+25 | 6"x6" Y RH |
| | 0+30 | " " CO. |
| 0+50 | " " Y RH | |
| 0+60 | " " CO. | |

P.C. 411
 de

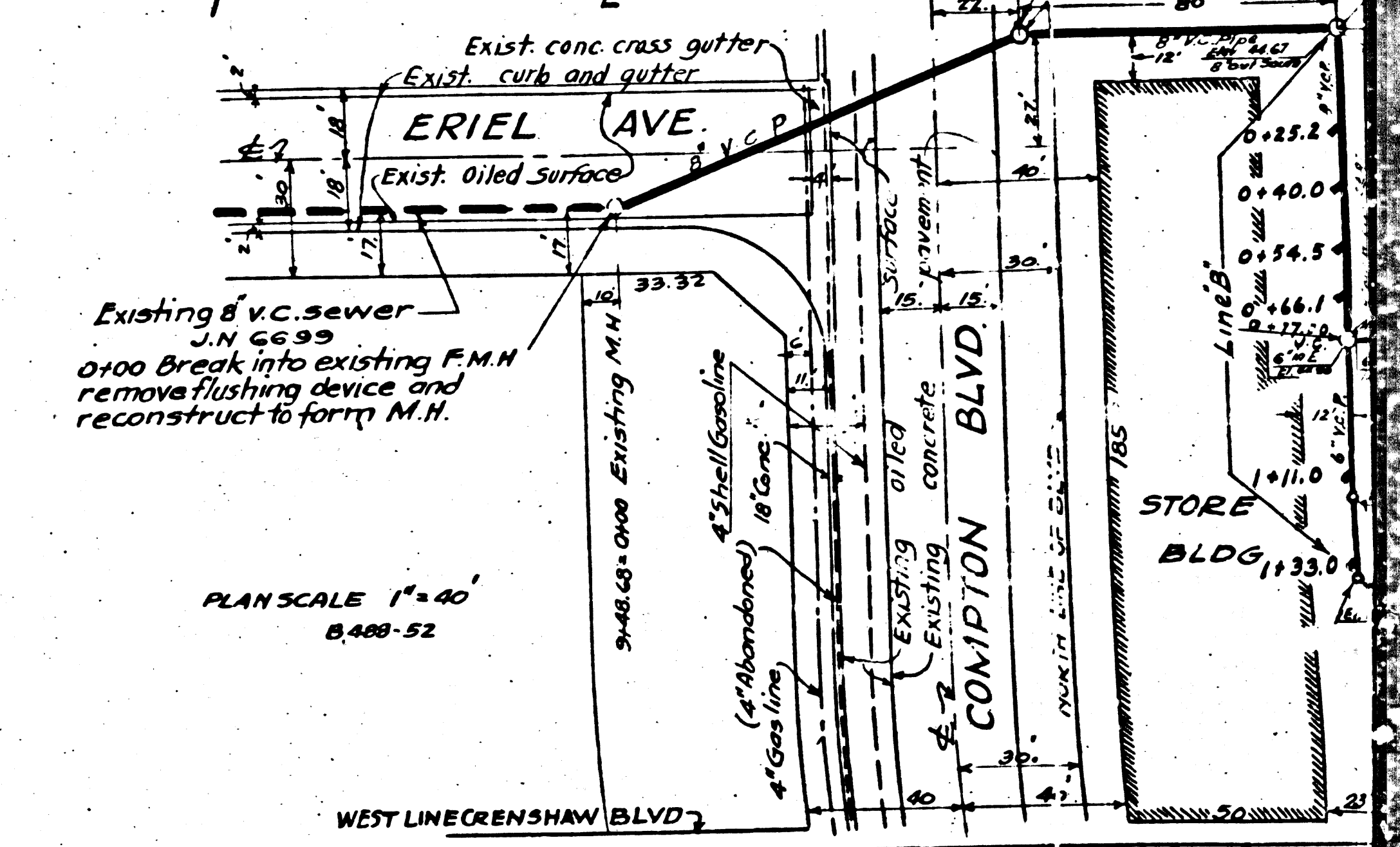

PLAN SCALE 1"=40'
 8,400-52