

CONSTRUCTION NOTES:

1. USE STANDARD MANHOLE FRAMES AND COVERS S. & M.T.
2. USE STANDARD STRENGTH PIPE
3. USE CEMENT MORTAR FOR ALL VITRIFIED CLAY PIPE JOINTS
4. RESURFACE ALL TRENCH WITHIN PAVED AREA TO MEET LOS ANGELES COUNTY ROAD DEPT. REQUIREMENTS
5. CONSTRUCT HOUSE CONNECTIONS WITH INVERT AT PROPERTY LINE, FIVE FEET BELOW CURB GRADE, EXCEPT AS NOTED
6. ENGAGE FOUR FEET OF SEWER AT POINTS OF INTERFERENCE WITH POLES AS PER S.O.C.
7. ALL STRUCTURES SHALL BE BRICK SEWER STRUCTURES S. & M.T.

BENCH MARK: ALL ELEVATIONS ARE REFERRED TO COUNTY OF LOS ANGELES, B.M. NO. 7, AS PER ROAD DEPT. B.L. LIQUID METER (CUT SPIKE IN CONCRETE PAVING 1/40 SOUTH OF S IMPERIAL HIGHWAY, 350 EAST OF S REDFERN AVENUE.) ELEVATION 80.92.

PROFILE, ALIGNMENT AND GRADE OF SANITARY SEWER TO BE CONSTRUCTED IN 117th STREET EAST FROM SUNDIALE AVENUE TO ALLEY

NOTE: NO REPRESENTATIVE OF THE COUNTY ENGINEER SHALL SURVEY OR CUT OUT ANY PART OF THIS WORK. THE OWNER OR HIS AUTHORIZED REPRESENTATIVE SHALL FURNISH THE COUNTY ENGINEER WITH PROPER RIGHTS AND PERMISSIONS OF ALL PROPER AGENCIES AND IF NECESSARY SHALL PROVIDE OTHER "AS TAKEN" SURVEYING INSTRUMENTS WITH STATIONING, ALIEN INTERESTS, AND CLAIMS. EACHING SHALL BE REQUESTED IN WRITING & THE OWNER SHALL BE RESPONSIBLE FOR ALL WORK NOT APPROVED BY THE COUNTY ENGINEER.

PRIVATE CONTRACT No. 455
MS 25
SHEET 1 OF 1 SHEET
 SCALE: HORIZ. 1" = 40'
 VERT. 1" = 4'

PREPARED BY F. B. Guggisberg
 C.E. No. 6007

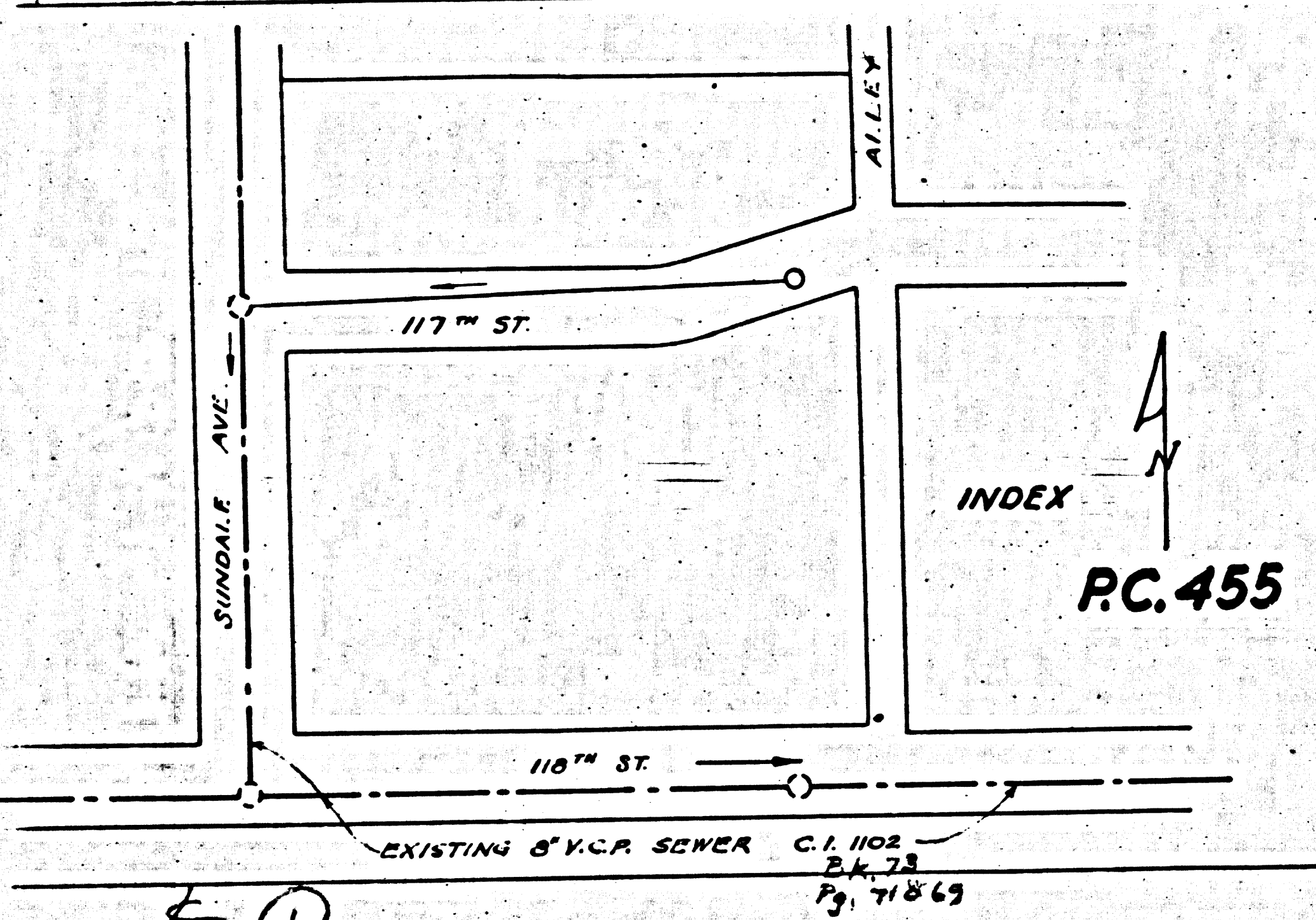

NOTE: GRADES TO WHICH THIS IMPROVEMENT IS TO BE CONSTRUCTED ARE SHOWN ON PLANS AND PROFILE. GRADE POINTS FOR TOP OF CURB, CENTER LINE OF STREET OR CENTER LINE OF ALLEY ARE SHOWN BY CIRCLES ON PROFILE. AT ALL POINTS BETWEEN DESIGNATED POINTS THE GRADE SHALL BE ESTABLISHED SO AS TO CONFORM TO A STRAIGHT LINE DRAWN BETWEEN SAID DESIGNATED POINTS. ELEVATIONS ARE IN FEET ABOVE U.S.C. DATUM, MEAN SEA LEVEL. THIS DRAWING AND THE DATA HEREON ARE HEREBY MADE A PART OF THE SPECIFICATIONS. WORK SHALL BE CONSTRUCTED ACCORDING TO SPECIFICATIONS ON FILE IN THE OFFICE OF THE COUNTY ENGINEER AND SHALL BE PROSECUTED ONLY IN THE PRESENCE OF THE COUNTY ENGINEER. BEFORE WORK CAN BE STARTED THE CONTRACTOR MUST OBTAIN A PERMIT TO EXCAVATE IN COUNTY STREETS FROM THE L.A. COUNTY ROAD DEPT., 1166 HALL OF RECORDS AND MAKE A DEPOSIT WITH THE COUNTY ENGINEER, 700 FAHMAN LEASE BUILDING, SUFFICIENT TO COVER THE COST OF CONSTRUCTION INSPECTION AND RECORD PLANS.

COUNTY OF LOS ANGELES, CALIFORNIA

APPROVED: *Alfred Jones*
 COUNTY ENGINEER

APPROVED: *Cecilia Jones*
 CHIEF ENGINEER OF COUNTY SANITATION DISTRICT NO. 5

CHECKED BY: *John B. Knoll* March 20, 1947
 OFFICE OF COUNTY ENGINEER, REG. C.E. NO. 6522

RECEIVED MAR 23 1947
 COUNTY ENGINEER

Final CK.T.P. 3/18/45

C

C

B

B

2.41. H. H. CL. 81.91. E. B. 1182. 2. 1182 ST. & SUNDAL AVE. N.W. COR. 1 ST. JPK. E. EDGE OF WALK. 7'-4" OF C.R.

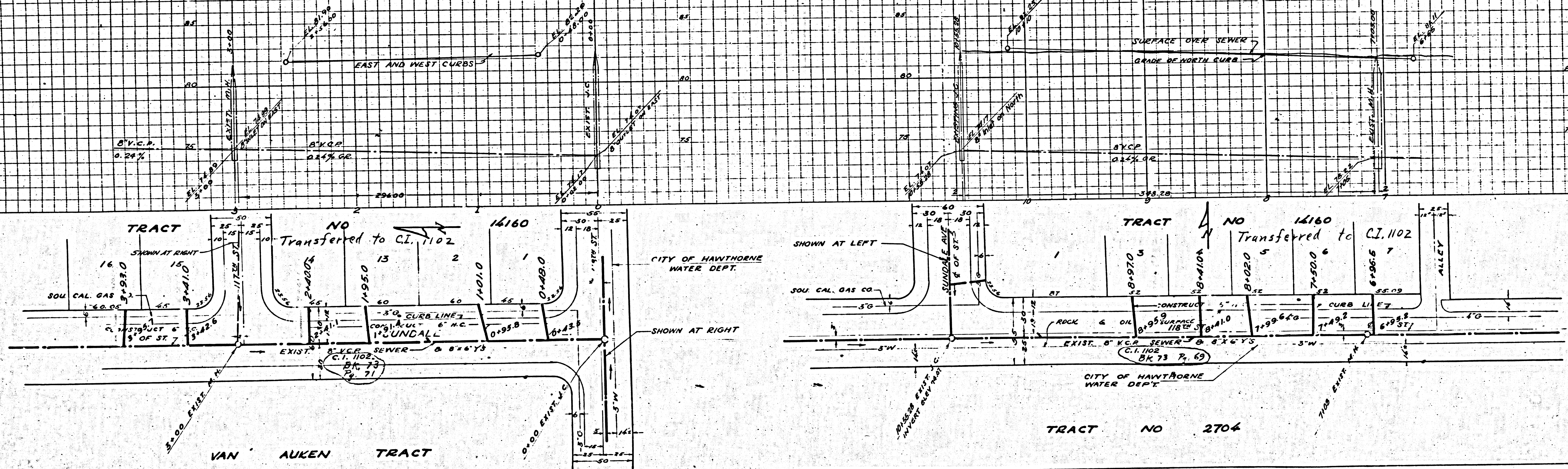

REV. PC 95

M3

M3

E 2