

TRIM PRINTS TO THIS LINE

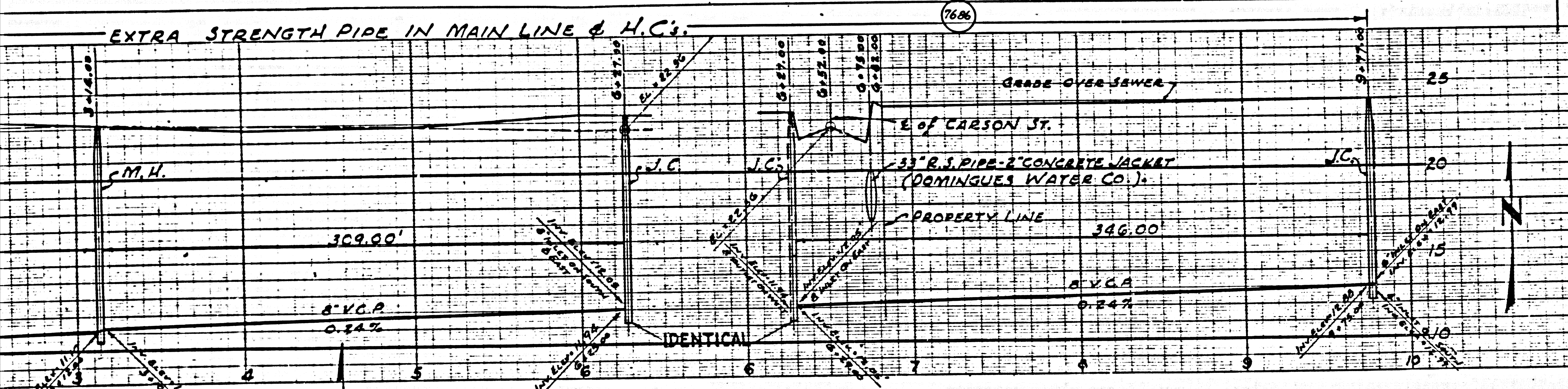

BM 8-03 ELEV. 23.835
 3" DIA. 10' DEEP AT CORNER, P.C. # 481
 23893422 - NINE CORNER OF
 CARSON & GRACE STREETS

PROFILE, ALIGNMENT AND GRADE OF
SANITARY SEWERS
 TO BE CONSTRUCTED IN
CARSON ST.
 EXTENDING EAST FROM GRACE ST.
 IN TRACT NO. 2982 M.A. 35-31
PRIVATE CONTRACT 481
W.S. - 28
ONE SHEET
 (DATE) JAN. 20, 1947

PREPARED IN THE OFFICES OF
BRANDON & JOHNSON
 CONSULTING ENGINEERS, LOS ANG.
 BY: *George L. Brandon*
 REG. C.E. NO. 5508

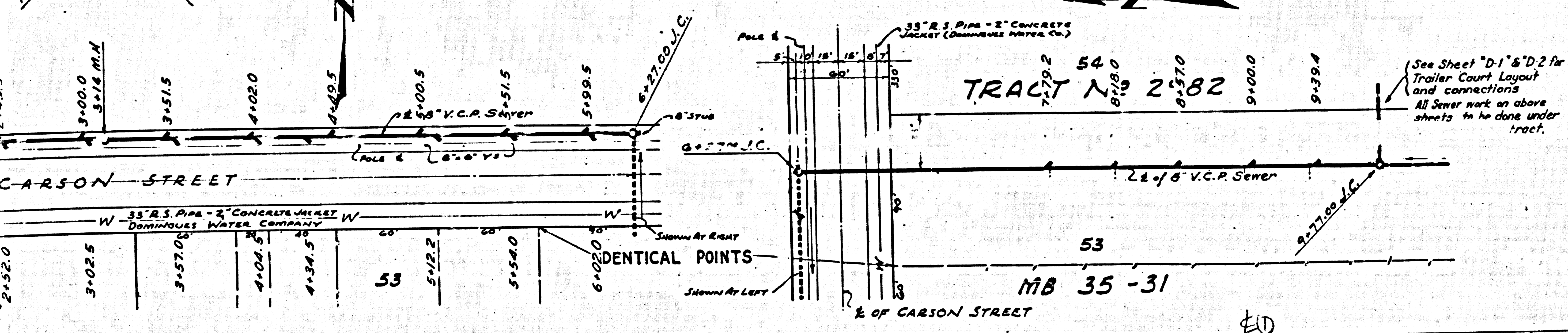

NOTE:-
 USE STANDARD MANHOLE FRAMES & COVER 3'-0" DIA.
 USE STANDARD STRENGTH PIPE (EXCEPT ALUMINUM)
 USE CEMENT MORTAR FOR ALL VITRIFIED CLAY PIPE JOINTS
 REPAIRS ALL TRENCH WITHIN PAVED AREA TO MEET
 LOS ANGELES COUNTY ROAD DEPARTMENT OR
 CALIFORNIA STATE HIGHWAY REQUIREMENTS
 ALL STRUCTURES SHALL BE BUILT SEWER STRUCTURES 3'-0" DIA.
 EXCEPT 4'-0" DIA. AT POINTS OF INTERFERENCE
 WITH PILES AS PER S-2-6

NOTE:
 GRADES TO WHICH THIS IMPROVEMENT IS TO BE CONSTRUCTED ARE SHOWN ON PLANS &
 PROFILES. GRADE POINTS, FOR THE CURB CENTRAL LINE OF STREET ARE SHOWN BY CIRCLES
 ON PROFILES. AT ALL POINTS BETWEEN DISTANCED POINTS, THE GRADE SHALL BE ESTABLISHED SO AS
 TO CONFORM TO A STRAIGHT LINE DRAWN BETWEEN SAID DISTANCED POINTS.
 ELEVATIONS ARE IN FEET ABOVE U.S. G.S. DATUM OR MEAN SEA LEVEL.
 THIS DRAWING & THE DATA THEREON ARE HEREBY MADE A PART OF THE SPECIFICATIONS.
 WORK SHALL BE CONSTRUCTED ACCORDING TO SPECIFICATIONS ON FILE IN THE OFFICE OF THE
 COUNTY ENGINEER, AND SHALL BE PROSECUTED ONLY IN THE PRESENCE OF THE COUNTY ENGINEER.
 BEFORE WORK CAN BE STARTED, THE CONTRACTOR MUST OBTAIN A PERMIT TO EXCAVATE IN COUNTY
 STREETS FROM THE L.A. COUNTY ROAD DEPT., 1108 HALL OF RECORDS, AND MAKE A DEPOSIT WITH
 THE COUNTY ENGINEER, 100 FASHION LEASE BLDG., SUFFICIENT TO COVER THE COST OF CON-
 TRACTION INSPECTION & RECORD PLANS.
 IF WORK IS TO BE DONE IN A STATE HIGHWAY, A PERMIT MUST BE OBTAINED FROM THE STATE OF
 CALIFORNIA DIVISION OF HIGHWAYS, 808 STATE BLDG. AFTER SHOWING THE DEPOSIT WITH THE COUNTY ENGINEER.
 THE OWNER OR HIS AUTHORIZED REPRESENTATIVE SHALL FURNISH THE COUNTY ENGINEER WITH
 GRADE SHEETS & STATIONS OF ALL HOUSE CONNECTIONS & 1" BENCHMANS AND SHALL FURNISH THE PERMIT
 FROM THE ROAD DEPT. TO THE ENGINEER. ANY CHANGE OF LOCATION
 SHALL BE REQUESTED IN WRITING BY THE OWNER OR HIS REPRESENTATIVE.
 NO REVISIONS SHALL BE MADE IN THESE PLANS WITHOUT APPROVAL OF THE COUNTY ENGINEER.
 COUNTY OF LOS ANGELES, CALIFORNIA

APPROVED: *George L. Brandon*
 COUNTY ENGINEER
 APPROVED: *Carl E. Johnson*
 COUNTY ENGINEER

RECEIVED
 FEB 24 1947
 COUNTY ENGINEER

CHECKED BY: *Carl E. Johnson* Feb 13 1947
 COUNTY ENGINEER REG. C.E. NO. 6622

Final CE TTP 3/15/48

TRIM PRINTS TO THIS LINE

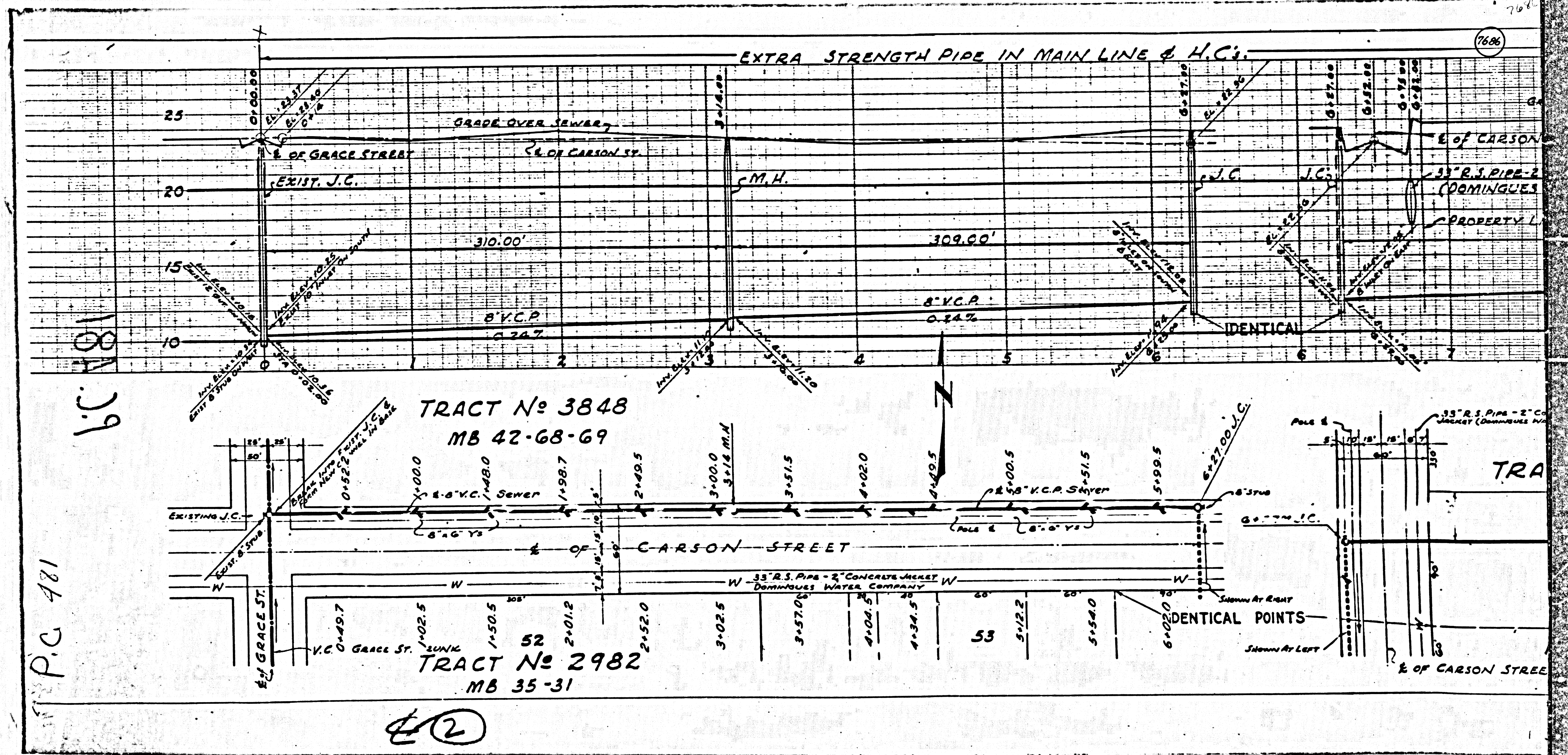

P.C. 481

P.C. 481

TRACT No 3848
MB 42-68-69

TRACT No 2982
MB 35-31

42

7686

TRA

M6