

CASH CONTRACT NO. 504

USE SEWER JOINT COMPOUND FOR ALL PIPE JOINTS
 USE EXTRA STRENGTH PIPE
 WHERE STATIONS ARE INDICATED ON PLANS JOIN H. C.
 TO EXISTING Y'S OR H.C.'S.
 RECONNECT EXISTING HOUSE SERVICES

PROFILE ALIGNMENT AND GRADE OF
SANITARY SEWER
 HOUSE CONNECTIONS
 TO BE CONSTRUCTED IN
SLAUSON AVENUE
 BETWEEN COMPTON AVE. AND CENTRAL AVE.

SHEET 1 OF 1 SHEETS

SCALE VERT 1"=4'
 HORIZ 1"=40'

APRIL 1938

COUNTY OF LOS ANGELES, CALIFORNIA
 ALFRED JONES COUNTY SURVEYOR

RECOMMENDED *W. H. Kreile*
 CHIEF DEPUTY

APPROVED *Alfred Jones*
 COUNTY SURVEYOR

APPROVED *W. H. Kreile*
 CHIEF ENGINEER OF COUNTY
 SANITATION DISTRICT NO. 1

FOR LEGEND
 SEE PLAN NO. 5-8-34

NOTE
 GRADES TO WHICH THIS IMPROVEMENT IS TO BE CONSTRUCTED ARE SHOWN ON PLANS AND PROFILES.
 GRADE POINTS FOR TOP OF CURB, CENTER LINE OF STREET OR CENTER LINE OF ALLEY ARE SHOWN BY
 CIRCLES ON PROFILES. AT ALL POINTS BETWEEN DESIGNATED POINTS THE GRADE SHALL BE ESTABLISHED
 SO AS TO CONFORM TO A STRAIGHT LINE DRAWN BETWEEN SAID DESIGNATED POINTS.
 ELEVATIONS ARE IN FEET ABOVE U. S. G. S. DATUM OR MEAN SEA LEVEL.
 UNIT PRICES FOR ADDITIONAL WORK WHICH MAY BE REQUIRED BUT WHICH CANNOT BE ASCERTAINED
 IN ADVANCE SHALL BE SUBMITTED IN THE PROPOSAL.
 THIS DRAWING AND THE DATA HEREON ARE HEREBY MADE A PART OF THE SPECIFICATIONS

REFERENCES			
W. S. 7	DESIGNED	<i>H. T. Spurling</i>	FEB. 1938
A. B. 317	TRACED	<i>J. E. Corville</i>	MAR. 1938
L. B.	CHECKED	<i>W. H. Kreile</i>	MAR. 1938

COMPTON AVE TO CENTRAL AVE
 AT ORANGE AVE (WIDENING)

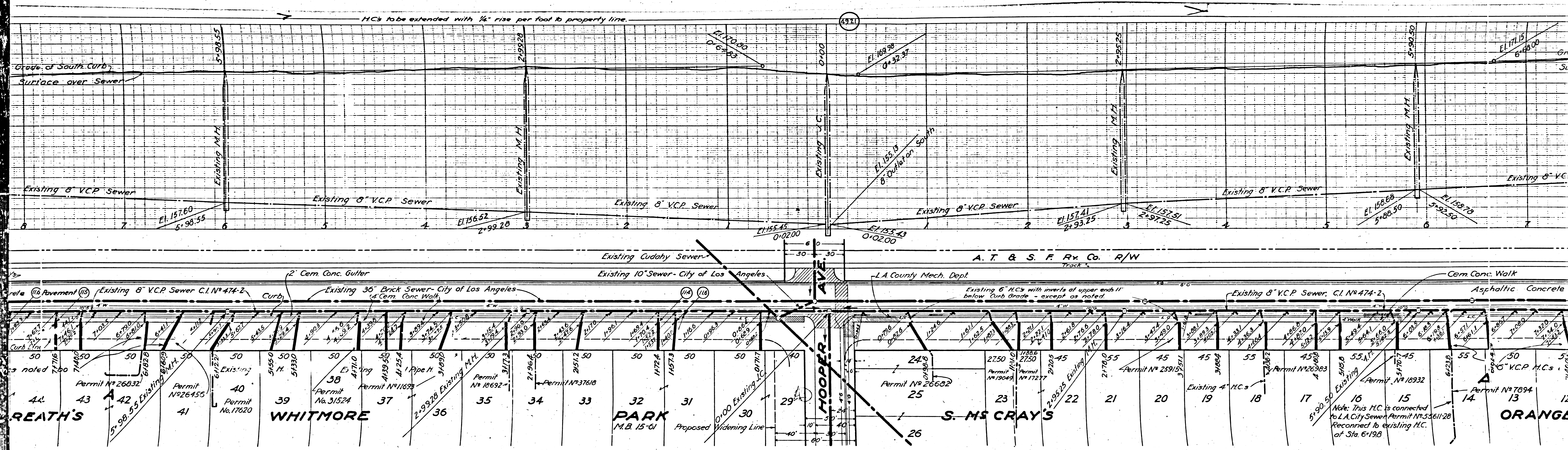

REATH'S 44
 43
A 42
 41
WHITMORE 39
 38
PARK 32
S. M. CRAY'S 26
ORANGE 13

Note: This H.C. is connected to L.A. City Sewer Permit No. 35611-28 Reconnected to existing H.C. at Sta. 6+19.8

