

L.C. 662  
 B.C. 662

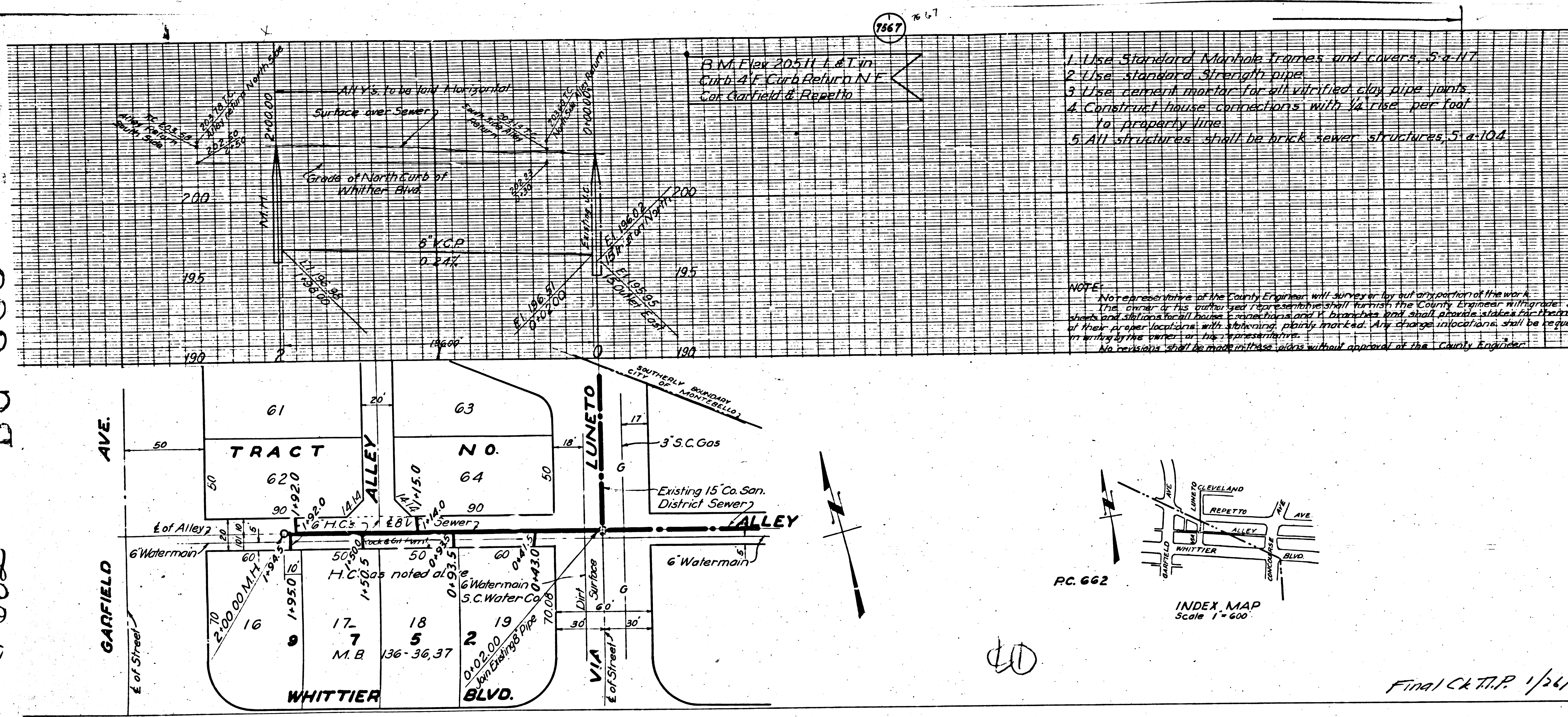

1. Use Standard Manhole frames and covers, 5'-0" x 7'
  2. Use standard strength pipe
  3. Use cement mortar for all vitrified clay pipe joints
  4. Construct house connections with 1/4" dia. per foot to property line
  5. All structures shall be brick sewer structures, 5'-0" x 10'-0"
- NOTE: No representative of the County Engineer will survey or lay out any portion of the work. The owner or his authorized representative shall furnish the County Engineer with grade scales and stations for all houses, connections and all branches and shall provide stakes for depth of their own locations with following plainly marked: All change in location shall be furnished in writing by the owner or his representative. No revisions shall be made in these plans without approval of the County Engineer.

PROFILE, ALIGNMENT AND GRADE OF  
**SANITARY SEWERS**  
**TO BE CONSTRUCTED IN**  
**ALLEY**  
 FIRST ALLEY NORTH OF WHITTIER BLVD.  
 BETWEEN VIA LUNETO AND GARFIELD AVE.

PRIVATE CONTRACT NO. 662  
 W.S. 36  
 OCT. 1947

SHEET 1 OF 1 SHEETS  
 PREPARED IN THE OFFICE OF  
**KARL F. TUTTLE**  
 BY *Karl F. Tuttle*

RE 2000  
 FOR LEGEND  
 SEE PLAN No. S-4-64

NOTE:  
 Grades to which this improvement is to be constructed are shown on Plans and Profile. Grade points for top of curb, center line of street or center line of alley are shown by circles on Profiles. At all points between designated points the grade shall be established so as to conform to a straight line drawn between said designated points. Elevations are in feet above U.S.G.S. datum or mean sea level. This drawing and the data hereon are hereby made a part of the specifications. Work shall be constructed according to specifications on file in the office of the County Engineer and shall be prosecuted only in the presence of the County Engineer. Before work can be started the Contractor must obtain a permit to excavate in County Streets from the L.A. County Road Dept., 104 Hill of Records, and make a deposit with the County Engineer, 700 Eastern League Bldg, sufficient to cover the cost of construction inspection and record plans. If work is to be done in a State Highway, a permit must be obtained from the State of California, division of Highways, 808 State Bldg after making the deposit with the County Engineer. COUNTY OF LOS ANGELES, CALIFORNIA

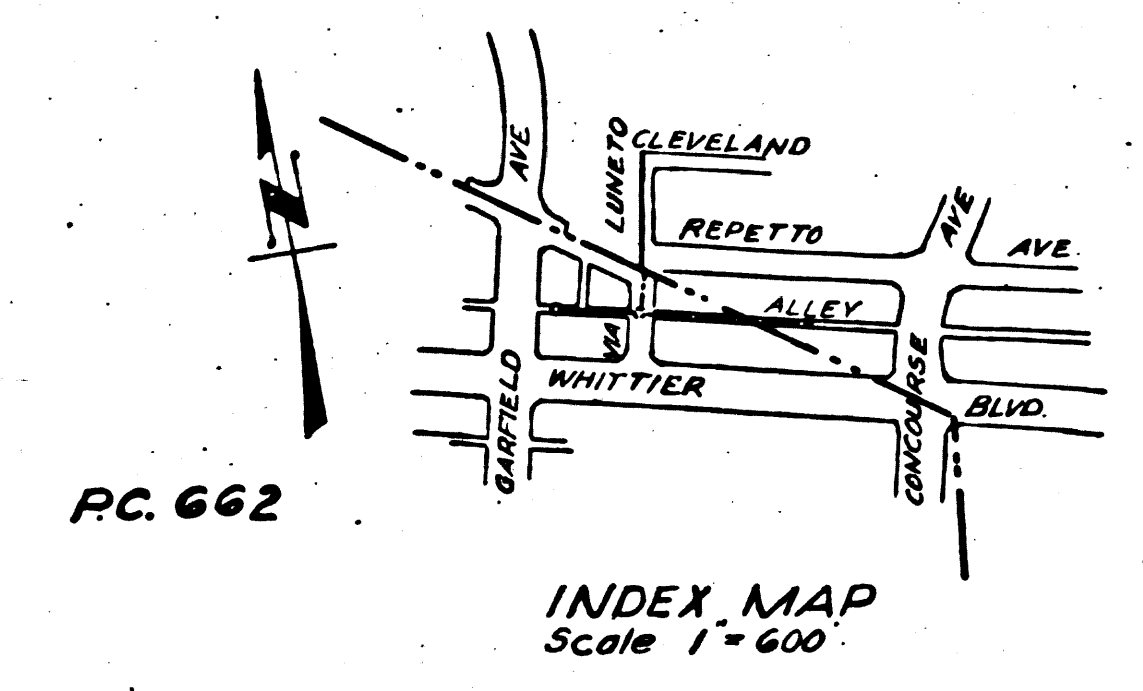

APPROVED *Alfred Jones*  
 COUNTY ENGINEER

APPROVED *[Signature]*  
 CHIEF ENGINEER OF COUNTY  
 SANITATION DISTRICT NO. 2

CHECKED BY *I. E. Moore* Oct 23 1947  
 Office of County Engineer, R.E. No. 2322

FINAL C&T.P. 1/24/48