

- (1) Use standard manhole frames and covers 30x37.
- (2) Use standard straight pipe.
- (3) Use cement mortar joint vitrified clay pipe pipe.
- (4) Reinforce all trenches within paved areas to meet Los Angeles County Road and/or California State Highway requirements.
- (5) All structures shall be brick sewer structures, 24x24.
- (6) Close all abandoned sewer pipe openings with brick and cement mortar.
- (7) Return all material salvaged from abandoned sewer line to Los Angeles County Maintenance Yard at 1229 East 53rd St Los Angeles.

NOTE:
 No representation of the County Engineer will be given on any portion of this work.
 The owner or his authorized representative shall provide the County Engineer with grade sheets and sketches of all house connections and eye brackets and shall provide release for them at their proper locations with satisfactory identity marked. Any change of location shall be requested in writing by the owner or his representative.
 No work shall be done in these places without approval of the County Engineer.

PROFILE, ALIGNMENT AND GRADE OF
SANITARY SEWER
 TO BE CONSTRUCTED IN
ALAMEDA STREET
 BETWEEN EXISTING SEWER IN ALAMEDA ST.
 AND EXISTING SEWER IN ALLEY
PRIVATE CONTRACT NO. 712
 W.S. 75
 SHEET 1 OF 1 SHEET
 SCALE: PLAN 1" = 40'
 PROFILE 1" = 4'

PLAN AND PROFILE PREPARED BY
G.T. SULLIVAN - ENGINEERING SERVICE.
 G.T. Sullivan P.C.E. 158
 RECEIVED
 JAN 28 1948
 COUNTY ENGINEER

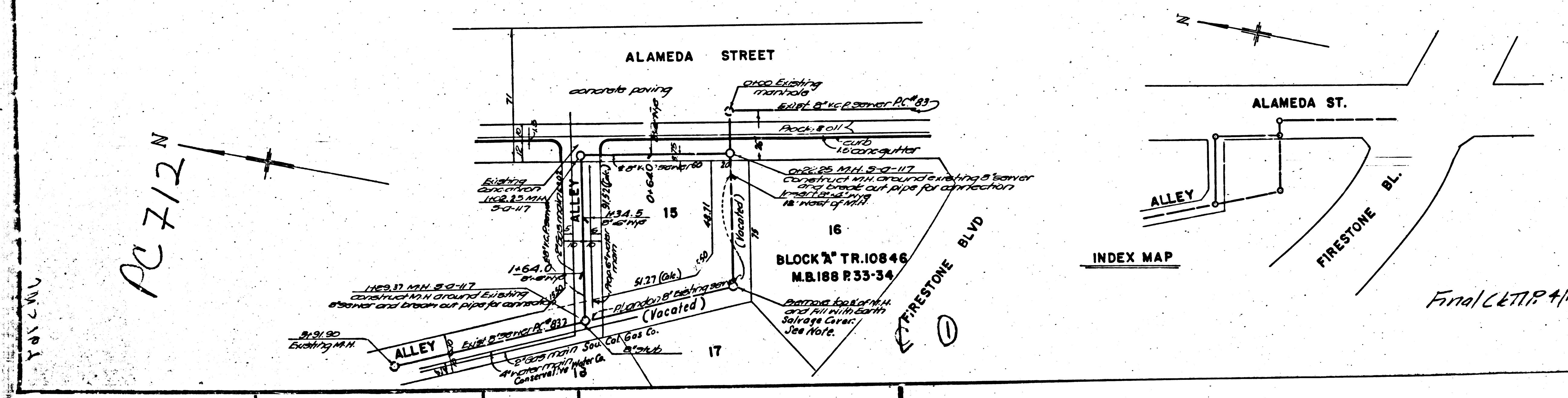

FORM LEGEND
 See Plan No. 5-0-64
 Note: Grades to which this improvement is to be constructed are shown on plan and profile. Grade points for top of curb, centerline of street, or centerline of Alley are shown by circles on profiles. At all points between designated points the grade shall be established so as to conform to a straight line drawn between said designated points.
 This drawing and the data hereon are hereby made a part of the specifications.
 Work shall be constructed according to specifications on file in the office of the County Engineer and shall be prosecuted only in the presence of the County Engineer.
 Before work can be started the contractor must obtain a permit to excavate in County streets from the L.A. County Road Dept., 1004 Hall of Records, and make a deposit with the County Engineer, 700 Fashion League Building, sufficient to cover the cost of construction, inspection and record plans.
 If work is to be done in a state highway, a permit must be obtained from the state of California, Division of Highways, 808 State Building, after making the deposit with the County Engineer. Elevations are in feet above U.S.G.S. Datum or mean sea level.

APPROVED: *[Signature]*
 COUNTY ENGINEER
 CHECKED BY: *[Signature]*
 OFFICE ENGINEER
 FIN/CET/P 4/13/48

D.C. 1110