

PROFILE ALIGNMENT AND GRADE OF  
**SANITARY SEWER**  
 TO BE CONSTRUCTED IN  
 SEWER R/W IN TRACT NO 15098  
 FROM LOWER AZUSA ROAD NORTHERLY 450'

PRIVATE CONTRACT NO 804  
 W.S. 44  
 SHEET 1 OF 1 SHEET

- Note:** Use standard manhole frames and covers S-117 except as noted  
 Use standard strength pipe  
 Use cement mortar for all vitrified clay pipe joints  
 Resurface all tracks within paved areas to meet Los Angeles County Road Dept requirements  
 All structures shall be back sewer elevations 6-in 104 except as noted  
 Construct tops of all structures in Right of Way 6 inches finished grade
- Note:** Sanitation District must be notified before work can be started
- Note:** No representative of the County Engineer will survey or lay out any portion of the work. The owner or his authorized representative shall furnish the County Engineer with grade sheets and stations of all house connections and Y branches and shall provide stakes for these at appropriate locations with stationing plainly marked. Any change of location shall be requested in writing by the owner or his representative. No revisions will be made in these plans without approval of the County Engineer.

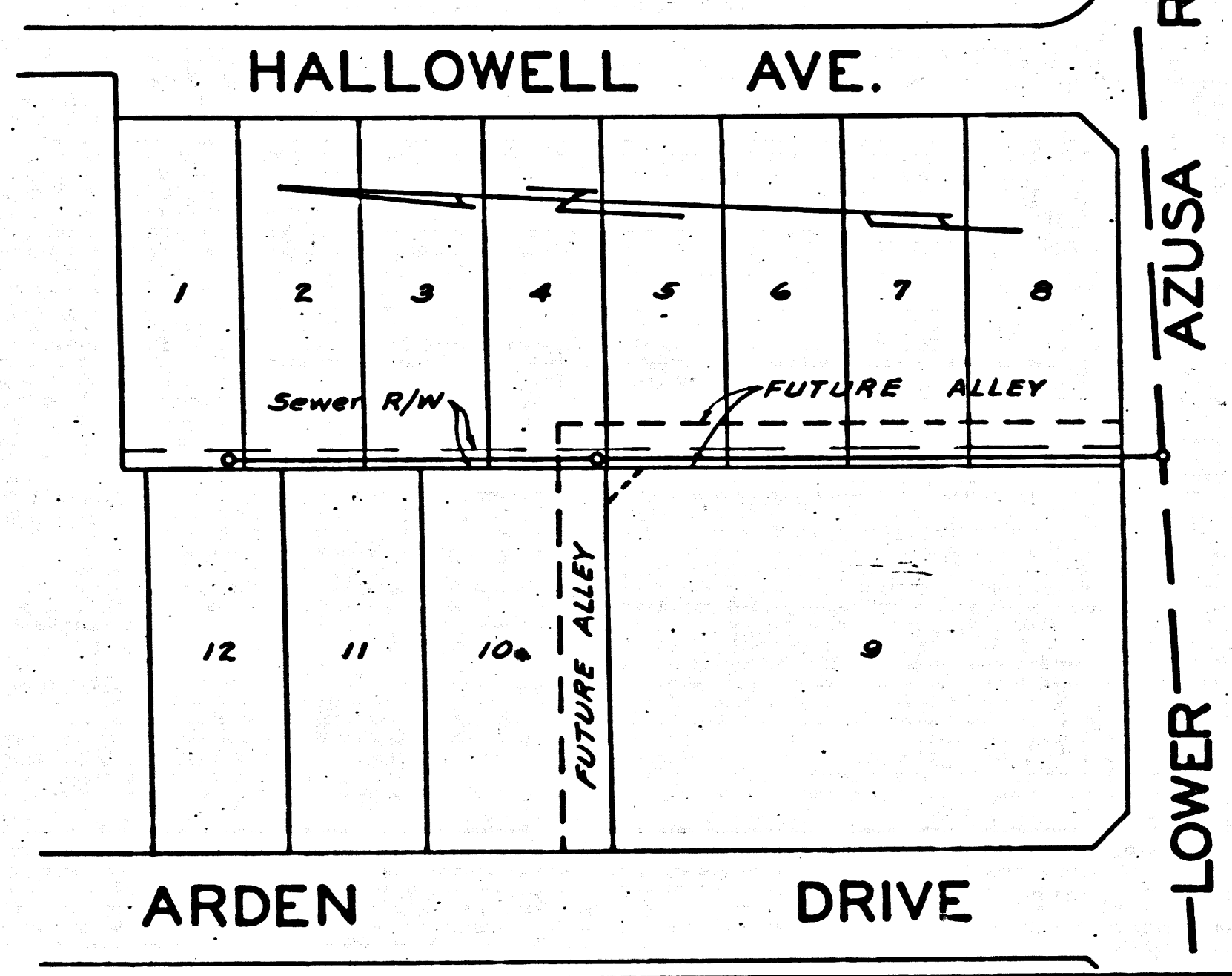
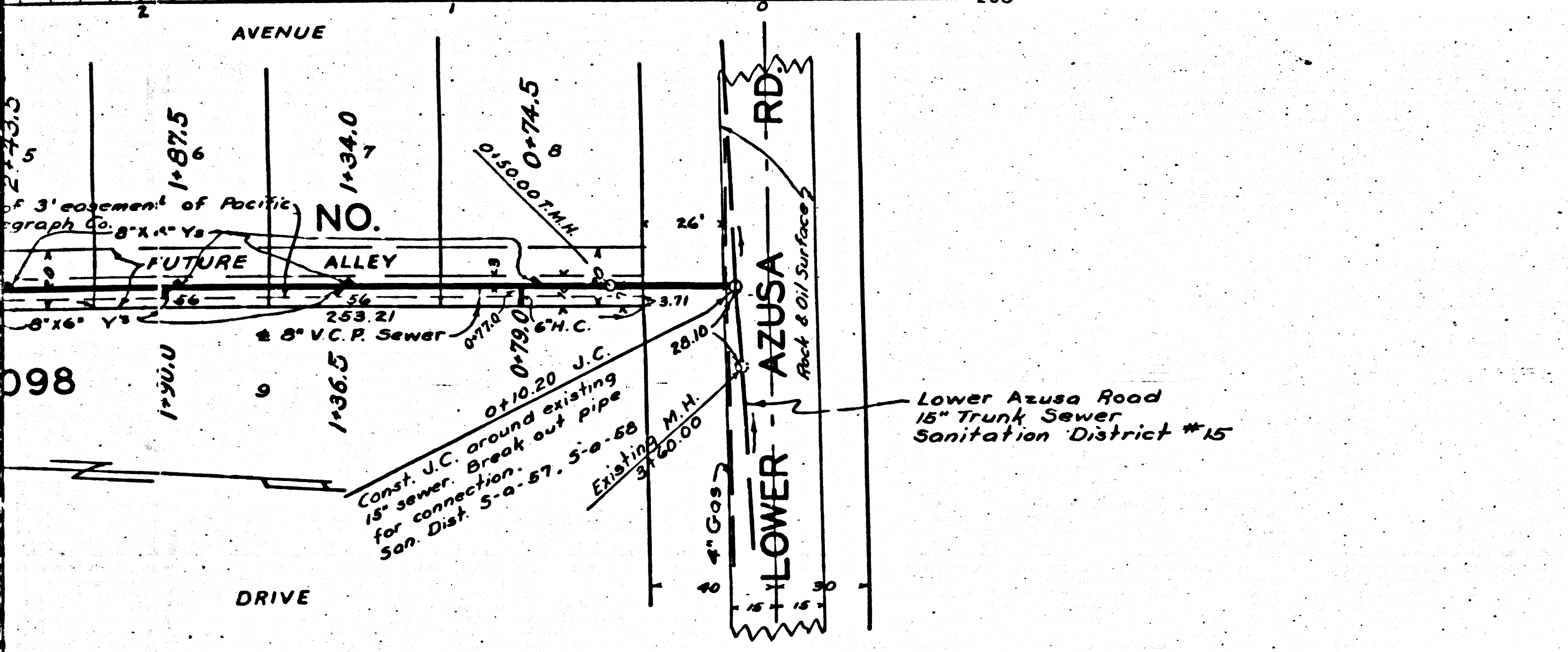

INDEX MAP OF  
 TRACT NO. 15098  
 P.C. NO. 804

Final Ck. T.I.P 11/10/23

For Legend see plan No 3-a-64

Prepared by *Lin W. Moore*  
 Reg. C.E. No. 3117

- Note:**
- Grades to which this improvement is to be constructed are shown on plan and profile.
  - Grade points for top of curb, center line of street, or center line of alley are shown by number on profile. At all points between designated points the grade shall be established so as to conform to a straight line drawn between said designated points.
  - Elevations are in feet above U.S.C. datum or mean sea level.
  - This drawing and the data hereon are hereby made a part of the specifications.
  - Work shall be constructed according to specifications on file in the office of the County Engineer and shall be prosecuted only in the presence of the County Engineer.
  - Before work can be started the Contractor must obtain a permit to excavate in County limits from the Los Angeles County Road Dept, 211 S. Main St. and make a deposit with the County Engineer, 700 Fashion League Building, sufficient to cover costs of inspection and record plans.

County of Los Angeles  
 Approved: *[Signature]*  
 County Engineer  
 Approved: *[Signature]*  
 For Chief Engineer of County Sanitation District #15  
 Approved: *[Signature]*  
 Office of the County Engineer  
 Date: 11/10/23

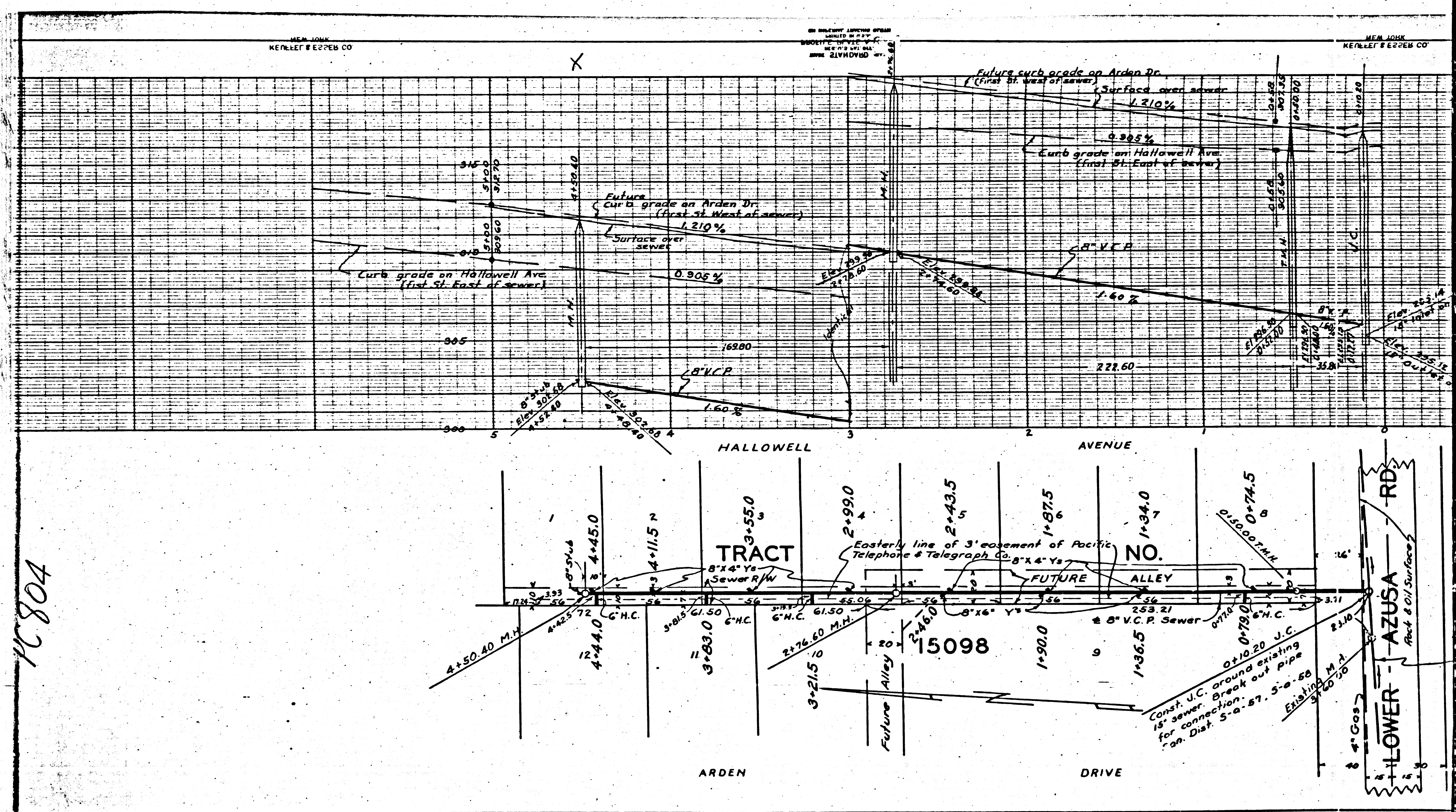

11804

10

MB