

- Spec. No. 3, Rd. Dept. F.B. 2-3/14, Etc.**
 Cut. Sp. in P.A. 308323
 N.W. Sec. 1, Laurel Ave. & Virginia Dr.
1. Use Standard Manhole, Frames and Covers, S-a-117.
 2. Use Standard Strength Pipe.
 3. Use Cement Mortar for all Vitrified Clay Pipe Joints.
 4. Resurface all trench within paved area to meet L.A. County Road Dept. requirements.
 5. Excise four feet of Sewer at points of interference with Poles as per S-a-119.
 6. All Structures shall be brick Sewer Structures S-a-104, except as noted.
 7. Construct House Connections with invert at Property Line 4 feet below Curb Grade, except as noted.

NOTE: Sanitation District must be notified before work can start.

NOTE: No representative of the County Engineers will survey or lay out any portion of the work. The owner or his authorized representative shall furnish the County Engineer with Grade Sheets and Stations for all House Connections and all Structures and shall locate edges for them at their proper locations with stations plainly marked. Any change of location shall be requested in writing by the owner or his representative. No revisions shall be made in these Plans without approval of the County Engineer.

**PROFILE ALIGNMENT AND GRADE OF
 SANITARY SEWERS
 TO BE CONSTRUCTED IN
 LAUREL AVENUE
 BETWEEN CLARK AVE. & VIRGINIA DR.
 PENNSWOOD AVENUE
 BETWEEN LAUREL AVE. & HARRISON ST.
 HARRISON STREET
 BETWEEN PENNSWOOD AVE. & VIRGINIA DR.**

**PRIVATE CONTRACT NO. 846
 W-3-33
 SHEET 1 OF 1 SHEET**

Scale: Vert. 1"=4'
 Horiz. 1"=40' July 1948

**PREPARED IN THE OFFICES OF
 JONES & GILBERT**

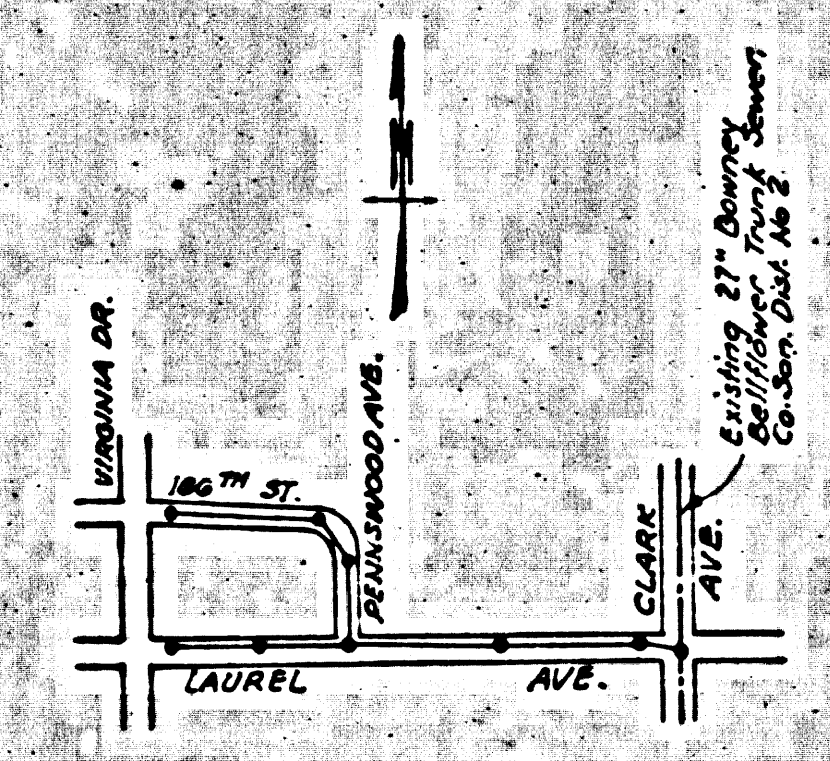
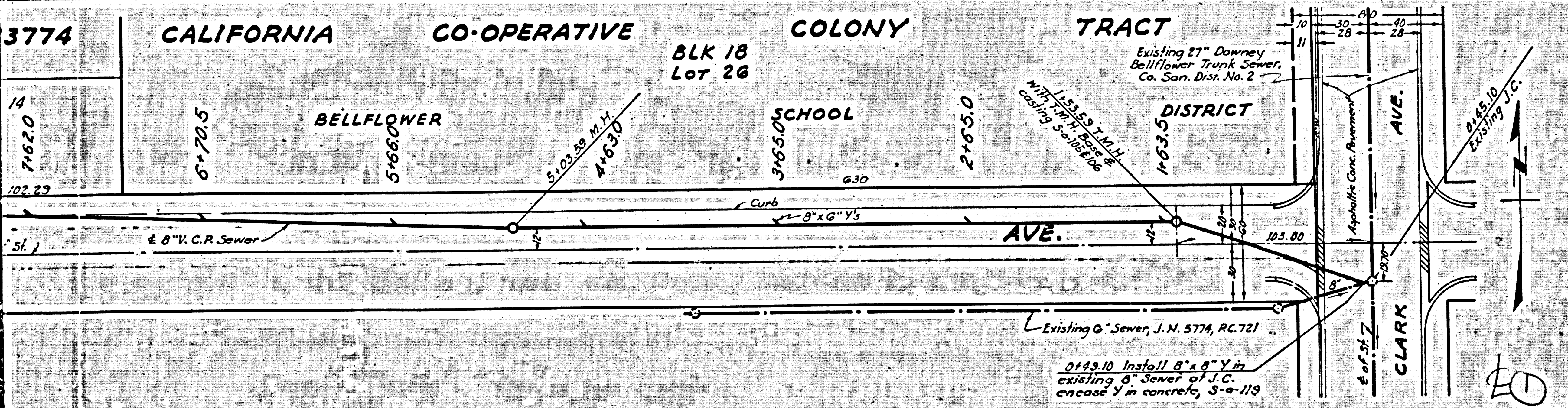

**INDEX MAP
 Scale: 1"=600'
 P.C. 846**

NOTE: Grades to which this improvement is to be constructed are shown on Plans and Profiles. Grade points for top of curb, center line of streets or center line of alley are shown by circles on Profiles. At all points between designated points the grade shall be established so as to conform to a straight line drawn between said designated points. Elevations are in feet above U.S.S. Datum or Mean Sea Level.

This drawing and the data hereon are hereby made a part of the specifications. Work shall be constructed according to specifications on file in the office of the County Engineer and shall be prosecuted only in the presence of the County Engineer. Before work can be started the Contractor must obtain a permit to excavate in County Streets from the L.A. County Road Dept. 211 South Main St. and make a deposit with the County Engineer 100 Fashion League Building, sufficient to cover cost of Construction Inspection and Record Plans.

COUNTY OF LOS ANGELES, CALIFORNIA

APPROVED: *[Signature]*
 County Engineer

APPROVED: *[Signature]*
 Chief Engineer of County
 Sanitation District No. 2

CHECKED: *[Signature]* July 7, 1948
 Chief of County Engineers, Reg. C. E. No. 6322

P.C. 846

