

PLAN, PROFILE AND GRADE OF
SANITARY SEWERS
 TO BE CONSTRUCTED IN
 SANITARY SEWER RIGHT OF WAY
 IN
 LOT 8, BLK. 3, ROSEMEAD, M.B. 12-194, 195
 FROM
 425 FT. WEST OF MUSCATEL AVE.
 TO
 410 FT. SOUTH OF MISSION DR.

PRIVATE CONTRACT NO. 1309
 W.S. 44
 ONE SHEET
 SCALE VERT. 1" = 4'
 HORIZ. 1" = 40'
 MARCH 1950

CHECKED AND APPROVED BY
Charles C. Miller
 Reg. Civil Engineer No. 122.

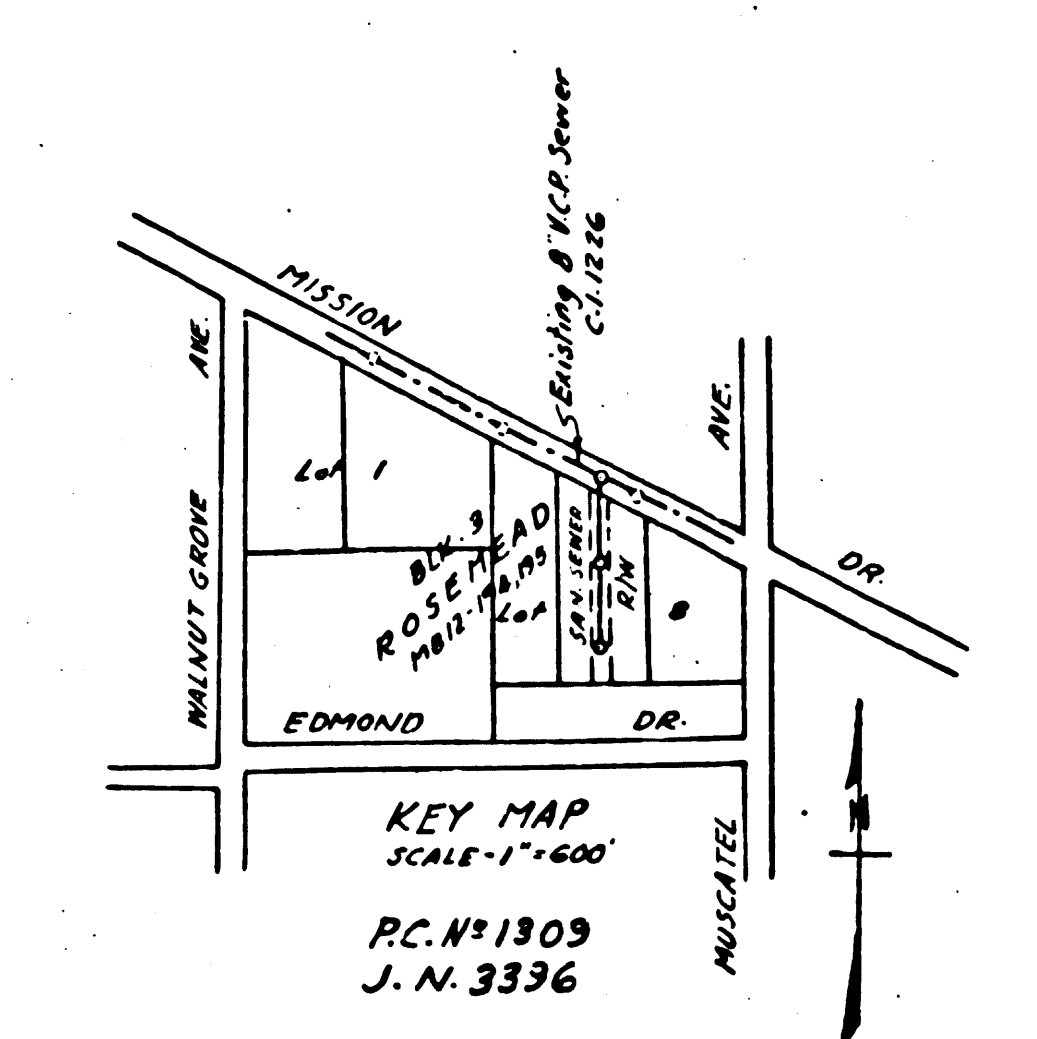
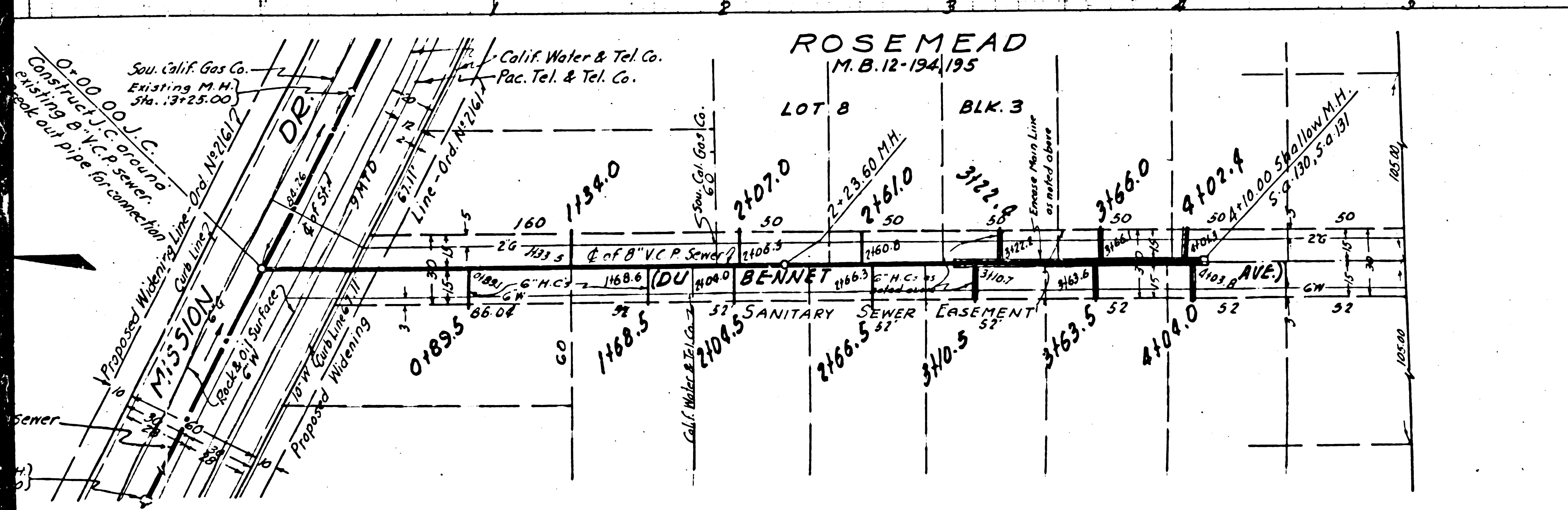

NOTE:-
 GRADES TO WHICH THIS IMPROVEMENT IS TO BE CONSTRUCTED ARE SHOWN ON PLAN AND PROFILE GRADE POINTS FOR TOP OF CURB, CENTER LINE OF STREET, CENTER LINE OF ALLEY AND TOP OF MANHOLES ARE SHOWN BY CIRCLE ON PROFILE. AT ALL POINTS BETWEEN SAID DESIGNATED POINTS THE GRADE SHALL BE ESTABLISHED SO AS TO CONFORM TO A STRAIGHT LINE DRAWN BETWEEN SAID DESIGNATED POINTS.
 ELEVATIONS ARE IN FEET ABOVE U.S.G.S. DATUM OR MEAN SEA LEVEL.
 THIS DRAWING AND THE DATA HEREON ARE HEREBY MADE A PART OF THE SPECIFICATIONS. WORK SHALL BE CONSTRUCTED ACCORDING TO SPECIFICATIONS ON FILE IN THE OFFICE OF THE COUNTY ENGINEER AND SHALL BE PROSECUTED ONLY IN THE PRESENCE OF THE COUNTY ENGINEER.
 BEFORE WORK CAN BE STARTED THE CONTRACTOR MUST OBTAIN A PERMIT TO EXCAVATE IN COUNTY STREETS FROM THE L.A. COUNTY ROAD DEPT., 211 SOUTH MAIN ST., AND MAKE A DEPOSIT WITH THE COUNTY ENGINEER, 828 L.A. COUNTY ENGINEERING BLDG., SUFFICIENT TO COVER THE COST OF CONSTRUCTION INSPECTION AND REPROD. PLANS.
 APPROVAL OF THIS PLAN BY THE COUNTY OF LOS ANGELES DOES NOT CONSTITUTE A REPRESENTATION AS TO THE ACCURACY OF THE LOCATION OF OR THE EXISTENCE OR NON-EXISTENCE OF ANY UNDERGROUND UTILITY, PIPE OR STRUCTURE, WITHIN THE LIMITS OF THIS PROJECT.

COUNTY OF LOS ANGELES, CALIFORNIA
 APPROVED *[Signature]* COUNTY ENGINEER
 OFFICE ENGINEER
 FOR CHIEF ENGINEER OF COUNTY
 SANITATION DISTRICT NO. 12

Checked by *[Signature]* 4-11-50
 Office of County Engineer
 Reg. C. No. 6322

