

FI-405(6)

PWA DIV. NO.	STATE	FEDERAL PROJECT NO.	FISCAL YEAR	SHEET NO.	TOTAL SHEETS
	CALIF.			21	37

Dist.	County	Route	Section	Sheet No.	Total Sheets
VII	L.A.	168	A	21	37

N. E. Curran
District Engineer

Approved June 11, 1951

Approved June 11, 1951

Approved June 11, 1951

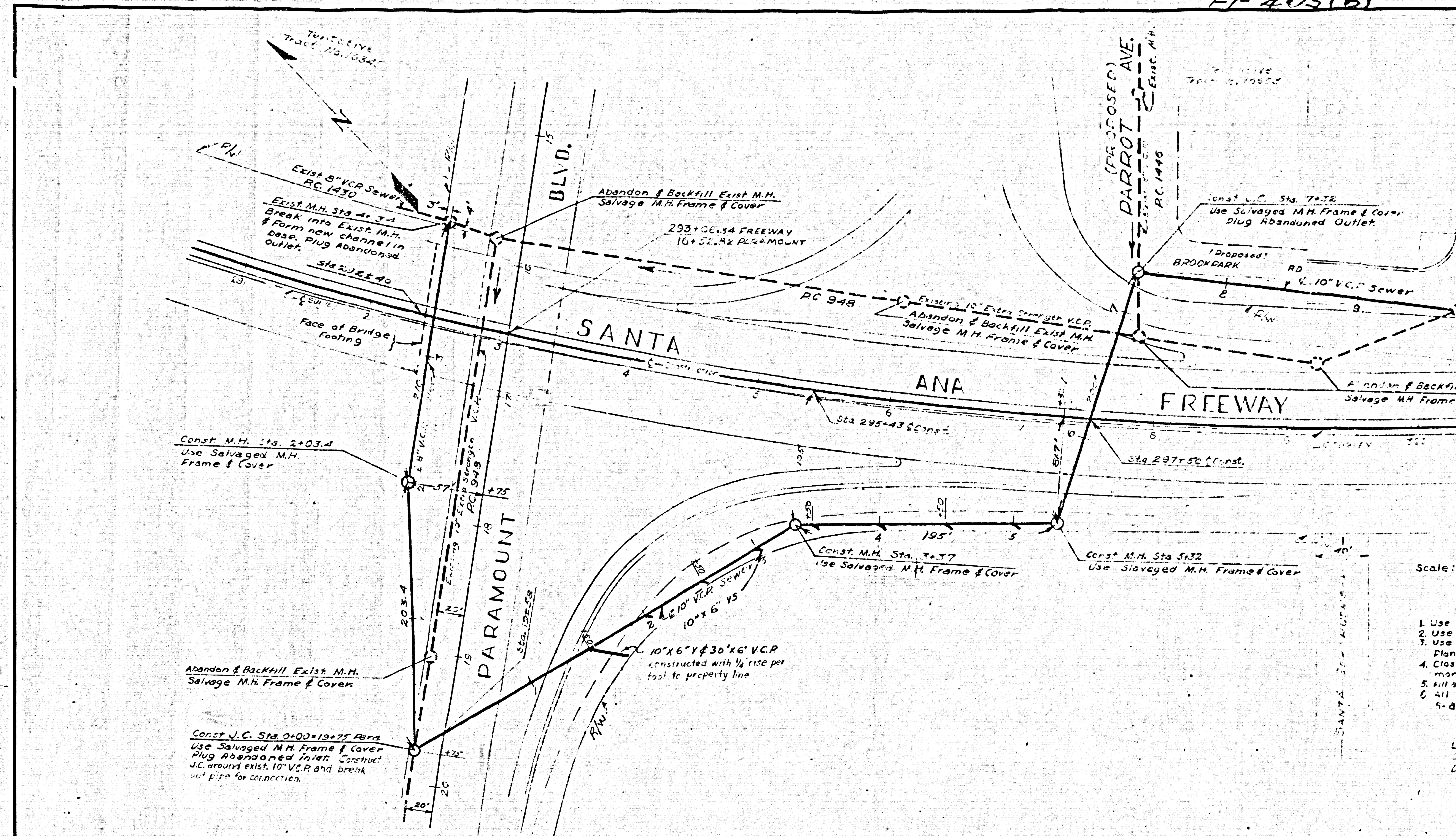

County of Los Angeles, California
P.C. 1536

Scale: 1" = 50' Horiz.
1" = 5' Vert.

W.S. 36

Notes

1. Use standard strength pipe except as noted.
2. Use Camlock marker for all vitrified clay pipe joints.
3. Use manhole frame and covers as per L.A. County Plan No. S-117 except where salvaged covers are used.
4. Close all abandoned sewer pipe openings with cement mortar.
5. Fill all abandoned sewer structures with earth.
6. All structures shall be brick sewer structures as per S-104.

Los Angeles County Engineer
Del Rio Ave. 100 E. of Stockton Ave.

Checked By *Richard E. Kulan* 10-10-50
OFFICE OF COUNTY ENGINEER
RECEIVED 1950

P.C. 1536

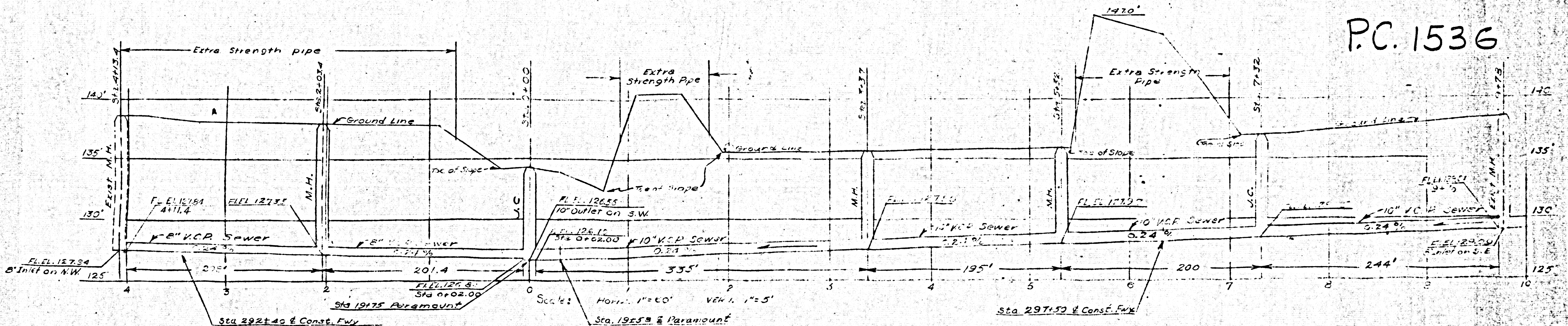

Design Dept.	Initial	Date
Designed	J.M.	8/50
Traced	J.M.	8/50
Checked	J.M.	8/50
Supervised By	<i>Quinn</i>	

SANITARY SEWER

109-5