

B.M. U.S.S. Std. Dia. in Corner at N.W. Cor. Reasons Blvd. & Dunlap Crossing Road. A-14. 1722. Elev. 169.74

APPROVAL OF THIS PLAN BY THE COUNTY OF LOS ANGELES DOES NOT CONSTITUTE A REPRESENTATION AS TO THE ACCURACY OF THE EXISTENCE OR NON-EXISTENCE OF ANY UNDERGROUND UTILITY, PIPE OR STRUCTURE WITHIN THE LIMITS OF THIS PROJECT.

(12.894)	USE STANDARD STRENGTH PIPE EXCEPT AS NOTED
	USE CEMENT MORTAR FOR ALL VITRIFIED CLAY PIPE JOINTS
	ENCASE FOUR FEET OF SEWER AT POINTS OF INTERFERENCE WITH POLES AS PER S-419
	CONSTRUCT HOUSE CONNECTIONS WITH INVERT AT PROP. LINE 5' FEET BELOW GRADE OF E. OF ALLEY EXCEPT AS NOTED
	ALL STRUCTURES SHALL BE BRICK SEWER STRUCTURES AS PER PLAN NO. S-414 EXCEPT AS NOTED
	USE STANDARD MANHOLE FRAMES AND COVERS AS PER PLAN NO. S-417 EXCEPT AS NOTED
	CONSTRUCT TOPS OF ALL STRUCTURES IN RIGHTS OF WAY 6" ABOVE FINISHED GRADE
	RESURFACE ALL TRENCHES WITHIN PAVED AREA TO MEET LOS ANGELES COUNTY ROAD DEPT. OR STATE HIGHWAY REQUIREMENTS IN ACCORDANCE WITH PERMITS
	PROVIDE STAKES ON THE PROPERTY LINES OR PROPERTY LINES PRODUCED, AT RIGHT ANGLES TO THE SEWER LINE AT THE CENTER LINE OF EACH MANHOLE
	NO REVISIONS SHALL BE MADE IN THESE PLANS WITHOUT APPROVAL OF THE COUNTY ENGINEER
	NO REPRESENTATIVE OF THE COUNTY ENGINEER WILL SURVEY OR LAY OUT ANY PORTION OF THE WORK
	THE OWNER OR HIS AUTHORIZED REPRESENTATIVE SHALL FURNISH THE COUNTY ENGINEER WITH GRADE SHEETS AND STATIONS OF ALL HOUSE CONNECTIONS AND Y BRANCHES AND SHALL PROVIDE STAKES FOR THEM AT THEIR PROPER LOCATIONS WITH STATIONING PLAINLY MARKED. ANY CHANGE OF LOCATION SHALL BE REQUESTED IN WRITING BY THE OWNER OR HIS REPRESENTATIVE

PROFILE ALIGNMENT AND GRADE OF  
**SANITARY SEWERS**  
TO BE CONSTRUCTED IN  
**FIRST ALLEY SOUTH OF BRADHURST ST.**  
BETWEEN E. & W. BOUNDARIES OF  
**TRACT NO 16502**

PRIVATE CONTRACT NO. 1586  
W. S. 34  
SHEET / OF / SHEETS

SCALE: VERT. 1"=4'-0"  
HORIZ. 1"=40'-0"

PREPARED IN THE OFFICES OF  
**KEMMERER ENG. CO. INC.**  
BY: *H. L. Snelson*  
REG. E. C. NO. 1281  
DEC 19 1950

FOR LEGEND  
SEE PLAN NO. S-414

NOTE: GRADES TO WHICH THIS IMPROVEMENT IS TO BE CONSTRUCTED ARE SHOWN ON PLANS AND PROFILES. GRADE POINTS FOR TOP OF CURB, CENTER LINE OF STREET OR CENTER LINE OF ALLEY ARE SHOWN BY CIRCLES ON PROFILES. AT ALL POINTS BETWEEN DESIGNATED POINTS THE GRADE SHALL BE ESTABLISHED AS TO CONFORM TO A STRAIGHT LINE DRAWN BETWEEN SAID DESIGNATED POINTS. ELEVATIONS ARE IN FEET ABOVE U. S. G. S. DATUM OR MEAN SEA LEVEL.

THIS DRAWING AND THE DATA HEREON ARE HEREBY MADE A PART OF THE SPECIFICATIONS FOR THE WORK AND SHALL BE CONSIDERED AS SUCH. BEFORE WORK CAN BE STARTED, THE CONTRACTOR MUST OBTAIN A PERMIT TO EXCAVATE IN COUNTY STREETS FROM THE L. A. COUNTY ROAD DEPT. 211 BOLMAIN ST. LOS ANGELES AND MAKE A DEPOSIT WITH THE COUNTY ENGINEER, ROOM 320 AT 104 W. 19TH STREET, SUFFICIENT TO COVER THE COST OF CONSTRUCTION INSPECTION AND RECORD PLANS.

NO WORK IS TO BE DONE IN A STATE HIGHWAY, A PERMIT MUST BE OBTAINED FROM THE STATE OF CALIFORNIA, DIVISION OF HIGHWAYS, 808 STATE BUILDING, AFTER MAKING THE DEPOSIT WITH THE COUNTY ENGINEER.

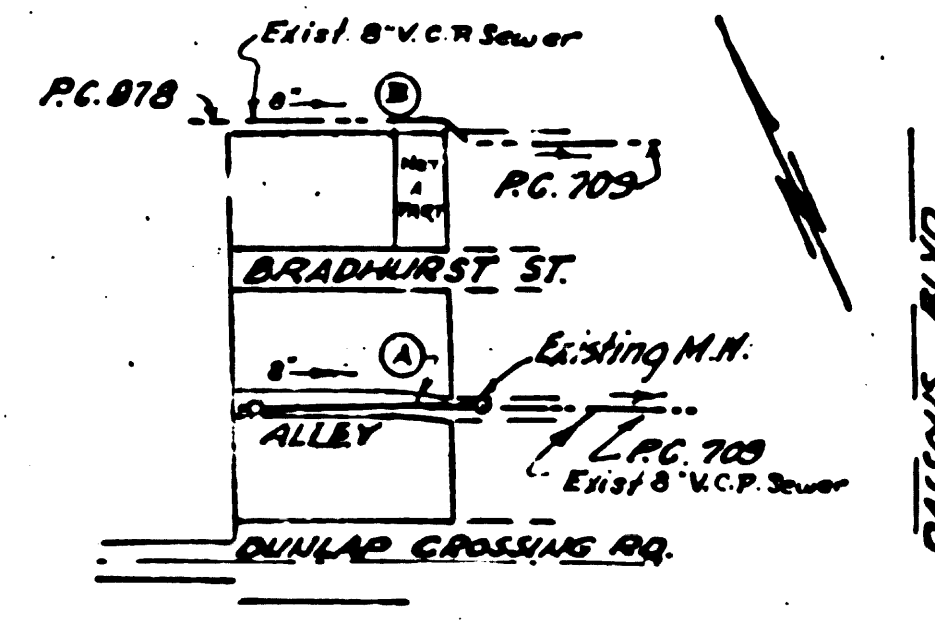
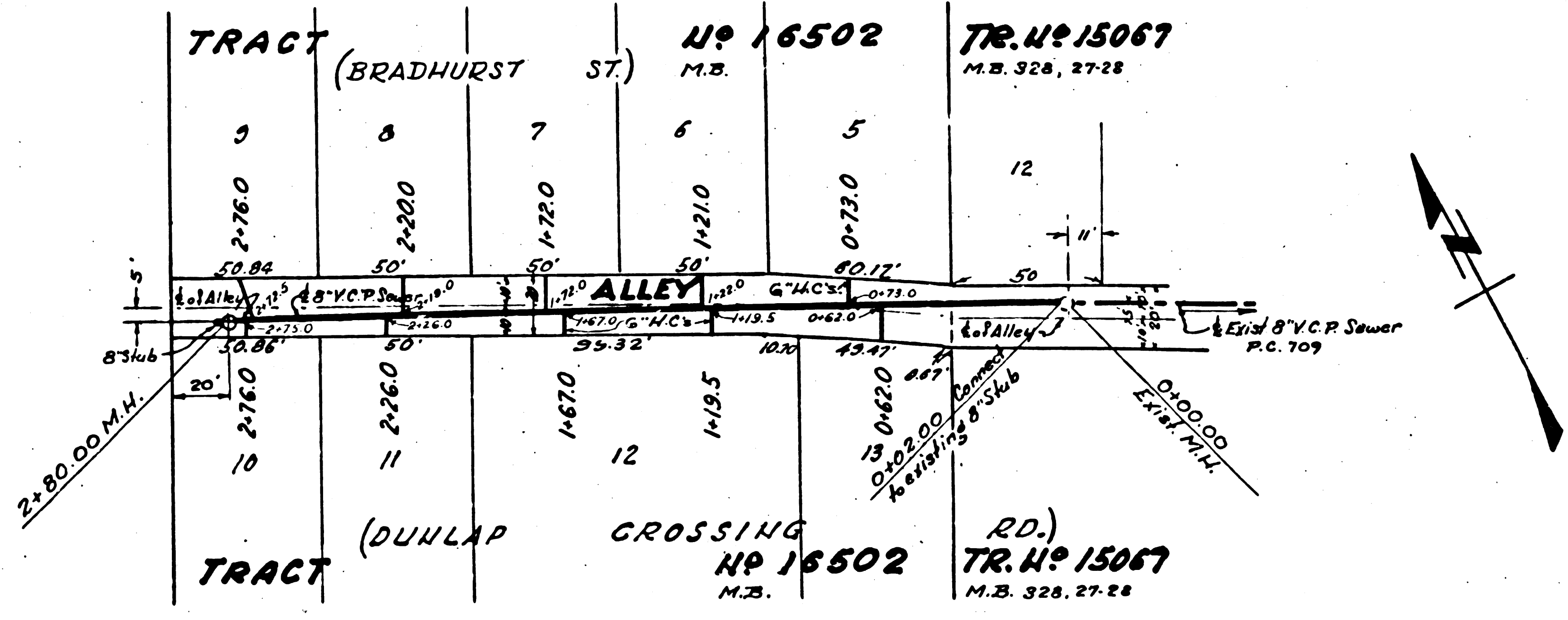

APPROVED: *H. L. Snelson*  
COUNTY ENGINEER

APPROVED BY: *A.M. BAWIN*  
OFFICE ENGINEER

CHECKED BY: *H. L. Snelson*  
OFFICE OF COUNTY ENGINEER, REG. E. C. NO. 1281



