

(1) Use standard manhole frame and cover, 3' x 4' 1/2"  
 (2) Use standard strength pipe  
 (3) Use cement mortar for all vitrified clay pipe joints  
 (4) Construct house connections with 1/2" rise per ft to  
 right of house line. It is to be laid horizontal.  
 (5) Excavate four feet of sewer at points of  
 discontinuance with holes, Sec. 54-102.  
 (6) All structures shall be brick sewer structures, Sec. 108  
 (7) Resurface all trench within paved areas to meet Los Angeles County Road Dept. requirements  
 in accordance with the permit.  
 Note:  
 The responsibility of the County Engineer will survey, or by any  
 portion of the work.  
 The owner or his authorized representative shall furnish  
 the County Engineer with grade sheets and stations of  
 all house connections and T branches and shall provide  
 stakes for them at their proper locations with stations  
 clearly marked.  
 Any change or location shall be requested in writing by the  
 owner at his own expense.  
 No repairs shall be made in these lines without approval  
 of the County Engineer.  
 Note:  
 Provide stakes on the property lines produced at right  
 angles to the sewer line at the center line of each  
 manhole.  
 Note:  
 Stoppers to be installed with joint compound by manufacturer of his plant, Specs. Sec. 33-43  
 Concrete pavement to be cut not less than 2" in depth with concrete saw. Specs. Sec. 65  
 INSTALL WIRE AND TAG AT END OF ALL CONNECTIONS, Specs. Sec. 48

13,996

PROFILE, ALIGNMENT AND GRADE OF  
**SANITARY SEWERS**  
 TO BE CONSTRUCTED IN  
**DAINES DRIVE**  
 FROM RYLAND AVENUE TO 154' EAST OF RYLAND AVENUE

PRIVATE CONTRACT NO. 1692  
 N.S. 44  
 SHEET 1 OF 1 SHEET  
 SCALE: HORIZ. 1"=40' VERT. 1"=4'  
 FEBRUARY 1951  
 PREPARED BY *John W. Jones*  
 REC. CL. NO. 3133  
**FOR LEGEND**  
 SEE PLAN S-a-64

DC 16957 TRACT NO. 16957  
 SANITARY SEWER PC 1692

SAN 150' Len 344,833 Rd Dept 13, 2842-14  
 30' N of Broadway on West line of  
 Tract No. 16957  
 Spk. in each man.

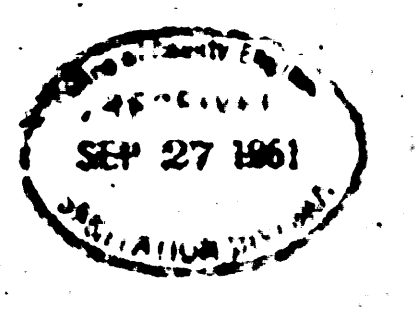

Note:  
 Grades to which this improvement is to be constructed are shown on plans and profile.  
 Grade points for top of curb, center line of street, or center line of alley are shown  
 by circles on location. All other points between designated points the grade shall be  
 established so as to conform to a straight line drawn between designated points.  
 Elevations are in feet above U.S.C.S. datum or mean sea level.  
 This drawing and the data hereon are hereby made a part of the specifications.  
 Work shall be constructed according to specifications on file in the office  
 of the County Engineer and shall be prosecuted only in the presence of the  
 County Engineer.  
 Before the work can be started, the contractor must obtain a permit to excavate  
 in County Streets from the L.A. County Rd Dept, 271 St. Main Street, and make  
 a deposit with the County Engineer, 228 L.A. County Engineering Bldg, sufficient  
 to cover the cost of construction, inspection, and record plans.  
 Approval of this plan by the County of Los Angeles does not constitute a  
 representation as to the accuracy of the location of or the existence or non-existence  
 of any underground utility, pipe or structure within the limits of this project.

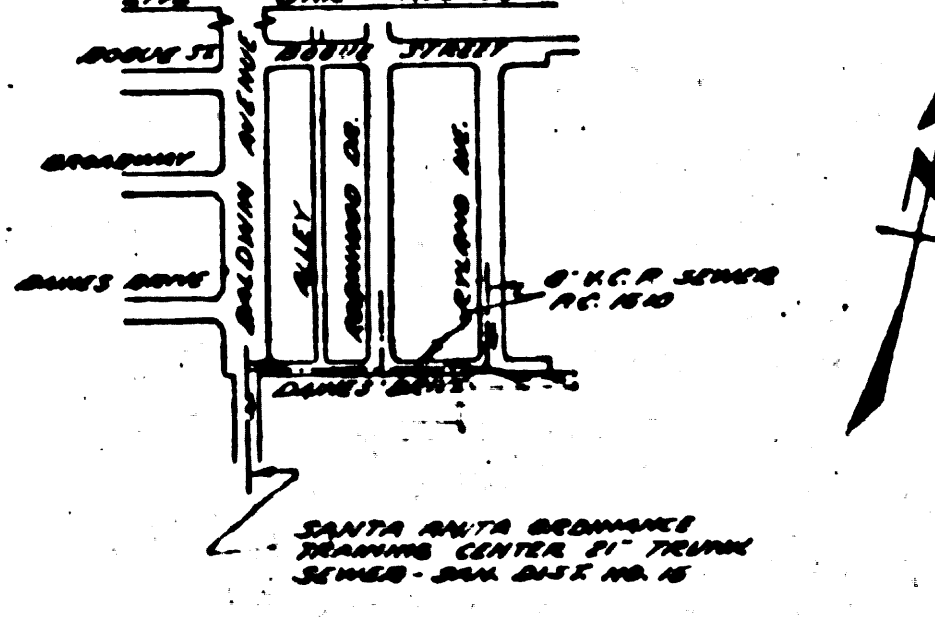

INDEX MAP  
 PC 1692 J.W. 3286  
 SCALE 1"=1000'

COUNTY OF LOS ANGELES  
 CALIFORNIA

APPROVED *John W. Jones*  
 COUNTY ENGINEER  
 Before breaking into any existing structure  
 and before final acceptance of this work,  
 County Sanitation District should be notified  
 in order that required inspection may be made.

APPROVED BY *AM RAWN*  
 CHIEF ENGINEER OF  
 COUNTY SANITATION  
 DISTRICT NO. 13  
 CHECKED BY *John W. Jones* 9-12-1951  
 OFFICE OF COUNTY ENGINEER  
 REC. CL. NO. 1662



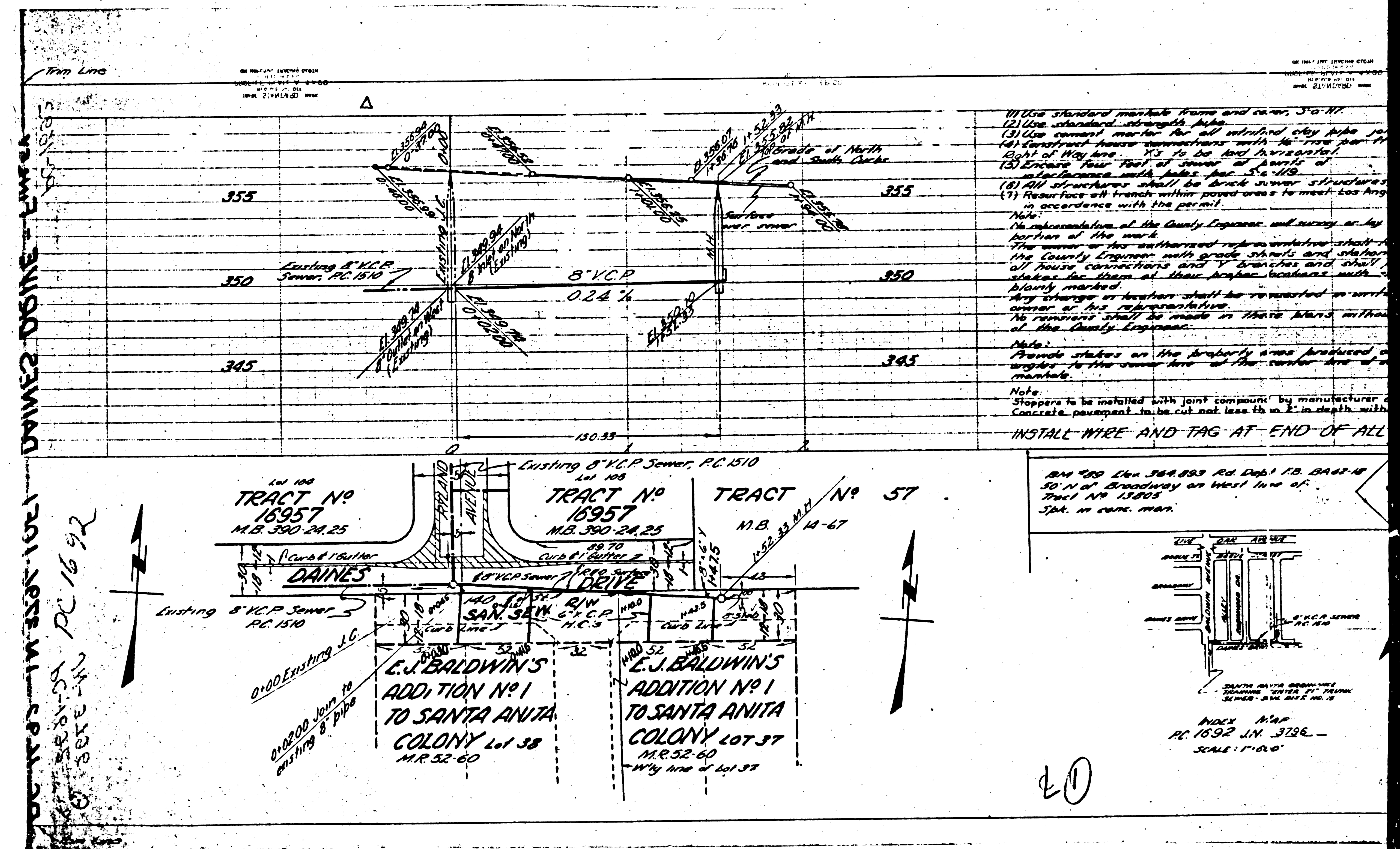

(1) Use standard manhole frame and cover, 3'0" H.  
 (2) Use standard strength pipe.  
 (3) Use cement mortar for all vitrified clay pipe joints.  
 (4) Construct house connections with the iron pipe to  
 East of Main line. It to be laid horizontally.  
 (5) Excavate four feet of sewer at points of  
 interference with holes for S.A. 169.  
 (6) All structures shall be brick masonry structures.  
 (7) Reconstruct trench within paved areas to meet local laws  
 in accordance with the permit.  
 Note:  
 Responsibility of the County Engineer and survey at his  
 portion of the work.  
 The owner or his authorized representative shall  
 the County Engineer with grade stakes and station  
 all house connections and Y branches and shall  
 stakes for them at their proper locations with  
 clearly marked.  
 Any change or location shall be requested in writing  
 owner or his representative.  
 No revisions shall be made in these plans without  
 at the County Engineer.  
 Note:  
 Provide stakes on the property areas produced in  
 angles to the center line of the center line of  
 manhole.  
 Note:  
 Stoppers to be installed with joint compound by manufacturer.  
 Concrete pavement to be cut not less than 2" in depth with  
 INSTALL WIRE AND TAG AT END OF ALL

SAN 200 (See 344-893 Rd Dept. 1.B. BA 42-10  
 50' N of Broadway on West line of  
 Tract No. 15805  
 Spk. in case man.

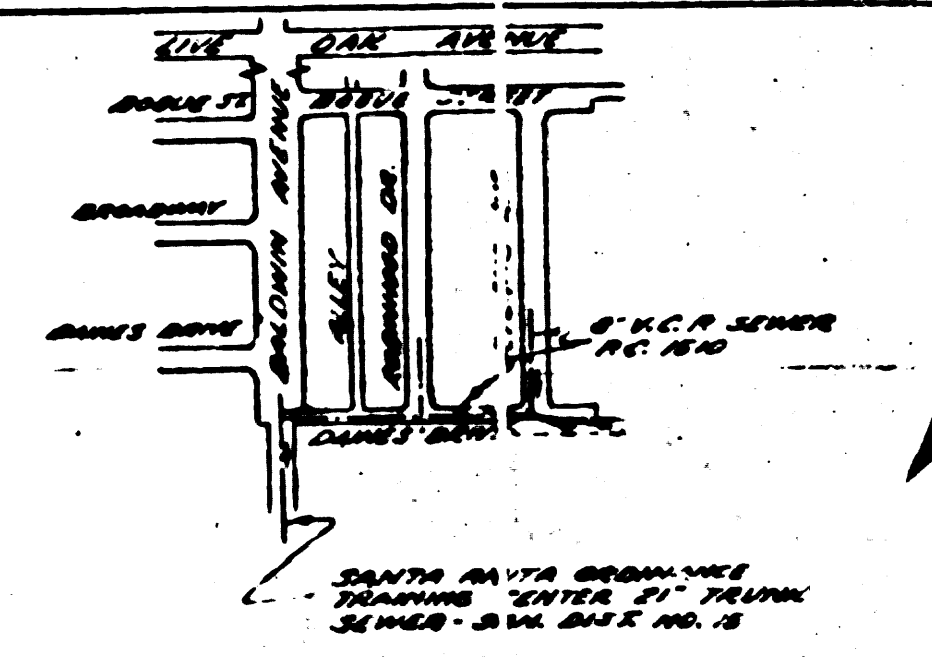

INDEX MAP  
 PC 1692 J.M. 3126  
 SCALE 1"=60'

20

PC 1692 J.M. 3126  
 PC 1692 J.M. 3126  
 PC 1692 J.M. 3126