

BM - L.Q. 595 P.I. Elev. 157.81
 Washington Blvd. & Alley's Av.
 Spike and Washington N. Curbs of
 Washington Blvd. 20' East of
 Curb Return at N.E. Corner.

- (1) USE STANDARD MANHOLE FRAME AND COVER, S-a-117
- (2) USE STANDARD STRENGTH PIPE.
- (3) USE CEMENT MORTAR FOR ALL VITRIFIED CLAY PIPE JOINTS
- (4) RESURFACE ALL TRENCH WITHIN PAVED AREA TO MEET LOS ANGELES COUNTY ROAD DEPT. IN ACCORDANCE WITH PERMIT
- (5) ENCASE FOUR FEET OF SEWER AT POINTS OF INTERFERENCE WITH POLES AS PER S-a-119.
- (6) ALL STRUCTURES SHALL BE BRICK SEWER STRUCTURES, S-a-104.
- (7) ALL CONNECTIONS MUST COMPLY WITH COUNTY SEWER ORDINANCE NO. 1396.
- (8) CONSTRUCTION DIVISION OF THE COUNTY ENGINEER'S OFFICE SHALL BE NOTIFIED 24 HOURS PRIOR TO START OF CONSTRUCTION.
- (9) STOPPERS TO BE INSTALLED WITH JOINT COMPOUND BY MANUFACTURER AT HIS PLANT. SPEC'S. SEC. 33.48.
- (10) CONCRETE PAVEMENT TO BE CUT NOT LESS THAN 2" IN DEPTH WITH CONCRETE SAW.

NOTE:
 NO REPRESENTATIVE OF THE COUNTY ENGINEER WILL SURVEY OR LAY OUT ANY PORTION OF THE WORK. THE OWNER OR HIS AUTHORIZED REPRESENTATIVE SHALL FURNISH THE COUNTY ENGINEER WITH GRADE SHEETS AND STATIONS OF ALL HOUSE CONNECTIONS AND Y BRANCHES AND SHALL PROVIDE STAKES FOR THEM AT THEIR PROPER LOCATIONS WITH STATIONING PLAINLY MARKED. ANY CHANGE OF LOCATION SHALL BE REQUESTED IN WRITING BY THE OWNER OR HIS REPRESENTATIVE. NO REVISIONS SHALL BE MADE IN THESE PLANS WITHOUT APPROVAL OF THE COUNTY ENGINEER.

13502
 PROFILE, ALIGNMENT AND GRADE OF THE
SANITARY SEWER
 TO BE CONSTRUCTED IN
UNION PACIFIC PROPERTY
TRACT N° 8626
 NORTH AND EAST OF
 WASHINGTON BLVD. AND COBB ST.

PRIVATE CONTRACT NO. 1739
W.S. 7-5

DATE: APRIL 1951

PREPARED IN THE OFFICES OF
 UNION PACIFIC RAILROAD CO.

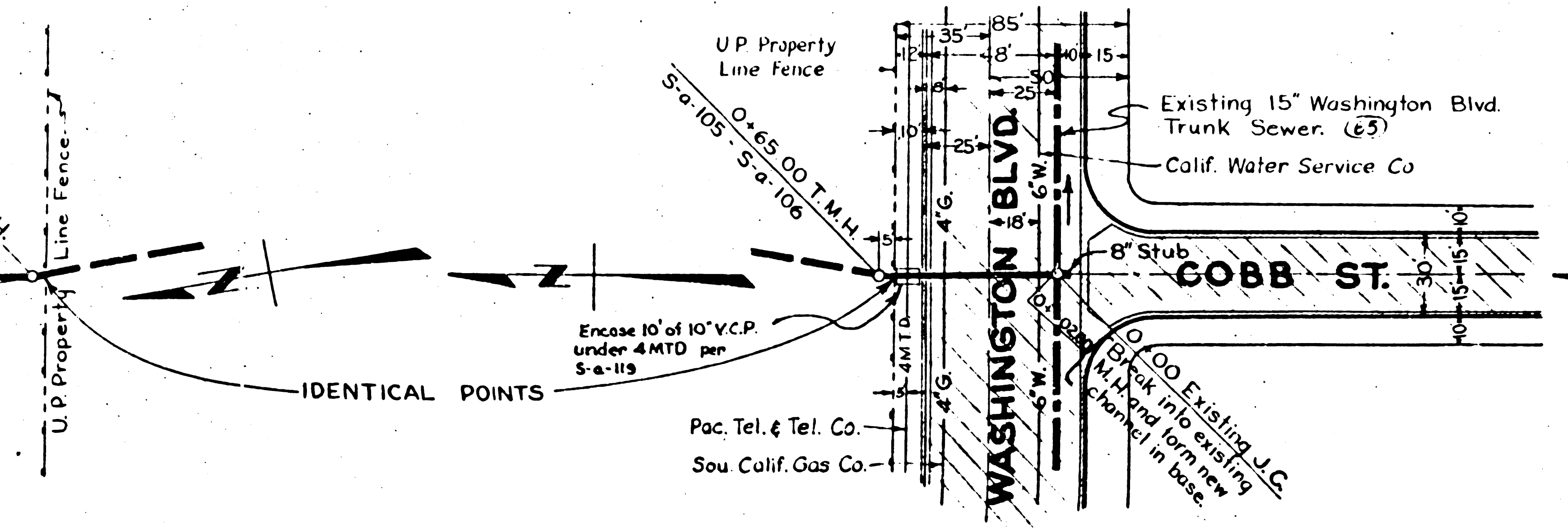

INDEX MAP
 P.C. N° 1739
 J.N. 3847

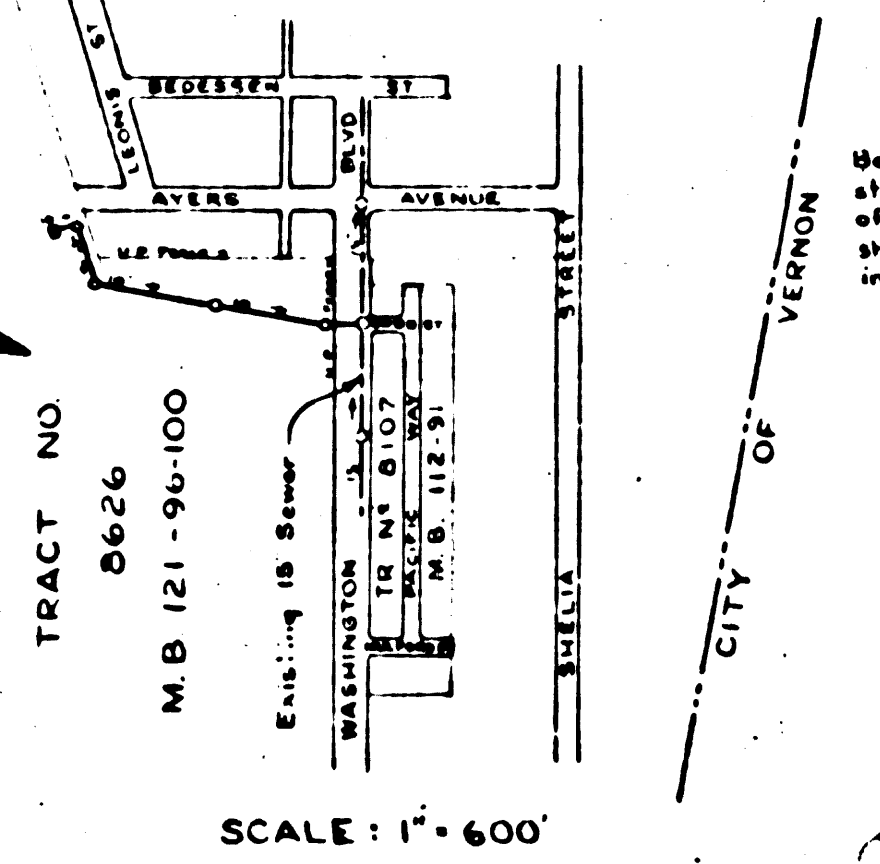

Industrial Waste 12 54
 APPROVED FOR THE COLLECTION AND
 PRETREATMENT OF LIQUID INDUSTRIAL WASTE ONLY
Richard Robert DATE 4/20/51
 INDUSTRIAL WASTE ENGINEER, OFFICE OF COUNTY ENGINEER

By: Charles W. McKee 1408
 REG. C.E. NO.

FOR LEGEND
 SEE PLAN NO. 5-a-64

APR 27 1951

NOTE:
 GRADES TO WHICH THIS IMPROVEMENT IS TO BE CONSTRUCTED ARE SHOWN ON PLANS AND PROFILE. GRAD POINTS FOR TOP OF LUBS, CENTER LINE OF STREET OR CENTER LINE OF ALLEY ARE SHOWN BY CIRCLES ON PROFILES. AT ALL POINTS BETWEEN DESIGNATED POINTS THE GRADE SHALL BE ESTABLISHED SO AS TO CONFORM TO A STRAIGHT LINE DRAWN BETWEEN SAID DESIGNATED POINTS.
 ELEVATIONS ARE IN FEET ABOVE U.S. & B. DATUM OR MEAN SEA LEVEL.
 THIS DRAWING AND THE DATA HEREON ARE HEREBY MADE A PART OF THE SPECIFICATIONS.
 WORK SHALL BE CONSTRUCTED ACCORDING TO SPECIFICATIONS ON FILE IN THE OFFICE OF THE COUNTY ENGINEER AND SHALL BE PROSECUTED ONLY IN THE PRESENCE OF THE COUNTY ENGINEER.
 BEFORE WORK CAN BE STARTED, THE CONTRACTOR MUST OBTAIN A PERMIT TO EXCAVATE IN COUNTY STREETS FROM THE L.A. COUNTY ROAD DEPT. JOB RECORDS STREET AND MAKE A DEPOSIT WITH THE COUNTY ENGINEER, 750 L.A. COUNTY ENGINEERS BLDG., SUFFICIENT TO COVER THE COST OF CONSTRUCTION INSPECTION AND RECORD PLANS.
 APPROVAL OF THIS PLAN BY THE COUNTY OF LOS ANGELES DOES NOT CONSTITUTE A REPRESENTATION AS TO THE ACCURACY OF THE LOCATION OF, OR THE EXISTENCE OR NON-EXISTENCE OF ANY UNDERGROUND UTILITY, PIPE OR STRUCTURE WITHIN THE LIMITS OF THIS PROJECT.

COUNTY OF LOS ANGELES, CALIFORNIA.
 APPROVED: *Edward* COUNTY ENGINEER
 APPROVED BY: *A.M. RAWN* OFFICE ENGR.
 CHIEF ENGINEER OF COUNTY SANITATION DISTRICT NO. 8

CHECKED BY: *Richard E. Nelson* 4-23-1951
 OFFICE OF COUNTY ENGINEER REG. C.E. NO. 7860

13502

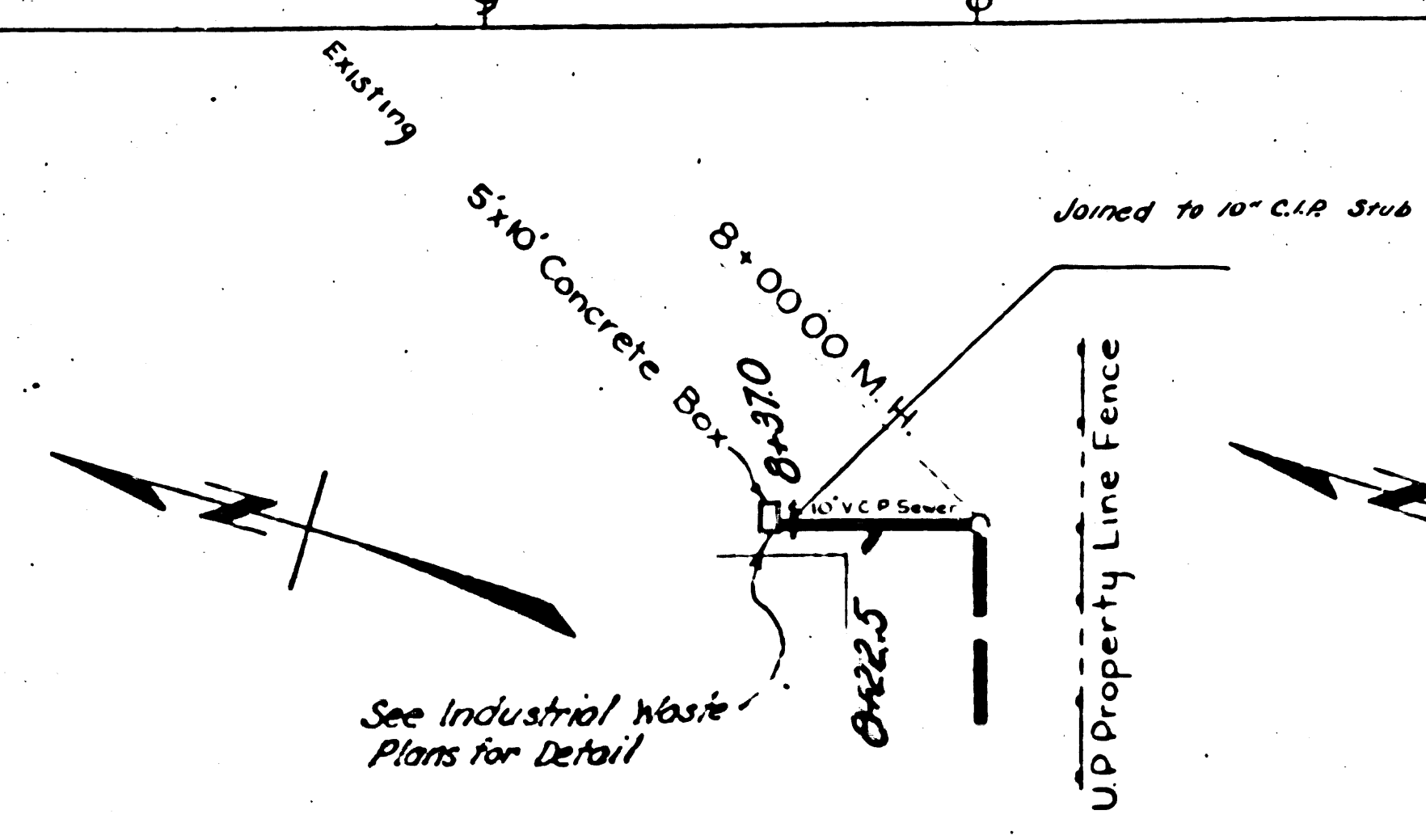
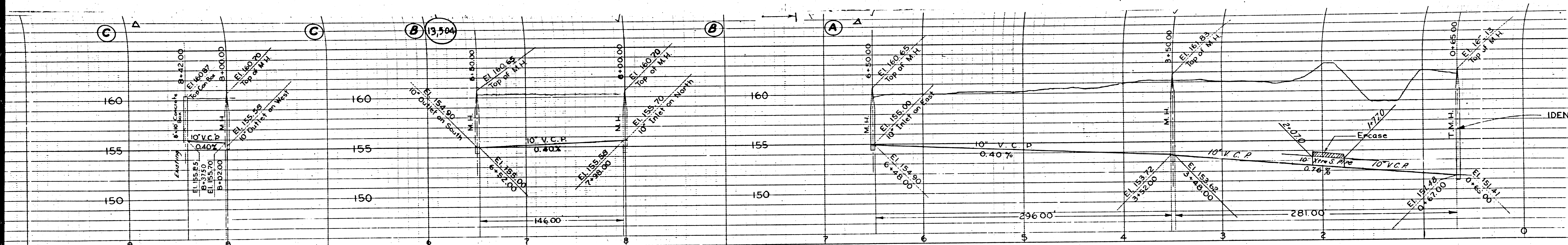

TRACT No 8626
M.B. 121 - 96-100

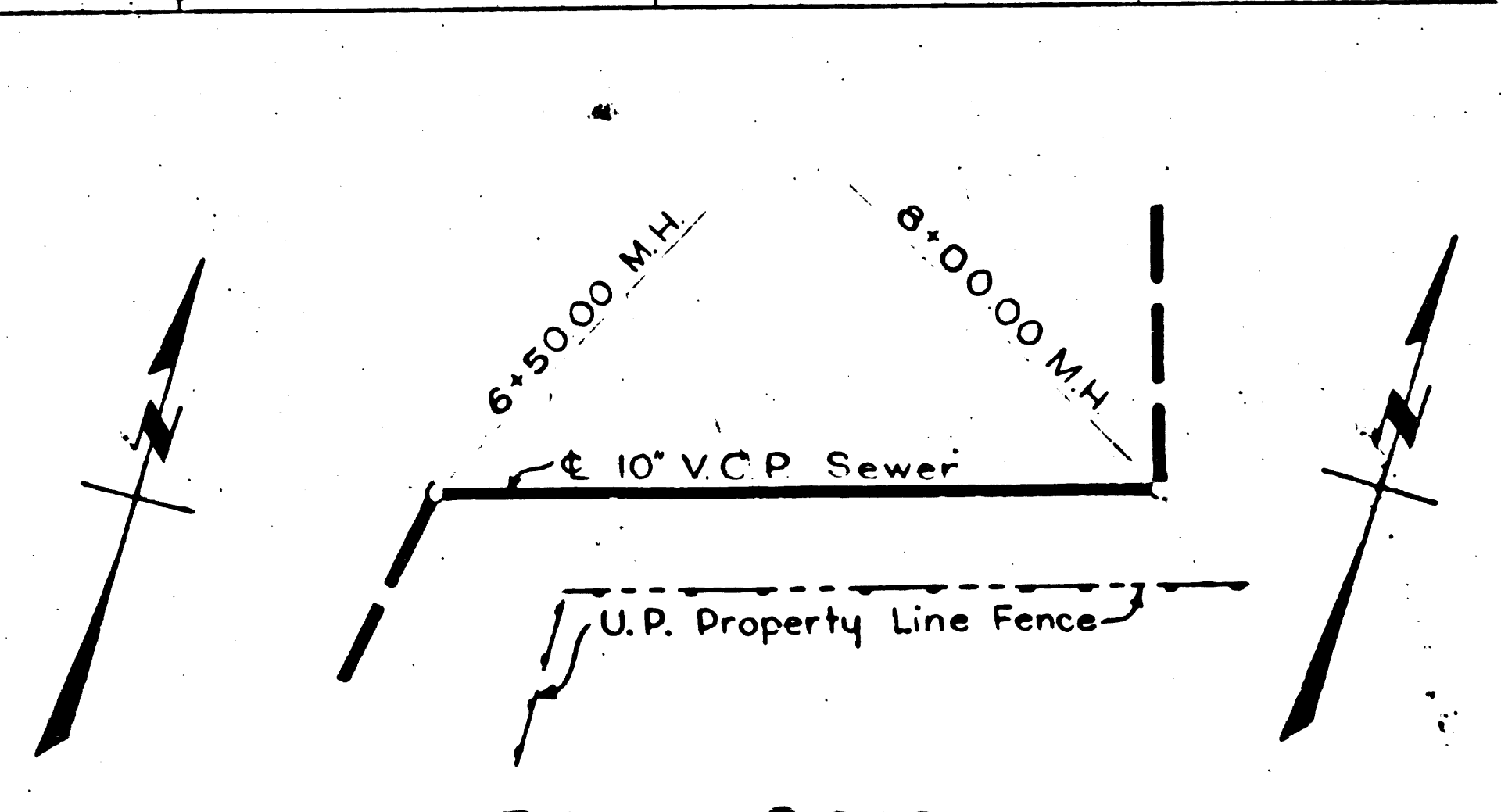

TRACT No 8626
M.B. 121 - 96-100

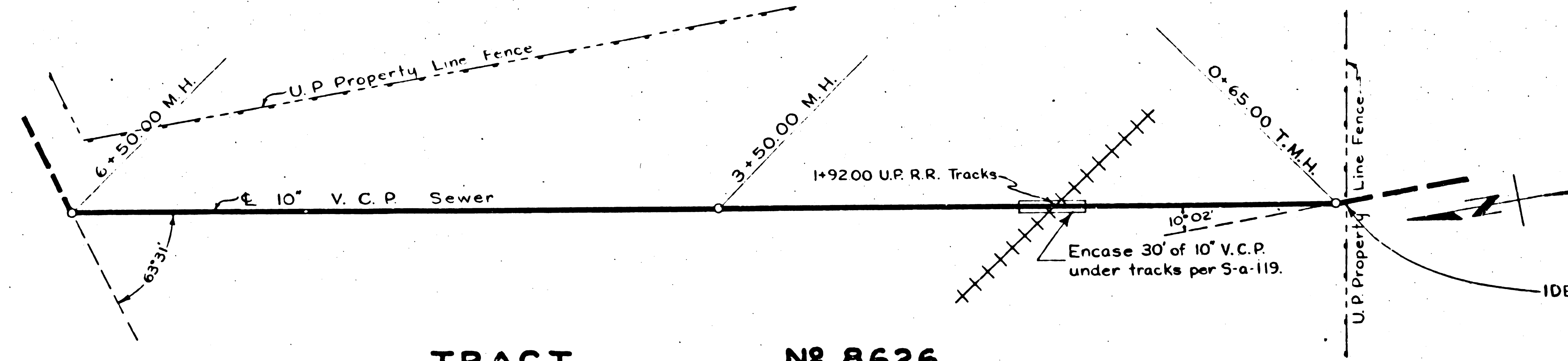

TRACT No 8626
M.B. 121 - 96-100