

**PROFILE, ALIGNMENT AND GRADE OF  
SANITARY SEWERS  
TO BE CONSTRUCTED IN  
ALLEY EAST OF AVALON BLVD  
BETWEEN 185<sup>TH</sup> AND 186<sup>TH</sup> STREETS**

**PRIVATE CONTRACT NO 1783  
W.S. 26  
ONE SHEET**

PREPARED IN THE OFFICES OF  
**EVERETT A. PHILIPS**  
BY: *Richard E. Nelson*  
REG. C.E. NO 7870

1. USE STANDARD MANHOLE FRAMES AND COVERS 3'-6" DIA.
  2. USE STANDARD STRENGTH PIPE (EXCEPT AS NOTED).
  3. USE CEMENT MORTAR FOR ALL VITRIFIED CLAY PIPE JOINTS.
  4. RESURFACE ALL TRENCH WITHIN PAVED AREA TO MEET LOS ANGELES COUNTY ROAD DEPT. OR CALIFORNIA STATE HIGHWAY REQUIREMENTS, ACCORDING TO PERMIT.
  5. ENCASE FOUR FEET OF RENEWAL POINTS OF INTERSECTION WITH POLES AS PER S.M. 110.
  6. ALL STRUCTURES SHALL BE BRICK SEWER STRUCTURES 3'-0" DIA.
- NOTE:  
NO REPRESENTATIVE OF THE COUNTY ENGINEER WILL SURVEY OR LAYOUT ANY PORTION OF THE WORK.  
NO REVISIONS SHALL BE MADE IN THESE PLANS WITHOUT APPROVAL OF THE CO. ENGINEER.  
STAPPERS TO BE INSTALLED WITH JOINT COMPOUND BY APPROVED POWER AT HIS PLANT SPEC. SEC. 33, 44.  
CONCRETE PAVEMENT TO BE CUT NOT LESS THAN 2" IN DEPTH WITH CONCRETE SAW SPEC. SEC. 63.

SCALE: VERT. 1"=4'  
HORIZ. 1"=40'

JUNE, 1951

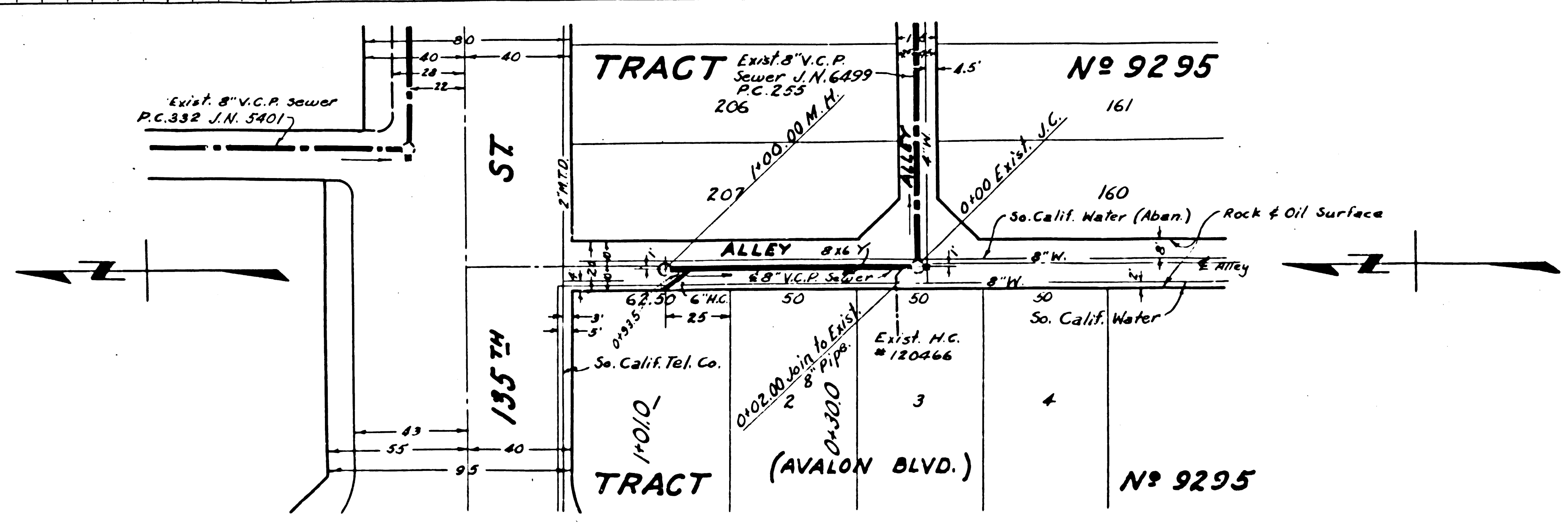

**INDEX MAP**  
Scale 1"=600'  
P.C. 1783 J.N. 3895

FOR LEGEND  
SEE PLAN NO 5-2-64

NOTE:  
ELEVATIONS ARE IN FEET ABOVE U.S.C. DATUM OR MEAN SEA LEVEL.  
THIS DRAWING AND THE DATA HEREON ARE HEREBY MADE A PART OF THE SPECIFICATIONS.  
WORK SHALL BE CONSTRUCTED ACCORDING TO SPECIFICATIONS ON FILE IN THE OFFICE OF THE CO. ENGINEER AND SHALL BE PROSECUTED ONLY IN THE PRESENCE OF THE CO. ENGINEER.  
BEFORE WORK CAN BE STARTED THE CONTRACTOR MUST OBTAIN A PERMIT TO EXCAVATE IN COUNTY STREETS FROM THE L.A. CO. ROAD DEPT. FOR BEST INTEREST AND MAKE A DEPOSIT WITH THE CO. ENGINEER, 130 CO. ENGINEERING BUILDING SUFFICIENT TO COVER THE COST OF CONSTRUCTION INSPECTION AND RECORD PLANS.  
IF WORK IS TO BE DONE IN A STATE HIGHWAY, A PERMIT MUST BE OBTAINED FROM THE STATE OF CALIFORNIA, DIVISION OF HIGHWAYS, 120 SO. SPRING ST., AFTER MAKING THE DEPOSIT WITH THE CO. ENGINEER.  
APPROVAL OF THIS PLAN BY THE CO. OF LOS ANGELES DOES NOT CONSTITUTE A REPRESENTATION AS TO THE ACCURACY OF THE LOCATION OF, OR THE EXISTENCE OR NON-EXISTENCE OF ANY UNDERGROUND UTILITY PIPE OR STRUCTURE WITHIN THE LIMITS OF THIS PROJECT.

COUNTY OF LOS ANGELES, CALIFORNIA

APPROVED: *Richard E. Nelson*  
COUNTY ENGINEER  
APPROVED: *A.M. Raman*  
CHIEF ENGINEER OF COUNTY SANITATION DISTRICT NO 1  
BY: *Richard E. Nelson*  
OFFICE ENGINEER  
CHECKED: *Richard E. Nelson* 6-3-51  
OFFICE OF COUNTY ENGINEER, P.O. BOX 19860

