

(13,227)

**PROFILE ALIGNMENT AND GRADE OF
SANITARY SEWERS
TO BE CONSTRUCTED IN
CAHITA AVENUE**

BETWEEN A POINT 40.50' SOUTH OF THE NORTH
LINE OF TRACT NO. 13111 AND A POINT 225'
NORTHERLY THEREFROM.

PRIVATE CONTRACT No. 1820
JUNE, 1951

GLEN ROOD, Registered Engineer
Compton, California

REG. C. E. No. 2093

RECEIVED
JUL 30 1951

INDEX MAP
(No scale)

1. USE STANDARD MANHOLE FRAMES AND COVERS, ETC.
2. USE STANDARD SIEMENS...
3. ALL STRUCTURES SHALL BE BUILT AS PER...
4. ALL STRUCTURES SHALL BE BUILT AS PER...
5. ALL STRUCTURES SHALL BE BUILT AS PER...
6. ALL STRUCTURES SHALL BE BUILT AS PER...
7. ALL STRUCTURES SHALL BE BUILT AS PER...
8. ALL STRUCTURES SHALL BE BUILT AS PER...
9. ALL STRUCTURES SHALL BE BUILT AS PER...
10. ALL STRUCTURES SHALL BE BUILT AS PER...

BENCH MARK No. 2 ROAD DEPT. ELEV. 99.445
LEAD AND TACK IN CURB TO "S" CURB TYPED AT SE. CORNER
Deadend and 1st. alley N. of 150th. St.

Shoppers to be installed with joint compound by
manufacturer at his plant. Specs. Sec. 53.48.

before breaking into any existing structure
and before final acceptance of this work.
County Sanitation District should be notified
in order that required inspection may be made.

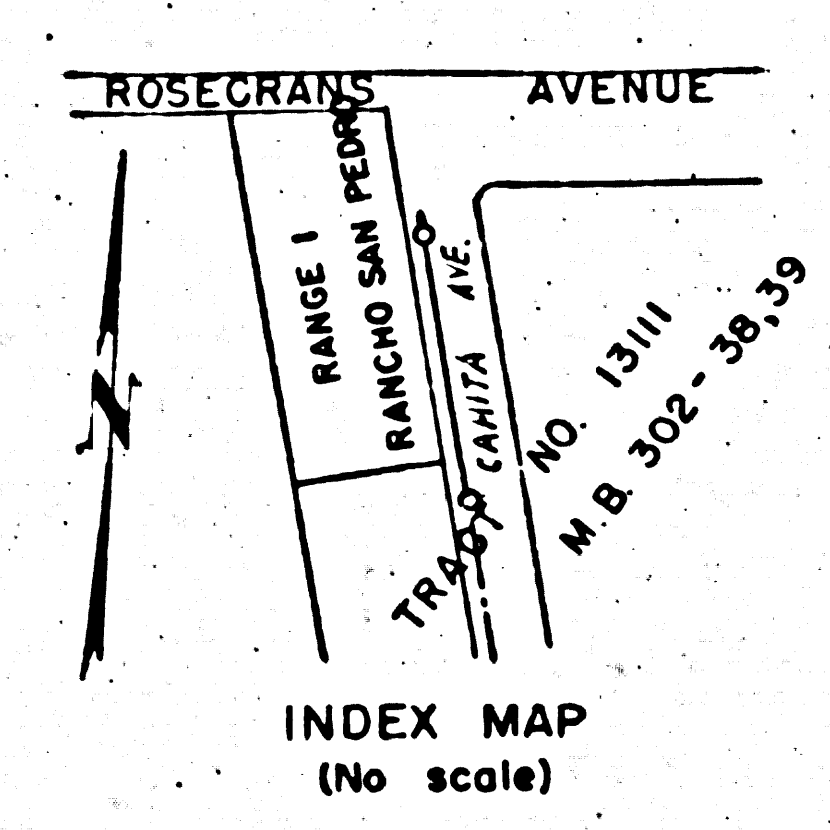

P.C. 1820
J.N. No. 3939

BC 1820

BC 1820