

125	(14,119)	(1) USE STANDARD MANHOLE FRAME AND COVER, 3'-x-17". (2) USE STANDARD STRENGTH PIPE. (3) USE CEMENT MORTAR FOR ALL VITRIFIED CLAY PIPE JOINTS. (4) RESURFACE ALL TRENCH WITHIN PAVED AREA TO MEET LOS ANGELES COUNTY ROAD DEPT. REQUIREMENTS IN ACCORDANCE WITH PERMIT. (5) CONSTRUCT HOUSE CONNECTIONS WITH INVERT AT PROPERTY LINE SEVEN (7) FEET BELOW FINISHED ROADWAY SURFACE ON CENTERLINE. (6) ALL STRUCTURES SHALL BE BRICK SEWER STRUCTURES, 3'-x-10". (7) GRADE AT TOP IS FOR CENTERLINE OF MANHOLE. (8) STOPPERS TO BE INSTALLED WITH JOINT COMPOUND BY MANUFACTURER AT HIS PLANT. Spec's Sec. 33, 48.	BENCH MARK: L.A. CO. SURVEYOR B.M. NO. 1A-13 ELEV. 117.125 Lead and right in west end curb feet at S.W. Cor. Avalon Blvd. & El Segundo Blvd.	<p>PLAN AND PROFILE OF SANITARY SEWERS TO BE CONSTRUCTED IN AVALON BOULEVARD FROM 310 FEET SOUTH OF EL SEGUNDO CENTER LINE TO 534 FEET SOUTH OF EL SEGUNDO CENTER LINE IN SEC. 17, T.3S, R.13W, S.B.B. &amp; M.</p> <p>PRIVATE CONTRACT NO. 1961 W.S. 26 ONE SHEET</p> <p>PREPARED IN THE OFFICES OF <i>Charles C. Miller</i> Charles C. Miller, Reg. C.E. No. 122</p> <p>NOV. 1951</p> <p>FOR LEGEND SEE PLAN NO. 3-8-61</p>
-----	----------	---------------------------------------------------------------------------------------------------------------------------------------------------------------------------------------------------------------------------------------------------------------------------------------------------------------------------------------------------------------------------------------------------------------------------------------------------------------------------------------------------------------------------------------------------------------------------------------------------------------------------------------	----------------------------------------------------------------------------------------------------------------------------------------------------	---------------------------------------------------------------------------------------------------------------------------------------------------------------------------------------------------------------------------------------------------------------------------------------------------------------------------------------------------------------------------------------------------------------------------------------------------------------------------

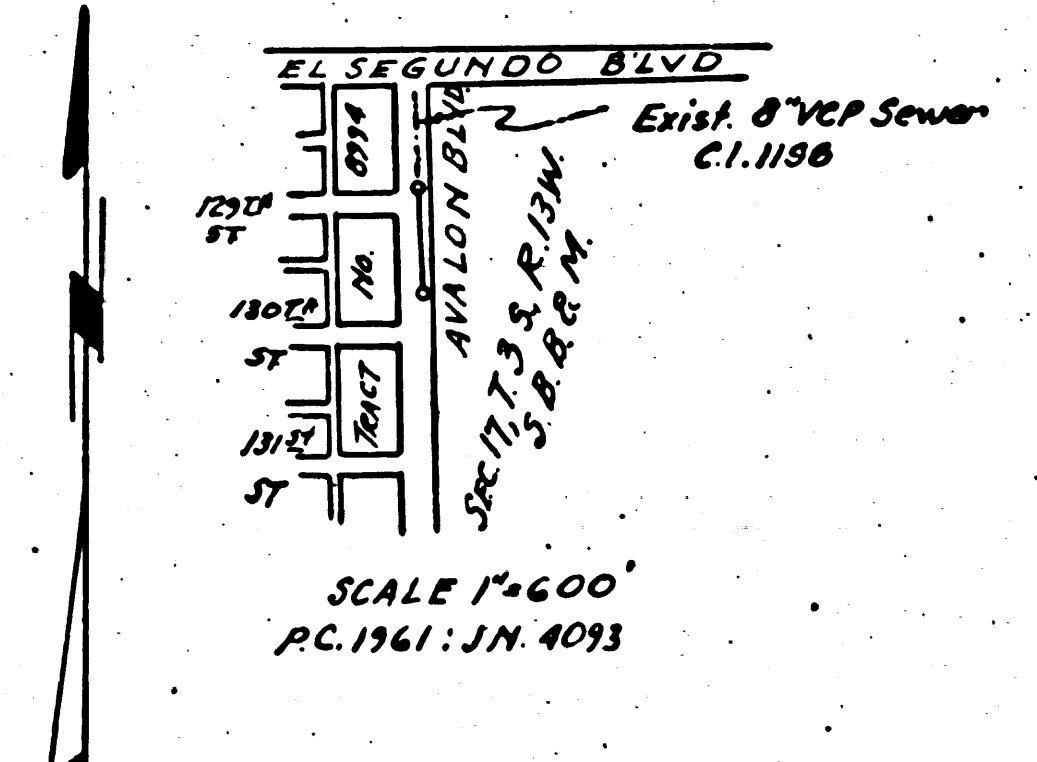
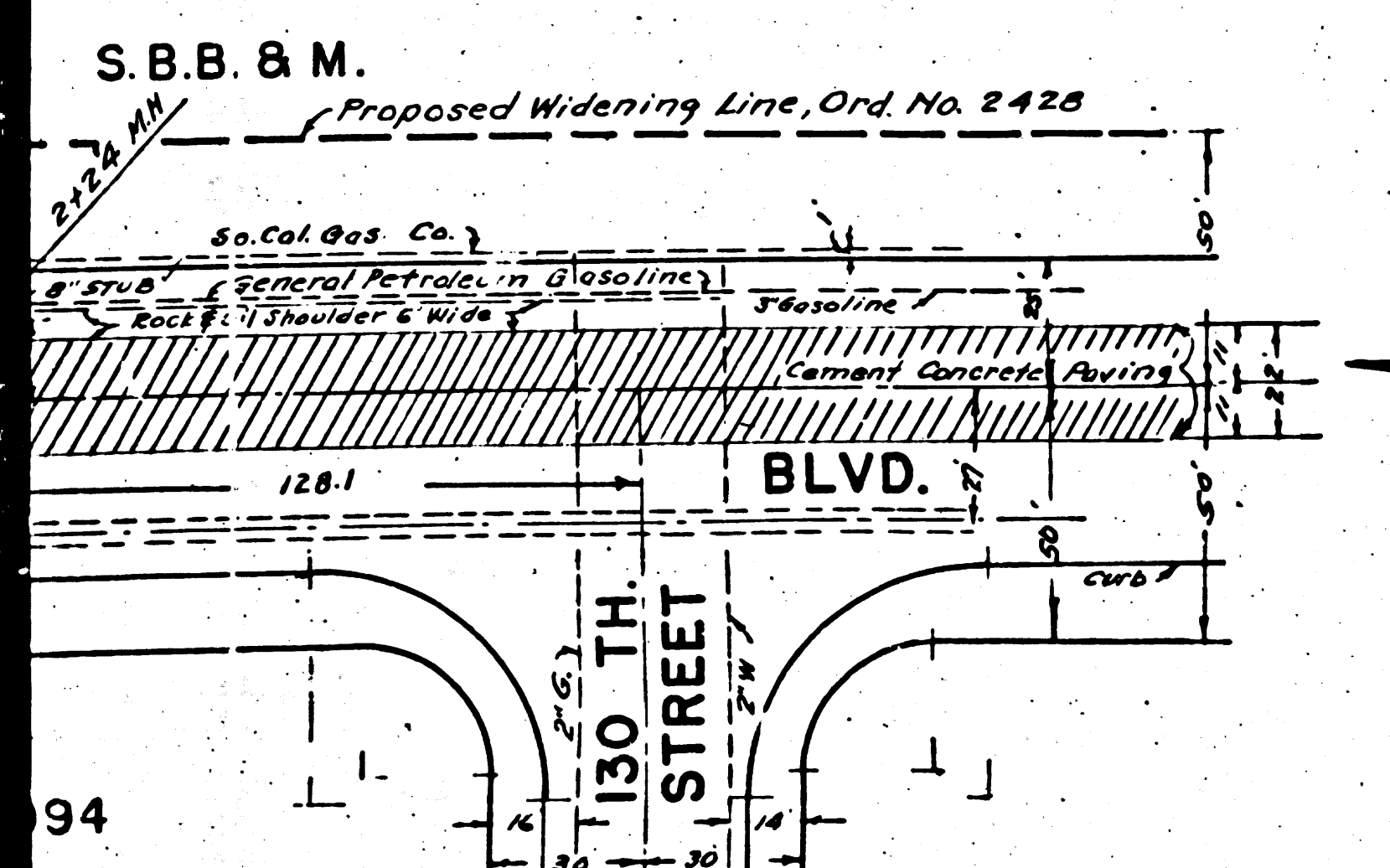

Before breaking into any existing structure and before final acceptance of this work, County Sanitation District should be notified in order that required inspection may be made.

Before breaking into any existing structure and before final acceptance of this work, County Sanitation District should be notified in order that required inspection may be made.

**NOTE:**  
GRADES TO WHICH THIS IMPROVEMENT IS TO BE CONSTRUCTED ARE SHOWN ON PLAN & PROFILE GRADE POINTS FOR TOP OF EDGE OF PAVING ON SIDE LINE OF STREET ARE SHOWN BY CIRCLES ON PROFILES. AT ALL POINTS BETWEEN DESIGNATED POINTS THE GRADE SHALL BE ESTABLISHED SO AS TO CONFORM TO A STRAIGHT LINE DRAWN BETWEEN SAID DESIGNATED POINTS.  
ELEVATIONS ARE IN FEET ABOVE U.S.C.S. DATUM OR MEAN SEA LEVEL.  
THIS DRAWING AND THE DATA HEREON ARE HEREBY MADE A PART OF THE SPECIFICATIONS.  
WORK SHALL BE CONSTRUCTED ACCORDING TO SPECIFICATIONS ON FILE IN THE OFFICE OF THE COUNTY ENGINEER AND SHALL BE PROSECUTED ONLY IN THE PRESENCE OF THE COUNTY ENGINEER.  
BEFORE WORK CAN BE STARTED THE CONTRACTOR MUST OBTAIN A PERMIT TO EXCAVATE IN COUNTY STREETS FROM THE L.A. COUNTY ROAD DEPT. 211 S. MAIN STREET AND MAKE A DEPOSIT WITH THE COUNTY ENGINEER, REG. L.A. COUNTY ENGINEERING BLDG. SUFFICIENT TO COVER THE COST OF CONSTRUCTION INSPECTION AND RECORD PLANS.  
APPROVAL OF THIS PLAN BY THE COUNTY OF LOS ANGELES DOES NOT CONSTITUTE A REPRESENTATION AS TO THE ACCURACY OF THE LOCATION OF, OR THE EXISTENCE OR NON-EXISTENCE OF ANY UNDERGROUND UTILITY, PIPE OR STRUCTURE WITHIN THE LIMITS OF THIS PROJECT.

COUNTY OF LOS ANGELES, CALIFORNIA.

APPROVED *William J. Fox*  
COUNTY ENGINEER

APPROVED BY *A. M. Rawlin*  
OFFICE ENGR  
CHIEF ENGINEER, COUNTY SANITATION DIST. NO. 1

CHECKED BY *Richard E. Kahan*  
OFFICE OF COUNTY ENGINEER, REG. C.E. NO. 2864

BO 1961

check 3-2-52 *McLaren*

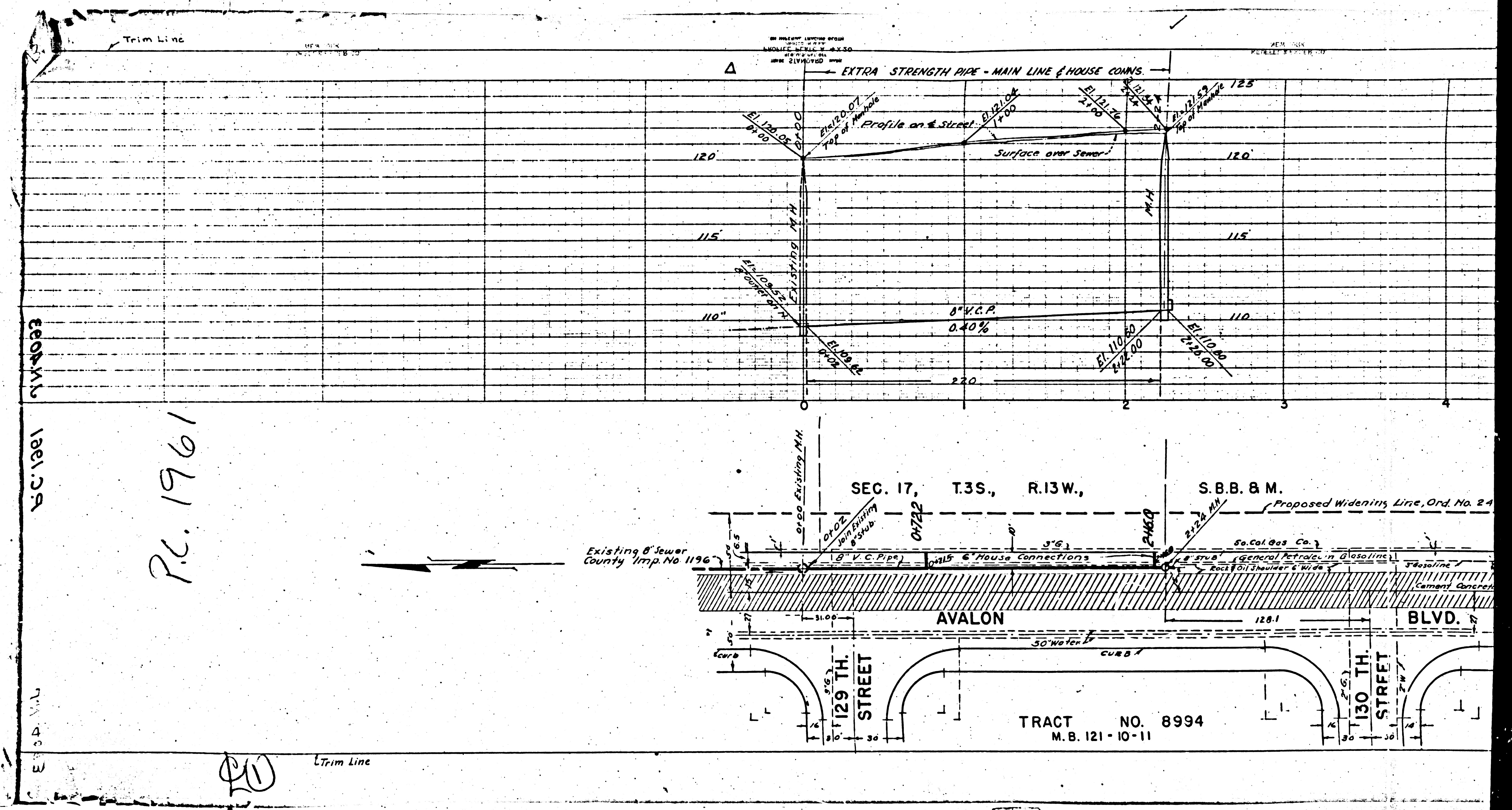

P.C. 1961

1961 25

1961 25

TRACT NO. 8994  
M.B. 121-10-11

SEC. 17, T.3S., R.13W.,

S.B.B. & M.

AVALON

BLVD.

129 TH. STREET

130 TH. STREET

Trim Line

Existing 8" Jewer County Imp. No. 1196

Proposed Widening Line, Ord. No. 24

EXTRA STRENGTH PIPE - MAIN LINE & HOUSE CONNS.

Profile on Street

Surface over Sewer

8" W.C.P. 0.40%

270

270

120

115

110

125

120

115

110

Trim Line

Trim Line

20

100