

14.726

1. USE STANDARD MANHOLE FRAMES AND COVERS, 3'-0" DIA.
  2. USE STANDARD STRENGTH PIPE.
  3. USE CEMENT MORTAR FOR ALL VITRIFIED CLAY PIPE JOINTS.
  4. RESURFACE ALL TRENCH WITHIN PAVED AREA TO MEET LOS ANGELES COUNTY ROAD DEPARTMENT REQUIREMENTS.
  5. CONSTRUCT HOUSE CONNECTIONS WITH INVERT AT PROPERTY LINE 6 FEET BELOW GRADE OF CURB.
  6. ALL STRUCTURES SHALL BE BRICK GENEER STRUCTURES, 5'-0" DIA.
  7. ENCASE FOUR FEET OF SEWER AT POINTS OF INTERFERENCE WITH POLES AT PER S-4-119.
- NO REPRESENTATIVE OF THE COUNTY ENGINEER SHALL SURVEY OR LAY OUT ANY PORTION OF THE WORK.
- THE OWNER OR HIS AUTHORIZED REPRESENTATIVE SHALL FURNISH THE COUNTY ENGINEER WITH THE SHEETS & STATIONS OF ALL HOUSE CONNECTIONS & Y BRANCHES & SHALL PROVIDE STAKES FOR THE WORK AT THEIR PROPER LOCATIONS WITH OPERATIONS PLANNED. ANY CHANGE OF LOCATION SHALL BE REQUESTED IN WRITING BY THE OWNER OR HIS REPRESENTATIVE.
- NO REVISIONS SHALL BE MADE IN THESE PLANS WITHOUT APPROVAL OF THE COUNTY ENGINEER.
- STOPPERS TO BE INSTALLED WITH JOINT COMPOUND BY MANUFACTURER AT THE PLANT.
- CONCRETE PAVEMENT TO BE NOT LESS THAN 2" IN DEPTH WITH CONCRETE SAW SPEC. SEC. 6-5.
- INSTALL WIRE & TAG PER SPEC. SEC. 4-8.

PROFILE, ALIGNMENT AND GRADE OF  
**SANITARY SEWERS**  
TO BE CONSTRUCTED IN  
**ARTESIA AVE.**  
WEST OF WOODRUFF AVE.

PRIVATE CONTRACT NO 2188  
W.S. 33  
ONE SHEET

PREPARED IN THE OFFICES OF  
**RALPH B. NUNNELLEY**  
BY: *Ralph B. Nunnelley* REG. C.E. NO. 8986

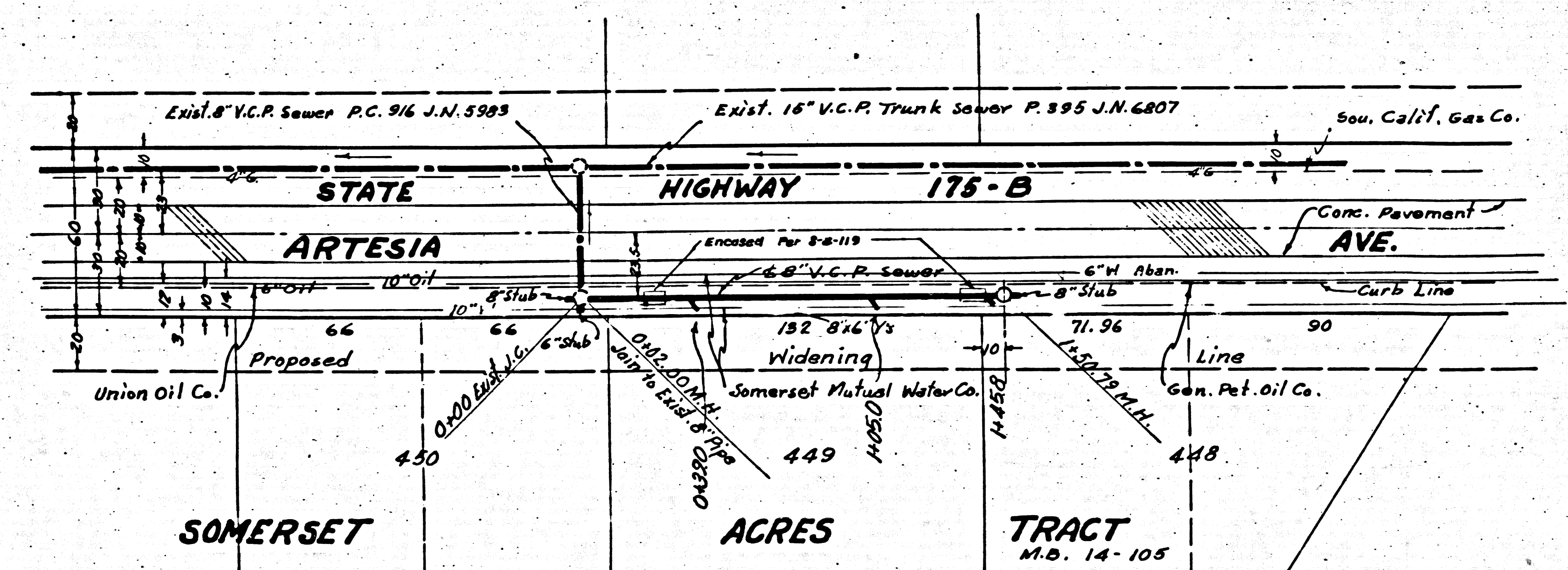

Extreme Caution should be used in excavating for sewer line as any misalignment of substructures could be critical. Substructures shown in red are only as shown in Substructure Section of County Road Dept.

INDEX MAP

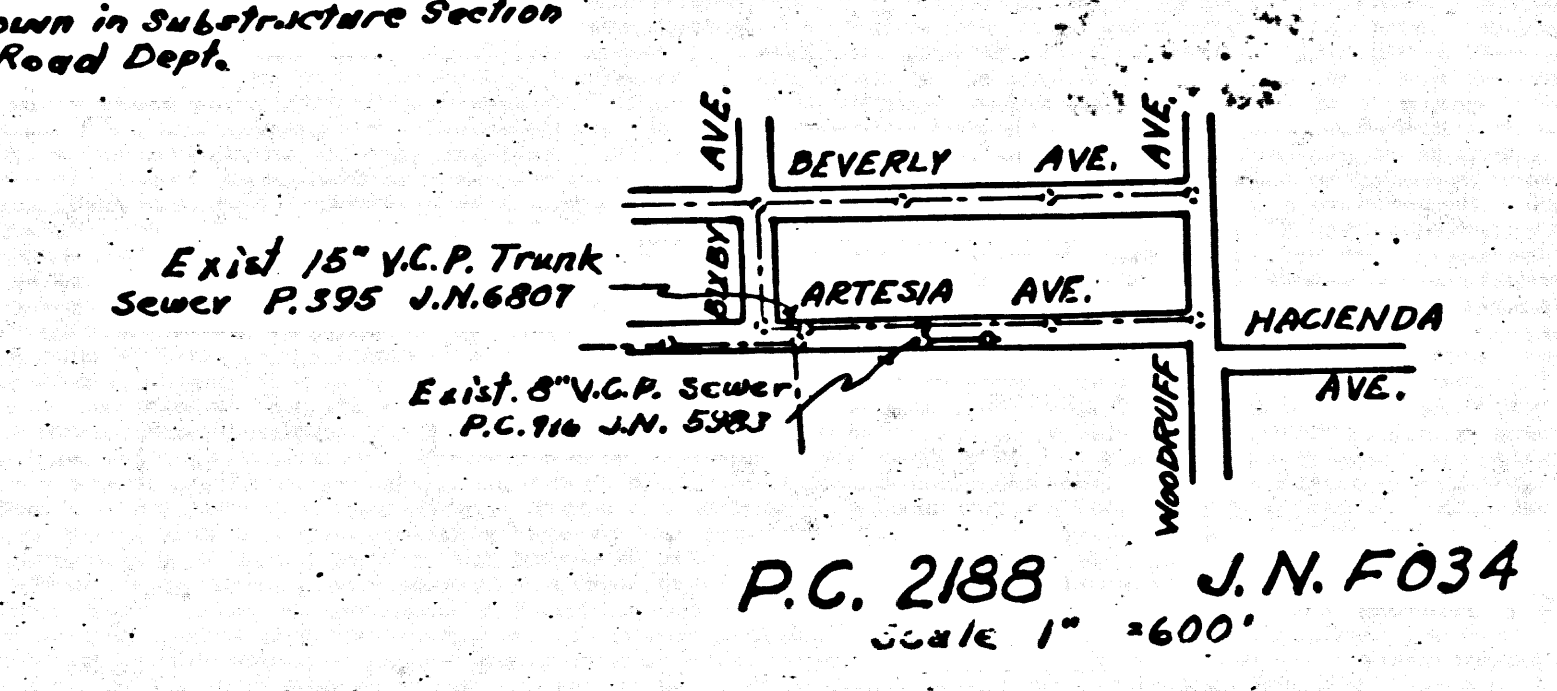

FOR LEGEND  
See Plan No S-8-64

NOTE:  
ELEVATIONS ARE IN FEET ABOVE U.S.S. DATUM OR MEAN SEA LEVEL.  
THIS DRAWING AND THE DATA HEREON ARE HEREBY MADE A PART OF THE SPECIFICATIONS.  
WORK SHALL BE CONSTRUCTED ACCORDING TO SPECIFICATION ON FILE IN THE OFFICE OF THE COUNTY ENGINEER AND SHALL BE PROSECUTED ONLY IN THE PRESENCE OF THE COUNTY ENGINEER.  
BEFORE WORK CAN BE STARTED THE CONTRACTOR MUST OBTAIN A PERMIT TO LOCATE IN COUNTY STREETS FROM LOS ANGELES COUNTY ROAD DEPARTMENT, 108 WEST 8<sup>TH</sup> ST. AND MAKE A DEPOSIT WITH THE COUNTY ENGINEER, 730 COUNTY ENGINEERING BUILDING SUFFICIENT TO COVER COST OF CONSTRUCTION INSPECTION AND RECORD PLANS.  
IF WORK IS TO BE DONE IN A STATE HIGHWAY, A PERMIT MUST BE OBTAINED FROM THE STATE OF CALIFORNIA, DIVISION OF HIGHWAYS, 180 SOUTH SPRING ST. AFTER MAKING THE DEPOSIT WITH THE COUNTY ENGINEER.  
APPROVAL OF THIS PLAN BY THE COUNTY OF LOS ANGELES DOES NOT CONSTITUTE A REPRESENTATION AS TO THE ACCURACY OF THE LOCATION OF, OR THE EXISTENCE OR NONEXISTENCE OF ANY UNDERGROUND UTILITY PIPE OR STRUCTURE WITHIN THE LIMITS OF THIS PROJECT.

COUNTY OF LOS ANGELES, CALIFORNIA

APPROVED WILLIAM J. FOX COUNTY ENGINEER  
BY: *William J. Fox* CHIEF DEPUTY

APPROVED A.M. RAWN CHIEF ENGINEER OF COUNTY SANITATION DISTRICT NO 2  
BY: *A.M. Rawn* OFFICE ENGINEER

CHECKED BY Richard E. Kuhn E.S. 52  
OFFICE OF COUNTY ENGINEER R.E.N. 7860

PC 5188

CO