

ONE SHEET
2207

T.M. 5024
BC 5501
P.C.

15,166
R.M. 59 F 104
Orange disk
Blvd bridge

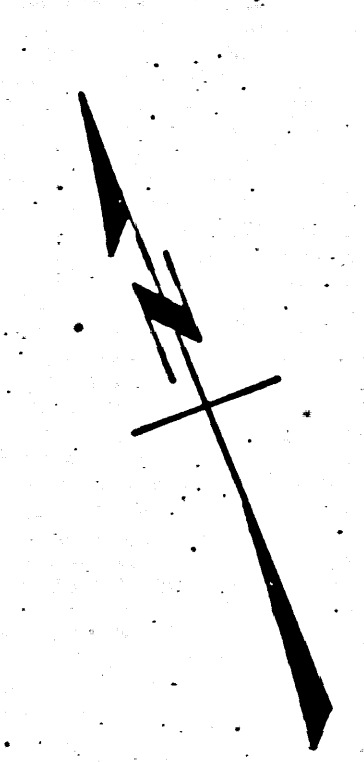

EL 5501
PROJECT

20

8 Calif Water & Tel. Co.
Transite Pipe

EMERALD CITY
BLVD.

Exist 15" Santa Anita
Trunk Sewer

Wly. Boundary of the
City of El Monte

3" So Counties
Gas Co.

0.3606 T.M.H.
S-0157, S-0158

0.000 Exist M.H. Break into
Exist M.H. Form new
channel

PORTION OF RANCHO SAN FRANCISQUITO
P. 1-31, 32

PORTION OF RANCHO SAN FRANCISQUITO
P. 1-31, 32

8" V.C.P. Sewer

8" V.C.P. Sewer

8" V.C.P. Sewer

8" V.C.P. Sewer

8" V.C.P. Sewer

8" V.C.P. Sewer

8" V.C.P. Sewer

8" V.C.P. Sewer

8" V.C.P. Sewer

8" V.C.P. Sewer

8" V.C.P. Sewer

8" V.C.P. Sewer

8" V.C.P. Sewer

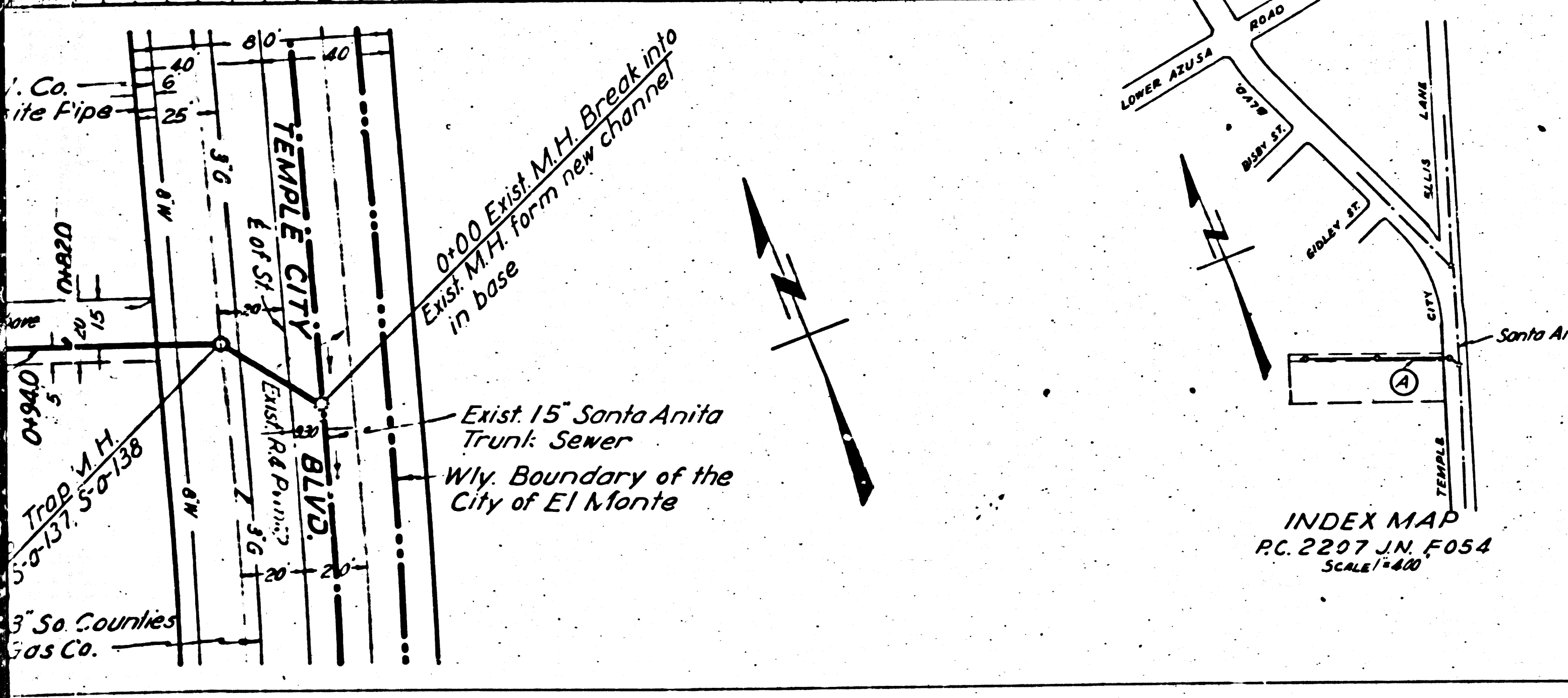
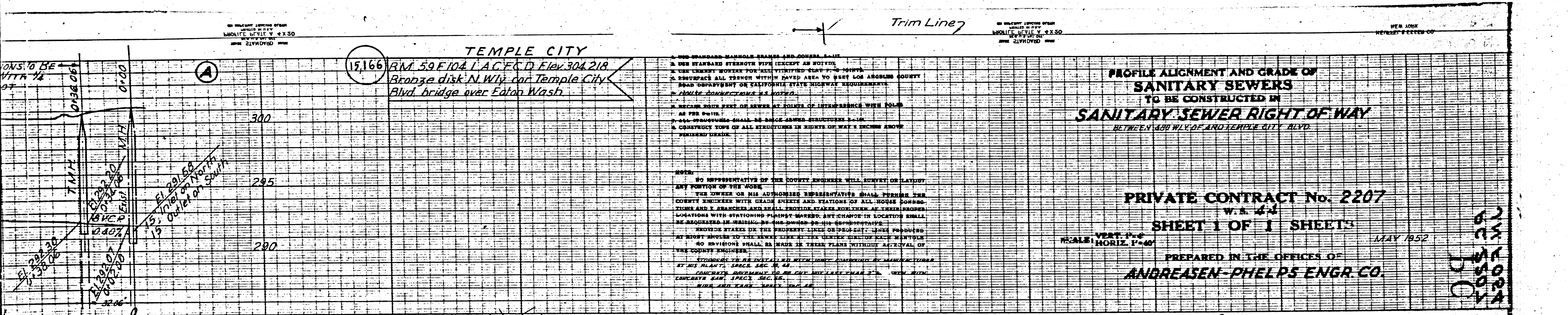

TEMPLE CITY
 B.M. 59 F104 L.A.C.F.C.D. Elev. 304.218
 Bronze disk N. Wily car Temple City
 Blvd. bridge over Eaton Wash

NOTE:
 NO REPRESENTATIVE OF THE COUNTY ENGINEER WILL SURVEY OR LAYOUT ANY PORTION OF THE WORK.
 THE OWNER OR HIS AUTHORIZED REPRESENTATIVE SHALL FURNISH THE COUNTY ENGINEER WITH DEATH CERTS AND PLATONS OF ALL HOUSES, BARRIQUES AND S. BRANCHES AND ALL EXISTING SEWER STRUCTURES AT THE PROPOSED LOCATIONS WITH STATIONING PLAINLY MARKED. ANY CHANGE IN LOCATION SHALL BE APPROVED IN WRITING BY THE COUNTY ENGINEER. THE CONTRACTOR SHALL BE RESPONSIBLE FOR THE LOCATION OF ALL STRUCTURES AND SHALL BE RESPONSIBLE FOR THE LOCATION OF ALL STRUCTURES AND SHALL BE RESPONSIBLE FOR THE LOCATION OF ALL STRUCTURES.

NOTE:
 BEFORE STARTING ANY WORK ON EXISTING STRUCTURES, THE COUNTY SANITATION DISTRICT SHOULD BE NOTIFIED IN ORDER THAT REQUIRED INSPECTION MAY BE MADE.

**PROFILE ALIGNMENT AND GRADE OF
 SANITARY SEWERS
 TO BE CONSTRUCTED IN
 SANITARY SEWER RIGHT OF WAY
 BETWEEN 400 W. OF AND TEMPLE CITY BLVD.**

PRIVATE CONTRACT No. 2207
 W. A. 44
SHEET 1 OF 1 SHEETS

PREPARED IN THE OFFICES OF
ANDREASEN-PHELPS ENGR. CO.

Robert R. Andreason R.C. 5205

FOR LEGEND
 NOTE: GRADES TO WHICH THIS IMPROVEMENT IS TO BE CONSTRUCTED AND SHOWN ON PLANS AND PROFILES.
 GRADE POINTS FOR TOP OF CURB, CENTER LINE OF STREET OR CENTER LINE OF ALLEY, AND ELEVATION OF THE TOP OF THE CURB OR CENTER LINE OF STREET OR ALLEY SHALL BE SHOWN BY A STRAIGHT LINE DRAWN BETWEEN SAID ELEVATED POINTS.
 THIS DRAWING AND THE DATA HEREON ARE HEREBY MADE A PART OF THE SPECIFICATIONS.
 WORK SHALL BE CONSTRUCTED ACCORDING TO SPECIFICATIONS ON FILE IN THE OFFICE OF THE COUNTY ENGINEER AND SHALL BE PROSECUTED ONLY IN THE PRESENCE OF THE COUNTY ENGINEER.
 BEFORE WORK CAN BE STARTED, THE CONTRACTOR MUST OBTAIN A PERMIT TO EXCAVATE, REPAIR AND MAKE A DEPOSIT WITH THE COUNTY ENGINEER'S OFFICE TO COVER THE COST OF INSPECTION AND RECORD PLANS.
 IF WORK IS TO BE DONE IN A STATE HIGHWAY, A PERMIT MUST BE OBTAINED FROM THE STATE OF CALIFORNIA DIVISION OF HIGHWAYS IN SOUTH COUNTY AFTER HAVING THE REPORT WITH THE COUNTY ENGINEER'S OFFICE APPROVED BY THE STATE OF CALIFORNIA DIVISION OF HIGHWAYS.
 IF THE CONTRACTOR HAS ANY QUESTIONS CONCERNING THE SPECIFICATIONS OR THE LOCATION OF THE STRUCTURES, HE SHOULD CONSULT WITH THE COUNTY ENGINEER'S OFFICE WITHIN THE LIMITS OF THIS PROJECT.

COUNTY OF LOS ANGELES, CALIFORNIA
 APPROVED WILLIAM J. [Signature] COUNTY ENGINEER
 APPROVED BY [Signature] COUNTY ENGINEER
 COUNTY SANITATION DISTRICT No. 15
 OFFICE OF COUNTY ENGINEER, 12 N. W. 2nd St.

MAY 1952

ONE SHEET
 5501
 5502