

B.M. 1107 El. 63.633 L.A. 741 pg. 124
Woodruff's Park Ave. N.W. Cor. Cul. Inlet
2' W. in N. Co. Park Ave. 21' W. end of C.B.

- (1) USE STANDARD MANHOLE FRAMES AND COVERS, S-111
 - (2) USE STANDARD STRENGTH PIPE
 - (3) USE CEMENT MORTAR FOR ALL VITRIFIED CLAY PIPE JOINTS
 - (4) RESURFACE ALL TRENCH WITHIN PAVED AREA TO MEET LOS ANGELES COUNTY ROAD DEPARTMENT REQUIREMENTS
 - (5) CONNECT HOUSE CONNECTIONS WITH INVERT AT PROPERTY LINE FEET BELOW GRADE OF CURB
 - (6) ALL STRUCTURES SHALL BE BRICK SEWER STRUCTURES, 3' x 10'
 - (7) LARGEST FOUR FEET OF SEWER AT POINTS OF INTERFERENCE WITH POLES IN PER'S 2-119
 - (8) CONTRACTOR SHALL BE RESPONSIBLE FOR ALL RIGHTS-OF-WAY ABOVE FINISHED GRADE
 - (9) EXISTING STAKES ON THE PROPERTY LINES OR PROPERTY LINES REDUCED AT RIGHT ANGLES TO THE SEWER LINE AT THE CENTER LINE OF EACH MANHOLE
 - (10) NO REPRESENTATIVE OF THE COUNTY ENGINEER WILL SURVEY OR LAY OUT ANY PORTION OF THE WORK
 - (11) THE OWNER OR HIS AUTHORIZED REPRESENTATIVE SHALL FURNISH THE COUNTY ENGINEER WITH WORKING STREETS & STATIONS IN ALL THESE LOCATIONS FROM 8' BY EXISTING 2" SPACE PROVIDED STAKES FOR FROM AT NEAR FRAMES - EXISTING NEW CONNECTIONS - PLAIN - EXISTING - ANY CHANGE IN LAYOUT SHALL BE DEMONSTRATED IN WRITING BY THE OWNER OR HIS AUTHORIZED REPRESENTATIVE
 - (12) NO REVISIONS SHALL BE MADE IN THE PLAN WITHOUT APPROVAL OF THE COUNTY ENGINEER
 - (13) STOPPERS TO BE INSTALLED WITH JOINT COMPANED BY MANHOLE COVER AT THE POINT
- SPEC. SEC. 33.48
CONCRETE PAVEMENT TO BE NOT LESS THAN 2" IN DEPTH WITH CONCRETE SAN. SPEC. SEC. 43
INSTALL WIRE AND TRGS PER SPEC. SEC. 48

PROFILE, ALIGNMENT AND GRADE OF
SANITARY SEWERS
TO BE CONSTRUCTED IN
PARK AVE.
EAST OF CALIFORNIA AVE.
AND
SANITARY SEWER EASEMENT

PRIVATE CONTRACT NO. 2238
W. S. 33
ONE SHEET

PREPARED IN THE OFFICES OF
MUNNIELLY & PONL
BY: *Richard C. Fisher*
REG. C.E. No. 21212

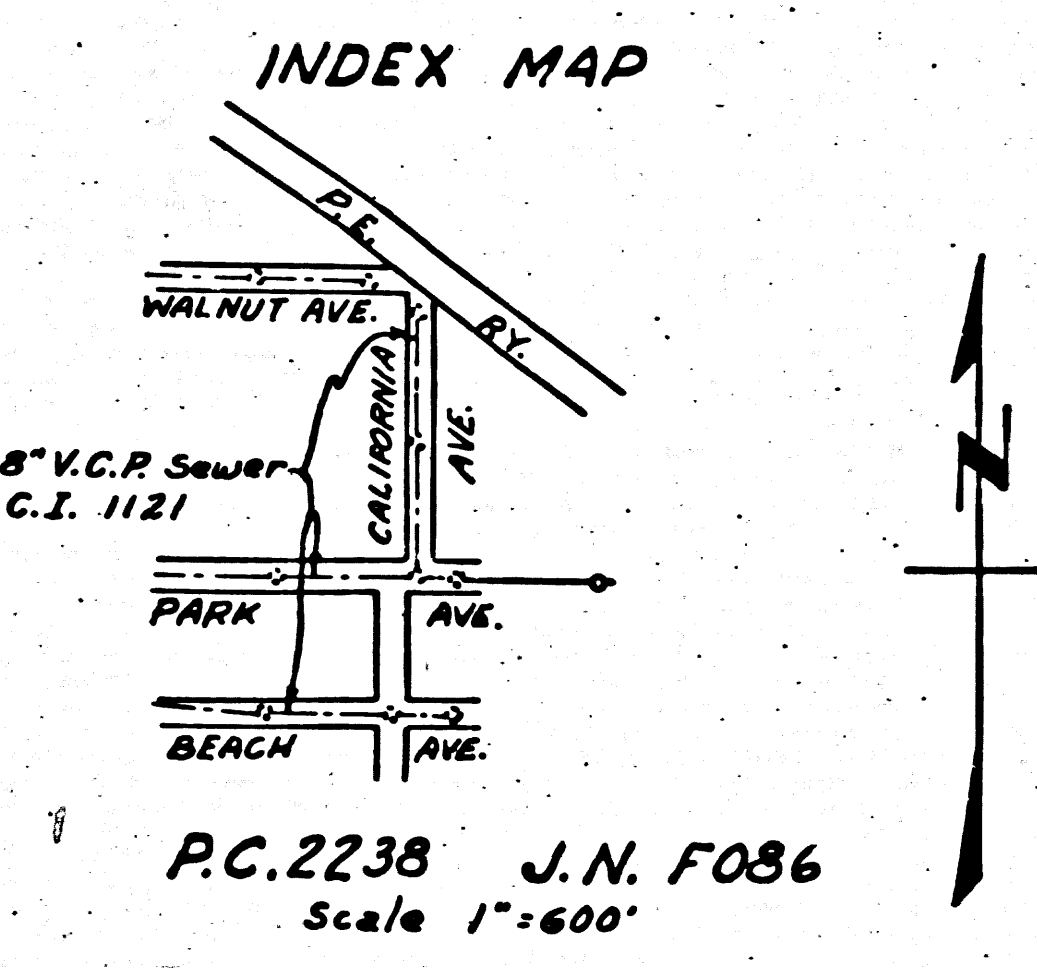
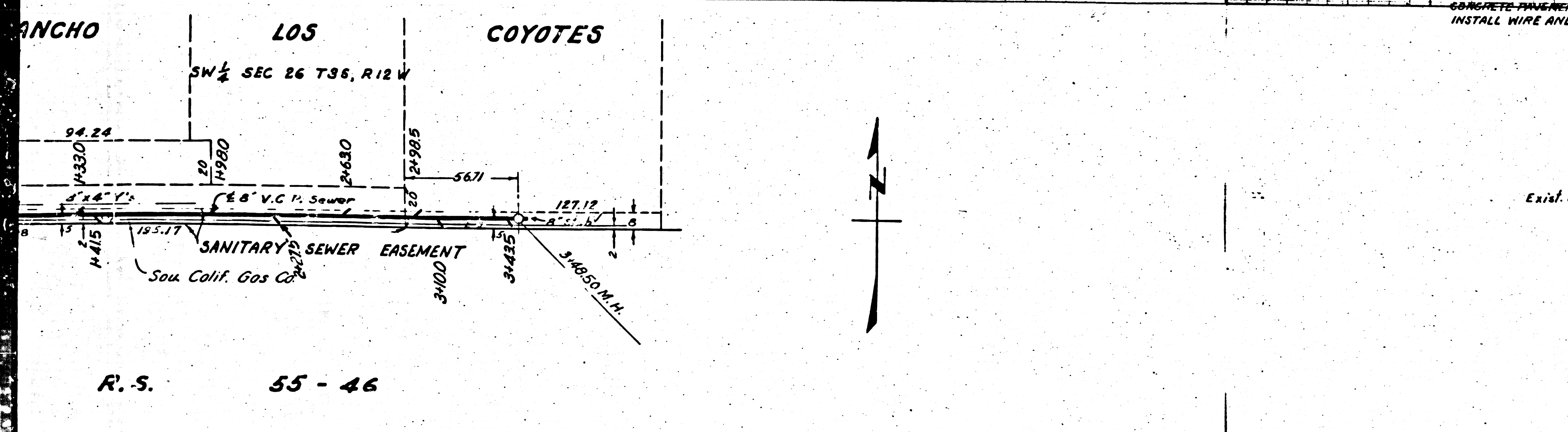

INDEX MAP
Exist. 6" V.C.P. Sewer
C.I. 1121
P.C. 2238 J.N. F086
Scale 1"=600'

FOR LEGEND
See Plan No. 8-2-64

NOTE:
ELEVATIONS ARE IN FEET ABOVE U.S.G.S. DATUM OR MEAN SEA LEVEL.
THIS DRAWING AND THE DATA HEREON ARE HEREBY MADE A PART OF THE SPECIFICATIONS.
WORK SHALL BE CONSTRUCTED ACCORDING TO SPECIFICATION ON FILE IN THE OFFICE OF THE COUNTY ENGINEER AND SHALL BE INSPECTED ONLY IN THE PRESENCE OF THE COUNTY ENGINEER.
BEFORE WORK CAN BE STARTED THE CONTRACTOR MUST OBTAIN A PERMIT TO EXCAVATE IN COUNTY STREETS FROM LOS ANGELES COUNTY ROAD DEPARTMENT, 100 WEST 8TH ST. AND MAKE A DEPOSIT WITH THE COUNTY ENGINEER, 730 COUNTY ENGINEERING BUILDING SUFFICIENT TO COVER COST OF CONSTRUCTION INSPECTION AND RECORD PLANS.
IF WORK IS TO BE DONE IN A STATE HIGHWAY, A PERMIT MUST BE OBTAINED FROM THE STATE OF CALIFORNIA DIVISION OF HIGHWAYS, 120 SOUTH SPRING ST. AFTER MAKING THE DEPOSIT WITH THE COUNTY ENGINEER.
APPROVAL OF THIS PLAN BY THE COUNTY OF LOS ANGELES DOES NOT CONSTITUTE A REPRESENTATION AS TO THE ACCURACY OF THE LOCATION OF OR THE EXISTENCE OR NON-EXISTENCE OF ANY UNDERGROUND UTILITY PIPE OR STRUCTURE WITHIN THE LIMITS OF THIS PROJECT.

COUNTY OF LOS ANGELES, CALIFORNIA
APPROVED *William J. Fox* COUNTY ENGINEER
APPROVED *J.M. Dawn* CHIEF ENGINEER OF COUNTY SANITATION DISTRICT NO. 2
BY: *Richard C. Fisher* CHIEF DEPUTY
BY: *J.P. Jones* OFFICE ENGINEER

CHECKED BY: *Richard C. Fisher* 6-28-53
OFFICE OF COUNTY ENGINEER R.L. NO. 786

STAMPS:
JUL 30 1952
JUL 30 1952

R. S. 55 - 46

SS38

J.N. F086

Let's d 9-16-52 *W. J. Fox*

Trim Line