

ALTADENA

B.M. ELEV. 66.220 T.E. 691, E.R. 1588.95  
LOTUS AVE. @ GREEN ST., S.W. COR. BL. SPK.  
P.P. 166110-C

15,043

- 1. USE STANDARD MANHOLE FRAMES AND COVERS 24" DIA.
  - 2. USE STANDARD 12" RIBBED PIPE (EXCEPT AS NOTED).
  - 3. THE CHASES FOR THE MANHOLES SHALL BE CAST IN PLACE.
  - 4. BRASSFACE ALL BRANCH WITHIN PAVED AREA TO MEET LOS ANGELES COUNTY ROAD DEPARTMENT OR CALIFORNIA STATE HIGHWAY DEPARTMENT.
  - 5. CONSTRUCT HOUSE CONNECTIONS WITH INVERT AT PROPERTY LINE (3" FEET BELOW CURB GRADE (EXCEPT AS NOTED).
  - 6. MINIMUM SLOPE OF SEWER AT POINTS OF INTERFERENCE WITH POLES AS PER 8-118.
  - 7. ALL STRUCTURES SHALL BE BRICK EXCEPT MANHOLES.
  - 8. CONSTRUCT TOPS OF ALL STRUCTURES IN RIGHTS OF WAY 4" INCHES ABOVE FINISHED GRADE.
  - 9. FOR CHANGE IN LEAKAGE TEST SEE SPEC 48 OF SPECIFICATIONS.
  - 10. WHERE GROUND WATER IS ENCOUNTERED, WESTON'S GASKETS AND FORMS SHALL BE USED, PER 8-21.
- NOTE:  
NO REPRESENTATIVE OF THE COUNTY ENGINEER WILL SURVEY OR LAYOUT ANY PORTION OF THE WORK.  
THE OWNER OR HIS AUTHORIZED REPRESENTATIVE SHALL FURNISH THE COUNTY ENGINEER WITH GRADE SHEETS AND STATIONS ON ALL HOUSE CONNECTIONS AND MANHOLES. 3" SMALL IRONING STAKES FOR LINES AT CURB, BLOW LOCATIONS WITH 1/4" 3" PINNED MARKED ANY CHANGE IN LOCATION SHALL BE RECORDED IN THE RECORDS OF THE COUNTY ENGINEER.  
PROVIDE STAKES ON THE PROPERTY LINES OR 20' TO 25' LINES PRODUCED BY SURVEY UNLESS TO THE STREET LINE TO THE CENTER LINE THROUGH NO SURVEYING SHALL BE MADE IN THESE PLACES WITHOUT THE REVIEW OF THE COUNTY ENGINEER.  
STOPPERS TO BE INSTALLED 1" JOINT COMPOUND BY MANUFACTURER AT HIS PLANT. SPEC'S SEC. 13.48.  
CONCRETE PAVEMENT TO BE CUT NOT LESS THAN 2" IN DEPTH WITH CONG. CRETE SAW SPEC'S SEC. 68.  
WIRE AND TARS. SPEC'S SEC. 48.

PROFILE ALIGNMENT AND GRADE OF  
**SANITARY SEWERS**  
TO BE CONSTRUCTED IN  
**SANITARY SEWER RIGHT OF WAY  
FROM THE WESTERLY TERMINUS  
OF GREEN STREET TO 172.68 FT.  
WESTERLY**

**PRIVATE CONTRACT No. 2277**  
W.S.  
**SHEET 1 OF 1 SHEETS**

SCALE: VERT. 1" = 4'  
HORIZ. 1" = 40'  
JUNE 1952  
PREPARED IN THE OFFICES OF  
**TED M. WALSH**  
BY *T.M. Walsh*  
COUNTY OF LOS ANGELES P.E. 7211

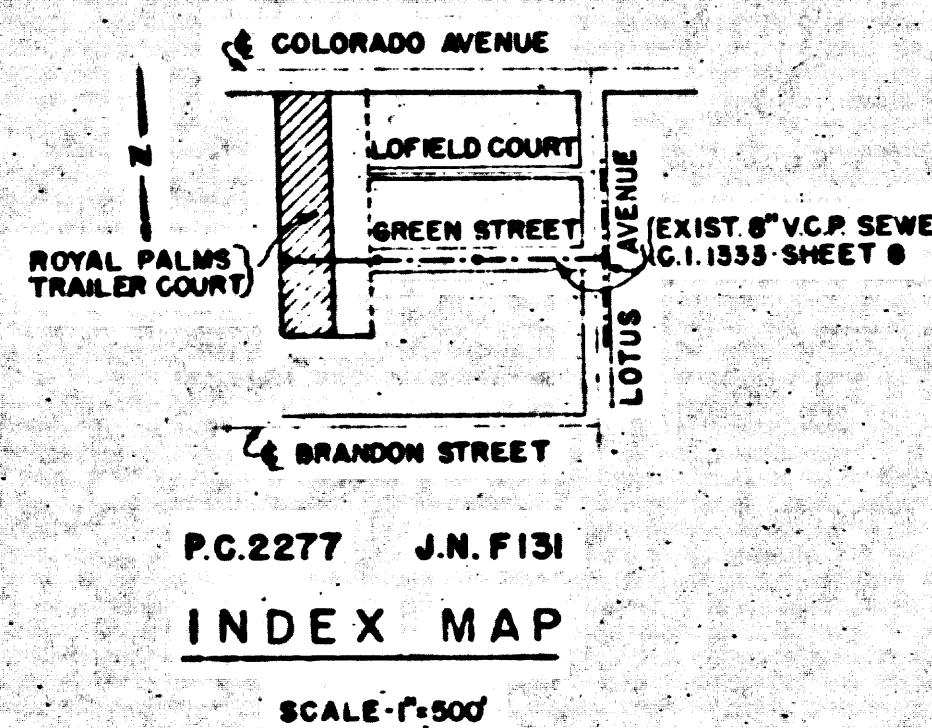

AUG 7 1952

**FOR LEGEND**

ALL TRADES TO WHICH THIS CONTRACT IS TO BE CONSTRUCTED AND SHOWS IN THESE PLANS SHALL BE IN ACCORDANCE WITH THE STANDARD SPECIFICATIONS FOR THE COUNTY OF LOS ANGELES. ALL WORK SHALL BE DONE IN ACCORDANCE WITH THE STANDARD SPECIFICATIONS FOR THE COUNTY OF LOS ANGELES. ALL WORK SHALL BE DONE IN ACCORDANCE WITH THE STANDARD SPECIFICATIONS FOR THE COUNTY OF LOS ANGELES. ALL WORK SHALL BE DONE IN ACCORDANCE WITH THE STANDARD SPECIFICATIONS FOR THE COUNTY OF LOS ANGELES.

COUNTY OF LOS ANGELES CALIFORNIA  
APPROVED WILLIAM J. FOX BY *William J. Fox*  
ASS. COUNTY ENGINEER  
APPROVED A.M. RAWN BY *A.M. Rawn*  
OFFICE ENGINEER  
CHECKED *A.M. Rawn* 7-11-52

checked 8-20-52 *W. J. Fox*

BC 5511  
ONE SHEET  
J.M.  
P.C. 2277

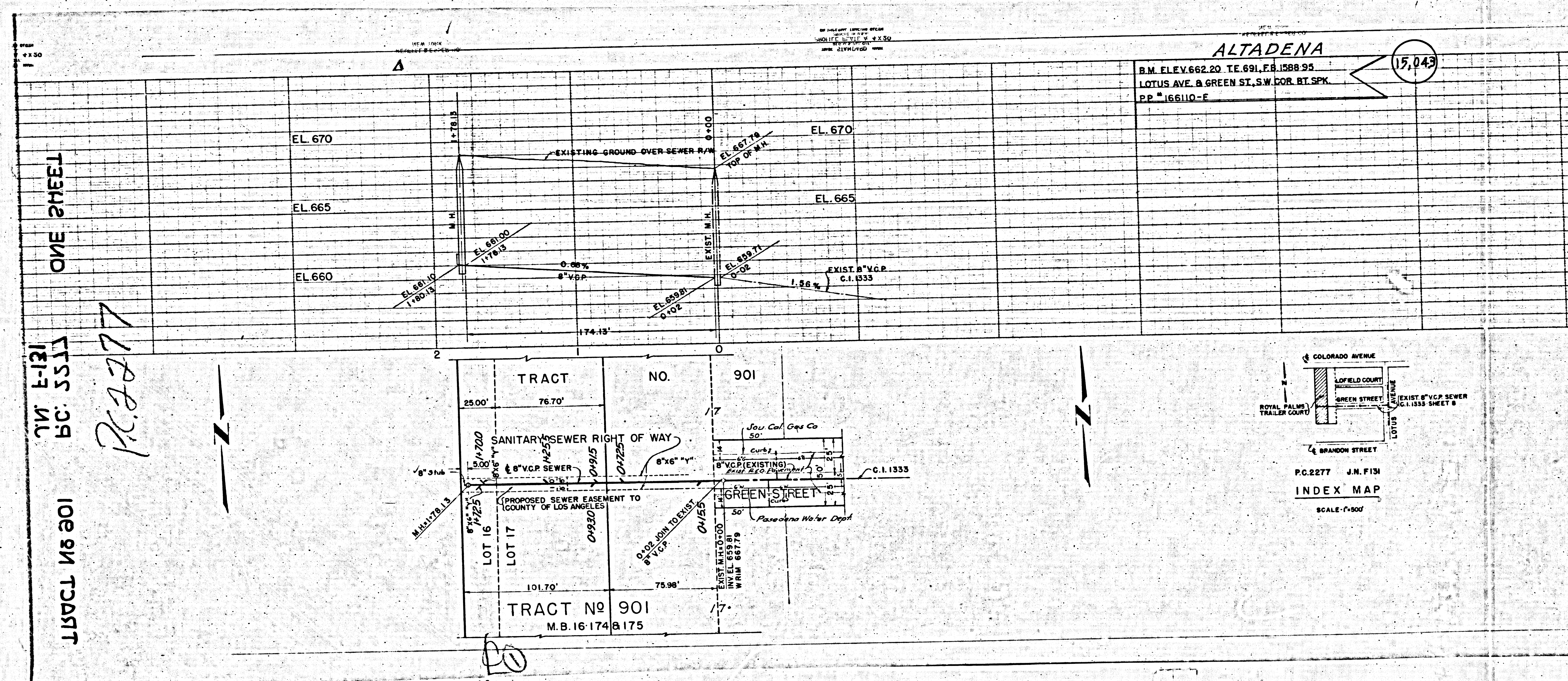

ONE SHEET

TRAC 16 801

106 9N TRACT

170 E-121  
BC: 5517  
P.C. 2277

ALTADENA  
S.M. ELEV. 662.20 T.E. 691. E.H. 1588.95  
LOTUS AVE. & GREEN ST., S.W. COR. BT. SPK.  
P.P. 166110-E

15,043

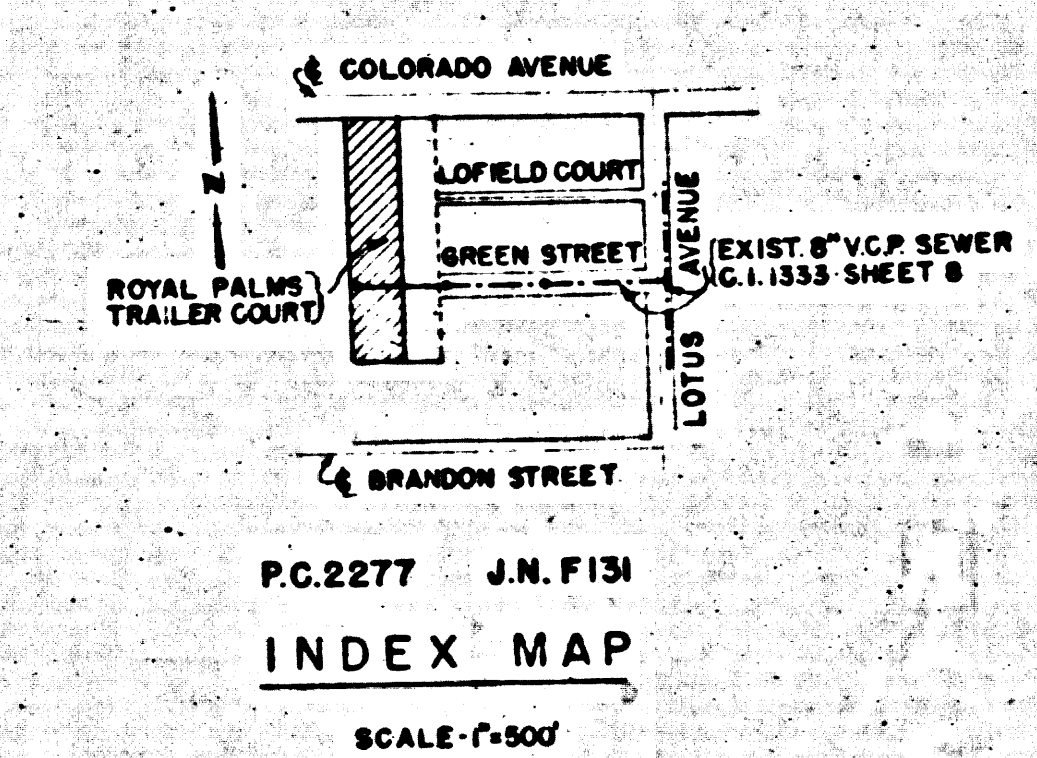

P.C. 2277 J.N. FISH  
INDEX MAP  
SCALE 1"=500'

TRACT NO. 901  
M.B. 16-174 & 175

20