

6C 5582 P.C. 2285

B.M. 55-2.729 L.B. 389 p. 84  
 Elev. 105.894 S.E. Cor. 255' W. of  
 E. Lucille Ave. - Bl. Spk. M.C.R.

15,067

1) USE STANDARD MANHOLES  
 2) USE STANDARD STRENGTH  
 3) USE CEMENT MORTAR  
 4) THE SURFACE OF ALL TRENCHES  
 5) THE DEPARTMENT OF  
 6) THE DEPARTMENT OF  
 7) ALL STRUCTURES SHALL  
 8) PROVIDE STAKES OF  
 9) RIGHT ANGLES TO  
 10) THE CENTERLINE OF THE  
 11) THE OWNER OR HIS AUTHORITY  
 12) SHALL BE REMOVED IN WRITING  
 13) NO REVISIONS SHALL BE  
 14) STOPPED TO BE INSTALLED  
 15) SPEC. SEE 38 48  
 16) 18" CONCRETE PIPE SHALL BE  
 17) INSTALLED WITH 4 TAGS  
 18) FOR CHANGE IN LEAKAGE  
 19) WHERE GROUND WATER

J.T.  
 CYPRESS  
 P.C.



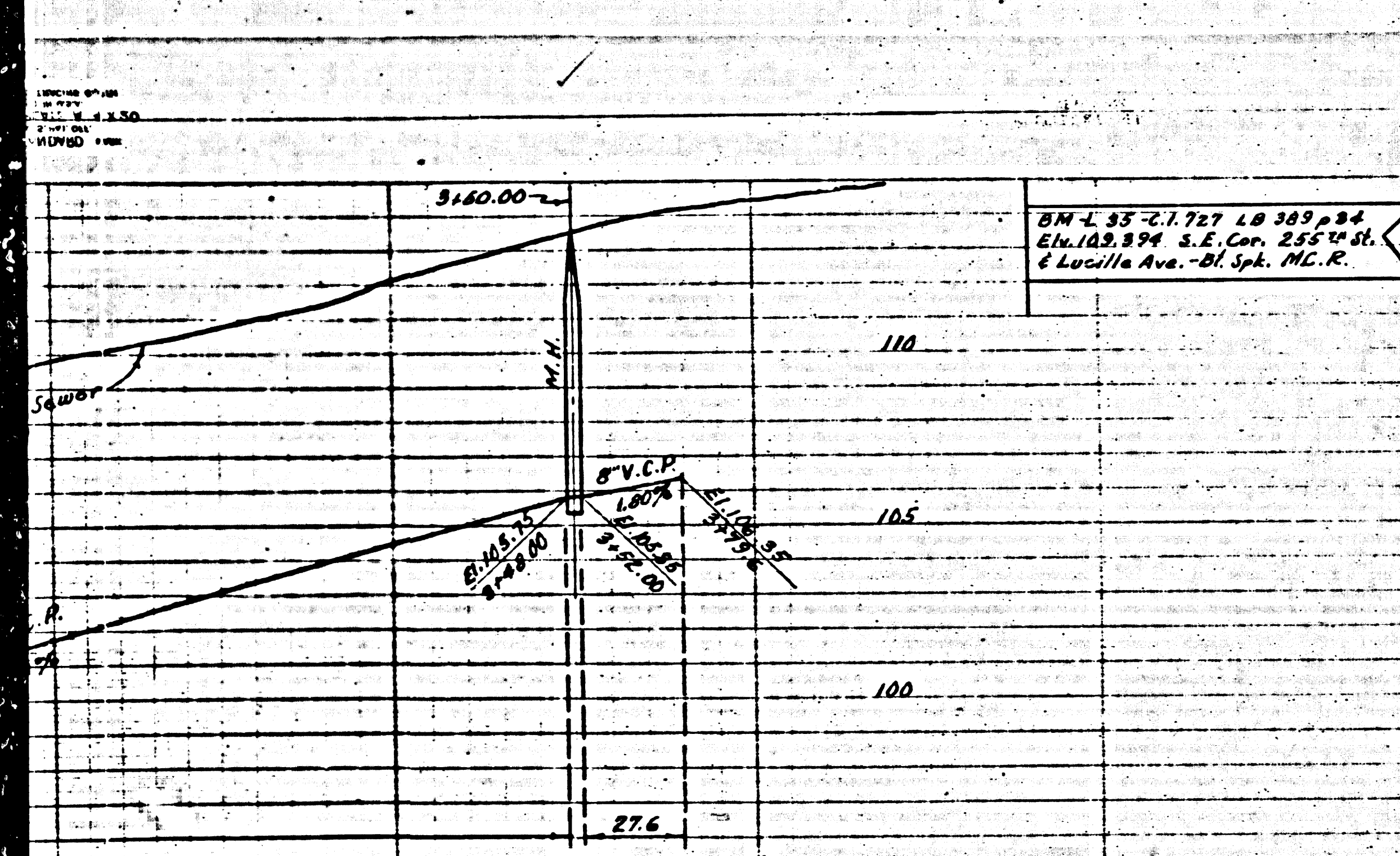

11	105	100
----	-----	-----

PROFILE, ALIGNMENT AND GRADE OF  
**SANITARY SEWERS**  
 TO BE CONSTRUCTED IN R/W  
 SO. OF 255<sup>TH</sup> ST.  
 BETWEEN LUCILLE AVE. & NARBONNE AVE.

**PRIVATE CONTRACT NO 2283**  
 W-S-27428  
 ONE SHEET

PREPARED IN THE OFFICES OF  
 MUNNELLY & POND  
 BY: Marshall B. Pond  
 REG. C.E. NO. 8232

FOR LEGEND  
 See Plan No 5-a-64

NOTE:  
 ELEVATIONS ARE IN FEET ABOVE U.S.G.S. DATUM ON MEAN SEA LEVEL.  
 THIS DRAWING AND THE DATA HEREON ARE HEREBY MADE A PART OF THE SPECIFICATIONS.  
 WORK SHALL BE CONSTRUCTED ACCORDING TO SPECIFICATION NO. 10 IN THE OFFICE OF THE COUNTY ENGINEER AND SHALL BE PROSECUTED ONLY IN THE PRESENCE OF THE COUNTY ENGINEER.  
 BEFORE WORK CAN BE STARTED THE CONTRACTOR MUST OBTAIN A PERMIT TO EXCAVATE IN COUNTY STREETS FROM LOS ANGELES COUNTY ROAD DEPARTMENT, 103 WEST 8<sup>TH</sup> ST. AND MAKE A DEPOSIT WITH THE COUNTY ENGINEER, THE COUNTY ENGINEERING BUILDING SUFFICIENT TO COVER COST OF CONSTRUCTION INSPECTION AND RECORD PLANS.  
 IF WORK IS TO BE DONE IN A STATE HIGHWAY, A PERMIT MUST BE OBTAINED FROM THE STATE OF CALIFORNIA, DIVISION OF HIGHWAYS, 100 SOUTH BOWLING ST. AFTER MAKING THE DEPOSIT WITH THE COUNTY ENGINEER.  
 APPROVAL OF THIS PLAN BY THE COUNTY OF LOS ANGELES DOES NOT CONSTITUTE A REPRESENTATION AS TO THE ACCURACY OF THE LOCATION OF, OR THE EXISTENCE OR NON-EXISTENCE OF ANY UNDERGROUND UTILITY PIPE OR STRUCTURE WITHIN THE LIMITS OF THIS PROJECT.

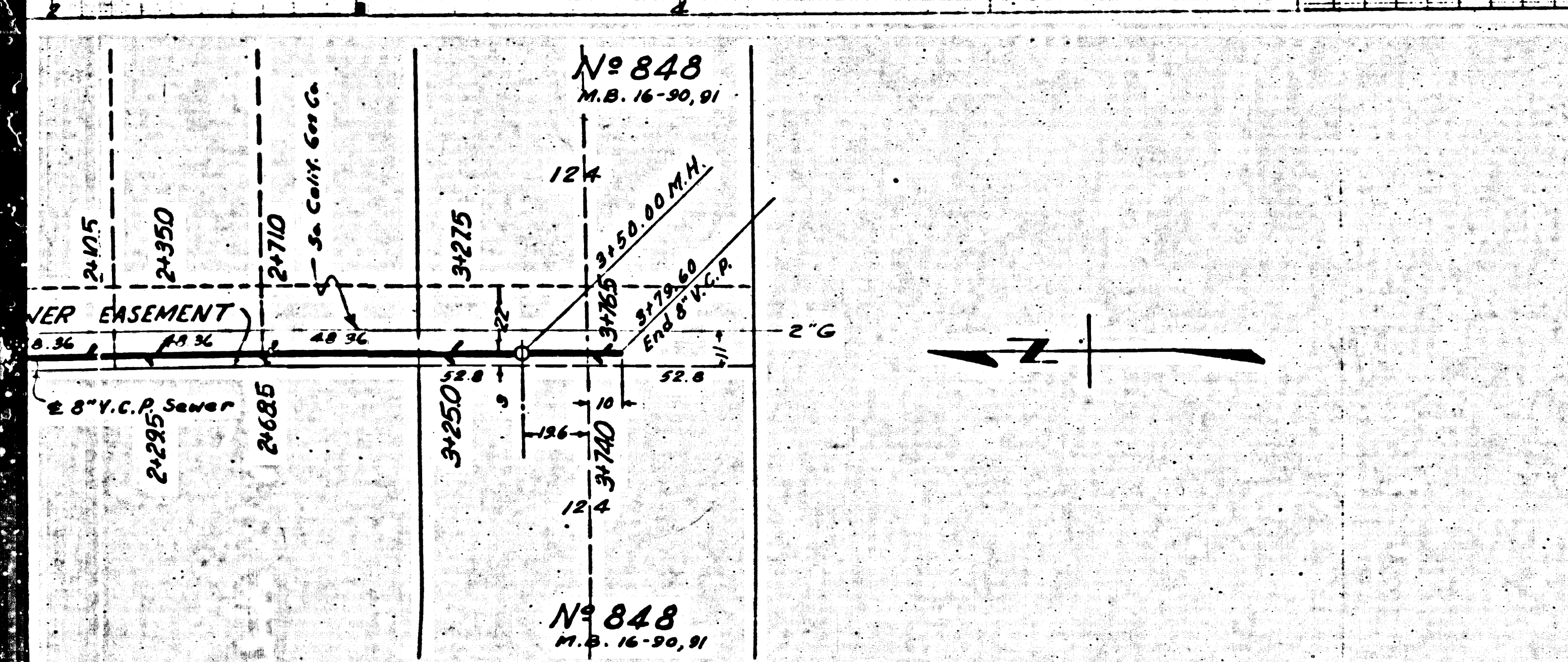
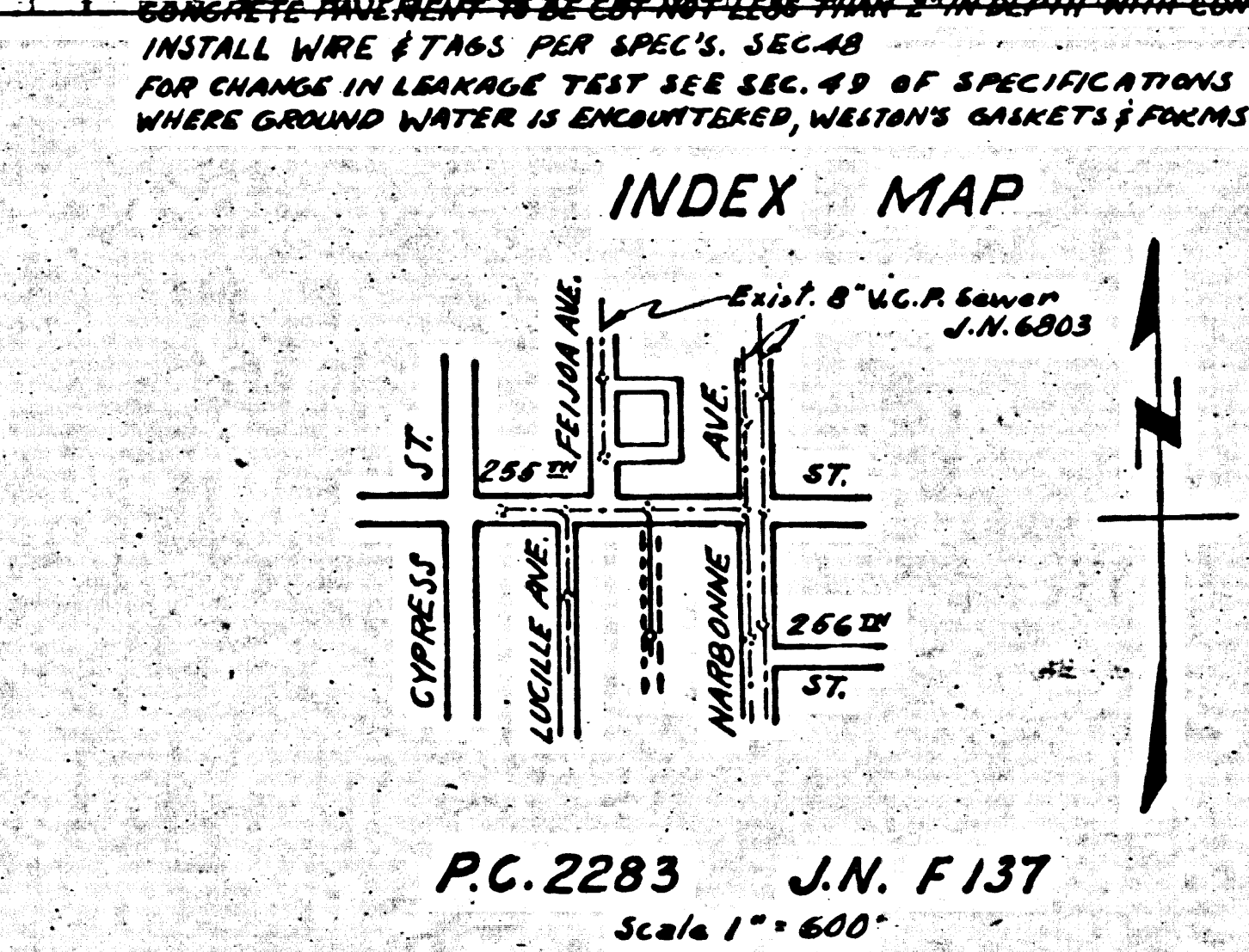

**COUNTY OF LOS ANGELES, CALIFORNIA**

APPROVED WILLIAM J. FOX COUNTY ENGINEER  
 BY K. L. Gregory CHIEF DEPUTY

APPROVED A. M. BAWN CHIEF ENGINEER OF COUNTY SANITARY DISTRICT NO. 6  
 BY E. J. [Signature] OFFICE ENGINEER

CHECKED BY [Signature] OFFICE OF COUNTY ENGINEER R.E. NO. 111  
 100 checked R.R. 7-16-52

dated 9-16-52 W. Kern

P.C. 2283  
 BC 5503  
 111