

FLORENCE Bldg. Dist.

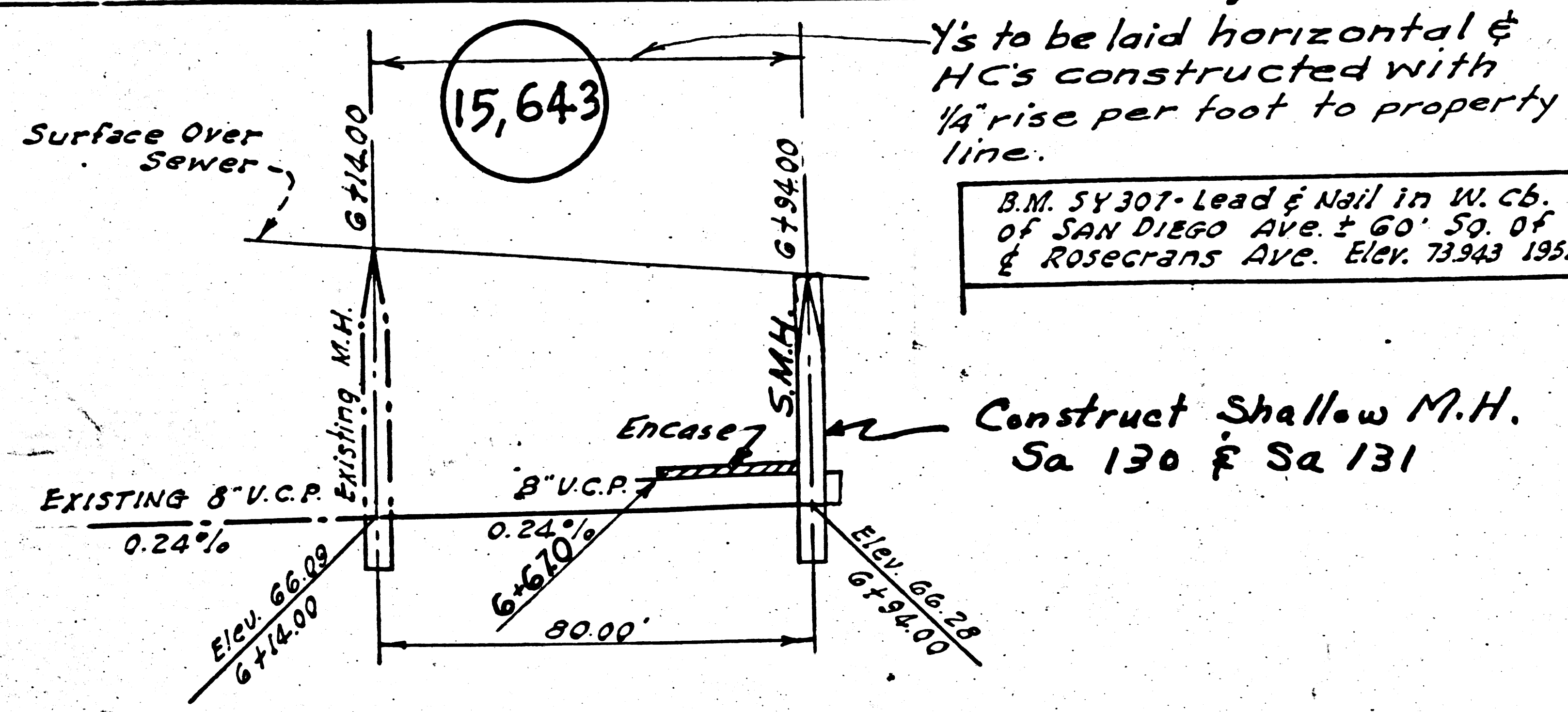

B.M. 54307- Lead & Nail in W. cb. of SAN DIEGO Ave. & 60' So. of Rosecrans Ave. Elev. 73.943 1951

P.C. 2365

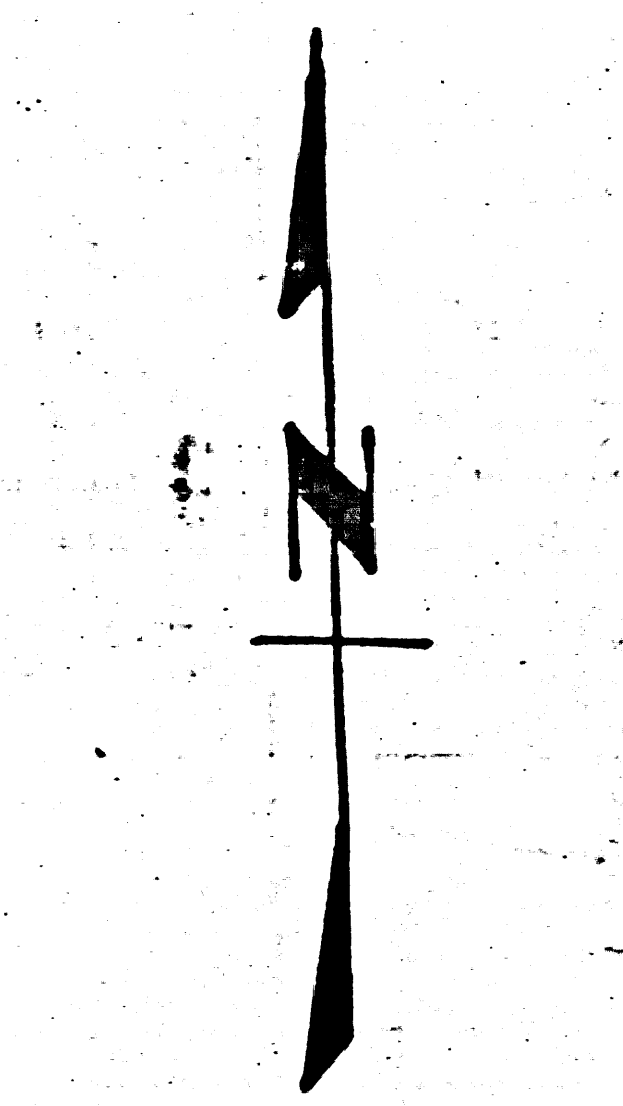
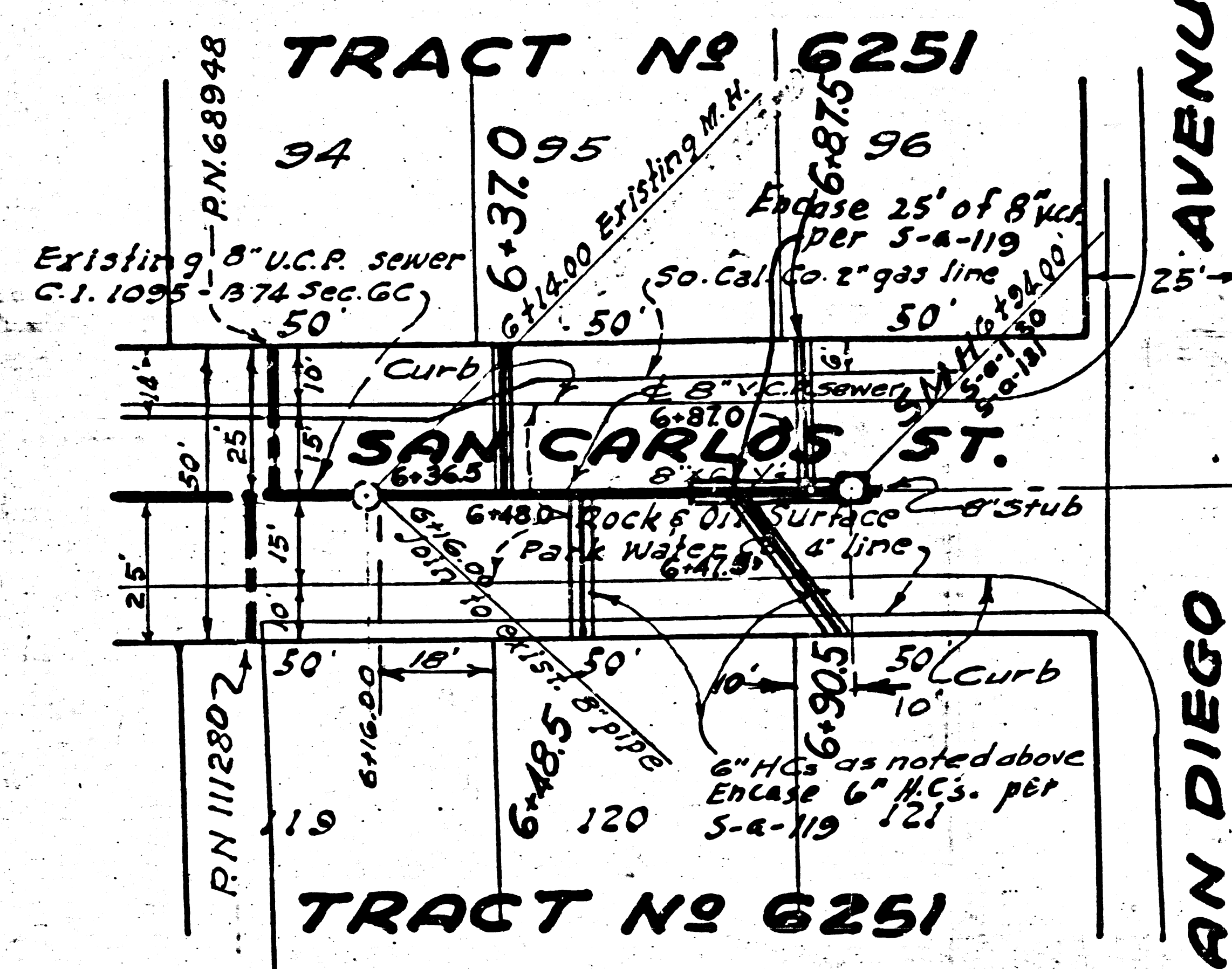

Horiz. 1"=40'
Scale: Vert. 1"=4'

RECEIVED
DEC 15 1952
L. A. COUNTY ENGINEER

Plans 12-19-52 W. L. Fox NAME OF PROPERTY OWNER
REQUESTING SEWER CONSTRUCTION R.H. Klattenberg

Note:
Work shall be constructed in accordance with the specifications on file in the office of the County Engineer and shall be prosecuted only in the presence of the County Engineer or his representative.
The engineer shall set stakes for main line sewer and supply the County Engineer with grade sheets.
Use Shallow M.H. per S-d-130
Use Shallow M.H. frames & covers per S-d-181

APPROVED *Rubén E. Kuhn* 9-16-52
OFFICE OF COUNTY ENGR
R.C.E. No. 7860

P.C. 2365 J.N. F226

PREPARED BY *Rubén E. Kuhn*
REG. C. E. 8080
WILLIAM J. FOX COUNTY ENGR

APPROVED *W. L. Fox*
CHIEF DEPUTY
A.M. PAW
APPROVED BY *W. L. Fox* ASSIST.
CHIEF ENGINEER OF COUNTY
SANITATION DISTRICT No. 1
5-2022 *J.W.*