

- NOTE: NO REPRESENTATIVE OF THE COUNTY ENGINEER WILL SURVEY OR LAY OUT ANY PORTION OF THE WORK. THE OWNER OR HIS AUTHORIZED REPRESENTATIVE SHALL FURNISH THE COUNTY ENGINEER WITH GRADE SHEETS AND STATIONS FOR ALL HOUSE CONNECTIONS AND Y BRANCHES AND SHALL PROVIDE STAKES FOR THEM AT THEIR PROPER LOCATIONS WITH STATIONING PLAINLY MARKED. ANY CHANGE IN LOCATION SHALL BE REQUESTED IN WRITING BY THE OWNER OR HIS REPRESENTATIVE. NO REVISIONS SHALL BE MADE IN THESE PLANS WITHOUT APPROVAL OF THE COUNTY ENGINEER.
1. USE STANDARD MANHOLE FRAMES AND COVERS, S-a-117.
 2. USE STANDARD STRENGTH PIPE EXCEPT AS NOTED.
 3. USE CEMENT MORTAR FOR ALL VITRIFIED CLAY PIPE JOINTS.
 4. RESURFACE ALL TRENCH WITHIN PAVED AREA TO MEET L.A. COUNTY ROAD DEPT. REQUIREMENTS.
 5. ENCASE FOUR FEET OF SEWER AT POINTS OF INTERFERENCE WITH POLFS, S-a-119.
 7. ALL STRUCTURES SHALL BE BRICK SEWER STRUCTURES, S-a-104.
 8. PROVIDE STAKES ON THE PROPERTY LINES OR PROPERTY LINES PRODUCED AT RIGHT ANGLES TO THE SEWER LINE AT THE CENTER LINE OF EACH MANHOLE.
 9. STOPPERS TO BE INSTALLED WITH JOINT COMPOUND BY MANUFACTURER AT HIS PLANT, SPEC'S. SEC. 33.48.
 10. CONCRETE PAVEMENT TO BE CUT NOT LESS THAN 2" IN DEPTH WITH CONCRETE SAW, SPEC'S. SEC. 65.
 11. INSTALL WIRE AND TAGS, SPEC'S. SEC. 48.

SHEET NO.	PAGES
1	1-3

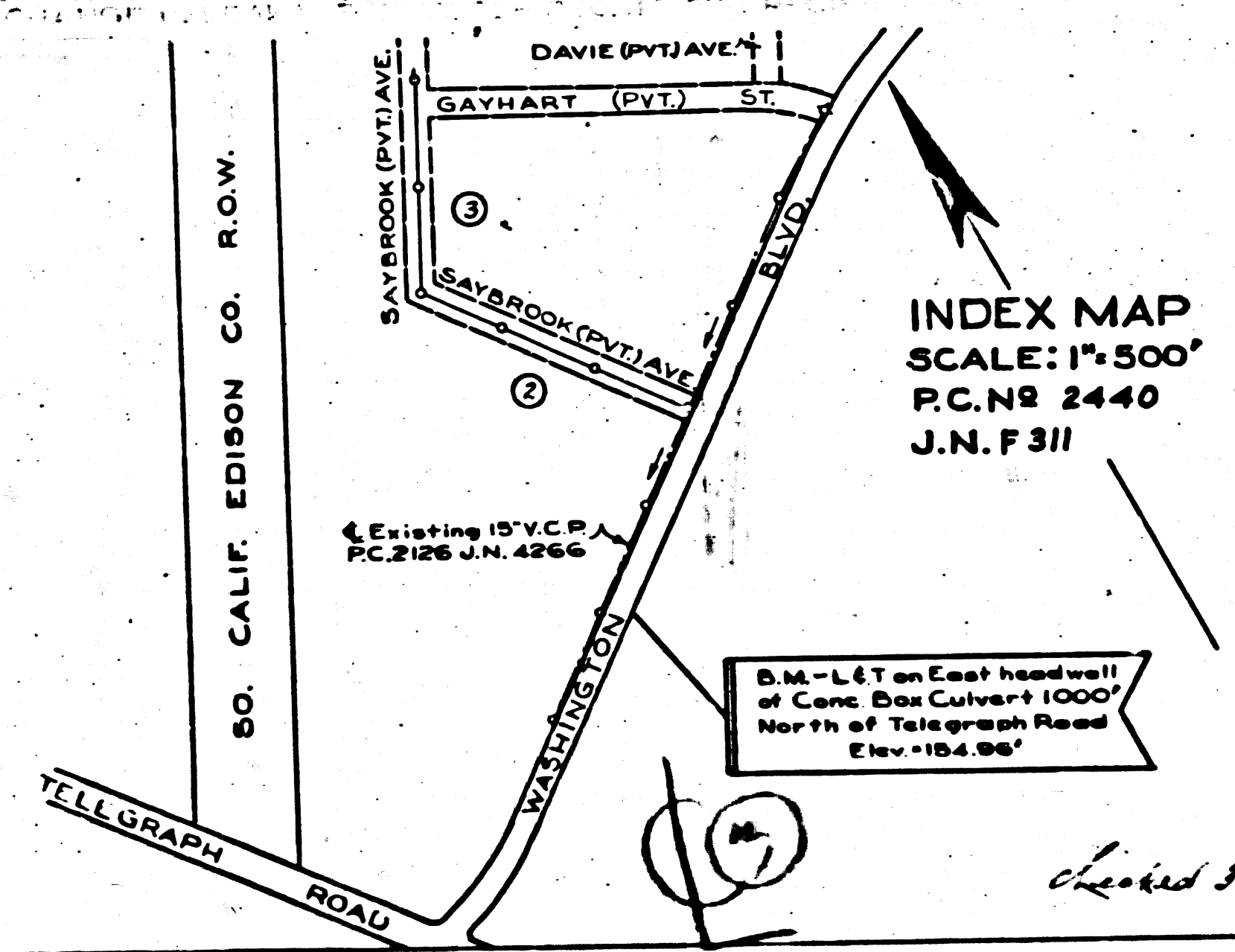

PROFILE, ALIGNMENT, AND GRADE OF
SANITARY SEWER
 TO BE CONSTRUCTED IN
SAYBROOK AVENUE

PRIVATE CONTRACT NO. 2440
 W.S. 36
 SHEET 1 OF 1 SHEET

PREPARED IN THE OFFICES OF
CENTRAL MANUFACTURING DISTRICT INC.
 CHECKED AND APPROVED BY *Charles C. Miller*
 REG. C.E. NO. 772

SCALE: VERT. 1" = 4'
 HORIZ. 1" = 40'
 OCT. 1952
 FOR LEGEND SEE PLAN NO. S-a-64

NOTE: GRADES TO WHICH THIS IMPROVEMENT IS TO BE CONSTRUCTED ARE SHOWN ON PLANS AND PROFILES. GRADE POINTS FOR TOP OF CURBS, CENTER LINE OF STREETS, OR CENTER LINE OF ALLEY ARE SHOWN BY CIRCLES ON PROFILES. AT ALL POINTS BETWEEN DESIGNATED POINTS THE GRADE SHALL BE ESTABLISHED SO AS TO CONFORM TO A STRAIGHT LINE DRAWN BETWEEN SAID DESIGNATED POINTS. ELEVATIONS ARE IN FEET ABOVE U.S.G.S. DATUM OR MEAN SEA LEVEL. THIS DRAWING AND THE DATA HEREON ARE HEREBY MADE A PART OF THE SPECIFICATIONS. WORK SHALL BE CONSTRUCTED ACCORDING TO SPECIFICATIONS ON FILE IN THE OFFICE OF THE COUNTY ENGINEER AND SHALL BE PROSECUTED ONLY IN THE PRESENCE OF THE COUNTY ENGINEER. BEFORE WORK CAN BE STARTED, THE CONTRACTOR MUST OBTAIN A PERMIT TO EXCAVATE IN COUNTY STREETS FROM THE L.A. COUNTY ROAD DEPT., 153 W. 2ND ST. AND MAKE A DEPOSIT WITH THE COUNTY ENGINEER, 735 L.A. COUNTY ENGINEERING BLDG., SUFFICIENT TO COVER THE COST OF CONSTRUCTION INSPECTION AND RECORD PLANS. APPROVAL OF THIS PLAN BY THE COUNTY OF LOS ANGELES DOES NOT CONSTITUTE A REPRESENTATION AS TO THE ACCURACY OF THE LOCATION OR THE EXISTENCE OR NON-EXISTENCE OF ANY UNDERGROUND UTILITY, PIPE, OR STRUCTURE WITHIN THE LIMITS OF THIS PROJECT. THIS NOTE APPLIES TO ALL SHEETS.

APPROVED, WILLIAM J. FOX, COUNTY ENGINEER
 BY *W. J. Fox*
 ASST. CHIEF DEPUTY

APPROVED, A.M. RAWN, CHIEF ENGR. SAN. DIST. NO. 2
 BY *A.M. Rawn*
 OFFICE ENGINEER

CHECKED BY: *H. G. ...* 11-12-52
 OFFICE OF COUNTY ENGINEER, REG. C.E. NO. 6212

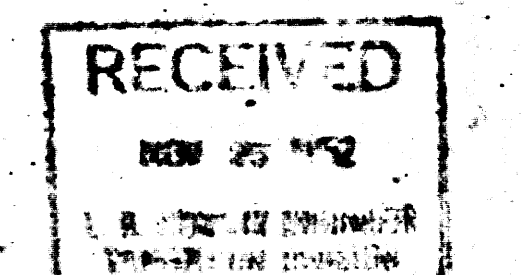

SAYBROOK AVENUE
 PC. 2440
 J.N.F.311

PC.2440 J.N.F311
PAGE 3

15,936

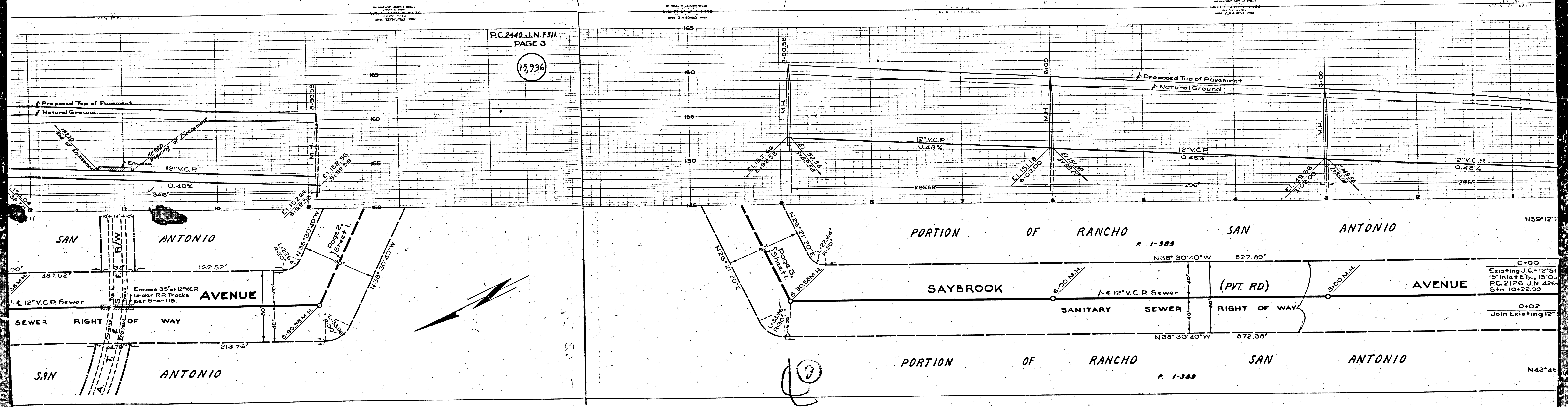

PORTION OF RANCHO SAN ANTONIO
A. 1-389

SAYBROOK AVENUE
SANITARY SEWER
RIGHT OF WAY
(PVT. RD.)

PORTION OF RANCHO SAN ANTONIO
A. 1-389

0+00
Existing J.C.-12" 15' Inlet Ely. 15' Out
PC. 2126 J.N. 426
Sta. 10+22.00

0+02
Join Existing 12"

N43°46'

