

EAST LOS ANGELES

TRIM LINE

B.M. S-58 CSFB 1121 Pg. 6
Bent spk. in curb S.E. of E. end
of curb return S.E. Cor. Beverly Blvd.
& Bradshaw St. Elev. 239.503

NOTE: NO REPRESENTATIVE OF THE COUNTY ENGINEER SHALL SURVEY OR LAY OUT ANY
PORTION OF THE WORK.
THE OWNER OR HIS SURVEYOR SHALL FURNISH THE COUNTY ENGINEER WITH SHEETS AND
AND SHALL, BEFORE STAKING THE CONSTRUCTION AND LOCATIONS WITH STAKES AND
PLANS SHOWN. ANY CHANGE IN THE LOCATION OF THE WORK SHALL BE MADE BY THE OWNER
OR HIS REPRESENTATIVE.
PROVIDE STAKES ON THE TYPICAL CURB CURVE WITH LINES PROCEEDED BY OWNER
AND TO THE CENTER LINE OF THE CENTER LINE OF LOCAL HIGHWAY.
NO RECORDS SHALL BE MADE IN THESE PLANS WITHOUT APPROVAL OF THE COUNTY
ENGINEER.

PROFILE ALIGNMENT AND GRADE OF
SANITARY SEWERS
TO BE CONSTRUCTED IN
ALLEY SOUTH OF BEVERLY BLVD.
BETWEEN 625' E. OF GERHART ST. & 85' E. OF GERHART ST.

PC 2607
J.N. F499

Page 1

16,102

1. USE STANDARD MANHOLE FRAMES AND COVER SLABS.
2. USE STANDARD MANHOLE RISE INDICATORS.
3. USE COUNTY STANDARD FOR ALL STRUCTURES.
4. USE COUNTY STANDARD FOR ALL STRUCTURES.
5. USE COUNTY STANDARD FOR ALL STRUCTURES.
6. USE COUNTY STANDARD FOR ALL STRUCTURES.
7. USE COUNTY STANDARD FOR ALL STRUCTURES.
8. USE COUNTY STANDARD FOR ALL STRUCTURES.
9. USE COUNTY STANDARD FOR ALL STRUCTURES.
10. USE COUNTY STANDARD FOR ALL STRUCTURES.

PRIVATE CONTRACT No. 2607
W.S. 36
SHEET 1 OF 1 SHEETS
SCALE: VERT. 1"=4'
HORIZ. 1"=40'

FEBRUARY 1953

PREPARED IN THE OFFICES OF
TED M. WALSH

Ted M. Walsh
RE 6371

SHEET NO.	PAGES
1	1-2

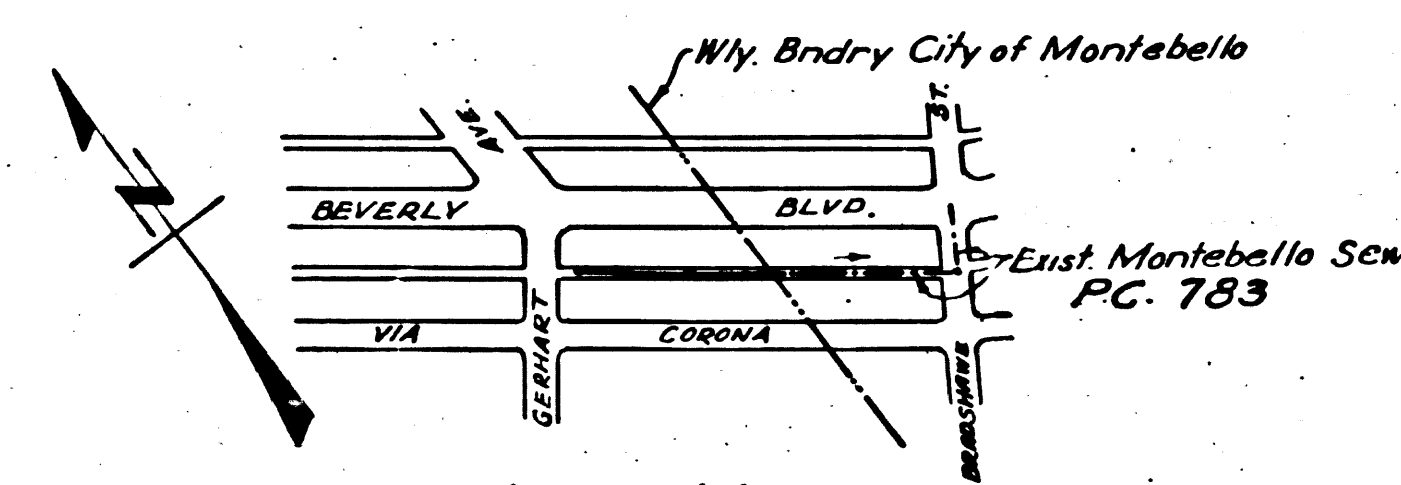

PC. 2607 J.N. F499

REVISION CHECKED
Change Depth
M. L. Sullivan 3-20-53
OFFICE OF COUNTY ENGINEER, REG. C.E. NO. 7860

Checked 4-15-53 *W. H. ...*

APPROVED: *James J. Cole* 3-25-53
ENGINEER OF MONTEBELLO

APPROVED: *William J. Fox*
COUNTY ENGINEER

APPROVED: *A. M. Rawn*
CHIEF ENGINEER CO. SAN. DIST. NO. 2

CHECKED BY: *Richard E. Nelson* 3-20-53
OFFICE OF COUNTY ENGINEER, REG. C.E. NO. 7860

R.S.

RECEIVED
APR 9 1953
L. A. COUNTY
ENGINEERING

FIRST VERTICAL CURVE OF BEVERLY BLVD. SOUTH OF BEVERLY BLVD. SOUTH OF BEVERLY BLVD.

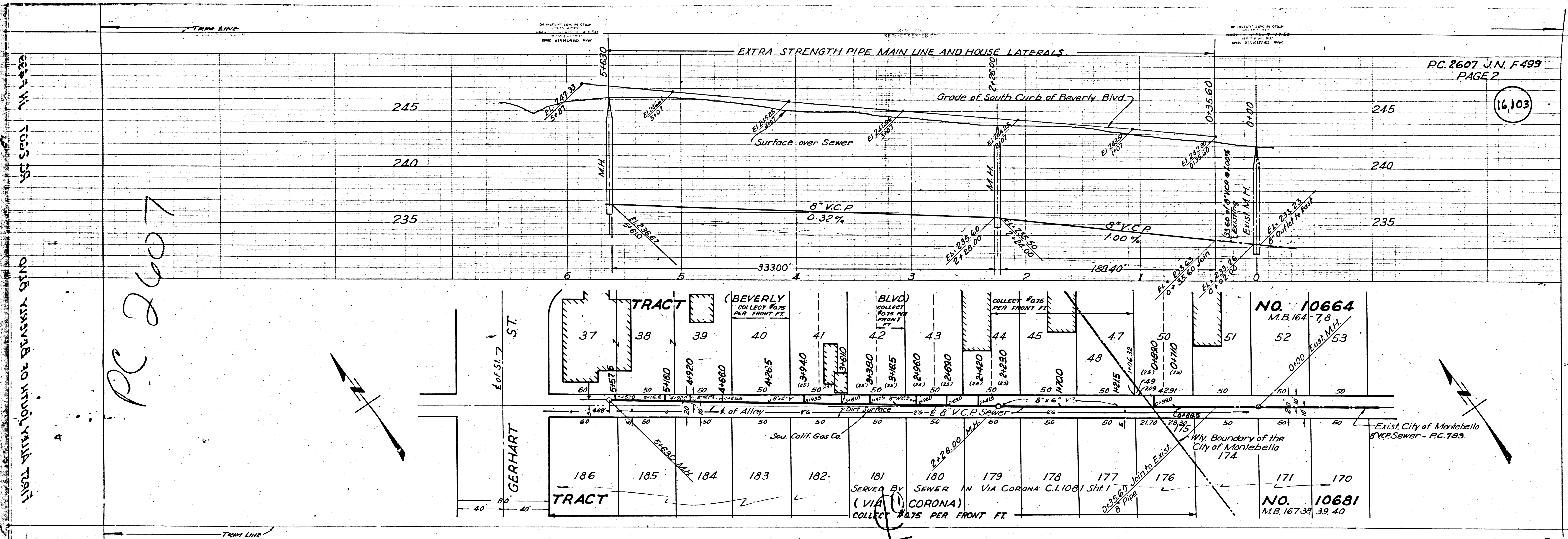

PC 2607 J.N.F. 499
PAGE 2

16,103

PC 2607

2007 W. 7005 S. 25' 10" 2005 S. 25' 10" 2005 S. 25' 10" 2005 S. 25' 10"

NO. 10664
M.B. 164-7, 8

NO. 10681
M.B. 167-39, 40

GERHART ST
E of St. 7

TRACT 37 38 39 40 41 42 43 44 45 47 50 51 52 53
 BEVERLY BLVD
 COLLECT #075 PER FRONT FT.
 186 185 184 183 182 181 180 179 178 177 176 171 170
 TRACT
 SERVED BY SEWER IN VIA CORONA C.11081 Sht. 1
 (VIA CORONA)
 COLLECT #075 PER FRONT FT.

Exist. City of Montebello
8" V.C.P. Sewer - PC 193

