



BELLFLOWER

P.L.M. 0107 P. No. 65620 C.S. 10 370-183  
 Woodruff Ave. & Park Ave. 21' Spk. to North Curb  
 of Park Ave. 21' West of East end

- NOTE:**  
 No representative of the County Engineer will survey or layout any  
 portion of the sewer.  
 The owner or his authorized representative shall furnish the County  
 Engineer with grade sheets and stations for all house connections and  
 Y-wells, and shall provide stakes for all proposed locations  
 with stationing plainly marked. Any change in location shall be requested in  
 writing by the owner or his representative.  
 No revisions shall be made in these plans without the approval of the County Engineer.  
 1. Use standard manhole frames and covers, 3'-6" dia.  
 2. Use standard strength pipe except as noted.  
 3. All structures shall be constructed in accordance with the County Road Dept. requirements.  
 4. Encase four feet of sewer at points of interference with poles, 3'-6" dia.  
 5. House connections to be constructed with 2" pipe per foot  
 in property lines.  
 6. All structures shall be brick sewer structures, 3'-6" dia.  
 7. Provide manholes on the property lines or property lines' projections.  
 8. Right angles to the sewer line at the center line of each manhole.  
 9. For allowable leakage test, use Formula No. 2, Spec. Sec. 5.

**PROFILE ALIGNMENT, AND GRADE OF  
 SANITARY SEWERS  
 TO BE CONSTRUCTED IN  
 PALM AVENUE  
 BETWEEN WOODRUFF AVE. AND  
 A POINT 170 FEET EASTERLY**

P.C. 2623  
 J.N. F. 521

Page 1  
 16,724

PRIVATE CONTRACT NO. 2623  
 W.B. 33

SHEET 1 OF 1 SHEETS  
 SCALE: VERT. 1" = 4'  
 HORIZ. 1" = 40' MARCH, 1953

Prepared in the Office of  
 VALLEY ENGINEERING CO.

By *J. J. Mansberg* Reg. C.E. No. 7676  
 FOR LEGEND SEE PLAN NO. 3-Q-G4

**NOTE:**  
 Grades to which this improvement is to be constructed are shown on plans and  
 profiles. Grade points for top of curbs, center line of streets or center line of alleys are  
 shown by circles on profiles. At all points between designated points the grade shall be  
 established so as to conform to a straight line drawn between said designated points.  
 Elevations are in feet above U.S.C. datum or mean sea level.  
 This drawing and the data hereon are hereby made a part of the specifications.  
 Work shall be constructed according to specifications on file in the office of the  
 County Engineer and shall be prosecuted only in the presence of the County Engineer.  
 Before work can be started, the contractor must obtain a permit to excavate in  
 County streets from the L.A. County Road Dept., 108 W. 2nd St. and make a deposit with  
 the County Engineer, 733 L.A. County Engineering Building, sufficient to cover the cost of  
 construction inspection and record plans.  
 Approval of this plan by the County of Los Angeles does not constitute a representation  
 as to the accuracy of the location of or the existence or non-existence of any underground  
 utility, pipe, or structure within the limits of this project. This note applies to all sheets.

COUNTY OF LOS ANGELES, CALIFORNIA

APPROVED, WILLIAM J. FOX, COUNTY ENGINEER  
 By *W. J. Fox* CHIEF DEPUTY  
 APPROVED, A.M. RAWN  
 Chief Eng'r. Co. San. Dist. No. 2  
 By *A.M. Rawn* OFFICE ENGINEER  
 CHECKED BY: *Richard E. Kuhn* 7-25-53  
 OFFICE OF COUNTY ENGINEER, REG. C.E. NO. 7660

SHEET NO.	PAGES
1	1, 2

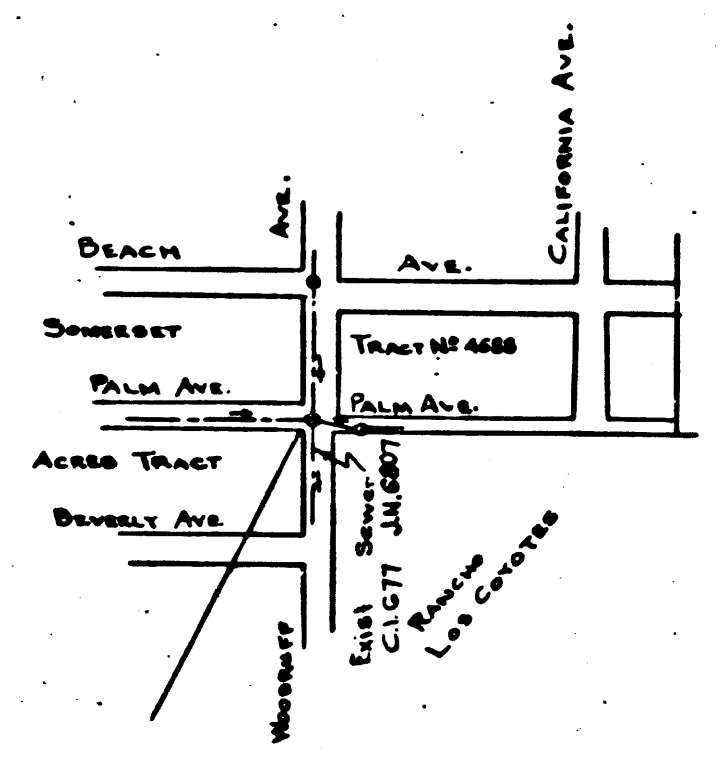

INDEX MAP  
 Scale: 1" = 400'  
 P.C. 2623 J.N. F. 521

Trim Line

B.P.M. V.A.E.

B.C.S.S.S.

7/11/53

872