

EAST LOS ANGELES BLDG. DIST. 6

17,217

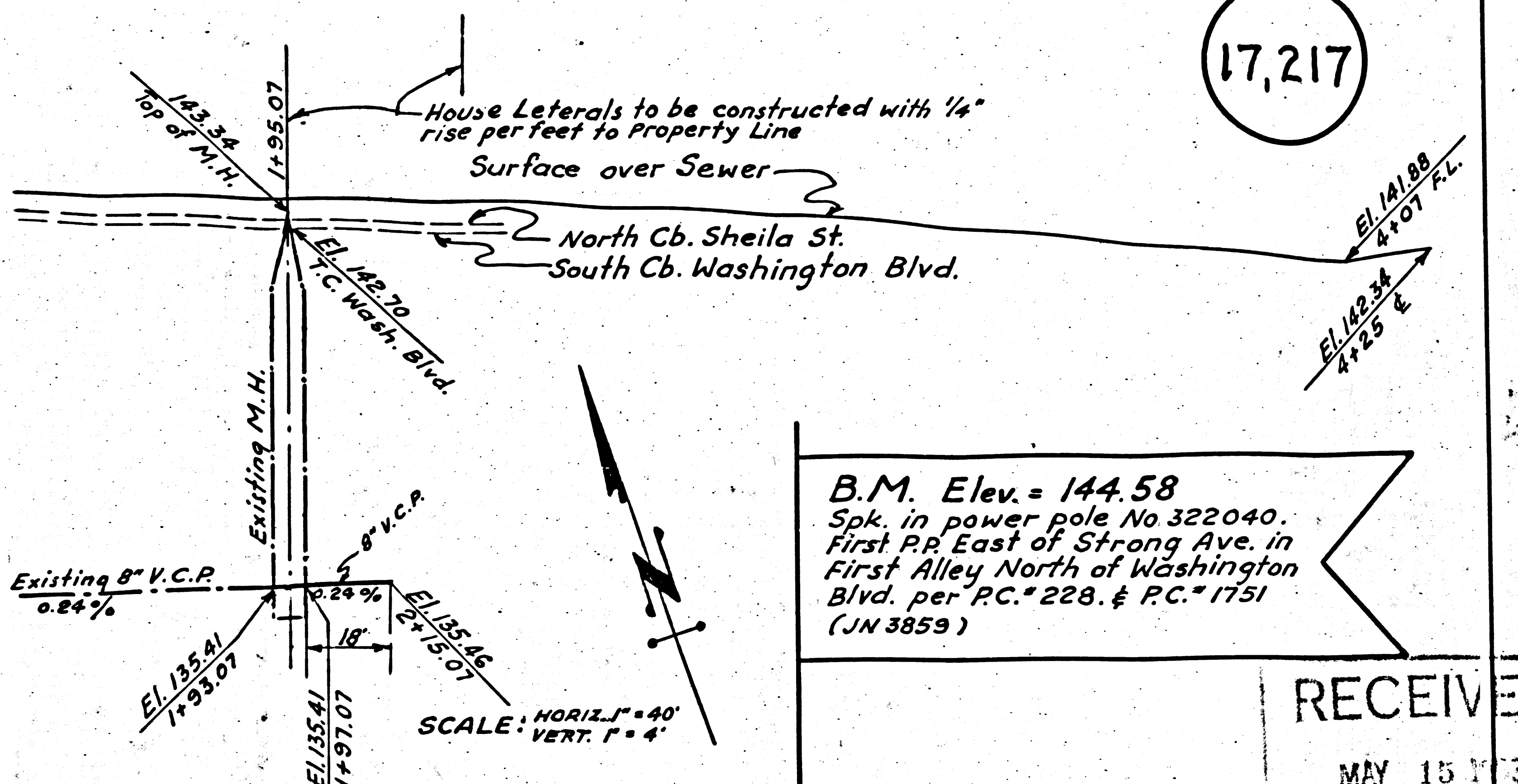

B.M. Elev. = 144.58
Spk. in power pole No 322040.
First P.P. East of Strong Ave. in
First Alley North of Washington
Blvd. per P.C. 228. & P.C. 1751
(JN 3859)

RECEIVED
MAY 15 1953
L.A. COUNTY ENGINEER
DIVISION

(WASHINGTON BLVD.)

TRACT NO. 9937

M.B. 139-60

25 26 (2+17.0) 27 28 29

Private Contract No. 1751 J.N. 3859

FIRST ALLEY SOUTH OF WASHINGTON BLVD

50' 50' 50' 50' 60'

8" V.C.P. Sewer 12" Water Pipe

50' 50' 50' 50' 60'

TRACT NO. 9937

M.B. 139-60

(SHEILA STREET)

NAME OF PROPERTY OWNER
REQUESTING SEWER CONSTRUCTION Mr. E.B. BOLSTAD

Note:
WORK SHALL BE CONSTRUCTED IN ACCORDANCE WITH THE SPECIFICATIONS ON FILE IN THE OFFICE OF THE COUNTY ENGINEER AND SHALL BE PROSECUTED ONLY IN THE PRESENCE OF THE COUNTY ENGINEER OR HIS REPRESENTATIVE.
THE ENGINEER SHALL SET STAKES FOR MAIN LINE SEWER AND SUPPLY THE COUNTY ENGINEER WITH GRADE SHEETS.

PC. 2627 J.N. F 527

PREPARED BY E. P. Wekall
REG. C.E. NO. 5939

APPROVED R. K. ... 4-21-53
OFFICE OF COUNTY ENGINEER
REG. C.E. NO. 7860

Sealed 10-19-53 McLaren

W.S. 36 MARCH, 1953

PC-2627

O'NEILL AVENUE

20

MARCH 1953